

COUNTY SANITATION DISTRICT NO. 1
 SACRAMENTO REGIONAL COUNTY SANITATION DISTRICT
SEWER IMPACT FEE
 PERMIT AND CALCULATION SHEET

APPLICATION NO: _____

BLDG PERMIT NO: _____

GENERAL INFORMATION

THIS PERMIT GOOD ONLY WHEN
 VALIDATED BY THE CASHIER

THIS PERMIT TO CONNECT EXPIRES
 ONE YEAR FROM DATE OF ISSUANCE

FEE CALCULATION

BUILDING USE

INSPECTION	RESIDENTIAL	SF	MF	UNITS
CSD-1	COMMERCIAL USE			
SRCSD				
CONSTRUCTION				
IN-LIEU				
TOTAL FEE				

APN: _____

DESCRIPTION/
 SUBDIVISION

LOT:

PROPERTY ADDRESS

OWNER

MAILING ADDRESS

CITY-STATE-ZIP

PHONE

ADDITIONAL FEES MAY BE DUE IF CHANGES IN USE INCREASE SEWER IMPACT.

APPLICANT SIGNATURE

CONSOLIDATED UTILITY BILLING USE ONLY

ACCT _____ INPUT _____ START _____

RECEIPT

INSTALLATION CARD
WESTERN ONE STUCCO SYSTEM
SACRAMENTO STUCCO PRODUCTS CO., INC.

Job Address:

LOT - 62 Arlington Park
LAKEMONT HOMES

ICBO Evaluation Service, Inc.

Report No. 3899

Date of Job Completion 8-21-97

Plastering Contractor

TOLIVER PLASTERING
P.O. BOX 740
FAIR OAKS, CA 95620-0740
CA LIC. #523013
NV LIC. #042471

Name: _____

Address: _____

Telephone Number 916) 431-9844

Approved Applicator's License Number as
Issued by Western Stucco Products 507

This is to certify that the plastering system on the building exterior at the above address has been installed in accordance with the evaluation report specified above and the manufacturer's instruction.

Gregory Toliver
Signature of authorized representative of plastering contractor

8-21-97
Date

Installation card must be presented to the building inspector after completion of work and before final inspection.

No. AP-43



WALLACE • KUHL & ASSOCIATES INC.
 GEOTECHNICAL ENGINEERING • CONSTRUCTION TESTING

3050 Industrial Blvd.
 PO Box 1137
 West Sacramento
 California 95691
 916-372-1434

DATE 11/19/97		JOB NO. 2399.07		WEATHER		TEMP. ° at		AM PM	
PROJECT ARLINGTON PARK				Technician I <input checked="" type="checkbox"/>		Staff E/G <input type="checkbox"/>			
LOCATION				Technician II <input type="checkbox"/>		Project E/G <input type="checkbox"/>			
TYPE OF WORK EPOXY BOLTS				Technician III <input type="checkbox"/>		Senior E/G <input type="checkbox"/>			
Inside 50 mi. radius <input checked="" type="checkbox"/>		Outside 50 mi. radius <input type="checkbox"/>		Nuclear Densities <input type="checkbox"/>		Principal E/G <input type="checkbox"/>			
PERSONNEL	REG. HRS	OT HRS	TOTAL HRS	TRAVEL	ON JOB	VEHICLE		MILES	
RYAN JOHNSON	7		8	1	7	#52		30	

OBSERVATIONS:

OBSERVED THE PLACEMENT OF THE EPOXY (SIMPSON EPOXY-TIG ICBO# 4945) AND THE ALL-THREAD. THE ALL-THREAD WAS A 1/2" IN DIAMETER, AND APPROX. 9" LONG. ALL HOLES WERE DRILLED TO A MIN. OF 4 1/2" IN DEPTH. ALL HOLES WERE CLEANED WITH A WIRE BRUSH AND WITH AIR.

OBSERVED THE PLACEMENT IN LOTS, 47 (12 BOLTS), ~~48 (12 BOLTS)~~, 59 (7 BOLTS), 61 (18 BOLTS), 62 (8 BOLTS), 63 (22 BOLTS), AND 64 (14 BOLTS). ALL OF THE ANCHOR BOLTS WERE INSTALLED CORRECTLY.

LOT 49 WAS NOT DONE YET. THEY WILL CALL AND RESCHEDULE FOR ANOTHER TIME.

FIELD REPORT

Signed

[Signature]

Certification of Compliance

School District Development Fees

(Print or Type) If Printing, press hard for four copies

PART I To be completed by the APPLICANT

OWNER'S NAME M.J. Brock & Sons 486-4530
 OWNER'S ADDRESS 3350 Watt Ave. Suite D Sacramento, Ca 95821
 PROJECT ADDRESS 6330 Chesterbrook Drive Elk Grove, Ca 95758
 PARCEL NUMBER 117-1260-051 LOT NO. 61
 SUBDIVISION NAME Arlington Park Unit #5 Phase 2
 NUMBER OF UNITS 1

Upon payment of the fees listed below, a 90-day approval period commences upon which the applicant paying the fees may protest such fees. Any failure to file such protest within the 90-day period shall result in forfeiture of any rights to challenge such fees, through litigation or otherwise.

APPLICANT'S SIGNATURE [Signature]
 TITLE OF APPLICANT Operations
 DATE 8/18/97 PHONE NUMBER 991-1200

PART II To be completed by BUILDING DEPARTMENT

PLAN IDENTIFICATION NUMBER 1624
 BUILDING TYPE
 RESIDENTIAL () APARTMENT/CONDOMINIUM () COMMERCIAL/INDUSTRIAL ()
 SQUARE FEET OF CHARGEABLE BUILDING AREA 1624
 SIGNATURE _____
 TITLE _____ DATE _____

PART III To be completed by SCHOOL DISTRICT

SCHOOL DISTRICT [Signature]
 DISTRICT CERTIFICATION NO. [Signature]

EXEMPT	COMMENTS
RESIDENTIAL/APT/CONDO _____	SQ FT X \$ _____ = \$ _____
COMMERCIAL/INDUSTRIAL _____	SQ FT X \$ _____ = \$ _____
OTHER FEE _____ TYPE _____	SQ FT X \$ _____ = \$ _____
TOTAL FEES COLLECTED _____	= \$ 5148.08

This Certification covers only the amount of square footage indicated above. Any additions or corrections to the square footage for this project will require an amendment to the Certificate of Compliance.

As the authorized school district official, I hereby certify that the requirements of Government Code Section 65995 and any other authorized requirements have been complied with by the above signed applicant.

AUTHORIZED SCHOOL DISTRICT OFFICIAL

SIGNATURE _____ TITLE _____ DATE _____

PAID

SEP 16 1997

Original: School District

1st copy: School District

2nd copy: Building Department

3rd copy: **Facilities Planning**
 Elk Grove Unified School District

SCALE: 1" = 20'

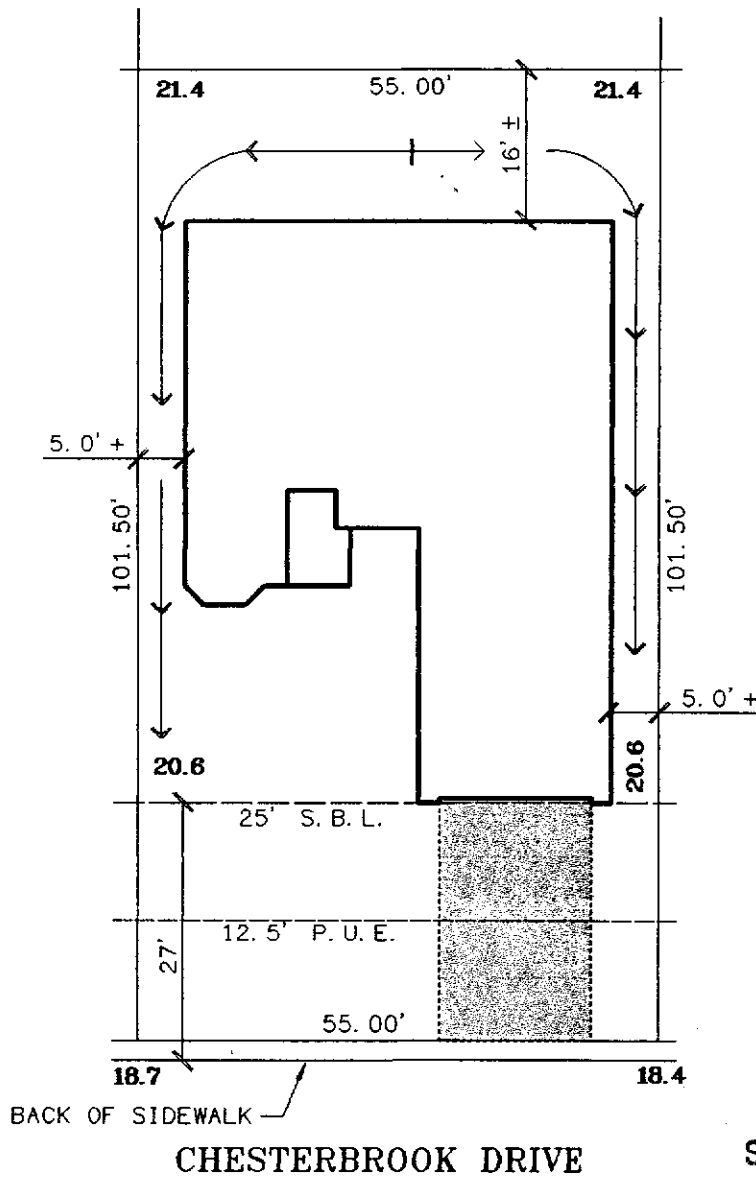

ISSUED

SEP 24 1997

Sacramento Building Division

LOT 61
PLAN 1624B RIGHT
 A.P.N.: 117-126-061

ADDRESS: 6330 CHESTERBROOK DRIVE

THIS PLOT PLAN IS FOR THE PURPOSE OF SHOWING THE HOUSE TO BE CONSTRUCTED ON THE LOT AND MAY NOT REPRESENT THE FINAL AS-BUILT CONFIGURATION OF THE PROPERTY OR IMPROVEMENTS THEREON. SETBACKS, OTHER THAN MINIMUM ORDINANCE, ARE APPROXIMATE ONLY AND MUST NOT BE ASSUMED TO BE PRECISE.

PR
8-18-97
8-15-97

The Splink Corporation
 2590 VENTURE OAKS WAY
 SACRAMENTO, CA 95833

PH:(916)925-5550 FAX:(916)921-9274

LARCHMONT HOMES
 3350 Watt Avenue
 Suite D
 Sacramento, CA 95821-3670

office: (916) 488-4500
 fax: (916) 488-7417

Larchmont Arlington Park
 Arlington Park Unit No. 5 Phase II
 City of Sacramento, California

Scale: 1"=20'

August, 1997