

CITY OF SACRAMENTO  
1231 I Street, Sacramento, CA 95814

Permit No: 9902086  
Insp Area: 4

Site Address: 1927 HAWKHAVEN WY SAC Sub-Type: NSFR  
Parcel No: 225-1100-034 NORTHPOINTE PARK UNIT 5 LOT 34 Housing (Y/N):  
N

CONTRACTOR  
CENTEX HOMES  
3300 DOUGLAS BL #425  
ROSEVILLE CA

OWNER  
CENTEX HOMES

ARCHITECT

95661

Nature of Work: MP 1400 7ROOM SFD

**CONSTRUCTION LENDING AGENCY :** I hereby affirm under penalty of perjury that there is a construction lending agency for the performance of the work for which this permit is issued (Sec. 3097, Civ. C).

Lender's Name \_\_\_\_\_ Lender's Address \_\_\_\_\_

**LICENSED CONTRACTORS DECLARATION:** I hereby affirm under penalty of perjury that I am licensed under provisions of Chapter 9 (commencing with section 7000) of Division 3 of the Business and Professions Code and my license is in full force and effect.

License Class \_\_\_\_\_ License Number 734094 Date 3/10/99 Contractor Signature Debbie Stawles

**OWNER-BUILDER DECLARATION:** I hereby affirm under penalty of perjury that I am exempt from the contractors License Law for the following reason (Sec. 7031.5, Business and Professions Code; any city or county which requires a permit to construct, alter, improve, demolish, or repair any structure, prior to its issuance, also requires the applicant for such permit to file a signed statement that he or she is licensed pursuant to the provisions of the Contractors License Law (Chapter 9 (commencing with Section 7000) of Division 8 of the Business and Professions Code) or that he or she is exempt therefrom and the basis for the alleged exemption. Any violation of Section 7031.5 by any applicant for a permit subjects the applicant to a civil penalty of not more than five hundred dollars (\$500.00);

\_\_\_\_ I, as a owner of the property, or my employees with wages as their sole compensation, will do the work, and the structure is not intended or offered for sale (Sec. 7044, Business and Professional Code: The Contractors License Law does not apply to an owner of property who builds or improves thereon, and who does such work himself or herself or through his/her own employees, provided that such improvements are not intended or offered for sale. If, however, the building or improvement is sold within one year of completion, the owner-builder will have the burden of proving that he/she did not build or improve for the purpose of sale.)

\_\_\_\_ I, as owner of the property, am exclusively contracting with licensed contractors to construct the project (Sec: 7044, Business and Professions Code: The Contractors License Law does not apply to an owner of property who builds or improves thereon, and who contracts for such projects with a contractor(s) licensed pursuant to the Contractors License Law).

\_\_\_\_ I am exempt under Sec. \_\_\_\_\_ B & PC for this reason: \_\_\_\_\_

Date \_\_\_\_\_ Owner Signature \_\_\_\_\_

**IN ISSUING THIS BUILDING PERMIT,** the applicant represents, and the city relies on the representation of the applicant, that the applicant verified all measurements and locations shown on the application or accompanying drawings and that the improvement to be constructed does not violate any law or private agreement relating to permissible or prohibited locations for such improvements. This building permit does not authorize any illegal location of any improvement or the violation of any private agreement relating to location of improvements.

I certify that I have read this application and state that all information is correct. I agree to comply with all city and county ordinances and state laws relating to building construction and hereby authorize representative(s) of this city to enter upon the abovementioned property for inspection purposes.

Date 3/10/99 Applicant/Agent Signature Debbie Stawles

**WORKER'S COMPENSATION DECLARATION:** I hereby affirm under penalty of perjury one of the following declarations:

\_\_\_\_ I have and will maintain a certificate of consent to self-insure for workers' compensation as provided for by Section 3700 of the Labor Code, for the performance of work for which the permit is issued.

\_\_\_\_ I have and will maintain workers' compensation insurance, as required by Section 3700 of the Labor Code, for the performance of the work for which this permit is issued. My workers' compensation insurance carrier and policy number are:

Carrier AMERICAN GUARANTEE AND LIABILITY Policy Number WC8322096-02 Exp Date 10/01/1999

\_\_\_\_ (This section need not be completed if the permit is for \$100 or less) I certify that in the performance of the work for which this permit is issued, I shall not employ any person in any manner so as to become subject to the workers' compensation laws of California and agree that if I should become subject to the workers' compensation provisions of Section 3700 of the Labor Code, I shall forthwith comply with those provisions.

Date 3/10/99 Applicant Signature Debbie Stawles

WARNING: FAILURE TO SECURE WORKER'S COMPENSATION COVERAGE IS UNLAWFUL AND SHALL SUBJECT AN EMPLOYER TO CRIMINAL PENALTIES AND CIVIL FINES UP TO ONE HUNDRED THOUSAND DOLLARS (\$100,000) IN ADDITION TO THE COST OF COMPENSATION, DAMAGES AS PROVIDED FOR IN SECTION 3706 OF THE LABOR CODE, INTEREST AND ATTORNEY'S FEE.

**THIS PERMIT SHALL EXPIRE BY LIMITATION IF WORK IS NOT COMMENCED WITHIN 180 DAYS.**

# NATOMAS UNIFIED SCHOOL DISTRICT

1515 Sports Drive, #1 • Sacramento, CA 95834

Phone 916/641-3300 • Fax 916/928-1629

## CERTIFICATION OF COMPLIANCE

### SCHOOL DISTRICT DEVELOPMENT FEES

#### PART I: TO BE COMPLETED BY APPLICANT

PROPERTY OWNER'S NAME		3500 ...	
OWNER'S ADDRESS		3500 ... # 210 ...	
PROJECT ADDRESS		1927 Hawkhaven Way, Sacramento, CA 95821	
PARCEL NUMBER		225-110-034	
SUBDIVISION NAME		... # 5	
NUMBER OF UNITS		1	
PRINT APPLICANT'S NAME	APPLICANT'S SIGNATURE: [Signature]		
TITLE OF APPLICANT			
DATE	TELEPHONE NUMBER		

#### PART II: TO BE COMPLETED BY BUILDING DEPARTMENT

PLAN IDENTIFICATION NUMBER		1400	
BUILDING TYPE (CHECK ONE)			
<input checked="" type="checkbox"/> RESIDENTIAL		<input type="checkbox"/> APARTMENT/CONDOMINIUM	<input type="checkbox"/> COMMERCIAL/INDUSTRIAL
SQUARE FEET OF CHARGEABLE BUILDING AREA		1400	
SIGNATURE			
TITLE		DATE	

#### PART III: TO BE COMPLETED BY NATOMAS UNIFIED SCHOOL DISTRICT

DISTRICT CERTIFICATION NUMBER			
FEES COLLECTED			
RESIDENTIAL	1400	Sq. Ft. X \$ 4.57	= \$ 6398.00
APARTMENT/CONDOMINIUM		Sq. Ft. X \$	= \$
COMMERCIAL/INDUSTRIAL		Sq. Ft. X \$	= \$

This certification covers only the amount of square footage indicated above. Any additions or corrections to the square footage for this project will require an amendment to the Certificate of Compliance.

As the authorized school district official, I hereby certify that the requirements of Government Code Section 65995 have been complied with by the above signed applicant.

AUTHORIZED SCHOOL DISTRICT OFFICIAL:

SIGNATURE: \_\_\_\_\_

TITLE: \_\_\_\_\_

DATE: 3/9/99

WHITE - SCHOOL DISTRICT

YELLOW - SCHOOL DISTRICT

PINK - BUILDING DEPARTMENT

GOLD - APPLICANT



This plan shows the general layout of the property. All information on this plan is for informational purposes only. It is not intended to be used for legal purposes. All dimensions, setback dimensions, driveway grades, and wall heights are subject to change without prior notice.

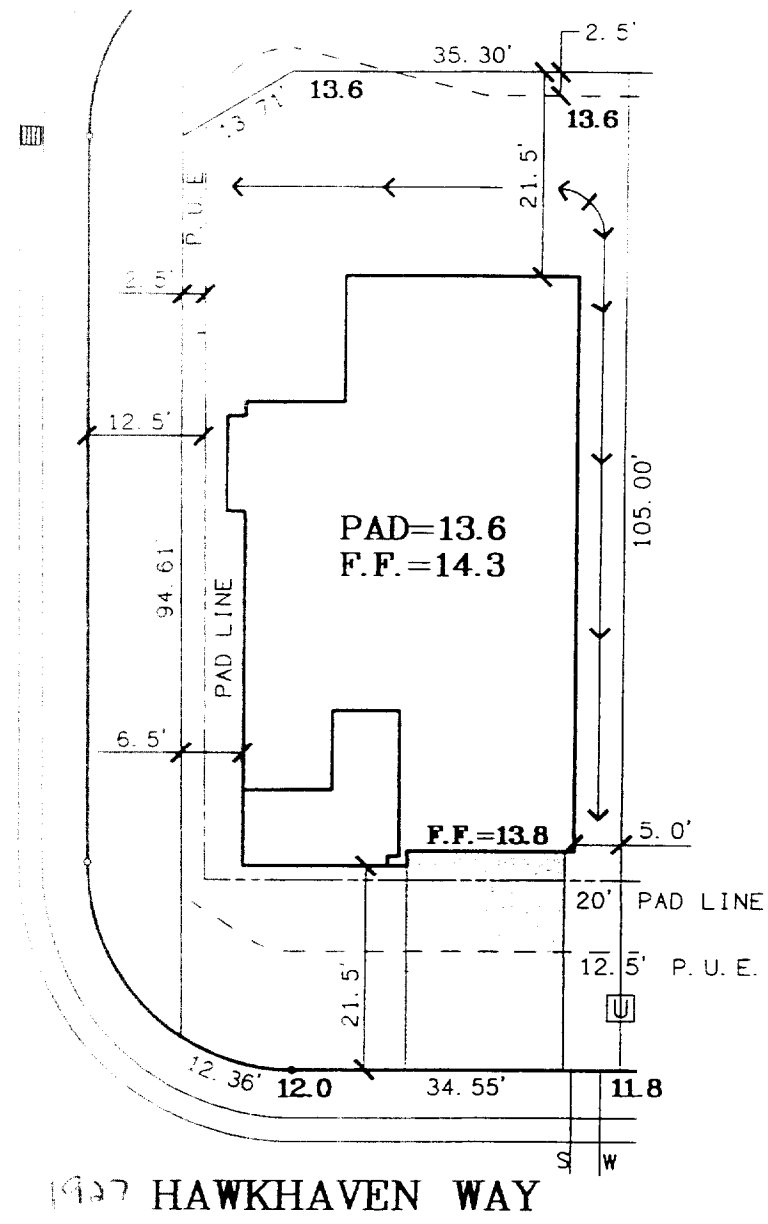

ALLANO AVENUE

1927 HAWKHAVEN WAY

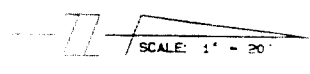

LOT 34  
 PLAN 1400 RIGHT  
 A.P.N.:  
 ADDRESS: 1927 HAWKHAVEN WAY  
 LOT AREA: 4,857 SF  
 LOT COVERAGE: 42%

READ AND APPROVED  
 Plan \_\_\_\_\_ Land Development \_\_\_\_\_  
 Elevation \_\_\_\_\_ Const. Manager \_\_\_\_\_  
 Orientation \_\_\_\_\_ Sales Appr. \_\_\_\_\_  
 Color \_\_\_\_\_ Field Manager \_\_\_\_\_

**The Splink Corporation**  
 2590 VENTURE OAKS WAY  
 SACRAMENTO, CA 95833

**CENTEX HOMES**  
 3300 Douglas Boulevard  
 Suite 210  
 Roseville Ca. 95661

**NORTHPOINTE PARK**  
 UNIT NO. 5  
 City of Sacramento, California

PH: (916) 925-5550 FAX: (916) 921-9274

office: (916) 786-8693  
 fax: (916) 786-6802

Scale: 1"=20'

REV Mar 1, 1999