

CITY OF SACRAMENTO
1231 I Street, Sacramento, CA 95814

Permit No: 0104953
Insp Area: 2

Site Address: 7297 LUTHER DR SAC
Parcel No: 049-0440-062 LUTHER ESTATES LOT 4

Sub-Type: NSFR
Housing (Y/N): N

CONTRACTOR
MAHAL CO.
3 NAPLES CT
SAC, CA 95831

OWNER
DUNCAN R.C., Mahal Co.
ORANGEVALE, CA
95662

ARCHITECT

Nature of Work: MP 1964 2 STORY 8 ROOM SFR

CONSTRUCTION LENDING AGENCY: I hereby affirm under penalty of perjury that there is a construction lending agency for the performance of the work for which this permit is issued (Sec. 3097, Civ. C)

Lender's Name _____ Lender's Address _____

LICENSED CONTRACTORS DECLARATION: I hereby affirm under penalty of perjury that I am licensed under provisions of Chapter 9 (commencing with section 7000) of Division 3 of the Business and Professions Code and my license is in full force and effect.

License Class B License Number 751251 Date 4/25/01 Contractor Signature [Signature]

OWNER-BUILDER DECLARATION: I hereby affirm under penalty of perjury that I am exempt from the contractors License Law for the following reason (Sec. 7031.5, Business and Professions Code, any city or county which requires a permit to construct, alter, improve, demolish, or repair any structure, prior to its issuance, also requires the applicant for such permit to file a signed statement that he or she is licensed pursuant to the provisions of the Contractors License Law (Chapter 9 (commencing with Section 7000) of Division 8 of the Business and Professions Code) or that he or she is exempt therefrom and the basis for the alleged exemption. Any violation of Section 7031.5 by any applicant for a permit subjects the applicant to a civil penalty of not more than five hundred dollars (\$500.00):

X I, as a owner of the property, or my employees with wages as their sole compensation, will do the work, and the structure is not intended or offered for sale (Sec. 7044, Business and Professional Code. The Contractors License Law does not apply to an owner of property who builds or improves thereon, and who does such work himself or herself or through his/her own employees, provided that such improvements are not intended or offered for sale. If, however, the building or improvement is sold within one year of completion, the owner-builder will have the burden of proving that he/she did not build or improve for the purpose of sale.)

I, as owner of the property, am exclusively contracting with licensed contractors to construct the project (Sec. 7044, Business and Professions Code. The Contractors License Law does not apply to an owner of property who builds or improves thereon, and who contracts for such projects with a contractor(s) licensed pursuant to the Contractors License Law).

I am exempt under Sec. _____ B & PC for this reason: _____

Date 4/25/01 Owner Signature [Signature]

IN ISSUING THIS BUILDING PERMIT, the applicant represents, and the city relies on the representation of the applicant, that the applicant verified all measurements and locations shown on the application or accompanying drawings and that the improvement to be constructed does not violate any law or private agreement relating to permissible or prohibited locations for such improvements. This building permit does not authorize any illegal location of any improvement or the violation of any private agreement relating to location of improvements.

I certify that I have read this application and state that all information is correct. I agree to comply with all city and county ordinances and state laws relating to building construction and hereby authorize representative(s) of this city to enter upon the abovementioned property for inspection purposes.

Date 4/25/01 Applicant/Agent Signature [Signature]

WORKER'S COMPENSATION DECLARATION: I hereby affirm under penalty of perjury one of the following declarations:

I have and will maintain a certificate of consent to self-insure for workers' compensation as provided for by Section 3700 of the Labor Code, for the performance of work for which the permit is issued

X I have and will maintain workers' compensation insurance, as required by Section 3700 of the Labor Code, for the performance of the work for which this permit is issued. My workers' compensation insurance carrier and policy number are:

Carrier STATE FUND Policy Number 1616696 Exp Date 02/01/2002

(This section need not be completed if the permit is for \$100 or less) I certify that in the performance of the work for which this permit is issued, I shall not employ any person in any manner so as to become subject to the workers' compensation laws of California and agree that if I should become subject to the workers' compensation provisions of Section 3700 of the Labor Code, I shall forthwith comply with those provisions.

Date 4/25/01 Applicant Signature [Signature]

WARNING: FAILURE TO SECURE WORKER'S COMPENSATION COVERAGE IS UNLAWFUL AND SHALL SUBJECT AN EMPLOYER TO CRIMINAL PENALTIES AND CIVIL FINES UP TO ONE HUNDRED THOUSAND DOLLARS (\$100,000) IN ADDITION TO THE COST OF COMPENSATION, DAMAGES AS PROVIDED FOR IN SECTION 3706 OF THE LABOR CODE, INTEREST AND ATTORNEY'S FEE.

THIS PERMIT SHALL EXPIRE BY LIMITATION IF WORK IS NOT COMMENCED WITHIN 180 DAYS.



WesPac

insulation

a MASCO Company



809 North Market Blvd., Ste. 11 • Sacramento, CA 95834
(916) 927-7149 • Fax (916) 927-4257
Lic. #487478

Installed Insulation Certificate

We certify that the building insulation listed herein is installed in conformance with current energy conservation regulations, California Administrative Code, Title 24, State of California

R FACTOR	AREA	TYPE	INCHES/BAGS (BLOWN)
R38	CEILING AREA	FIBERGLASS BLOW	14.75" / 22 BAGS
R38	CEILING AREA	FIBERGLASS BATT	13"
R13 @2X4	EXT. WALL AREA	FIBERGLASS BATT	3.5"
R19 @2X6	EXT. WALL AREA	FIBERGLASS BATT	6.5"

Certified by

Jammy Jimenez

Title Secretary

7297 LUTHER DR

7297 LUTHER DR/4

Address or Lot Number

08/30/01

Phase #

Date Installed



BASALITE®
 PACIFIC STUCCO SYSTEMS

4290 Roseville Road
 North Highlands, CA 95660-5710
 (916) 486-4094
 Fax (916) 486-4187

Installation Card
 Fiber Reinforced Stucco

Job Name and Address : LUTHER STATES
MAHAL CO

ICBO# 5269

9-08-01
 Date of job completion
LOT-4

Plastering Contractor

Name: VISION PLASTERING

Address: 8974 GREEN BACH LN

Telephone No. () 987-3324

Approved contractor as issued by Basalite/Pacific Stucco.

This is to certify the exterior coating system at the above address, has been installed in accordance with the evaluation report specified above and the manufacturers instructions.

[Signature]
 Signature of authorized representative of
 plastering contractor

10-10-01
 Date

This installation card must be presented to the building inspector after completion of work and before final inspection.

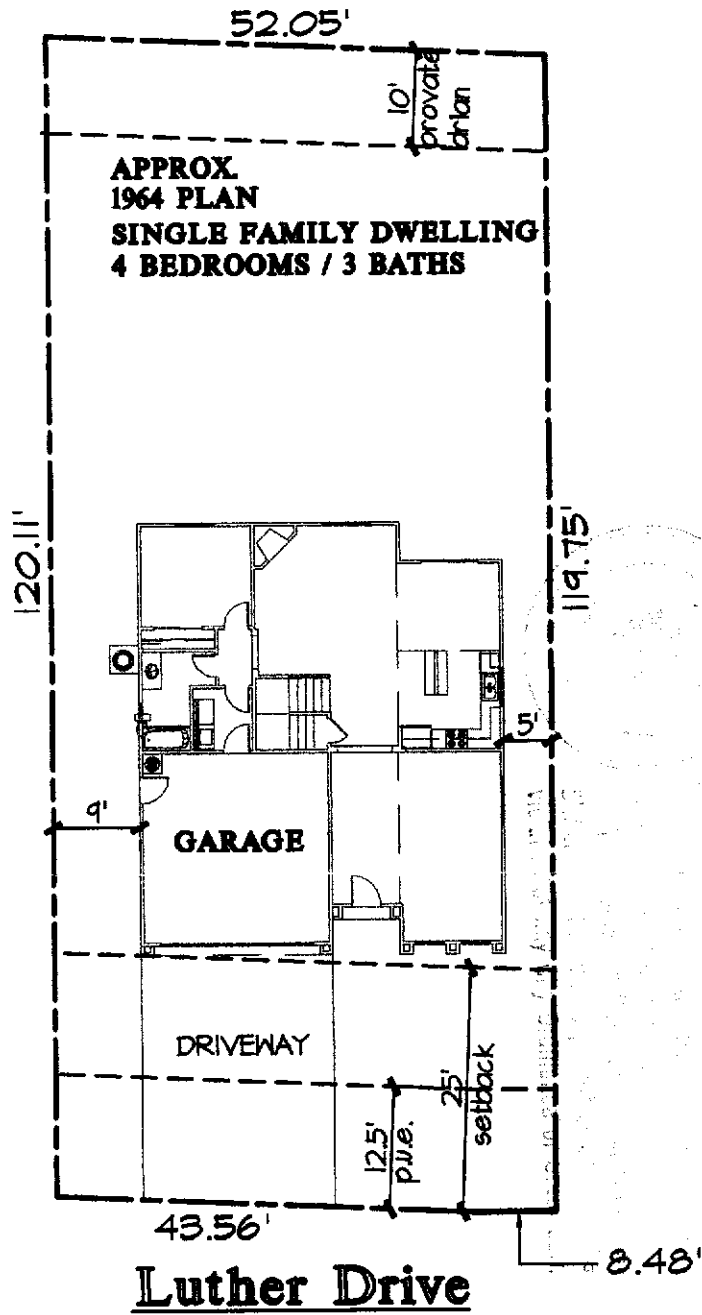

Talle Design

206 Bridge Street
Yuba City Ca. 95991

PH: (530) 674-1670

SITE PLAN - Luther Estates - Lot #4

PROJECT: Luther Estates-1964 Sq. Ft. Plan
7297 Luther Drive Sacramento Ca.

A.P.N.: 049-0440-062 DRAWN : GRC
DATE : 02-06-01 CHECKED:
SCALE : 1" = 20' REVISED:

SHEET

OF SHTS

