

**CITY OF SACRAMENTO**  
1231 I Street, Sacramento, CA 95814

**Permit No: 0104946**  
**Insp Area: 4**

**Site Address: 1821 BAINES AV SAC**  
Parcel No: 225-1110-018 NORTHPT PK 12 LOT 18

Sub-Type: NSFR  
Housing (Y/N): N

**CONTRACTOR**  
FENNAR RENAISSANCE INC  
2240 DOUGLAS BL  
ROSEVILLE CA 95661

**OWNER**  
FENNAR RENAISSANCE INC  
2240 DOUGLAS BLVD #250  
ROSEVILLE CA 95661

**ARCHITECT**

**Nature of Work: NSFR MP652X/OPT 1&2 2741 SQ FT/11 RMS**

**CONSTRUCTION LENDING AGENCY:** I hereby affirm under penalty of perjury that there is a construction lending agency for the performance of the work for which this permit is issued (Sec. 3097, Civ. C.)

Lender's Name \_\_\_\_\_ Lender's Address \_\_\_\_\_

**LICENSED CONTRACTORS DECLARATION:** I hereby affirm under penalty of perjury that I am licensed under provisions of Chapter 9 (commencing with section 7000) of Division 3 of the Business and Professions Code and my license is in full force and effect.

License Class B License Number 732248 Date 6/1/02 Contractor Signature J. Price

**OWNER-BUILDER DECLARATION:** I hereby affirm under penalty of perjury that I am exempt from the contractors License Law for the following reason (Sec. 7031.5, Business and Professions Code: any city or county which requires a permit to construct, alter, improve, demolish, or repair any structure, prior to its issuance, also requires the applicant for such permit to file a signed statement that he or she is licensed pursuant to the provisions of the Contractors License Law (Chapter 9 (commencing with Section 7000) of Division 8 of the Business and Professions Code) or that he or she is exempt therefrom and the basis for the alleged exemption. Any violation of Section 7031.5 by any applicant for a permit subjects the applicant to a civil penalty of not more than five hundred dollars (\$500.00).

I, as a owner of the property, or my employees with wages as their sole compensation, will do the work, and the structure is not intended or offered for sale (Sec. 7044, Business and Professions Code. The Contractors License Law does not apply to an owner of property who builds or improves thereon, and who does such work himself or herself or through his/her own employees, provided that such improvements are not intended or offered for sale. If, however, the building or improvement is sold within one year of completion, the owner-builder will have the burden of proving that he/she did not build or improve for the purpose of sale.)

I, as owner of the property, am exclusively contracting with licensed contractors to construct the project (Sec. 7044, Business and Professions Code). The Contractors License Law does not apply to an owner of property who builds or improves thereon, and who contracts for such projects with a contractor(s) licensed pursuant to the Contractors License Law.

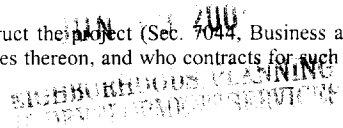

I am exempt under Sec. \_\_\_\_\_ B & P. for this reason \_\_\_\_\_

Date \_\_\_\_\_ Owner Signature \_\_\_\_\_

**IN ISSUING THIS BUILDING PERMIT,** the applicant represents, and the city relies on the representation of the applicant, that the applicant verified all measurements and locations shown on the application or accompanying drawings and that the improvement to be constructed does not violate any law or private agreement relating to permissible or prohibited locations for such improvements. This building permit does not authorize any illegal location of any improvement or the violation of any private agreement relating to location of improvements.

I certify that I have read this application and state that all information is correct. I agree to comply with all city and county ordinances and state laws relating to building construction and hereby authorize representative(s) of this city to enter upon the abovementioned property for inspection purposes.

Date 6/1/02 Applicant/Agent Signature J. Price

**WORKER'S COMPENSATION DECLARATION:** I hereby affirm under penalty of perjury one of the following declarations:

I have and will maintain a certificate of consent to self-insure for workers' compensation as provided for by Section 3700 of the Labor Code, for the performance of work for which the permit is issued

I have and will maintain workers' compensation insurance, as required by Section 3700 of the Labor Code, for the performance of the work for which this permit is issued. My workers' compensation insurance carrier and policy number are:

Carrier CNA INSURANCE COMPANY Policy Number WC138201151 Exp Date 06/01/2002

(This section need not be completed if the permit is for \$100 or less) I certify that in the performance of the work for which this permit is issued, I shall not employ any person in any manner so as to become subject to the workers' compensation laws of California and agree that if I should become subject to the workers' compensation provisions of Section 3700 of the Labor Code, I shall forthwith comply with those provisions.

Date 6/1/02 Applicant Signature J. Price

**WARNING: FAILURE TO SECURE WORKER'S COMPENSATION COVERAGE IS UNLAWFUL AND SHALL SUBJECT AN EMPLOYER TO CRIMINAL PENALTIES AND CIVIL FINES UP TO ONE HUNDRED THOUSAND DOLLARS (\$100,000) IN ADDITION TO THE COST OF COMPENSATION, DAMAGES AS PROVIDED FOR IN SECTION 3706 OF THE LABOR CODE, INTEREST AND ATTORNEY'S FEE.**

**THIS PERMIT SHALL EXPIRE BY LIMITATION IF WORK IS NOT COMMENCED WITHIN 180 DAYS.**

RESIDENTIAL BUILDING PERMIT APPLICATION

New Construction

Addition

Remodels

Other

Project Address: 1821 Baines Ave.

Assessor Parcel # 225-111-018-000

OWNER INFORMATION: LOT 18

Legal Property Owner: LENNAR RENAISSANCE, INC. Phone # (916) 773-4083  
Owner Address: 2240 DOUGLAS BLVD. #250 City ROSEVILLE State CA Zip 95661

CONTRACTOR INFORMATION:

Contractor: SAME AS ABOVE Lic. # 732348 B Phone # 773-4083 Fax# 773-4086

PROJECT INFORMATION:

Land Use Zone R/A Occupancy Group R3 Construction Type VN Fed Code 1A  
No. of stories: 1 No. of rooms: 11 Street width: 40  
1<sup>st</sup> Floor Area 2346 2<sup>nd</sup> Floor Area \* Basement \_\_\_\_\_ Roof Material \_\_\_\_\_

AREA IN SQUARE FOOT OF:

EXISTING

NEW

Dwelling/Living \_\_\_\_\_ 2741  
Garage/Storage \_\_\_\_\_ 662  
Decks/Balconies \_\_\_\_\_ 118  
Carports \_\_\_\_\_

SCOPE OF WORK: MP 2741/ 652X

\* BONUS ROOM PER PLANNING DIRECTORS SPECIAL PERMIT (395 SF.)

FOR OFFICE USE ONLY

- Information above complete
- Violation files checked
- Standard setbacks
- County Sewer
- AR Flood Waiver required
- Flood Elevation Certificate Required
- Water Development Infill Area
- Planning Approval
- Design Review Approval
- Special Fee Districts Apply : \_\_\_\_\_

NEW STRUCTURES & ADDITIONS

❖ THE FOLLOWING MUST BE PROVIDED IN ORDER TO SUBMIT FOR PLAN REVIEW

- 2 COMPLETE PLANS, LEGIBLE & DRAWN TO SCALE
- 3 SETS IF PROJECT IS IN A DESIGN REVIEW AREA
- Title 24 Energy Compliance documentation
- Grading and Erosion Control Questionnaire
- ❖ Plans to include: site plan, floor plan, elevations, roof/ceiling plan, foundation and structural framing details, and structural calculations for non-conforming structures.
- 11" x 17" copy of floor plan for County Assessor
- Plan Review Fees

Date: \_\_\_\_\_

Received by: (staff) 4-4-01

ACTIVITY/PERMIT #  
0104946

\$ 180,805 48

# INSTALLATION CARD

Job Address:

1821 Baines Ave  
Sacramento Ca  
H/S # 18

State System Trademark: **STATE NOTE**Name of State Manufacturer: **STATE NOTE CORP.**

OSD Evaluation Service, Inc.

OSD Report # 1-4-02  
Date of Job Completion

State Contractor:

Name: Kenyon Plastering  
Address: Sacramento Ca

Telephone Number: \_\_\_\_\_

Approved Contractor Number as issued by the State Manufacturer: \_\_\_\_\_

This is to certify that the plaster system on the building exterior of the above address has been inspected in accordance with the evaluation report specified above and the manufacturer's instructions.

Nester Perez  
Signature of authorized representative of state contractor

1/18/02  
Date

## FIGURE 1

### DECLARATION

Project Address: \_\_\_\_\_ Date: \_\_\_\_\_

The field batch and mixing of all components and of the exterior wall coating of the address noted above has been continuously inspected before, during and after installation of the continuous coating. The field batching and mixing have been found to comply with current evaluation report SA-007 and approved plans.

Authorized Inspector Signature: \_\_\_\_\_

Authorized Inspector Name (Print): \_\_\_\_\_

Employer Name: \_\_\_\_\_

Employer Address: \_\_\_\_\_

Telephone Number ( ): \_\_\_\_\_

This is to certify that the above noted inspector, approved by STATE NOTE CORP. was authorized to inspect the project as noted and was found to properly discharge his duties.

Signature of Employee of Office of Report Issuer: \_\_\_\_\_

Signer's Name (Print): \_\_\_\_\_ Date: \_\_\_\_\_

\* Signature required only if inspector is not an employee of evaluation report issuer.

## FIGURE 4

**ENGEL INSULATION, INC.**

CALIFORNIA CONTRACTOR'S LICENSE #745646

460 Roseville Road • Roseville, CA 95678

(916) 786-2088 / (916) 969-6191

THIS IS TO CERTIFY THAT INSULATION HAS BEEN INSTALLED IN CONFORMANCE WITH CURRENT ENERGY REGULATIONS, CALIFORNIA ADMINISTRATIVE CODE, TITLE 24, STATE OF CALIFORNIA, IN THE BUILDING LOCATED AT:

TRACT SOMERSET LOT #18  
 STREET \_\_\_\_\_ CITY SACRAMENTO

EXTERIOR WALLS

MANUFACTURER CERTAINTEED THICKNESS 3 1/2" R-VALUE 13

CEILING AREA: BATTS

MANUFACTURER CERTAINTEED THICKNESS 12" R-VALUE 38

CEILINGS: BLOWN IN

MANUFACTURER CERTAINTEED THICKNESS 1 3/4" R-VALUE 38

SQUARE FOOTAGE 2150 † NUMBER OF BAGS USED 42

FLOOR AREA N/A

MANUFACTURER \_\_\_\_\_ THICKNESS \_\_\_\_\_ R-VALUE \_\_\_\_\_

EXTERIOR KNEEWALL:

MANUFACTURER CERTAINTEED THICKNESS 3 1/2" R-VALUE 13

INTERIOR KNEEWALL:

MANUFACTURER CERTAINTEED THICKNESS 3 1/2" R-VALUE 13

APPLIED CAULK & SEALANT TO ALL EXTERIOR  
 OPENINGS & PENETRATIONS

YES X NO \_\_\_\_\_

GENERAL CONTRACTOR \_\_\_\_\_

CALIFORNIA CONTRACTORS  
 LICENSE # \_\_\_\_\_ DATE \_\_\_\_\_

SIGNATURE \_\_\_\_\_ TITLE \_\_\_\_\_  
 INSULATION CONT. SIGNATURE \_\_\_\_\_ TITLE ESTIM./SALES DATE 1/31/02

19  
P=13.3

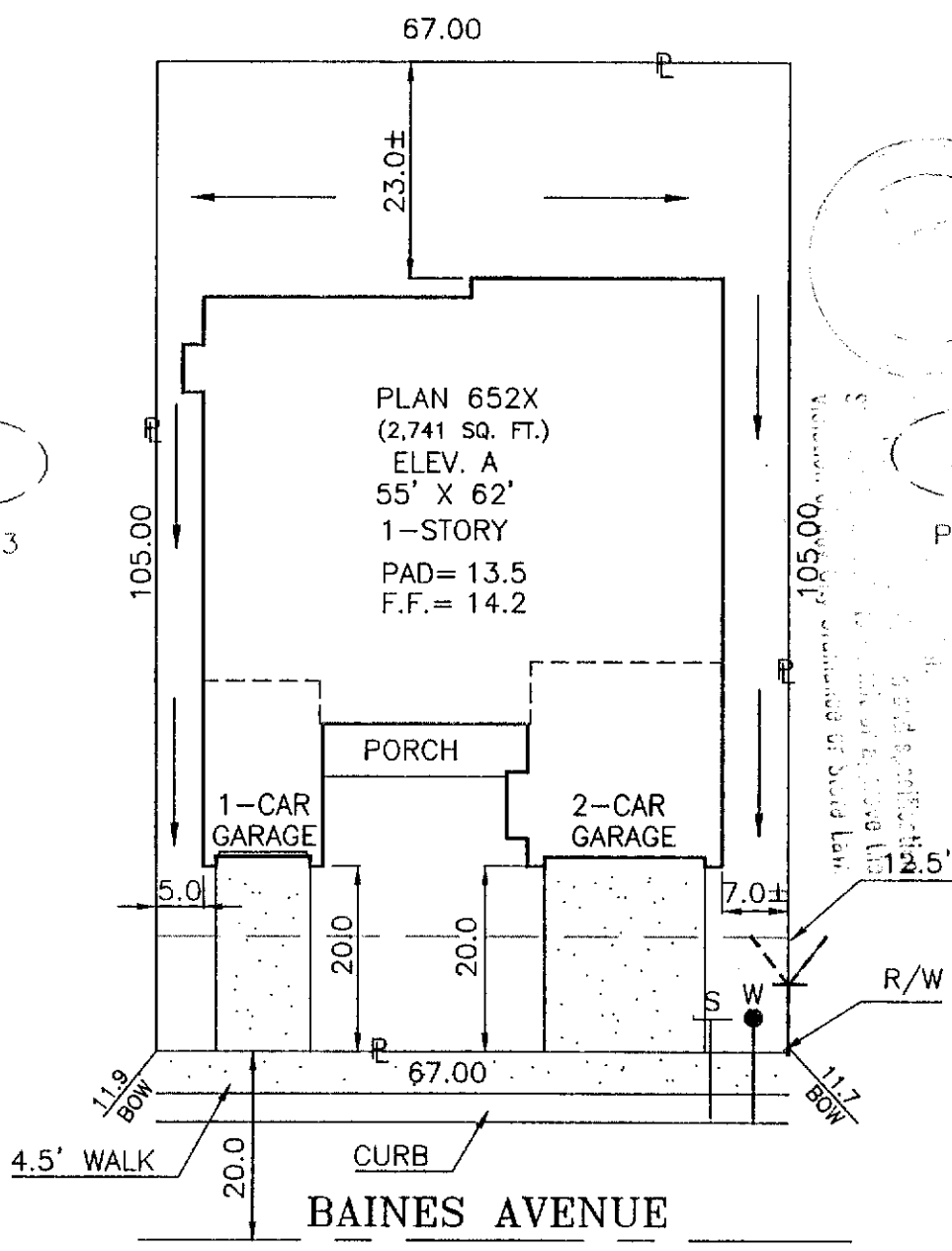

17  
P=13.5

105.00

12.5' P.U.E.

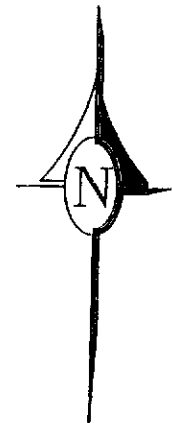

DIMENSIONS SHOWN ARE APPROXIMATE EXCEPT FOR MINIMUMS REQUIRED BY ORDINANCE.  
THIS PLOT DOES NOT REFLECT AS BUILT CONDITIONS AND MAY VARY FROM THIS PLAN.

<b>RENAISSANCE</b> <b>H O M E S</b> 2240 DOUGLAS BLVD. SUITE 250, ROSEVILLE, CALIFORNIA 95661 PHONE (916) 773-4083 FAX (916) 773-4086	SOMERSET		PLOT PLAN
	NORTHPOINTE PARK UNIT 12 CITY OF SACRAMENTO SACTO. COUNTY CALIFORNIA		NOTES:
ADDRESS: 1821 BAINES AVENUE	LOT COV: 43.0 %	APN:	LOT 18
PLAN NO.: 652X-A	LOT SQ. FT.: 7,035	REAR YARD COVERAGE: %	
DRAWN BY: R.P.	APPROVED BY:	DATE: 3/28/01 SCALE: 1"=20'	