

**CITY OF SACRAMENTO**  
1231 I Street, Sacramento, CA 95814

**Permit No: 0519929**

**Insp Area: 4**

**Thos Bros:**

**Sub-Type: NSFR**

**Housing (Y/N): N**

**Site Address: 300 SOARING HAWK WY SAC**

**Parcel No: TREASURE HOMES@ WILLOW CREEK LOT 21**

**CONTRACTOR**  
TREASURE HOMES  
1386 LEAD HILL BLVD. #300  
ROSEVILLE, CA. 95661

**OWNER**

**ARCHITECT**

**Nature of Work: MP 1591 2 STORY 6 ROOM SFR**

**CONSTRUCTION LENDING AGENCY:** I hereby affirm under penalty of perjury that there is a construction lending agency for the performance of the work for which this permit is issued (Sec. 3097, Civ. C).

Lender's Name \_\_\_\_\_ Lender's Address \_\_\_\_\_

**LICENSED CONTRACTORS DECLARATION:** I hereby affirm under penalty of perjury that I am licensed under provisions of Chapter 9 (commencing with section 7000) of Division 3 of the Business and Professions Code and my license is in full force and effect.

License Class \_\_\_\_\_ License Number 770778 Date 1/9/06 Contractor Signature Jane Hausley

**OWNER-BUILDER DECLARATION:** I hereby affirm under penalty of perjury that I am exempt from the contractors License Law for the following reason (Sec. 7031.5, Business and Professions Code; any city or county which requires a permit to construct, alter, improve, demolish, or repair any structure, prior to its issuance, also requires the applicant for such permit to file a signed statement that he or she is licensed pursuant to the provisions of the Contractors License Law (Chapter 9 (commencing with Section 7000) of Division 8 of the Business and Professions Code) or that he or she is exempt therefrom and the basis for the alleged exemption. Any violation of Section 7031.5 by any applicant for a permit subjects the applicant to a civil penalty of not more than five hundred dollars (\$500.00);

I, as a owner of the property, or my employees with wages as their sole compensation, will do the work, and the structure is not intended or offered for sale (Sec. 7044, Business and Professional Code: The Contractors License Law does not apply to an owner of property who builds or improves thereon, and who does such work himself or herself or through his/her own employees, provided that such improvements are not intended or offered for sale. If, however, the building or improvement is sold within one year of completion, the owner-builder will have the burden of proving that he/she did not build or improve for the purpose of sale.)

I, as owner of the property, am exclusively contracting with licensed contractors to construct the project (Sec. 7044, Business and Professions Code: The Contractors License Law does not apply to an owner of property who builds or improves thereon, and who contracts for such projects with a contractor(s) licensed pursuant to the Contractors License Law).

I am exempt under Sec. \_\_\_\_\_ B & PC for this reason: \_\_\_\_\_

Date 1/9/06 Owner Signature Jane Hausley

**IN ISSUING THIS BUILDING PERMIT,** the applicant represents, and the city relies on the representation of the applicant, that the applicant verified all measurements and locations shown on the application or accompanying drawings and that the improvement to be constructed does not violate any law or private agreement relating to permissible or prohibited locations for such improvements. This building permit does not authorize any illegal location of any improvement or the violation of any private agreement relating to location of improvements.

I certify that I have read this application and state that all information is correct. I agree to comply with all city and county ordinances and state laws relating to building construction and hereby authorize representative(s) of this city to enter upon the abovementioned property for inspection purposes.

Date \_\_\_\_\_ Applicant/Agent Signature \_\_\_\_\_

**WORKER'S COMPENSATION DECLARATION:** I hereby affirm under penalty of perjury one of the following declarations:

I have and will maintain a certificate of consent to self-insure for workers' compensation as provided for by Section 3700 of the Labor Code, for the performance of work for which the permit is issued.

I have and will maintain workers' compensation insurance, as required by Section 3700 of the Labor Code, for the performance of the work for which this permit is issued. My workers' compensation insurance carrier and policy number are:

Carrier STATE FUND Policy Number 1579166-2005 Exp Date 02/01/2006

(This section need not be completed if the permit is for \$100 or less) I certify that in the performance of the work for which this permit is issued, I shall not employ any person in any manner so as to become subject to the workers' compensation laws of California and agree that if I should become subject to the workers' compensation provisions of Section 3700 of the Labor Code, I shall forthwith comply with those provisions.

Date 1/9/06 Applicant Signature Jane Hausley

**WARNING:** FAILURE TO SECURE WORKER'S COMPENSATION COVERAGE IS UNLAWFUL AND SHALL SUBJECT AN EMPLOYER TO CRIMINAL PENALTIES AND CIVIL FINES UP TO ONE HUNDRED THOUSAND DOLLARS (\$100,000) IN ADDITION TO THE COST OF COMPENSATION, DAMAGES AS PROVIDED FOR IN SECTION 3706 OF THE LABOR CODE, INTEREST AND ATTORNEY'S FEE.

**THIS PERMIT SHALL EXPIRE BY LIMITATION IF WORK IS NOT COMMENCED WITHIN 180 DAYS.**

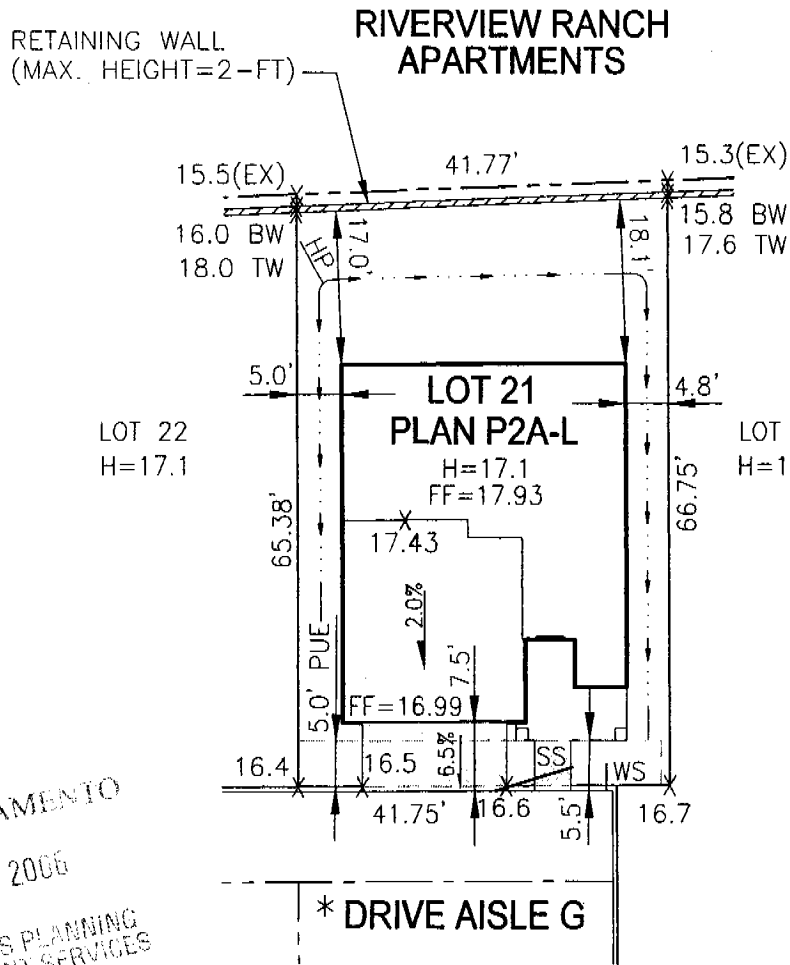

This set of plans and specifications must be kept on the job at all times and it is unlawful to make any changes or alterations from the original plans without the approval of the City Engineer. The City Engineer's approval shall NOT be held to approve the violation of any City Ordinance or State Law.

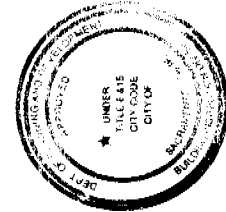

PAID  
CITY OF SACRAMENTO  
JAN 09 2006  
NEIGHBORHOODS PLANNING  
AND DEVELOPMENT SERVICES

A.P.N.:  
ADDRESS: 300 SOARING HAWK LANE  
REDUCED HOUSE AREA: 1191 SF  
LOT AREA: 2,758 SF  
LOT COVERAGE: 43.18%

\* REFER TO CIVIL IMPROVEMENT  
PLANS—NOT AN ACTUAL STREET NAME.  
NOTE:  
YARD SWALES SHALL BE  
AT 1.0% MINIMUM.

LEGEND:		SEWER SERVICE	SS	LIP OF GUTTER	LIP	TOP BACK CURB	TBC
YARD SWALE		WATER SERVICE	WS	DRIVEWAY/WALKWAY		TOP BACK WALK	TBW
SOUND WALL		FIRE HYDRANT		SLOPE		RIGHT OF WAY	R/W
FENCE		HOUSE PAD ELEV.	H=13.4	PATIO AREA		HIGH POINT	HP
DRAIN INLET	DI	FINISH FLOOR ELEV.	FF=14.2			FINISHED ELEV.	15.5 X



**Stantec**

**NOTE:**  
The information on this plot plan is for reference with respect to the general location of the proposed building on the lot. This plot plan is not to be used for staking the house location. The accuracy of the plot plan is not guaranteed. Dimensions are approximate and may change without notice. Stantec accepts no liability for staking errors caused due to using this plot plan for staking purposes.

Client/Project  
TREASURE HOMES  
AT WILLOWCREEK  
CITY OF SACRAMENTO, CA

Title  
**LOT 21  
PLAN P2A-L**  
DEC 2005  
1844 38302