

CITY OF SACRAMENTO

Permit No: 0110948

1231 I Street, Sacramento, CA 95814

Insp Area: 4

Site Address: 401 AVIATOR CR SAC

Thos Bros:

Parcel No: 225-1470-069

NORTHPOINTE PARK UNIT 6 LOT 69

Sub-Type:

NSFR

N

Housing (Y/N):

CONTRACTOR

WESTERN PACIFIC HOUSING
1210 CENTRAL BLVD
BRENTWOOD CA. 94513

OWNER

WESTERN PACIFIC HOUSING
1210 CENTRAL BLVD
BRENTWOOD CA 94513

ARCHITECT

Nature of Work: MP1741 1 STORY 6 ROOM SFR

CONSTRUCTION LENDING AGENCY : I hereby affirm under penalty of perjury that there is a construction lending agency for the performance of the work for which this permit is issued (Sec. 3097, Civ. C).

Lender's Name

Lender's Address

LICENSED CONTRACTORS DECLARATION: I hereby affirm under penalty of perjury that I am licensed under provisions of Chapter 9 (commencing with section 7000) of Division 3 of the Business and Professions Code and my license is in full force and effect.

License Class

B

License Number 675709

Date

8/29/01

Contractor Signature

D. Collins

OWNER-BUILDER DECLARATION: I hereby affirm under penalty of perjury that I am exempt from the contractors License Law for the following reason (Sec. 7031.5, Business and Professions Code; any city or county which requires a permit to construct, alter, improve, demolish, or repair any structure, prior to its issuance, also requires the applicant for such permit to file a signed statement that he or she is licensed pursuant to the provisions of the Contractors License Law (Chapter 9 (commencing with Section 7000) of Division 8 of the Business and Professions Code) or that he or she is exempt therefrom and the basis for the alleged exemption. Any violation of Section 7031.5 by any applicant for a permit subjects the applicant to a civil penalty of not more than five hundred dollars (\$500.00);

I, as a owner of the property, or my employees with wages as their sole compensation, will do the work, and the structure is not intended or offered for sale (Sec. 7044, Business and Professional Code: The Contractors License Law does not apply to an owner of property who builds or improves thereon, and who does such work himself or herself or through his/her own employees, provided that such improvements are not intended or offered for sale. If, however, the building or improvement is sold within one year of completion, the owner-builder will have the burden of proving that he/she did not build or improve for the purpose of sale.)

I, as owner of the property, am exclusively contracting with licensed contractors to construct the project (Sec. 7044, Business and Professions Code: The Contractors License Law does not apply to an owner of property who builds or improves thereon, and who contracts for such projects with a contractor(s) licensed pursuant to the Contractors License Law).

I am exempt under Sec. B & PC for this reason:

Date

Owner Signature

IN ISSUING THIS BUILDING PERMIT, the applicant represents, and the city relies on the representation of the applicant, that the applicant verified all measurements and locations shown on the application or accompanying drawings and that the improvement to be constructed does not violate any law or private agreement relating to permissible or prohibited locations for such improvements. This building permit does not authorize any illegal location of any improvement or the violation of any private agreement relating to location of improvements.

I certify that I have read this application and state that all information is correct. I agree to comply with all city and county ordinances and state laws relating to building construction and herby authorize representative(s) of this city to enter upon the above mentioned property for inspection purposes.

Date

8/29/01

Applicant/Agent Signature

D. Collins

WORKER'S COMPENSATION DECLARATION: I hereby affirm under penalty of perjury one of the following declarations:

I have and will maintain a certificate of consent to self-insure for workers' compensation as provided for by Section 3700 of the Labor Code, for the performance of work for which the permit is issued.

X I have and will maintain workers' compensation insurance, as required by Section 3700 of the Labor Code, for the performance of the work for which this permit is issued. My workers' compensation insurance carrier and policy number are:

Carrier

Policy Number

Exp Date

(This section need not be completed if the permit is for \$100 or less) I certify that in the performance of the work for which this permit is issued, I shall not employ any person in any manner so as to become subject to the workers' compensation laws of California and agree that if I should become subject to the workers' compensation provisions of Section 3700 of the Labor Code, I shall forthwith comply with those provisions.

Date

8/29/01

Applicant Signature

D. Collins

WARNING: FAILURE TO SECURE WORKER'S COMPENSATION COVERAGE IS UNLAWFUL AND SHALL SUBJECT AN EMPLOYER TO CRIMINAL PENALTIES AND CIVIL FINES UP TO ONE HUNDRED THOUSAND DOLLARS (\$100,000) IN ADDITION TO THE COST OF COMPENSATION, DAMAGES AS PROVIDED FOR IN SECTION 3706 OF THE LABOR CODE, INTEREST AND ATTORNEY'S FEE.

THIS PERMIT SHALL EXPIRE BY LIMITATION IF WORK IS NOT COMMENCED WITHIN 180 DAYS.

ADDITIONAL SUBDIVISION BUILDING PERMIT APPLICATION

Project Address: 401 Aviator Circle Assessor Parcel # 225-1470-069
Lot Number: 69 Subdivision Northpointe Park Unit # 6

OWNER INFORMATION:

Legal Property Owner: Western Pacific Housing Phone# (925) 634-6023
Owner Address: 1210 Central Boulevard; City Brentwood, State Ca. Zip 94513

CONTRACTOR INFORMATION:

Contractor: Western Pacific Lic# 075709/B Phone# (925) 634-6023 Fax 634-6166

PROJECT INFORMATION:

Land Use Zone RIA Occupancy Group R3 Construction Type VN Fed Code 1A
No. of Stories: 1 No. of Rooms: 4 Street Width: 40'
1st Floor Area 1741 2nd Floor Area _____ Basement _____ Roof Material _____

AREA IN SQUARE FOOT OF:

Dwelling/Living 1741
Garage/Storage 442
Decks/Balconies 55
Carports _____

SCOPE OF WORK: _____

- Information Above Complete
- Violation Files Checked
- Standard Setbacks
- County Sewer
- AR Flood Waiver Required
- Flood Elevation Certificate Required
- Water Development Infill Area
- Planning Approval
- Design Review Approval
- Special Fee Districts Apply:

THE FOLLOWING MUST BE PROVIDED IN ORDER TO SUBMIT FOR PERMIT

- 2 COMPLETE PLOT PLANS, LEGIBLE & DRAWN TO SCALE
- 11 X 17 COPY OF FLOOR PLAN WITH FOLLOWING INFORMATION:
 - a) Assessor's Parcel Number
 - b) New Floor Area
 - c) Owners Name
 - d) Project Address

0110948

Date:

Received by: (initials)

Permit #

11500718

CERTIFICATION OF INSULATION

WESTERN PACIFIC

LOT # 69

401 Aviator

SIENA

- P.O. BOX 154, WEST SACRAMENTO, CA 95831 LIC. #202026
- 1308 MELODY ROAD, MARYSVILLE, CA 95901 LIC. #202026
- P.O. BOX 9651, FRESNO, CA 93793-9651 LIC. #202026
- P.O. BOX 1631, RENO, NV 89506 LIC. #10675
- 3326 A PONDEROSA WAY, LAS VEGAS, NV 89118 LIC. #10675

DATE INSULATION COMPLETED
10-24-01

WALLS		WALLS		FLOORS	
(SQUARE FEET)		(SQUARE FEET)		(SQUARE FEET)	
MATERIAL FIBERGLASS		MATERIAL FIBERGLASS		MATERIAL FIBERGLASS	
FORM BATTS		FORM BATTS & BLOW		FORM BATTS	
MANUFACTURER'S PRODUCT I.D.		MANUFACTURER'S PRODUCT I.D.		MANUFACTURER'S PRODUCT I.D.	
OCF		OCF		OCF	
R-VALUE		APPLIED		APPLIED	
13	3 5/8"	30	9"		

MATERIAL FIBERGLASS	FORM BATTS	R-VALUE	MANUFACTURER OCF
-------------------------------	----------------------	---------	----------------------------

MATERIAL FOAM	MANUFACTURER W R GRACE
-------------------------	----------------------------------

SIGNATURE - INSULATION CONTRACTOR <i>Jeff Cable</i>	TITLE MANAGER	DATE 10-25-01
SIGNATURE - GENERAL CONTRACTOR	TITLE	DATE

REMARKS



BASALITE[®]
 PACIFIC STUCCO SYSTEMS

4290 Roseville Road
 North Highlands, CA 95660-5710
 (916) 486-4094
 Fax (916) 486-4187

Installation Card
 Fiber Reinforced Stucco

Job Name and Address : WESTERN PACIFIC

ICBO# 5269

SIENA

11-05-01
 Date of job completion
LOT-69

Plastering Contractor

Name: VISION PLASTERING

Address: 8974 GREEN BACH LN

Telephone No. () 987-9324

Approved contractor as issued by Basalite/Pacific Stucco.

This is to certify the exterior coating system at the above address, has been installed in accordance with the evaluation report specified above and the manufacturers instructions.

L. A. W. DeW
 Signature of authorized representative of
 plastering contractor

12-07-01
 Date

This installation card must be presented to the building inspector after completion of work and before final inspection.

LEGEND

- SWALE
- ☐ MAILBOX
- * STREET LIGHT
- * WOOD FENCE
- SIDEYARD GATE
- ⊕ TRANSFORMER
- SS SEWER SERVICE
- WS WATER SERVICE
- ◆ FIRE HYDRANT
- ☐ UTILITY SERVICE
- F.F. FINISH FLOOR
- ▨ DRAIN INLET

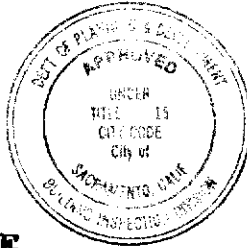
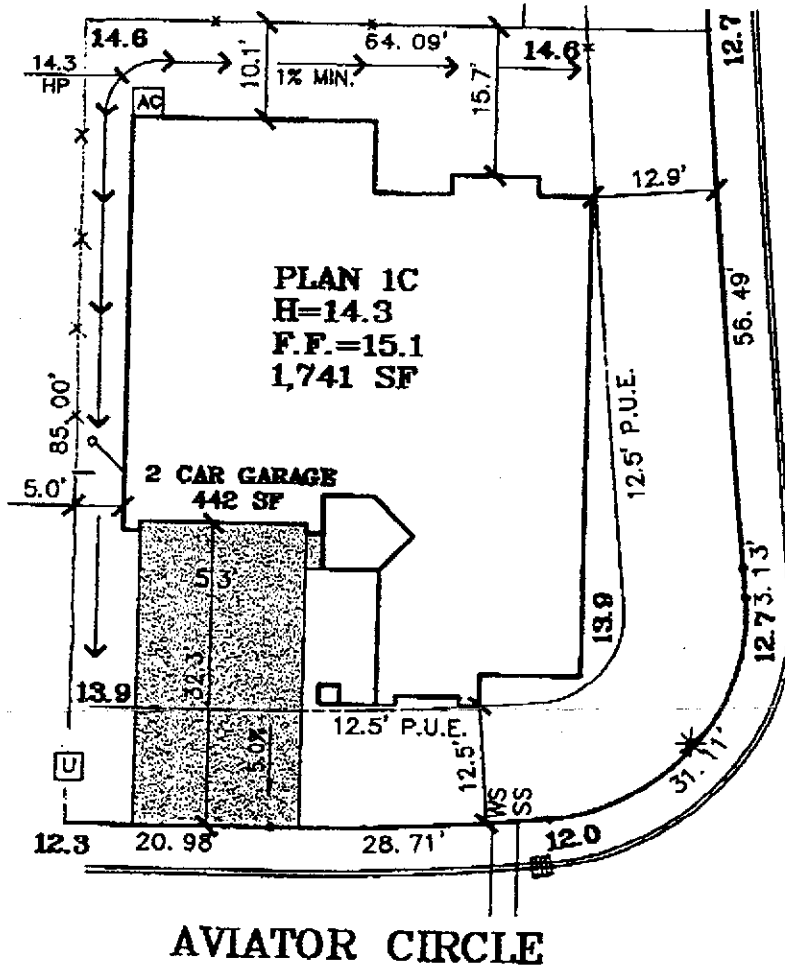

This set of plans and specifications must be kept on the job at all times and it is unlawful to make any changes or alterations from the same without written permission from the Building Inspection Division.

The approval of this plan and specification SHALL NOT be held to permit or approve the violation of any City Ordinance or State Law.

SCALE: 1" = 20'

LOT 69
PLAN 1C
A.P.N.:
ADDRESS: 401 AVIATOR CIRCLE
LOT AREA: 5,583 SF

TO THE UNIQUE CONDITIONS OF THIS LOT, THE BUYER AS WALKED AND APPROVED THE SITE. FINAL GRADING CONDITIONS MAY VARY. THE INFORMATION ON THIS PLAN IS PROVIDED FOR YOUR CONVENIENCE AS A GUIDE TO THE GENERAL LOCATION OF THE SUBJECT PROPERTY. THE ACCURACY OF THIS PLAN IS NOT GUARANTEED OR IS IT A PART OF ANY POLICY, REPORT OR GUARANTEE TO WHICH IT MAY BE ATTACHED. ACTUAL DIMENSIONS MAY VARY OR CHANGE WITHOUT PRIOR NOTICE DUE TO ACTUAL SITE CONDITIONS.

PLAN: 1
ELEVATION: C
ORIENTATION: L
COLOR: 169

SIGNED (BUYER) _____ DATE _____

Stantec Consulting Inc.
2590 Venture Oaks Way
Sacramento, CA 95833
Tel. 916.925.5550
Fax. 916.921.9274
www.stantec.com

Western Pacific Housing
1210 Central Boulevard
Brentwood, CA 94513
office: (925) 634-6023
fax: (925) 634-6083

SIENA
NORTHPOINTE PARK UNIT 6
City of Sacramento, California