

CITY OF SACRAMENTO

Permit No: 0108848

1231 I Street, Sacramento, CA 95814

Insp Area: 4

Site Address: 50 GOLDSTONE CR SAC

Sub-Type: NSFR

Parcel No: 225-1270-037

NATOMAS CROSS 17 LOT 19

Housing (Y/N): N

CONTRACTOR

BECK HOMES
3114 WEST HAMMER LANE
STOCKTON CA. 95209

OWNER

BECK PROPERTIES
3114 W HAMMER LN
STOCKTON CA 95209

ARCHITECT

Nature of Work: NSFR MP2634 2 STORY 10 RMS

CONSTRUCTION LENDING AGENCY : I hereby affirm under penalty of perjury that there is a construction lending agency for the performance of the work for which this permit is issued (Sec. 3097, Civ. C).

Lender's Name _____ Lender's Address _____

LICENSED CONTRACTORS DECLARATION: I hereby affirm under penalty of perjury that I am licensed under provisions of Chapter 9 (commencing with section 7000) of Division 3 of the Business and Professions Code and my license is in full force and effect.

License Class _____ License Number 478421 Date 10-19-01 Contractor Signature *Debi Tjorn*

OWNER-BUILDER DECLARATION: I hereby affirm under penalty of perjury that I am exempt from the contractors License Law for the following reason (Sec. 7031.5, Business and Professions Code; any city or county which requires a permit to construct, alter, improve, demolish, or repair any structure, prior to its issuance, also requires the applicant for such permit to file a signed statement that he or she is licensed pursuant to the provisions of the Contractors License Law (Chapter 9 (commencing with Section 7000) of Division 8 of the Business and Professions Code) or that he or she is exempt therefrom and the basis for the alleged exemption. Any violation of Section 7031.5 by any applicant for a permit subjects the applicant to a civil penalty of not more than five hundred dollars (\$500.00);

I, as a owner of the property, or my employees with wages as their sole compensation, will do the work, and the structure is not intended or offered for sale (Sec. 7044, Business and Professional Code: The Contractors License Law does not apply to an owner of property who builds or improves thereon, and who does such work himself or herself or through his/her own employees, provided that such improvements are not intended or offered for sale. If, however, the building or improvement is sold within one year of completion, the owner-builder will have the burden of proving that he/she did not build or improve for the purpose of sale.)

I, as owner of the property, am exclusively contracting with licensed contractors to construct the project (Sec. 7044, Business and Professions Code: The Contractors License Law does not apply to an owner of property who builds or improves thereon, and who contracts for such projects with a contractor(s) licensed pursuant to the Contractors License Law).

I am exempt under Sec. _____ B & PC for this reason: _____

Date _____ Owner Signature _____

IN ISSUING THIS BUILDING PERMIT, the applicant represents, and the city relies on the representation of the applicant, that the applicant verified all measurements and locations shown on the application or accompanying drawings and that the improvement to be constructed does not violate any law or private agreement relating to permissible or prohibited locations for such improvements. This building permit does not authorize any illegal location of any improvement or the violation of any private agreement relating to location of improvements.

I certify that I have read this application and state that all information is correct. I agree to comply with all city and county ordinances and state laws relating to building construction and hereby authorize representative(s) of this city to enter upon the abovementioned property for inspection purposes.

Date 10-19-01 Applicant/Agent Signature *Debi Tjorn*

WORKER'S COMPENSATION DECLARATION: I hereby affirm under penalty of perjury one of the following declarations:

I have and will maintain a certificate of consent to self-insure for workers' compensation as provided for by Section 3700 of the Labor Code, for the performance of work for which the permit is issued.

I have and will maintain workers' compensation insurance, as required by Section 3700 of the Labor Code, for the performance of the work for which this permit is issued. My workers' compensation insurance carrier and policy number are:

Carrier FREMONT COMPENSATION Policy Number WN99591990-06 Exp Date 07/29/2000

(This section need not be completed if the permit is for \$100 or less) I certify that in the performance of the work for which this permit is issued, I shall not employ any person in any manner so as to become subject to the workers' compensation laws of California and agree that if I should become subject to the workers' compensation provisions of Section 3700 of the Labor Code, I shall forthwith comply with those provisions.

Date 10-19-01 Applicant Signature *Debi Tjorn*

WARNING: FAILURE TO SECURE WORKER'S COMPENSATION COVERAGE IS UNLAWFUL AND SHALL SUBJECT AN EMPLOYER TO CRIMINAL PENALTIES AND CIVIL FINES UP TO ONE HUNDRED THOUSAND DOLLARS (\$100,000) IN ADDITION TO THE COST OF COMPENSATION, DAMAGES AS PROVIDED FOR IN SECTION 3706 OF THE LABOR CODE, INTEREST AND ATTORNEY'S FEE.

THIS PERMIT SHALL EXPIRE BY LIMITATION IF WORK IS NOT COMMENCED WITHIN 180 DAYS.



**INSULATION CONTRACTORS
ASSOCIATION
OF AMERICA**

INSULATION
CERTIFICATE

74064

1321 DUKE STREET, SUITE 303 • ALEXANDRIA, VA 22314 • (703) 739-0356

THIS IS TO CERTIFY THAT INSULATION HAS BEEN INSTALLED IN CONFORMANCE WITH CURRENT ENERGY REGULATIONS, CALIFORNIA ADMINISTRATIVE CODE, TITLE 24, STATE OF CALIFORNIA, IN THE BUILDING LOCATED AT:

Beck LOT # 19-3 TRACT # CRISTLE

STREET 50 Goodstone CITY SACRAMENTO

EXTERIOR WALLS:

MANUFACTURER ETC THICKNESS/TYPE 3 5/8 R- VALUE 15

CEILING:

BATTS: MANUFACTURER ETC THICKNESS/TYPE 12 R- VALUE 38

BLOWN IN: MANUFACTURER AT MINIMUM THICKNESS 14 3/4 R- VALUE 38

SQUARE FOOTAGE COVERED 1552 NUMBER OF BAGS USED 36

MANUFACTURER _____ THICKNESS/TYPE _____ R- VALUE _____

SLAB ON GRADE: MANUFACTURER _____ THICKNESS/TYPE _____ R- VALUE _____

WIDTH OF INSULATION _____ INCHES

FOUNDATION WALLS: MANUFACTURER _____ THICKNESS/TYPE _____ R- VALUE _____

GENERAL CONTRACTOR _____
CALIFORNIA CONTRACTORS LICENSE # _____

DATE _____

SIGNATURE _____ TITLE _____

INSULATION CONTRACTOR **ARCADE INSULATION**
CALIFORNIA CONTRACTORS LICENSE #263784

DATE 4-3-2

SIGNATURE [Signature] TITLE RYMAN

MP 2634

RESIDENTIAL BUILDING PERMIT APPLICATION

- New Construction
- Addition
- Remodels
- Other

Project Address: 60 Goldstone Circle Assessor Parcel # 226-1270-37

OWNER INFORMATION: Lot 19 2634-B

Legal Property Owner: Beck Properties Phone # 209-957-0331
 Owner Address: 3114 W. Hammer Ln. City Stockton State CA Zip 95209

CONTRACTOR INFORMATION:

Contractor: Beck Properties Lic. # 478421 Phone # 209-957-0331 Fax # 209-957-0368

PROJECT INFORMATION:

Land Use Zone _____ Occupancy Group _____ Construction Type _____ Fed Code _____
 No. of stories: 2 No. of rooms: 10 Street width: _____
 1st Floor Area 1368 2nd Floor Area _____ Basement _____ Roof Material _____

AREA IN SQUARE FOOT OF:

	EXISTING	NEW
Dwelling/Living	_____	<u>2634</u>
Garage/Storage	_____	<u>502</u>
Decks/Balconies	_____	<u>117</u>
Carports	_____	_____

SCOPE OF WORK:

FOR OFFICE USE ONLY

- Information above complete
- Violation files checked
- Standard setbacks
- County Sewer
- AR Flood Waiver required
- Flood Elevation Certificate Required
- Water Development Infill Area
- Planning Approval
- Design Review Approval
- Special Fee Districts Apply : _____

NEW STRUCTURES & ADDITIONS

❖ THE FOLLOWING MUST BE PROVIDED IN ORDER TO SUBMIT FOR PLAN REVIEW

- 2 COMPLETE PLANS, LEGIBLE & DRAWN TO SCALE
 - 3 SETS IF PROJECT IS IN A DESIGN REVIEW AREA
 - Title 24 Energy Compliance documentation
 - Grading and Erosion Control Questionnaire
 - 11" x 17" copy of floor plan for County Assessor
 - Plan Review Fees
- ❖ Plans to include: site plan, floor plan, elevations, roof/ceiling plan, foundation and structural framing details, and structural calculations for non-conforming structures.

Date: _____

Received by: (staff) _____

ACTIVITY/PERMIT # _____

This set of plan and specifications must be kept on the job at all times and it is unlawful to make any changes or alterations from the same without written permission from the Building Inspector Division.
 The approval of this plan and specification SHALL NOT be held to permit or approve the violation of any City Ordinance or State Law.

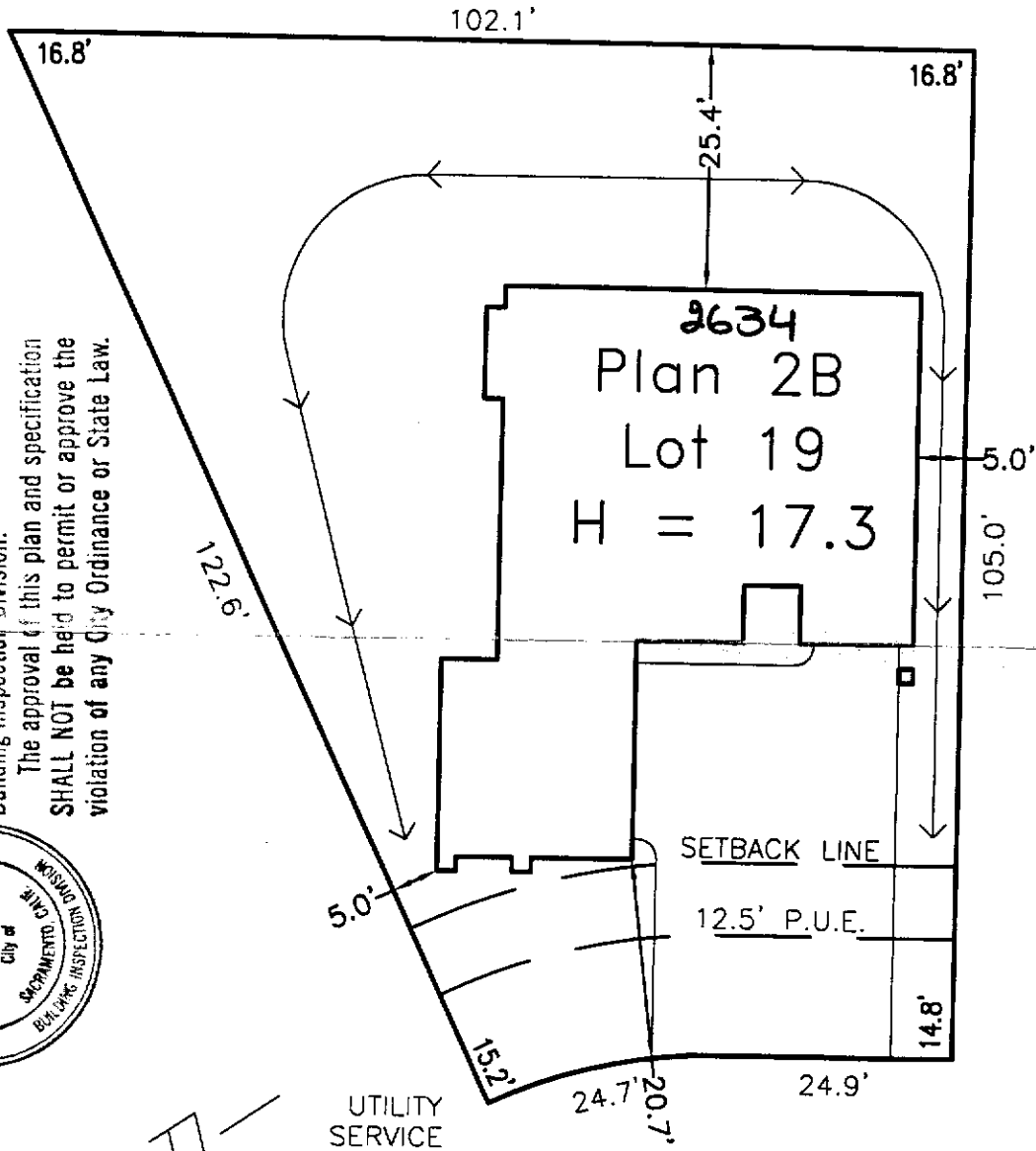
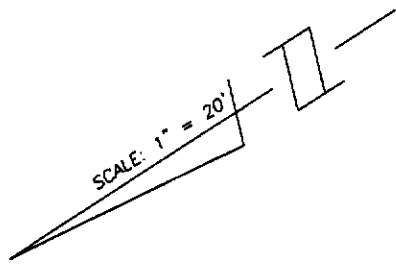
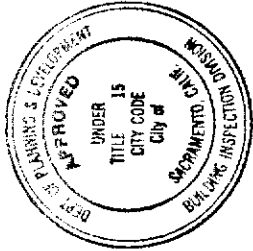

50 Goldstone Circle

SCALE: 1" = 20'

Natomas Crossing
 Village 17 L.F.
 City of Sacramento, CA
 Beck Properties

Natomas Crossing
 APN# 225-1270-37
 50 Goldstone Circle

**WECKER
 SURVEYS**

3740 MODOC PLACE
 DAVIS, CA 95616
 530-792-7252