

CITY OF SACRAMENTO

Permit No: 0109637

1231 I Street, Sacramento, CA 95814

Insp Area: 4

Site Address: 3320 CALLA LILY WY SAC

Sub-Type: NSFR

Parcel No: 274-0570-005

NATOMAS W 2 LOT 25

Housing (Y/N): N

CONTRACTOR

OWNER

ARCHITECT

KAUFMAN AND BROAD  
611 ORANGE DR  
VACAVILLE CA. 95687

Nature of Work: NSFR MP2318 2 STORY 10 RMS

CONSTRUCTION LENDING AGENCY: I hereby affirm under penalty of perjury that there is a construction lending agency for the performance of the work for which this permit is issued (Sec. 3097, Civ. C).

Lender's Name

Lender's Address

LICENSED CONTRACTORS DECLARATION: I hereby affirm under penalty of perjury that I am licensed under provisions of Chapter 9 (commencing with section 7000) of Division 3 of the Business and Professions Code and my license is in full force and effect.

License Class B

License Number 761970

Date 8/21/01

Contractor Signature

OWNER-BUILDER DECLARATION: I hereby affirm under penalty of perjury that I am exempt from the contractors License Law for the following reason (Sec. 7031.5, Business and Professions Code; any city or county which requires a permit to construct, alter, improve, demolish, or repair any structure, prior to its issuance, also requires the applicant for such permit to file a signed statement that he or she is licensed pursuant to the provisions of the Contractors License Law (Chapter 9 (commencing with Section 7000) of Division 8 of the Business and Professions Code) or that he or she is exempt therefrom and the basis for the alleged exemption. Any violation of Section 7031.5 by any applicant for a permit subjects the applicant to a civil penalty of not more than five hundred dollars (\$500.00);

I, as a owner of the property, or my employees with wages as their sole compensation, will do the work, and the structure is not intended or offered for sale (Sec. 7044, Business and Professional Code: The Contractors License Law does not apply to an owner of property who builds or improves thereon, and who does such work himself or herself or through his/her own employees, provided that such improvements are not intended or offered for sale. If, however, the building or improvement is sold within one year of completion, the owner-builder will have the burden of proving that he/she did not build or improve for the purpose of sale.)

I, as owner of the property, am exclusively contracting with licensed contractors to construct the project (Sec. 7044, Business and Professions Code: The Contractors License Law does not apply to an owner of property who builds or improves thereon, and who contracts for such projects with a contractor(s) licensed pursuant to the Contractors License Law).

I am exempt under Sec. B & PC for this reason:

Date

Owner Signature

IN ISSUING THIS BUILDING PERMIT, the applicant represents, and the city relies on the representation of the applicant, that the applicant verified all measurements and locations shown on the application or accompanying drawings and that the improvement to be constructed does not violate any law or private agreement relating to permissible or prohibited locations for such improvements. This building permit does not authorize any illegal location of any improvement or the violation of any private agreement relating to location of improvements.

I certify that I have read this application and state that all information is correct. I agree to comply with all city and county ordinances and state laws relating to building construction and hereby authorize representative(s) of this city to enter upon the above mentioned property for inspection purposes.

Date

8/21/01

Applicant/Agent Signature

WORKER'S COMPENSATION DECLARATION: I hereby affirm under penalty of perjury one of the following declarations:

I have and will maintain a certificate of consent to self-insure for workers' compensation as provided for by Section 3700 of the Labor Code, for the performance of work for which the permit is issued.

I have and will maintain workers' compensation insurance, as required by Section 3700 of the Labor Code, for the performance of the work for which this permit is issued. My workers' compensation insurance carrier and policy number are:

Carrier CONTINENTAL CAS. CO.

Policy Number WC188899094

Exp Date 05/01/2000

(This section need not be completed if the permit is for \$100 or less) I certify that in the performance of the work for which this permit is issued, I shall not employ any person in any manner so as to become subject to the workers' compensation laws of California and agree that if I should become subject to the workers' compensation provisions of Section 3700 of the Labor Code, I shall forthwith comply with those provisions.

Date

8/21/01

Applicant Signature

WARNING: FAILURE TO SECURE WORKER'S COMPENSATION COVERAGE IS UNLAWFUL AND SHALL SUBJECT AN EMPLOYER TO CRIMINAL PENALTIES AND CIVIL FINES UP TO ONE HUNDRED THOUSAND DOLLARS (\$100,000) IN ADDITION TO THE COST OF COMPENSATION, DAMAGES AS PROVIDED FOR IN SECTION 3706 OF THE LABOR CODE, INTEREST AND ATTORNEY'S FEE.

THIS PERMIT SHALL EXPIRE BY LIMITATION IF WORK IS NOT COMMENCED WITHIN 180 DAYS.

**RESIDENTIAL SUBDIVISION BUILDING PERMIT APPLICATION**

Project Address: 3320 Calla Lily way Assessor Parcel # 274-0570-005  
 Lot Number: 25 Subdivision Natomas West Village 1

**OWNER INFORMATION:**

Legal Property Owner: <u>KB Home</u>	Phone# <u>707-469-2464</u>
Owner Address: <u>611 Orange dr</u>	City <u>Vacaville</u> State <u>CA</u> Zip <u>95687</u>

**CONTRACTOR INFORMATION:**

Contractor: <u>KB Home</u>	Lic. # <u>761970</u>	Phone # <u>707-469-2464</u>	<u>469-2405</u>
----------------------------	----------------------	-----------------------------	-----------------

**PROJECT INFORMATION:**

Land Use Zone <u>RIA</u>	Occupancy Group <u>R3</u>	Construction Type <u>VN</u>	Fed Code <u>1A</u>
No. of Stories: <u>2</u>	No. of Rooms: _____	Street Width: _____	
1 <sup>st</sup> Floor Area <u>1054</u>	2 <sup>nd</sup> Floor Area <u>1264</u>	Basement _____	Roof Material _____

AREA IN SQUARE FOOT OF:

Dwelling/Living	<u>2318</u>
Garage/Storage	<u>380</u>
Decks/Balconies	<u>19</u>
Carports	_____

SCOPE OF WORK: New Single Family Dwelling

CITY OF SACRAMENTO  
 PERMIT ASSISTANCE  
 JUL 25 2001  
**RECEIVED**

FOR OFFICE USE ONLY

<input type="checkbox"/> Information Above Complete	<input type="checkbox"/> AR Flood Waiver Required	<input type="checkbox"/> Planning Approval
<input type="checkbox"/> Violation Files Checked	<input type="checkbox"/> Flood Elevation Certificate Required	<input type="checkbox"/> Design Review Approval
<input type="checkbox"/> Standard Setbacks	<input type="checkbox"/> Water Development Infill Area	<input type="checkbox"/> Special Fee Districts Apply:
<input type="checkbox"/> County Sewer	_____	

- THE FOLLOWING MUST BE PROVIDED IN ORDER TO SUBMIT FOR PERMIT -

2 COMPLETE PLOT PLANS, LEGIBLE & DRAWN TO SCALE

11 X 17 COPY OF FLOOR PLAN WITH FOLLOWING INFORMATION

a) Assessor's Parcel Number	c) Owners Name
b) New Floor Area	d) Project Address

# CERTIFICATION OF INSULATION

ADDRESS OR TRACT <b>KB HOMES</b>	LOT # <b>25</b>	SACRAMENTO INSULATION CONTRACTORS <input checked="" type="checkbox"/> P.O. BOX 854, WEST SACRAMENTO, CA 95691 LIC. #202026 <input type="checkbox"/> 1309 MELODY ROAD, MARYSVILLE, CA 95901 LIC. #202026 <input type="checkbox"/> P.O. BOX 9651, FRESNO, CA 93793-9651 LIC. #202026 <input type="checkbox"/> P.O. BOX 1631, RENO, NV 89505 LIC. #10675 <input type="checkbox"/> 3326 A PONDEROSA WAY, LAS VEGAS, NV 89118 LIC. #10675
CALIFORNIA GARDENS		DATE INSULATION COMPLETED

WALLS		CEILINGS			FLOORS	
( SQUARE FEET)		( SQUARE FEET)			( SQUARE FEET)	
TYPE OF INSULATION		TYPE OF INSULATION			TYPE OF INSULATION	
MATERIAL <b>FIBERGLASS</b>		MATERIAL <b>FIBERGLASS</b>			MATERIAL <b>FIBERGLASS</b>	
FORM <b>BATTS</b>		FORM <b>BATTS &amp; BLOW</b>			FORM <b>BATTS</b>	
MANUFACTURER'S PRODUCT I.D.		MANUFACTURER'S PRODUCT I.D.			MANUFACTURER'S PRODUCT I.D.	
MANUFACTURER		MANUFACTURER			MANUFACTURER	
<b>OCF</b>		<b>OCF</b>			<b>OCF</b>	
BAGS						
R-VALUE INSTALLED	APPLIED THICKNESS	R-VALUE INSTALLED	APPLIED THICKNESS	MIN. INSTALLED WEIGHT PER SQUARE FOOT	R-VALUE INSTALLED	APPLIED THICKNESS
<b>13</b>	<b>3 5/8"</b>	<b>38</b> <b>38</b>	<b>12 1/4"</b> <b>14 3/4"</b>			
KNEE WALLS IF R-VALUE IS OTHER THAN WALLS ABOVE						
MATERIAL <b>FIBERGLASS</b>		FORM <b>BATTS</b>		R VALUE		MANUFACTURER <b>OCF</b>
AIR INFILTRATION SEALANT						
MATERIAL <b>FOAM</b>				MANUFACTURER <b>W R GRACE</b>		

**THIS IS TO CERTIFY THAT INSULATION AND/OR SEALANT HAS BEEN INSTALLED IN CONFORMANCE WITH APPLICABLE CODES, MATERIAL STANDARDS AND REGULATIONS.**

SIGNATURE - INSULATION CONTRACTOR <i>[Signature]</i>	TITLE MANAGER	DATE <b>2/14/02</b>
SIGNATURE - GENERAL CONTRACTOR	TITLE	DATE

REMARKS:



**WALLACE - KUHL & ASSOCIATES INC.**  
 GEOTECHNICAL ENGINEERING • CONSTRUCTION TESTING

3050 Industrial Blvd.  
 PO Box 1137  
 West Sacramento  
 California 95691  
 916-372-1434

DATE	1/16/02		JOB NO.	349415		WEATHER			TEMP.	° at	AM
PROJECT	Cal Gardens / K+B					Technician I	<input type="checkbox"/>	Staff E/G	<input type="checkbox"/>		
LOCATION	Natomas					Technician II	<input type="checkbox"/>	Project E/G	<input type="checkbox"/>		
TYPE OF WORK	Epoxy anchor bolts					Technician III	<input type="checkbox"/>	Senior E/G	<input type="checkbox"/>		
Inside 50 mi. radius	<input type="checkbox"/>	Outside 50 mi. radius	<input type="checkbox"/>			Nuclear Densities	<input type="checkbox"/>	Principal E/G	<input type="checkbox"/>		
PERSONNEL	REG. HRS	OT HRS	TOTAL HRS	TRAVEL	ON JOB	VEHICLE		MILES			
JH						#18					

**OBSERVATIONS:** Observed epoxy bond installation of 5/8" anchor bolts. In minimum embedment of 7 1/2" anchor bolt. The minimum embedment of 7 1/2" All holes were blown out with compressed air, brushed out by hand then bl. out again. Snapson Set 22 Epoxy adhesion was used to manufacturer's instructions. Exp date 7/03.

Lot #25 - 5/8" a.b. - each, 7/8" a.b. 1 each

Lot #26 - 7/8" a.b. - 2 each

Lot #29 - 7/8" a.b. - 1 each

Lot #54 - 5/8" a.b. - 1 each

**FIELD REPORT**

Signed Dawn Bleeker

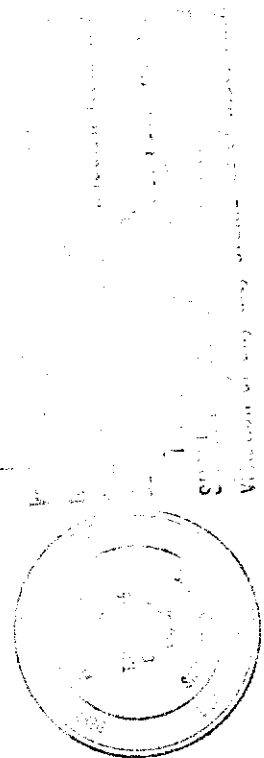
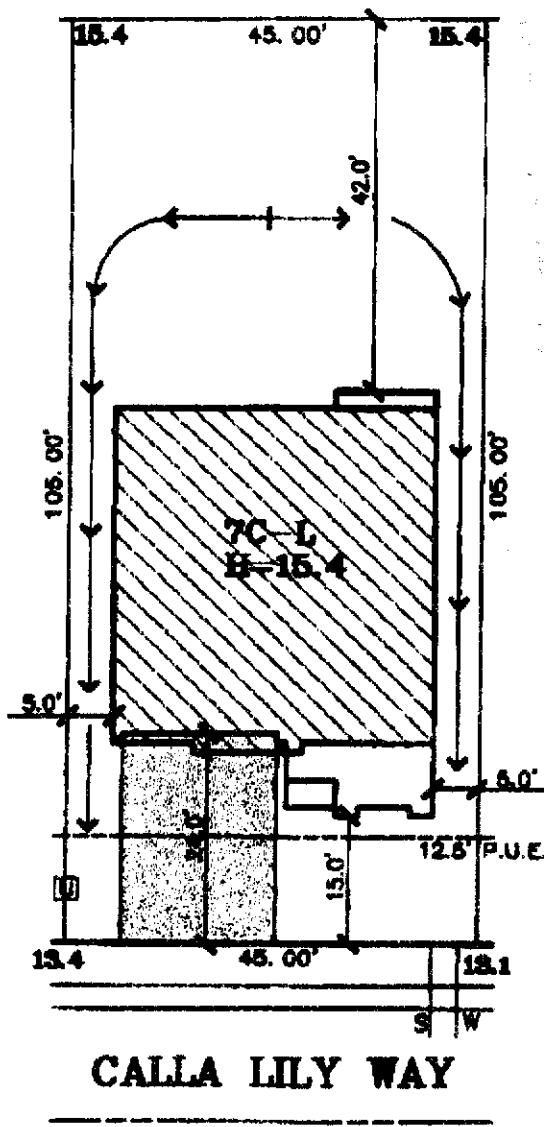

CALLA LILY WAY



DATE: 6-19-01  
 A.P.N.: 274-0570-005  
 ADDRESS: 3320 CALLA LILY WAY

LOT AREA: 4,725 SF  
 LOT COVERAGE: 31%

**Stantec**

Stantec Consulting Inc.  
 2590 Venture Oaks Way  
 Sacramento, CA 95833-3288  
 Tel. 916.925.5550  
 Fax. 916.921.8274  
 www.stantec.com

**NATOMAS WEST  
 VILLAGE 2**  
 LOT 26  
 PLAN 7C

**CALIFORNIA GARDENS**  
 CITY OF SACRAMENTO, CA  
 CLIENT: KAUFMAN & BROAD

5-2001/03/07/013