

CITY OF SACRAMENTO
1231 I Street, Sacramento, CA 95814

Permit No: 0317004
Insp Area: 2
Thos Bros: 337-D4

Site Address: 7858 19TH ST SAC
Parcel No: MEADOWVIEW ESTATES UNIT 2 LOT 85

Sub-Type: NSFR
Housing (Y/N): N

CONTRACTOR
JTS COMMUNITIES
401 WATT AV.
SACRAMENTO CA. 95864

OWNER

ARCHITECT

Nature of Work: MP 1800 1 STORY 9 ROOM SFR

CONSTRUCTION LENDING AGENCY : I hereby affirm under penalty of perjury that there is a construction lending agency for the performance of the work for which this permit is issued (Sec. 3097, Civ. C).

Lender's Name _____ Lender's Address _____

LICENSED CONTRACTORS DECLARATION: I hereby affirm under penalty of perjury that I am licensed under provisions of Chapter 9 (commencing with section 7000) of Division 3 of the Business and Professions Code and my license is in full force and effect.

License Class B License Number 767107 Date 11/06/03 Contractor Signature Rona J. Caldwell

OWNER-BUILDER DECLARATION: I hereby affirm under penalty of perjury that I am exempt from the contractors License Law for the following reason (Sec. 7031.5, Business and Professions Code; any city or county which requires a permit to construct, alter, improve, demolish, or repair any structure, prior to its issuance, also requires the applicant for such permit to file a signed statement that he or she is licensed pursuant to the provisions of the Contractors License Law (Chapter 9 (commencing with Section 7000) of Division 8 of the Business and Professions Code) or that he or she is exempt therefrom and the basis for the alleged exemption. Any violation of Section 7031.5 by any applicant for a permit subjects the applicant to a civil penalty of not more than five hundred dollars (\$500.00);

____ I, as a owner of the property, or my employees with wages as their sole compensation, will do the work, and the structure is not intended or offered for sale (Sec. 7044, Business and Professional Code: The Contractors License Law does not apply to an owner of property who builds or improves thereon, and who does such work himself or herself or through his/her own employees, provided that such improvements are not intended or offered for sale. If, however, the building or improvement is sold within one year of completion, the owner-builder will have the burden of proving that he/she did not build or improve for the purpose of sale.)

____ I, as owner of the property, am exclusively contracting with licensed contractors to construct the project (Sec. 7044, Business and Professions Code: The Contractors License Law does not apply to an owner of property who builds or improves thereon, and who contracts for such projects with a contractor(s) licensed pursuant to the Contractors License Law).

____ I am exempt under Sec. _____ B & PC for this reason: _____
Date _____ Owner Signature _____

PAID
CITY OF SACRAMENTO
NOV 06 2003
NORTH PERMIT
DIVISION

IN ISSUING THIS BUILDING PERMIT, the applicant represents, and the city relies on the representation of the applicant, that the applicant verified all measurements and locations shown on the application or accompanying drawings and that the improvement to be constructed does not violate any law or private agreement relating to permissible or prohibited locations for such improvements. This building permit does not authorize any illegal location of any improvement or the violation of any private agreement relating to location of improvements.

I certify that I have read this application and state that all information is correct. I agree to comply with all city and county ordinances and state laws relating to building construction and herby authorize representative(s) of this city to enter upon the abovementioned property for inspection purposes.

Date 11/06/03 Applicant/Agent Signature Rona J. Caldwell

WORKER'S COMPENSATION DECLARATION: I hereby affirm under penalty of perjury one of the following declarations:

____ I have and will maintain a certificate of consent to self-insure for workers' compensation as provided for by Section 3700 of the Labor Code, for the performance of work for which the permit is issued.

I have and will maintain workers' compensation insurance, as required by Section 3700 of the Labor Code, for the performance of the work for which this permit is issued. My workers' compensation insurance carrier and policy number are:

Carrier ZURICH INSURANCE CO Policy Number WC367556101 Exp Date 11/18/2003

____ (This section need not be completed if the permit is for \$100 or less) I certify that in the performance of the work for which this permit is issued, I shall not employ any person in any manner so as to become subject to the workers' compensation laws of California and agree that if I should become subject to the workers' compensation provisions of Section 3700 of the Labor Code, I shall forthwith comply with those provisions.

Date 11/06/03 Applicant Signature Rona J. Caldwell

WARNING: FAILURE TO SECURE WORKER'S COMPENSATION COVERAGE IS UNLAWFUL AND SHALL SUBJECT AN EMPLOYER TO CRIMINAL PENALTIES AND CIVIL FINES UP TO ONE HUNDRED THOUSAND DOLLARS (\$100,000) IN ADDITION TO THE COST OF COMPENSATION, DAMAGES AS PROVIDED FOR IN SECTION 3706 OF THE LABOR CODE, INTEREST AND ATTORNEY'S FEE.

THIS PERMIT SHALL EXPIRE BY LIMITATION IF WORK IS NOT COMMENCED WITHIN 180 DAYS.

TRANSFORMER
(LOCATION MAY VARY)

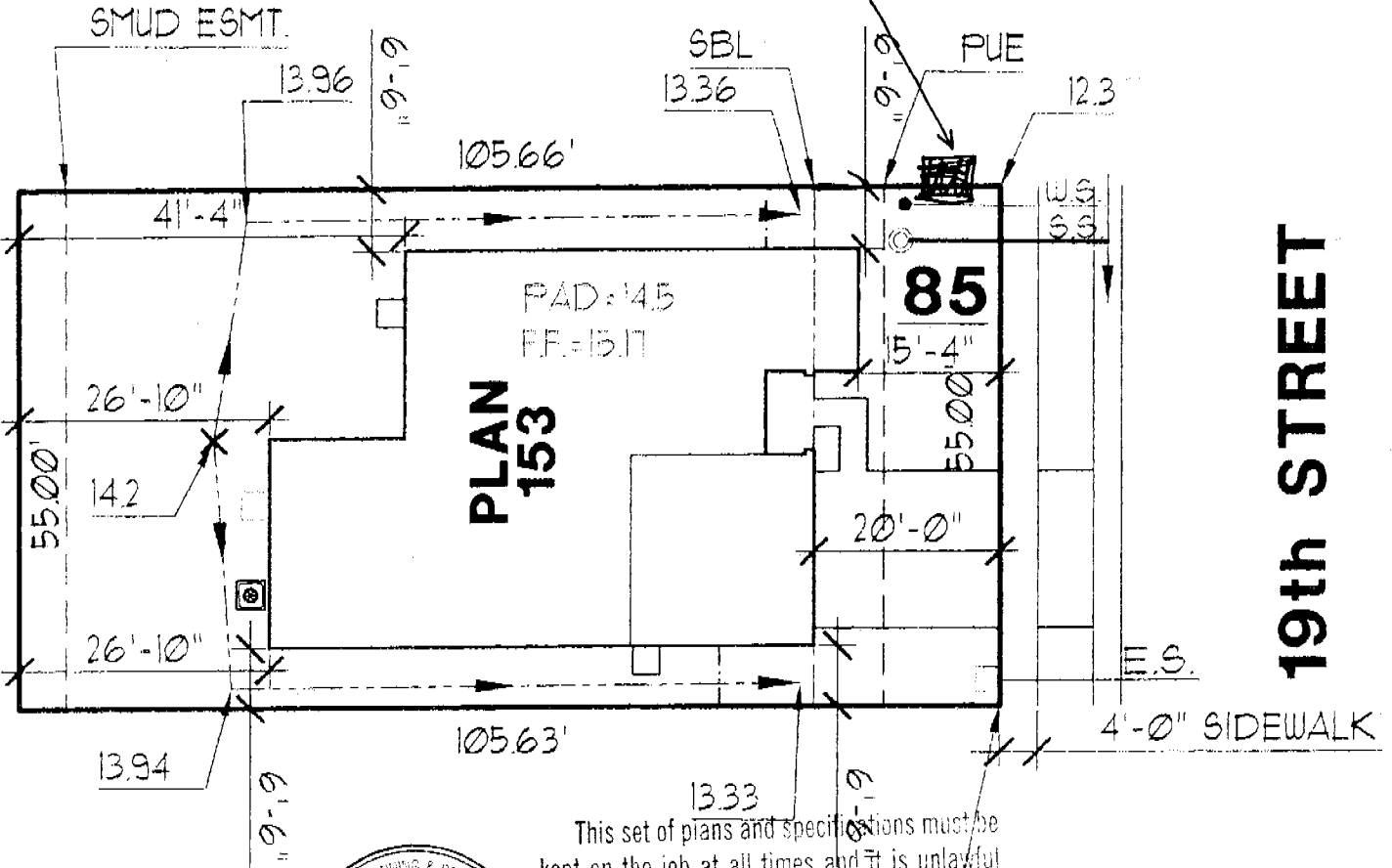

19th STREET

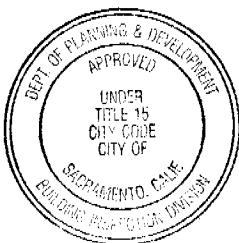

This set of plans and specifications must be kept on the job at all times and it is unlawful to make any changes or alterations from the same without written permission from the Building Inspection Division.

The approval of this plan and specification SHALL NOT be held to permit or approve the violation of any City Ordinance or State Law.

MP1800

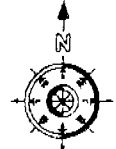

DIMENSIONS SHOWN ARE APPROXIMATE AND ARE FOR THE SOLE PURPOSE OF COUNTY/CITY APPROVAL. ADDITIONAL INFORMATION REFLECTED ON THIS DOCUMENT SUCH AS FENCE, WALL, UTILITY, AND MAILBOX LOCATIONS ARE SUBJECT TO CHANGE WITHOUT NOTIFICATION TO BUYER. THIS PLOT PLAN MAY NOT REFLECT ALL "AS BUILT" CONDITIONS WHICH MIGHT VARY FROM THIS PROPOSED PLOT PLAN.

<p>1 STORY HOUSE 2 CAR GARAGE</p>	<p>PROPOSED SITE PLAN</p>	<p>JTS Working Together to Achieve Excellence COMMUNITIES INC. 401 Watt Avenue Sacramento, CA 95821 (916) 487-3434</p>	<p>MEADOWVIEW ESTATES</p>
<p>APN # APPROVED FOR RELEASE</p>	<p>DATE</p>	<p>APPROVED FOR RELEASE</p>	<p>SCALE = 1" = 20' DATE: AUG. 20, 2003 DATE</p>



Planning and Building Department
Building Division

CITY OF SACRAMENTO
CALIFORNIA

Downtown Permits Center
1231 I Street, #200
Sacramento, CA 95814-2998

North Permits Center
2101 Arena Blvd., Suite 200
Sacramento, CA 95834

ADDRESS 7858 19TH ST PERMIT NO. 0317004

INSPECTION COMMENTS	PERMIT DOCUMENTS
12-15-03 B17 CV B-26 CV DEL	
12-17-03 Ref + SHEET OF HUB	
12-23-03 B-81 - CIV. & DRAINAGE	
12-24-03 B-81 - P.A.C. -	
12-26-03 Fox. EDC.	
11-07-03 AP B10, 11 & P40	M/S
11-19-03 AP B12, 262-M/D	
2-5-04 AP P47 C/N E67	LAWS
2-6-04 AP Temp FWP CDG	
2/24/04 CIVIL & CW Final	
2-1-04 Final / AP EDC.	

FINAL APPROVALS	
BUILDING	
ELECTRICAL	
PLUMBING	
MECHANICAL	
FIRE	
SITE	

CERTIFICATION OF INSULATION

ADDRESS OR TRACT JTS Comm Premier @ Meadowview Sac CA LOT # 85	SACRAMENTO BUILDING PRODUCTS <input checked="" type="checkbox"/> P.O. BOX 854, WEST SACRAMENTO, CA 95691 LIC. #202026 <input type="checkbox"/> 1309 MELODY ROAD, MARYSVILLE, CA 95901 LIC. #202026 <input type="checkbox"/> P.O. BOX 9651, FRESNO, CA 93793-9651 LIC. #202026 <input type="checkbox"/> P.O. BOX 1631, RENO, NV 89505 LIC. #10675 <input type="checkbox"/> 3326 A PONDEROSA WAY, LAS VEGAS, NV 89118 LIC. #10675 DATE INSULATION COMPLETED
---	--

WALLS				CEILING			FLOORS				
SQUARE FEET				SQUARE FEET			SQUARE FEET				
TYPE OF INSULATION				TYPE OF INSULATION			TYPE OF INSULATION				
MATERIAL FIBERGLASS				MATERIAL FIBERGLASS			MATERIAL FIBERGLASS				
FORM BATTS				FORM BATTS & BLOW			FORM BATTS				
MANUFACTURER'S PRODUCT I.D.				MANUFACTURER'S PRODUCT I.D.			MANUFACTURER'S PRODUCT I.D.				
MANUFACTURER				MANUFACTURER			MANUFACTURER				
CT	OC	JM	CT	OC	JM	CT	OC	JM			
R - VALUE INSTALLED			APPLIED THICKNESS			R - VALUE INSTALLED			APPLIED THICKNESS		
13			3 1/2"			30			9"		
14			5 1/2"			12"			-		
KNEE WALLS IF R-VALUE IS OTHER THAN WALLS ABOVE											
MATERIAL FIBERGLASS			FORM BATTS			R VALUE			MANUFACTURER		
									CT OC JM		
AIR INFILTRATION SEALANT											
MATERIAL						MANUFACTURER					
Foam						HILTI			HANDY FOAM		

THIS IS TO CERTIFY THAT INSULATION AND/OR SEALANT HAS BEEN INSTALLED IN CONFORMANCE WITH APPLICABLE CODES, MATERIAL STANDARDS AND REGULATIONS.

SIGNATURE — INSULATION CONTRACTOR	TITLE	DATE
J.C.	MANAGER	12/10/03
SIGNATURE — GENERAL CONTRACTOR	TITLE	DATE

REMARKS

INSTALLATION CARD
Diamond Wall One Coat System
Omega Products International, Inc.

Project Address

ICBO Evaluation Service, Inc.
Report ER-4004

7858 19th St
Scoto Ca

Date Completed 1-20-04

Plastering Contractor

Name: J.T.S Stucco Div.
Address: 11285 White Rock Road
Telephone No. (916) 635-2800

Approved contractor number as issued by Omega Products Int'l, Inc. P.N. # 2227

This is to certify that the exterior coating system on the building exterior at the above address has been installed in accordance with the evaluation report and the manufacturer's instructions.

Don Ricketts
Signature of authorized representative of plastering contractor

Date _____

This installation card must be presented to the building inspector after completion of work and before final inspection.

This installation card must be presented to the building inspector after completion of work and before final inspection.

Plastering Contractor
Name: J.T.S Stucco Div.
Address: 11285 White Rock Road
Telephone No. (916) 635-2800
Approved contractor number as issued by Omega Products Int'l, Inc. P.N. # 2227
This is to certify that the exterior coating system on the building exterior at the above address has been installed in accordance with the evaluation report and the manufacturer's instructions.

Signature of authorized representative of plastering contractor
Don Ricketts
Date _____

Project Address
7858 19th St
Scoto Ca 95222
Date Completed 1-20-04

ICBO Evaluation Service, Inc.
Report ER-4004

Omega Products International, Inc.
Diamond Wall One Coat System

INSTALLATION CARD

RESIDENTIAL SUBDIVISION BUILDING PERMIT APPLICATION

(MOTHER APN)

Project Address: 7858 19th
 Lot Number: 85

Assessor Parcel # 052-0010-033
 Subdivision MEADOWVIEW ESTATES UNIT #2

OWNER INFORMATION:

Legal Property Owner: JTS Communities, Inc. Phone# 487-3434
 Owner Address: 401 WATT AVE. City Sacto State CA Zip 95864

CONTRACTOR INFORMATION:

Contractor: JTS Communities Lic. # 767107 Phone # 487-3434 Fax 487-3815

PROJECT INFORMATION:

Land Use Zone R1A Occupancy Group R3 Construction Type VN Fed Code 1A
 No. of Stories: 1 No. of Rooms: _____ Street Width: _____
 1st Floor Area 1800 2nd Floor Area 0 Basement _____ Roof Material _____

AREA IN SQUARE FOOT OF:

Dwelling/Living 1,800
 Garage/Storage 390
 Decks/Balconies _____
 Carports _____

SCOPE OF WORK: New SFD Plan: 153

FOR OFFICE USE ONLY

- Information Above Complete
- Violation Files Checked
- Standard Setbacks
- County Sewer
- AR Flood Waiver Required
- Flood Elevation Certificate Required
- Water Development Infill Area
- Planning Approval
- Design Review Approval
- Special Fee Districts Apply:

•THE FOLLOWING MUST BE PROVIDED IN ORDER TO SUBMIT FOR PERMIT•

- 2 COMPLETE PLOT PLANS, LEGIBLE & DRAWN TO SCALE
- 11 X 17 COPY OF FLOOR PLAN WITH FOLLOWING INFORMATION
 - a) Assessor's Parcel Number
 - b) New Floor Area
 - c) Owners Name
 - d) Project Address