

CITY OF SACRAMENTO
1231 T Street, Sacramento, CA 95814

Permit No: 0106688
Insp Area: 1

Site Address: 1226 P ST SAC
Parcel No: 006-0281-034 CAPITOL PK HOMES LOT 5

Sub-Type: NSFR
Housing (Y/N): N

CONTRACTOR
CAPITOL PARK HOMES
818 19TH ST STE 200
SACRAMENTO CA 95814

OWNER
STATE OF CALIFORNIA
800 Q STREET
SACRAMENTO CA 95814

ARCHITECT

Nature of Work: MP 1448 3 STORY 7 ROOM SFR

CONSTRUCTION LENDING AGENCY: I hereby affirm under penalty of perjury that there is a construction lending agency for the performance of the work for which this permit is issued (Sec. 8097, Civ. C.)

Lender's Name _____ Lender's Address _____

LICENSED CONTRACTORS DECLARATION: I hereby affirm under penalty of perjury that I am licensed under provisions of Chapter 9 (commencing with section 7000) of Division 3 of the Business and Professions Code and my license is in full force and effect.

License Class B License Number 767087 Date 7-10-01 Contractor Signature [Signature]

OWNER-BUILDER DECLARATION: I hereby affirm under penalty of perjury that I am exempt from the contractors License Law for the following reason (Sec. 7031.5, Business and Professions Code; any city or county which requires a permit to construct, alter, improve, demolish, or repair any structure, prior to its issuance, also requires the applicant for such permit to file a signed statement that he or she is licensed pursuant to the provisions of the Contractors License Law (Chapter 9 (commencing with Section 7000) of Division 8 of the Business and Professions Code) or that he or she is exempt therefrom and the basis for the alleged exemption. Any violation of Section 7031.5 by any applicant for a permit subjects the applicant to a civil penalty of not more than five hundred dollars (\$500.00).

I, as a owner of the property, or my employees with wages as their sole compensation, will do the work, and the structure is not intended or offered for sale (Sec. 7044, Business and Professional Code: The Contractors License Law does not apply to an owner of property who builds or improves thereon, and who does such work himself or herself or through his/her own employees, provided that such improvements are not intended or offered for sale. If, however, the building or improvement is sold within one year of completion, the owner-builder will have the burden of proving that he/she did not build or improve for the purpose of sale.)

I, as owner of the property, am exclusively contracting with licensed contractors to construct the project (Sec. 7044, Business and Professions Code: The Contractors License Law does not apply to an owner of property who builds or improves thereon or to a contractor for such projects with a contractor(s) licensed pursuant to the Contractors License Law.)

I am exempt under Sec. _____ B & PC for this reason. _____

Date _____ Owner Signature _____

PAID
CITY OF SACRAMENTO
JUL 20 2001
NEIGHBORHOODS PLANNING
AND DEVELOPMENT SERVICES

IN ISSUING THIS BUILDING PERMIT, the applicant represents, and the city relies on the representation of the applicant, that the applicant verified all measurements and locations shown on the application or accompanying drawings and that the improvement to be constructed does not violate any law or private agreement relating to permissible or prohibited locations for such improvements. This building permit does not authorize any illegal location of any improvement or the violation of any private agreement relating to location of improvements.

I certify that I have read this application and state that all information is correct. I agree to comply with all city and county ordinances and state laws relating to building construction and hereby authorize representative(s) of this city to enter upon the abovementioned property for inspection purposes.

Date 7-10-01 Applicant Agent Signature [Signature]

WORKER'S COMPENSATION DECLARATION: I hereby affirm under penalty of perjury one of the following declarations:

I have and will maintain a certificate of consent to self-insure for workers' compensation as provided for by Section 3700 of the Labor Code, for the performance of work for which the permit is issued.

I have and will maintain workers' compensation insurance, as required by Section 3700 of the Labor Code, for the performance of the work for which this permit is issued. My workers' compensation insurance carrier and policy number are:

Carrier _____ Policy Number _____ Exp Date _____

(This section need not be completed if the permit is for \$100 or less) I certify that in the performance of the work for which this permit is issued, I shall not employ any person in any manner so as to become subject to the workers' compensation laws of California and agree that if I should become subject to the workers' compensation provisions of Section 3700 of the Labor Code, I shall forthwith comply with those provisions.

Date 7-10-01 Applicant Signature [Signature]

WARNING: FAILURE TO SECURE WORKER'S COMPENSATION COVERAGE IS UNLAWFUL AND SHALL SUBJECT AN EMPLOYER TO CRIMINAL PENALTIES AND CIVIL FINES UP TO ONE HUNDRED THOUSAND DOLLARS (\$100,000) IN ADDITION TO THE COST OF COMPENSATION DAMAGES AS PROVIDED FOR IN SECTION 3706 OF THE LABOR CODE, INTEREST AND ATTORNEY'S FEE.

THIS PERMIT SHALL EXPIRE BY LIMITATION IF WORK IS NOT COMMENCED WITHIN 180 DAYS.

RESIDENTIAL SUBDIVISION BUILDING PERMIT APPLICATION PLAN 2

Project Address: 1226 P Street Assessor Parcel # 006-281-034
Lot Number: 5 Subdivision CAPITOL PARK HOMES

OWNER INFORMATION:

Legal Property Owner: SHASTA/DOWNTOWN SINGLE FAMIL Phone# 449-8989
Owner Address: 818 19th ST City SACRAMENTO State CA Zip 95814

CONTRACTOR INFORMATION:

Contractor: CNM CONST. Lic. # 767087 Phone # 449-8989 Fax 449-8865

PROJECT INFORMATION:

Land Use Zone RIA Occupancy Group R3 Construction Type VN Fed Code 1A
No. of Stories: 3 No. of Rooms: 9 Street Width: 20
1st Floor Area 998 2nd Floor Area 432 Basement - Roof Material COMP

AREA IN SQUARE FOOT OF:

Dwelling/Living 1430
Garage/Storage 626/355
Decks/Balconies 91
Carports -

SCOPE OF WORK: NEW SINGLE FAMILY RESIDENCE

- Information Above Complete
- Violation Files Checked
- Standard Setbacks
- County Sewer
- AR Flood Waiver Required
- Flood Elevation Certificate Required
- Water Development Infill Area
- Planning Approval
- Design Review Approval
- Special Fee Districts Apply:

THE FOLLOWING MUST BE PROVIDED IN ORDER TO SUBMIT FOR PERMIT:

- 2 COMPLETE PLOT PLANS, LEGIBLE & DRAWN TO SCALE
- 11 X 17 COPY OF FLOOR PLAN WITH FOLLOWING INFORMATION
 - a) Assessor's Parcel Number
 - b) New Floor Area
 - c) Owners Name
 - d) Project Address

Date: _____ Received by: (staff) _____ Permit # _____

FOR OFFICE USE ONLY

Certification of Compliance
School District Development

Part I - To be completed by the APPLICANT

Owner's Name/Address SHASTA LUNITION SINGLE FAM DEV LLC
Project Address 1226 P ST
Parcel Number 106-281-034 Lot No. 5
Subdivision Name CAPITOL PARK HOMES No. of Units 6"
Applicant's Signature [Signature] Title PM
Phone No. 768-4801 Date 7-10-01

Notice to Applicant: Pursuant to Government Code Section 66020(d), this will serve to notify you that the 90-day approval period in which you may protest the fees or other payment identified above will begin to run on the date in which the building or installation permit for this project is issued or on which they are paid to the district(s) or to another public entity authorized to collect them on behalf of the district(s), whichever is earlier.

Part II - To be completed by the BUILDING DEPARTMENT

Plan Identification Number 11279
Building Type (check one) Residential Apartment/Condominium Commercial/Industrial
Square Feet of Chargeable Building Area 1609
Signature/Title [Signature] Date 7-10-01

Part III - To be completed by the SCHOOL DISTRICT

School District 71821 Certificate No. 1111
 Exempt Comments _____
Residential/Apartment/etc. _____ Square ft. x \$ _____ = \$ _____
Commercial/Industrial _____ Square ft. x \$ _____ = \$ _____
Total fees collected..... = \$ 452.22

This certification covers only the amount of square footage indicated above. Any additions or corrections to the square footage for this project will require an amendment to the Certificate of Compliance.

As the authorized school official, I hereby certify that the requirements of Government Code Section 65995 and any other authorized requirements have been complied with by the above signed applicant.

Signature _____ Date 7/18/01

MOTOR COURT "D"

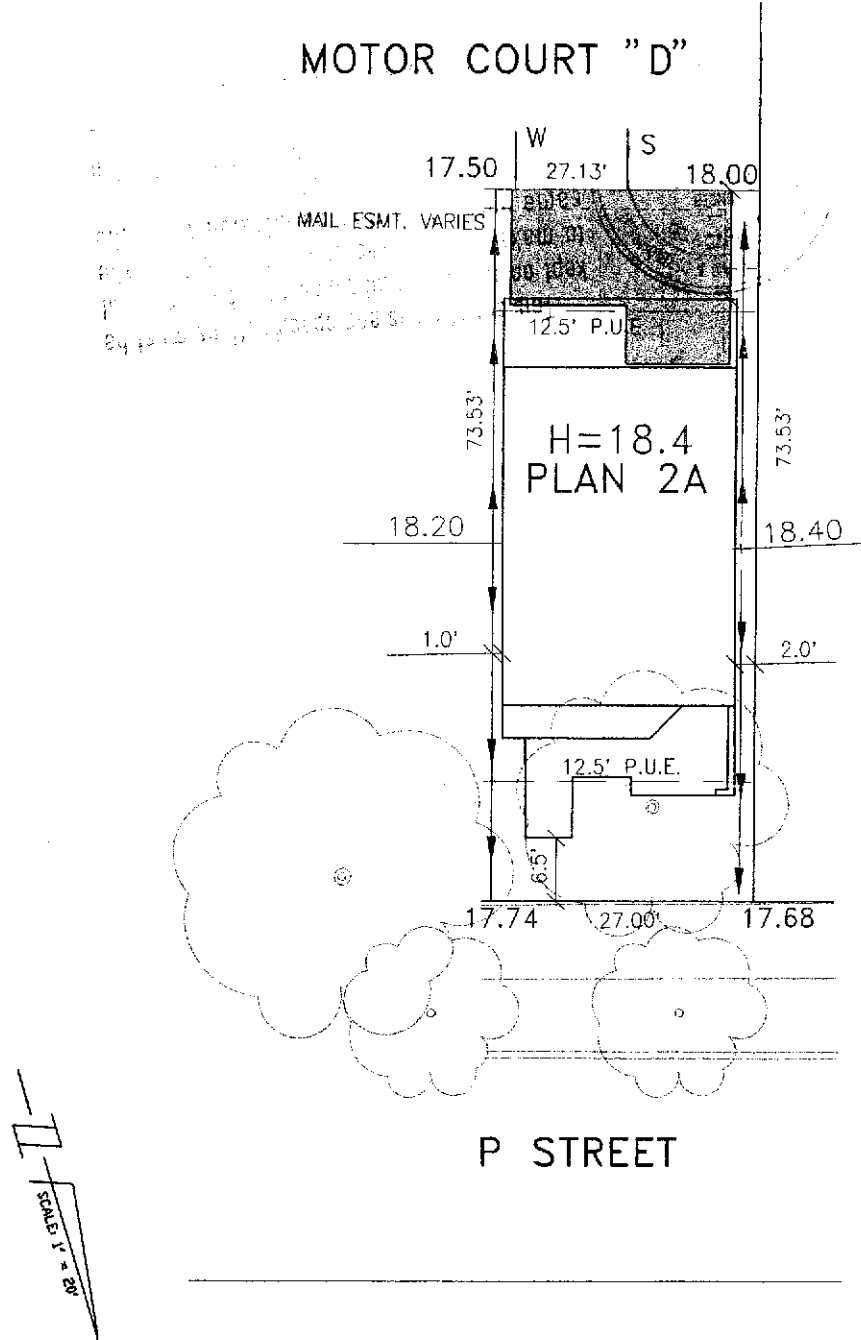

P STREET

NOTE:

This plan is only intended to reference the building plan designated for this lot. All setbacks other than minimum code requirements are approximate. The "as-built" field condition may vary from this plan.

DATE: 03-23-01
 A.P.N.: 006-2810-034
 ADDRESS: 1226 P STREET

LOT AREA: 1,990 SF
 LOT COVERAGE: 54%

The Spink Corporation
 2590 VENTURE OAKS WAY
 SACRAMENTO, CA. 95833
 PH (916)925-5550 FAX (916)921-9274

CAPITOL PARK
 LOT 5
 PLAN 2A

CAPITOL PARK
 CITY OF SACRAMENTO, CA
 CLIENT: CNM CONSTRUCTION
 JOB NO.: 1222-002