

**CITY OF SACRAMENTO**  
1231 I Street, Sacramento, CA 95814

**Permit No: 0006913**  
**Insp Area: 4**

**Site Address: 461 LYMAN CR SAC**  
Parcel No: 225-1290-006  
N

LOT 6 NORTHPOINTE PARK 13-1

Sub-Type: NSFR  
Housing (Y/N):

CONTRACTOR  
WESTERN PACIFIC HOUSING  
1210 CENTRAL BLVD  
BRENTWOOD CA. 94513

OWNER

ARCHITECT

**Nature of Work: NSFR MP2736 2 STORY 10 RMS**

**CONSTRUCTION LENDING AGENCY:** I hereby affirm under penalty of perjury that there is a construction lending agency for the performance of the work for which this permit is issued (Sec. 3097, Civ. C).

Lender's Name \_\_\_\_\_ Lender's Address \_\_\_\_\_

**LICENSED CONTRACTORS DECLARATION:** I hereby affirm under penalty of perjury that I am licensed under provisions of Chapter 9 (commencing with section 7000) of Division 3 of the Business and Professions Code and my license is in full force and effect.

License Class B License Number 675709 Date 7/14/00 Contractor Signature N. Collins

**OWNER-BUILDER DECLARATION:** I hereby affirm under penalty of perjury that I am exempt from the contractors License Law for the following reason (Sec. 7031.5, Business and Professions Code; any city or county which requires a permit to construct, alter, improve, demolish, or repair any structure, prior to its issuance, also requires the applicant for such permit to file a signed statement that he or she is licensed pursuant to the provisions of the Contractors License Law (Chapter 9 (commencing with Section 7000) of Division 8 of the Business and Professions Code) or that he or she is exempt therefrom and the basis for the alleged exemption. Any violation of Section 7031.5 by any applicant for a permit subjects the applicant to a civil penalty of not more than five hundred dollars (\$500.00).

I, as a owner of the property, or my employees with wages as their sole compensation, will do the work, and the structure is not intended or offered for sale (Sec. 7044, Business and Professional Code: The Contractors License Law does not apply to an owner of property who builds or improves thereon, and who does such work himself or herself or through his/her own employees, provided that such improvements are not intended or offered for sale. If, however, the building or improvement is sold within one year of completion, the owner-builder will have the burden of proving that he/she did not build or improve for the purpose of sale.)

I, as owner of the property, am exclusively contracting with licensed contractors to construct the project (Sec. 7044, Business and Professions Code. The Contractors License Law does not apply to an owner of property who builds or improves thereon, and who contracts for such projects with a contractor(s) licensed pursuant to the Contractors License Law).

I am exempt under Sec. \_\_\_\_\_ B & PC for this reason: \_\_\_\_\_

Date \_\_\_\_\_ Owner Signature \_\_\_\_\_

**IN ISSUING THIS BUILDING PERMIT,** the applicant represents, and the city relies on the representation of the applicant, that the applicant verified all measurements and locations shown on the application or accompanying drawings and that the improvement to be constructed does not violate any law or private agreement relating to permissible or prohibited locations for such improvements. This building permit does not authorize any illegal location of any improvement or the violation of any private agreement relating to location of improvements.

I certify that I have read this application and state that all information is correct. I agree to comply with all city and county ordinances and state laws relating to building construction and hereby authorize representative(s) of this city to enter upon the abovementioned property for inspection purposes.

Date 7/14/00 Applicant/Agent Signature N. Collins

**WORKER'S COMPENSATION DECLARATION:** I hereby affirm under penalty of perjury one of the following declarations:

I have and will maintain a certificate of consent to self-insure for workers' compensation as provided for by Section 3700 of the Labor Code, for the performance of work for which the permit is issued.

I have and will maintain workers' compensation insurance, as required by Section 3700 of the Labor Code, for the performance of the work for which this permit is issued. My workers' compensation insurance carrier and policy number are:

Carrier EAGLE INS. CO. Policy Number 4S-0000273 Exp Date 03/19/2001

(This section need not be completed if the permit is for \$100 or less) I certify that in the performance of the work for which this permit is issued, I shall not employ any person in any manner so as to become subject to the workers' compensation laws of California and agree that if I should become subject to the workers' compensation provisions of Section 3700 of the Labor Code, I shall forthwith comply with those provisions.

Date 7/14/00 Applicant Signature N. Collins

**WARNING:** FAILURE TO SECURE WORKER'S COMPENSATION COVERAGE IS UNLAWFUL AND SHALL SUBJECT AN EMPLOYER TO CRIMINAL PENALTIES AND CIVIL FINES UP TO ONE HUNDRED THOUSAND DOLLARS (\$100,000) IN ADDITION TO THE COST OF COMPENSATION, DAMAGES AS PROVIDED FOR IN SECTION 3706 OF THE LABOR CODE, INTEREST AND ATTORNEY'S FEE.

**THIS PERMIT SHALL EXPIRE BY LIMITATION IF WORK IS NOT COMMENCED WITHIN 180 DAYS.**

**RESIDENTIAL SUBDIVISION BUILDING PERMIT APPLICATION**

Project Address: 461 Lyman Circle Assessor Parcel # 0006913  
 Lot Number: 6 Subdivision Northpointe Park Unit #

**OWNER INFORMATION:**

Legal Property Owner: Western Pacific Housing Phone# (925) 634-6023  
 Owner Address: 1210 Central Boulevard; City Brentwood, State Ca. Zip 94513

**CONTRACTOR INFORMATION:**

Contractor: Western Pacific Lic# 675709/B Phone # (925) 634-6023 Fax 634-6166

**PROJECT INFORMATION:**

Land Use Zone RIA Occupancy Group R3 Construction Type VN Fed Code IA  
 No. of Stories: 2 No. of Rooms: \_\_\_\_\_ Street Width: \_\_\_\_\_  
 1<sup>st</sup> Floor Area 1359 2<sup>nd</sup> Floor Area 1377 Basement \_\_\_\_\_ Roof Material \_\_\_\_\_

AREA IN SQUARE FOOT OF:

Dwelling/Living 2736  
 Garage/Storage 677  
 Decks/Balconies 122  
 Carports \_\_\_\_\_

SCOPE OF WORK: \_\_\_\_\_

FOR OFFICE USE ONLY

<input type="checkbox"/> Information Above Complete	<input type="checkbox"/> AR Flood Waiver Required	<input type="checkbox"/> Planning Approval
<input type="checkbox"/> Violation Files Checked	<input type="checkbox"/> Flood Elevation Certificate Required	<input type="checkbox"/> Design Review Approval
<input type="checkbox"/> Standard Setbacks	<input type="checkbox"/> Water Development Infill Area	<input type="checkbox"/> Special Fee Districts Apply:
<input type="checkbox"/> County Sewer	9166358626 JUN 07 12:04 001 00H00 21 ECH NG RESULT	
2 COMPLETE PLOT PLANS, LEGIBLE & DRAWN TO SCALE 11 X 17 COPY OF FLOOR PLAN WITH FOLLOWING INFORMATION: a) Assessor's Parcel Number      c) Owners Name b) New Floor Area                      d) Project Address		
KX RESULT REPORT		

NAME: DEVELOPMENT SERVICES  
 TEL: 916-264-1902  
 DATE: JUN 07 2000 12:04

LEGEND

→ SWALE  
□ MAILBOX

✂ WOOD FENCE  
○ SIDEYARD GATE

SS SEWER SERVICE  
WS WATER SERVICE

□ UTILITY SERVICE  
F.F. FINISH FLOOR

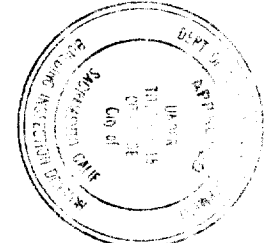
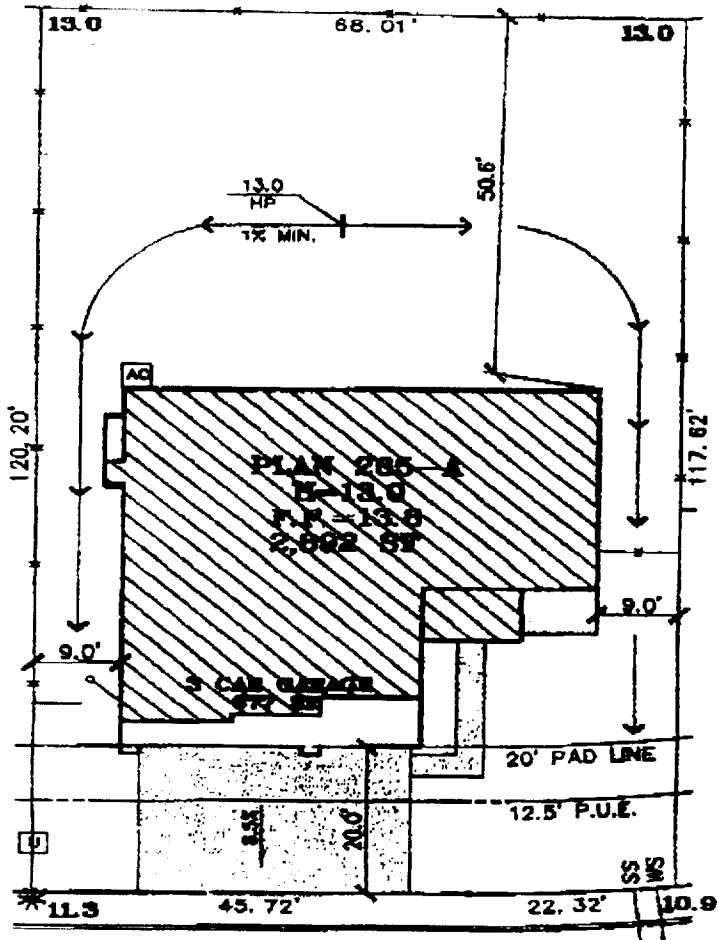

This set of plans and specifications were prepared by the City of Sacramento, Department of Public Works, Building Inspection Division, to make any changes or alterations to the same without written permission from the Building Inspector, Division.  
The approval of this plan and specification SHALL NOT be held to permit or approve the violation of any City Ordinance or State Law.

**LOT 6**  
**PLAN 265-A**  
**A.P.N.:**  
**ADDRESS: 461 LYMAN CIRCLE**  
**LOT AREA: 6,121 SF**

**LYMAN CIRCLE**

DUE TO THE UNIQUE CONDITIONS OF THIS LOT, THE BUYER HAS WALKED AND APPROVED THE SITE. FINAL GRADING CONDITIONS MAY VARY. THE INFORMATION ON THIS PLOT PLAN IS PROVIDED FOR YOUR CONVENIENCE AS A GUIDE TO THE GENERAL LOCATION OF THE SUBJECT PROPERTY. THE ACCURACY OF THIS PLOT PLAN IS NOT GUARANTEED NOR IS IT A PART OF ANY POLICY, REPORT OR GUARANTEE TO WHICH IT MAY BE ATTACHED. DIMENSIONS MAY VARY OR CHANGE WITHOUT PRIOR NOTICE DUE TO ACTUAL SITE CONDITIONS.

PLAN: 265  
ELEVATION: A  
ORIENTATION: L  
COLOR: 160

SIGNED (BUYER) \_\_\_\_\_ DATE \_\_\_\_\_  
PROJECT SUPERINTENDENT APPROVAL \_\_\_\_\_ DATE \_\_\_\_\_  
SITE SUPERINTENDENT APPROVAL \_\_\_\_\_ DATE \_\_\_\_\_  
CONTRACTING APPROVAL \_\_\_\_\_ DATE \_\_\_\_\_  
SALES APPROVAL Rel \_\_\_\_\_ DATE \_\_\_\_\_  
CONSTRUCTION APPROVAL \_\_\_\_\_ DATE \_\_\_\_\_

**The Splink Corporation**  
2500 VENTURE OAKS WAY  
SACRAMENTO, CA 95833  
PH: (916) 825-6660 FAX: (916) 821-8674

  
**Western Pacific Housing**  
1210 Central Boulevard  
Brentwood, CA 94513  
office: (925) 834-6093  
fax: (925) 834-2065

**BELLAGIO**  
NORTHPOINTE PARK VILLAGE 15 PHASE 1  
City of Sacramento, California  
Scale: 1"=20'  
May 12, 2000