

RESOLUTION NO. 2004-882

ADOPTED BY THE SACRAMENTO CITY COUNCIL

ON DATE OF NOV 16 2004

RESOLUTION TO AMEND THE NORTH NATOMAS COMMUNITY PLAN LAND DESIGNATION FOR 180.3± VACANT ACRES FROM 145.2+/- ACRES OF MEDIUM DENSITY RESIDENTIAL (7-21 DU/NA) AND 35.1+/- ACRES OF PARKS/OPEN SPACE TO 147.7+/- ACRES OF MEDIUM DENSITY RESIDENTIAL (7-21 DU/NA) AND 32.6+/- ACRES OF PARKS/OPEN SPACE FOR PROPERTY LOCATED EAST OF HIGHWAY 99/70, WEST AND EAST OF EAST COMMERCE WAY AND NORTH AND SOUTH OF CLUB CENTER DRIVE.

(APNs: Portions of 201-0300-016, -017, -018, -027, -028, -061, 225-0040-017)
(P03-158)

WHEREAS, the Planning Commission conducted a public hearing on October 14, 2004, and the City Council conducted a public hearing on November 16, 2004 concerning the above plan amendment and based on documentary and oral evidence submitted at the public hearing, the Council hereby finds:

1. The proposed land use amendment is compatible with the surrounding land uses;
2. The subject site is suitable for Medium Density (7-21 du/na) residential and Parks/Open Space development;
3. The proposal is consistent with the policies of the North Natomas Community Plan and the General Plan.

NOW, THEREFORE BE IT RESOLVED by the City Council of the City of Sacramento that:

- A. The 180.3± acre area described on the attached Exhibit 1 is hereby designated on the North Natomas Community Plan land use map as 147.7+/- acres of Medium Density Residential (7-21 du/na) and 32.6+/- acres of Parks/Open Space.

FOR CITY CLERK USE ONLY

RESOLUTION NO.: 2004-882

DATE ADOPTED: NOV 16 2004

SANDY SHEEDY

VICE-MAYOR

ATTEST:

SHIRLEY CONCOLINO

CITY CLERK

(P03-158)

FOR CITY CLERK USE ONLY

RESOLUTION NO.: **2004-882**

DATE ADOPTED: **NOV 16 2004**

COMMUNITY PLAN AMENDMENT EXHIBIT

THE HAMPTONS
CITY OF SACRAMENTO, CALIFORNIA

ADOPTED MAY 21, 2003
REVISIONS MAY 21, 2004
REVISIONS SEPTEMBER 17, 2004

COMMUNITY PLAN SUMMARY TABLE

DESIGNATION	LAND USE	EXISTING	PROPOSED	DIFFERENCE
HO	MEDIUM DENSITY RESIDENTIAL (17-21 DU/AC)	145.2	147.7	+2.5
P	PARK	25.4	19.4	-6.0
O5	OPEN SPACE	12.7	14.2	+1.5
		180.3	180.3	

P03-158
REVISED
Rec'd 9-17-04

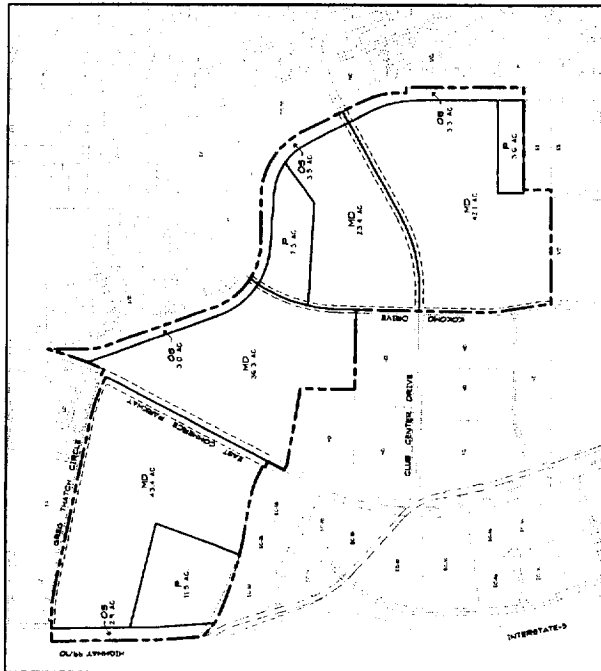
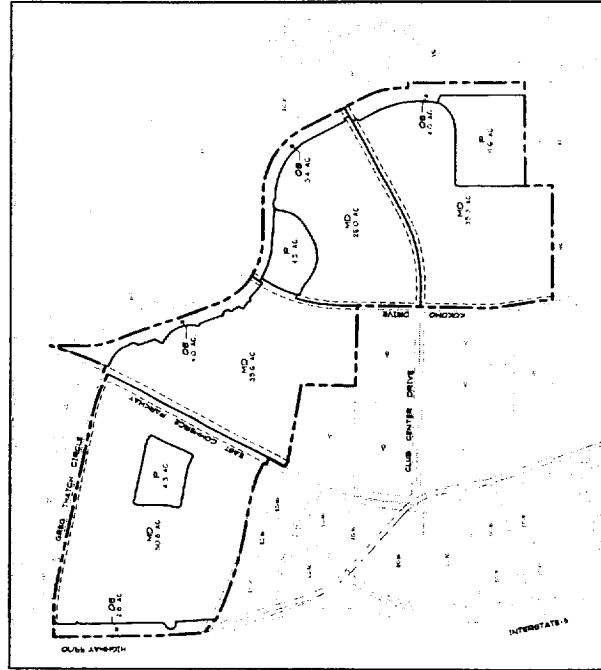
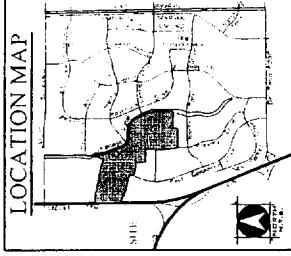

WOOD ROGERS
ENGINEERING • PLANNING • MAPPING • SURVEYING
330 HUNTERS CREEK ROAD, SUITE 100
SACRAMENTO, CA 95825
PHONE: (916) 291-7100 FAX: (916) 291-0712

Proposed Community Plan

Existing Community Plan

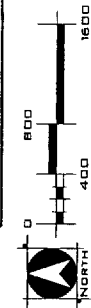

FOR CITY CLERK USE ONLY

RESOLUTION NO.: 2004-882
DATE ADOPTED: NOV 16 2004