

**CITY OF SACRAMENTO**  
1231 I Street, Sacramento, CA 95814

**Permit No: 0112846**  
**Insp Area: 4**  
Thos Bros:  
Sub-Type: NSFR  
Housing (Y/N):

**Site Address: 2596 MAYBROOK DR SAC**  
Parcel No: 201-0420-046 NORTHBOROUGH VIL. 5-2 LOT 8  
N

CONTRACTOR  
CENTEX HOMES  
3300 DOUGLAS BLVD  
STE. 210 95661

OWNER

ARCHITECT

**Nature of Work: MP 2492 2 STORY 9 ROOM SFR**

**CONSTRUCTION LENDING AGENCY :** I hereby affirm under penalty of perjury that there is a construction lending agency for the performance of the work for which this permit is issued (Sec. 3097, Civ. C).

Lender's Name N/A Lender's Address \_\_\_\_\_

**LICENSED CONTRACTORS DECLARATION:** I hereby affirm under penalty of perjury that I am licensed under provisions of Chapter 9 (commencing with section 7000) of Division 3 of the Business and Professions Code and my license is in full force and effect.

License Class B License Number 734094 Date 10/9/01 Contractor Signature Debbie Stowers

**OWNER-BUILDER DECLARATION:** I hereby affirm under penalty of perjury that I am exempt from the contractors License Law for the following reason (Sec. 7031.5, Business and Professions Code; any city or county which requires a permit to construct, alter, improve, demolish, or repair any structure, prior to its issuance, also requires the applicant for such permit to file a signed statement that he or she is licensed pursuant to the provisions of the Contractors License Law (Chapter 9 (commencing with Section 7000) of Division 8 of the Business and Professions Code) or that he or she is exempt therefrom and the basis for the alleged exemption. Any violation of Section 7031.5 by any applicant for a permit subjects the applicant to a civil penalty of not more than five hundred dollars (\$500.00);

\_\_\_\_\_, I, as a owner of the property, or my employees with wages as their sole compensation, will do the work, and the structure is not intended or offered for sale (Sec. 7044, Business and Professional Code: The Contractors License Law does not apply to an owner of property who builds or improves thereon, and who does such work himself or herself or through his/her own employees, provided that such improvements are not intended or offered for sale. If, however, the building or improvement is sold within one year of completion, the owner-builder will have the burden of proving that he/she did not build or improve for the purpose of sale.)

\_\_\_\_\_, I, as owner of the property, am exclusively contracting with licensed contractors to construct the project (Sec. 7044, Business and Professions Code: The Contractors License Law does not apply to an owner of property who builds or improves thereon, and who contracts for such projects with a contractor(s) licensed pursuant to the Contractors License Law).

\_\_\_\_\_, I am exempt under Sec. \_\_\_\_\_ B & PC for this reason: \_\_\_\_\_

Date \_\_\_\_\_ Owner Signature \_\_\_\_\_

**IN ISSUING THIS BUILDING PERMIT,** the applicant represents, and the city relies on the representation of the applicant, that the applicant verified all measurements and locations shown on the application or accompanying drawings and that the improvement to be constructed does not violate any law or private agreement relating to permissible or prohibited locations for such improvements. This building permit does not authorize any illegal location of any improvement or the violation of any private agreement relating to location of improvements.

I certify that I have read this application and state that all information is correct. I agree to comply with all city and county ordinances and state laws relating to building construction and hereby authorize representative(s) of this city to enter upon the abovementioned property for inspection purposes.

Date 10/9/01 Applicant/Agent Signature Debbie Stowers

**WORKER'S COMPENSATION DECLARATION:** I hereby affirm under penalty of perjury one of the following declarations:  
\_\_\_\_\_, I have and will maintain a certificate of consent to self-insure for workers' compensation as provided for by Section 3700 of the Labor Code, for the performance of work for which the permit is issued.

I have and will maintain workers' compensation insurance, as required by Section 3700 of the Labor Code, for the performance of the work for which this permit is issued. My workers' compensation insurance carrier and policy number are:

Carrier ZURICH AMERICAN INS CO Policy Number WC8322098WI Exp Date 10/01/2002

\_\_\_\_\_, (This section need not be completed if the permit is for \$100 or less) I certify that in the performance of the work for which this permit is issued, I shall not employ any person in any manner so as to become subject to the workers' compensation laws of California and agree that if I should become subject to the workers' compensation provisions of Section 3700 of the Labor Code, I shall forthwith comply with those provisions.

Date 10/9/01 Applicant Signature Debbie Stowers

**WARNING: FAILURE TO SECURE WORKER'S COMPENSATION COVERAGE IS UNLAWFUL AND SHALL SUBJECT AN EMPLOYER TO CRIMINAL PENALTIES AND CIVIL FINES UP TO ONE HUNDRED THOUSAND DOLLARS (\$100,000) IN ADDITION TO THE COST OF COMPENSATION, DAMAGES AS PROVIDED FOR IN SECTION 3706 OF THE LABOR CODE, INTEREST AND ATTORNEY'S FEE.**

**THIS PERMIT SHALL EXPIRE BY LIMITATION IF WORK IS NOT COMMENCED WITHIN 180 DAYS.**

**INSULATION CERTIFICATE**

**THIS IS TO CERTIFY THAT INSULATION HAS BEEN INSTALLED IN CONFORMANCE WITH THE CURRENT ENERGY REGULATIONS, CALIFORNIA ADMINISTRATION CODE, TITLE 24, STATE OF CALIFORNIA, IN THE BUILDING LOCATED AT:**

**SITE ADDRESS** LOT 208 NORTHBOROUGH SACRAMENTO CA  
**NUMBER** **STREET** **CITY** **STATE**

**CEILING:**

**BLOW:** **MANUFACTURER** GREENSTONE **THICKNESS** 10.3" **R-VALUE** 38  
**SQUARE FEET** 1308 **KG/LBS PER BAGS** \_\_\_\_\_

**BATTS:** **MANUFACTURER** JOHNS MANVILLE **THICKNESS** 10" **R-VALUE** 38  
JOHNS MANVILLE \_\_\_\_\_

**WALL:**

**MANUFACTURER** JOHNS MANVILLE **THICKNESS** 3.5" **R-VALUE** 13  
JOHNS MANVILLE \_\_\_\_\_

**FLOOR INSULATION:**

**MANUFACTURER** JOHNS MANVILLE **THICKNESS** 0.5" **R-VALUE** 19

**AIR INFILTRATION:**

(TITLE 24)

**YES** XX **NO** \_\_\_\_\_

**OTHER:** \_\_\_\_\_

**GENERAL CONTRACTOR:** GENTEX HOMES **LICENSE #** \_\_\_\_\_

**BY:** \_\_\_\_\_ **TITLE** \_\_\_\_\_ **DATE** \_\_\_\_\_

**INSULATION CONTRACTOR:** WESTERN INSULATION LP **LICENSE #** 784454

**BY:** Jamie Blair **TITLE** AUTH. AGENT **DATE** 2/8/02  
JAMIE BLAIR

**RESIDENTIAL BUILDING PERMIT APPLICATION**

New Construction

Addition

Remodels

Other

Project Address: 2596 Maybrook Drive

Assessor Parcel # 201-0420-046

LOT 8

**OWNER INFORMATION:**

Legal Property Owner: Center Homes Phone # 786-8693  
 Owner Address: 3700 Douglas Blvd #150 City Roseville State CA Zip 95661

**CONTRACTOR INFORMATION:**

Contractor: Center Homes Lic. # 734094 Phone # 786-8693 Fax# 786-6802

**PROJECT INFORMATION:**

Land Use Zone RIA Occupancy Group R3 Construction Type VN Fed Code 1A  
 No. of stories: 2 No. of rooms: \_\_\_\_\_ Street width: \_\_\_\_\_  
 1<sup>st</sup> Floor Area 1286 2<sup>nd</sup> Floor Area 1206 Basement \_\_\_\_\_ Roof Material \_\_\_\_\_

AREA IN SQUARE FOOT OF:	EXISTING	NEW
Dwelling/Living	_____	<u>2492</u>
Garage/Storage	_____	<u>601</u>
Decks/Balconies	_____	_____
Carports	_____	_____

SCOPE OF WORK: MP 2492 New SFR

**FOR OFFICE USE ONLY**

- |   |   |  |
|---|---|--|
| <input type="checkbox"/> Information above complete | <input type="checkbox"/> AR Flood Waiver required             | <input type="checkbox"/> Planning Approval                   |
| <input type="checkbox"/> Violation files checked    | <input type="checkbox"/> Flood Elevation Certificate Required | <input type="checkbox"/> Design Review Approval              |
| <input type="checkbox"/> Standard setbacks          | <input type="checkbox"/> Water Development Infill Area        | <input type="checkbox"/> Special Fee Districts Apply : _____ |
| <input type="checkbox"/> County Sewer               |   |  |

**NEW STRUCTURES & ADDITIONS**

◆ THE FOLLOWING MUST BE PROVIDED IN ORDER TO SUBMIT FOR PLAN REVIEW

- |   |   |
|---|---|
| <input type="checkbox"/> 2 COMPLETE PLANS, LEGIBLE & DRAWN TO SCALE   | ◆ Plans to include: site plan, floor plan, elevations, roof/ceiling plan, foundation and structural framing details, and structural calculations for non-conforming structures. |
| <input type="checkbox"/> 3 SETS IF PROJECT IS IN A DESIGN REVIEW AREA |   |
| <input type="checkbox"/> Title 24 Energy Compliance documentation     | <input type="checkbox"/> 11" x 17" copy of floor plan for County Assessor   |
| <input type="checkbox"/> Grading and Erosion Control Questionnaire    | <input type="checkbox"/> Plan Review Fees   |

Date: \_\_\_\_\_

Received by: (staff) \_\_\_\_\_



Lot Area = 5,947 sf  
 Building Footprint = 1,971 sf  
 Gross Coverage = 33.1%  
 Porch Allowance = 84 sf  
 Net Coverage = 31.7%

SCALE: 1" = 20'

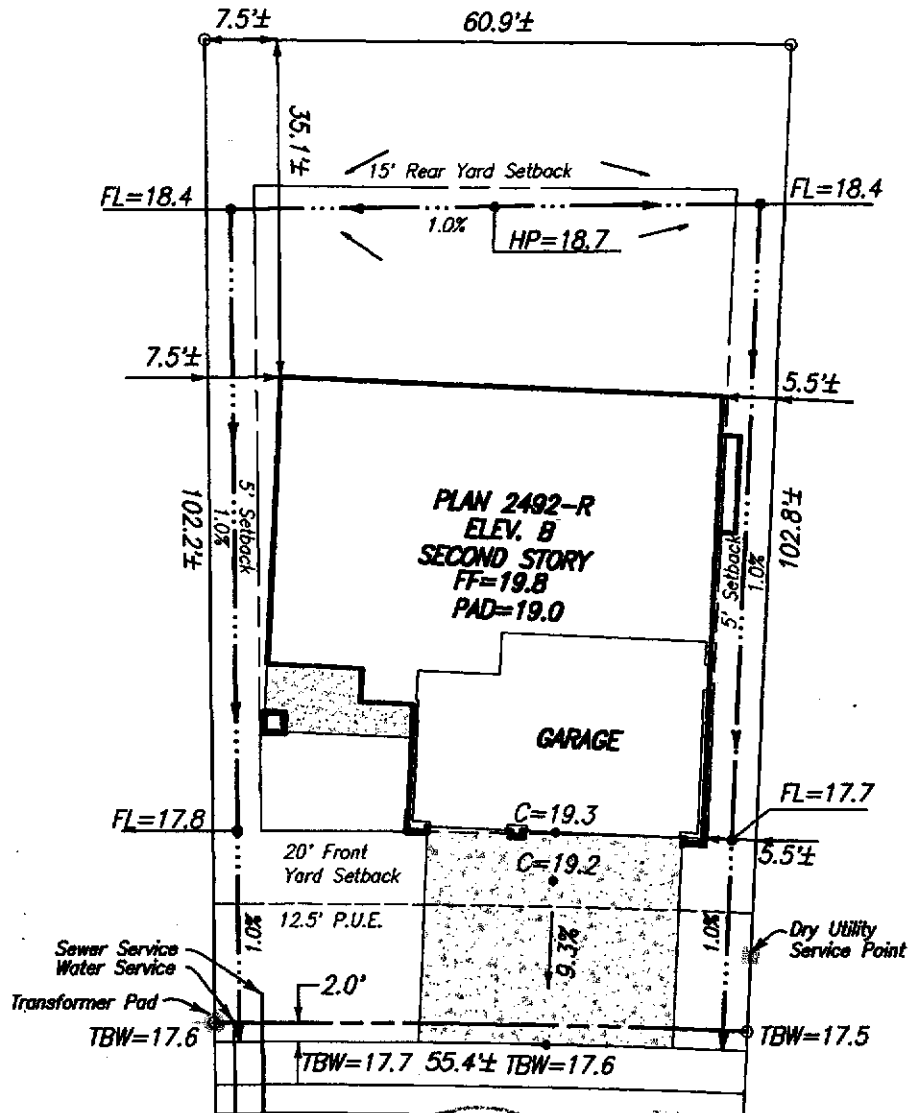

2596 MAYBROOK DRIVE

This set of plans and specifications must be kept on the job at all times and no changes or alterations shall be made without the written approval of the engineer. The engineer shall not be responsible for any errors or omissions in these plans.

<p> <b>Plot Plan for Lot 8</b>  <b>Northborough Village 5-2</b>  <b>City of Sacramento</b> </p>	<p> <b>Centex Homes</b>          3700 Douglas Blvd., Suite 150          Roseville, CA 95661          Ph.: (916) 786-8693       </p>	<p> <b>Plan 2492 Elev. B</b>  <b>Centex Review &amp; Approval:</b>          By: <u>JS</u> Date: <u>6/25</u> </p>
<p> <b>Note:</b>          This plot plan has been prepared for the purpose of showing the building foundation relationship to the property line, proposed drainage elevations and direction of flow to conform to local ordinances and for the purpose of building permit issuance. Information shown is approximate except for those setbacks which are minimums required by ordinance. This plot does not reflect as-built conditions which will likely vary from this plan.       </p>		<p> <b>Murray Smith &amp; Associates</b>  <b>Engineering, Inc.</b>          3110 Gold Canal Drive          Rancho Cordova, CA 95670          Ph.: (916) 635-1511       </p>
<p>June 18, 2001</p>		<p>PN: 99030</p>