

**CITY OF SACRAMENTO**  
1231 I Street, Sacramento, CA 95814

**Permit No: 0103005**  
**Insp Area: 4**

**Site Address: 12 INDIGO OAKS CT SAC**  
Parcel No: 225-1430-041 NATOMAS CROSS 22 LOT 41

Sub-Type: NSFR  
Housing (Y/N): N

**CONTRACTOR**  
RYLAND HOMES  
380 LEAD HILL BLVD STE 108  
ROSEVILLE CA 95601

**OWNER**

**ARCHITECT**

**Nature of Work: MP 2383 2 STORY 10 ROOM SFR**

**CONSTRUCTION LENDING AGENCY:** I hereby affirm under penalty of perjury that there is a construction lending agency for the performance of the work for which this permit is issued (Sec. 3097, C.C.P.C.).

Lender's Name \_\_\_\_\_ Lender's Address \_\_\_\_\_

**LICENSED CONTRACTORS DECLARATION:** I hereby affirm under penalty of perjury that I am licensed under provisions of Chapter 9 commencing with section 7000 of Division 3 of the Business and Professions Code and my license is in full force and effect.

License Class B License Number 54648 Date 3.23.01 Contractor Signature [Signature]

**OWNER-BUILDER DECLARATION:** I hereby affirm under penalty of perjury that I am exempt from the contractors License Law for the following reason (Sec. 7031.5, Business and Professions Code): any city or county which requires a permit to construct, alter, improve, demolish, or repair any structure, prior to its issuance, also requires the applicant for such permit to file a signed statement that he or she is licensed pursuant to the provisions of the Contractors License Law (Chapter 9 commencing with Section 7000) of Division 8 of the Business and Professions Code) or that he or she is exempt therefrom and the basis for the alleged exemption. Any violation of Section 7031.5 by any applicant for a permit subjects the applicant to a civil penalty of not more than five hundred dollars (\$500.00).

I, as a owner of the property, or my employees with wages as their sole compensation, will do the work, and the structure is not intended or offered for sale (Sec. 7044, Business and Professional Code). The Contractors License Law does not apply to an owner of property who builds or improves thereon, and who does such work himself or herself or through his/her own employees, provided that such improvements are not intended or offered for sale. If, however, the building or improvement is sold within one year of completion, the owner-builder will have the burden of proving that he/she did not build or improve for the purpose of sale.

I, as owner of the property, am exclusively contracting with licensed contractors to construct the project (Sec. 7044, Business and Professions Code). The Contractors License Law does not apply to an owner of property who builds or improves thereon, and who contracts for such projects with a contractor(s) licensed pursuant to the Contractors License Law.

I am exempt under Sec. \_\_\_\_\_ B & PC for this reason: \_\_\_\_\_

Date \_\_\_\_\_ Owner Signature \_\_\_\_\_

**PAID**  
**CITY OF SACRAMENTO**

MAR 23 2001

**IN ISSUING THIS BUILDING PERMIT,** the applicant represents, and the city relies on the representation of the applicant, that the applicant verified all measurements and locations shown on the application or accompanying drawings. This building permit does not authorize any illegal location of any improvement or the violation of any private agreement relating to location of improvements.

**NEIGHBORHOODS PLANNING AND DEVELOPMENT SERVICES**

I certify that I have read this application and state that all information is correct. I agree to comply with all city and county ordinances and state laws relating to building construction and hereby authorize representatives of this city to enter upon the abovementioned property for inspection purposes.

Date 3.23.01 Applicant/Agent Signature [Signature]

**WORKER'S COMPENSATION DECLARATION:** I hereby affirm under penalty of perjury one of the following declarations:

I have and will maintain a certificate of consent to self-insure for workers' compensation as provided for by Section 3700 of the Labor Code, for the performance of work for which the permit is issued.

I have and will maintain workers' compensation insurance, as required by Section 3700 of the Labor Code, for the performance of the work for which this permit is issued. My workers' compensation insurance carrier and policy number are:

Carrier American Protection Policy Number 4820003291.01 Exp Date 6.1.01

(This section need not be completed if the permit is for \$100 or less) I certify that in the performance of the work for which this permit is issued, I shall not employ any person in any manner so as to become subject to the workers' compensation laws of California and agree that if I should become subject to the workers' compensation provisions of Section 3700 of the Labor Code, I shall forthwith comply with those provisions.

Date 3.23.01 Applicant Signature [Signature]

**WARNING: FAILURE TO SECURE WORKER'S COMPENSATION COVERAGE IS UNLAWFUL AND SHALL SUBJECT AN EMPLOYER TO CRIMINAL PENALTIES AND CIVIL FINES UP TO ONE HUNDRED THOUSAND DOLLARS (\$100,000) IN ADDITION TO THE COST OF COMPENSATION, DAMAGES AS PROVIDED FOR IN SECTION 3706 OF THE LABOR CODE, INTEREST AND ATTORNEY'S FEE.**

**THIS PERMIT SHALL EXPIRE BY LIMITATION IF WORK IS NOT COMMENCED WITHIN 180 DAYS.**

Project Address: 12 INTALO CAY CT  
Lot Number: 41

Assessor Parcel # 225 1430 041  
Subdivision Natomas Crossing Unit # 12

**OWNER INFORMATION:**

Legal Property Owner: Ryland Homes Phone# 784-1330#14  
Owner Address: 1380 Lead Hill Rd. City Roseville State CA Zip 95661

**CONTRACTOR INFORMATION:**

Contractor: Ryland Homes Lic. # 54648 Phone # 784-1330#14 Fax 784-9805

**PROJECT INFORMATION:** Plan Four MP 2383

Land Use Zone R1A Occupancy Group R3 Construction Type VN Fed Code 1A  
No. of Stories: 2 No. of Rooms: 10 Street Width: 41'  
1<sup>st</sup> Floor Area 1238 2<sup>nd</sup> Floor Area 1145 Basement \_\_\_\_\_ Roof Material Tile

**AREA IN SQUARE FOOT OF:**

Dwelling/Living 2383  
Garage/Storage 625  
Decks/Balconies \_\_\_\_\_  
Carports \_\_\_\_\_

SCOPE OF WORK: SFD.

FOR OFFICE USE ONLY

- Information Above Complete
- Violation Files Checked
- Standard Setbacks
- County Sewer
- AR Flood Waiver Required
- Flood Elevation Certificate Required
- Water Development Infill Area
- Planning Approval
- Design Review Approval
- Special Fee Districts Apply:

**THE FOLLOWING MUST BE PROVIDED IN ORDER TO SUBMIT FOR PERMIT**

- 2 COMPLETE PLOT PLANS, LEGIBLE & DRAWN TO SCALE
- 11 X 17 COPY OF FLOOR PLAN WITH FOLLOWING INFORMATION
  - a) Assessor's Parcel Number
  - b) New Floor Area
  - c) Owners Name
  - d) Project Address

Date: \_\_\_\_\_ Received by: (staff) \_\_\_\_\_ Permit # \_\_\_\_\_

T.R. PRINTING (702) 821-3018



# WESPAC

Insulation  
a WESPAC Company

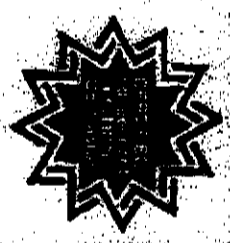

809 North Market Blvd, Ste. 11 • Sacramento, CA 95834  
(916) 927-7149 • Fax (916) 927-4257  
Lic. #487478

## Installed Insulation Certificate

We certify that the Insulation listed herein is installed in conformance with current energy conservation regulations, California Administrative Code, Title 24, State of California

AREA	TYPE	THICKNESS (INCHES)
R38 CEILING	FIBERGLASS Batts	13"
R19 CEILING	FIBERGLASS Batts	6.5"
R13 EXTERIOR WALLS	FIBERGLASS Batts	3.5"

RYLAND HOMES

Certified by *Jimmy Jimmy*

Title Secretary

HERITAGE NATOMAS  
RYLH HERITAGE/141

Address or Lot Number  
07/19/01

Date Installed

Phase #

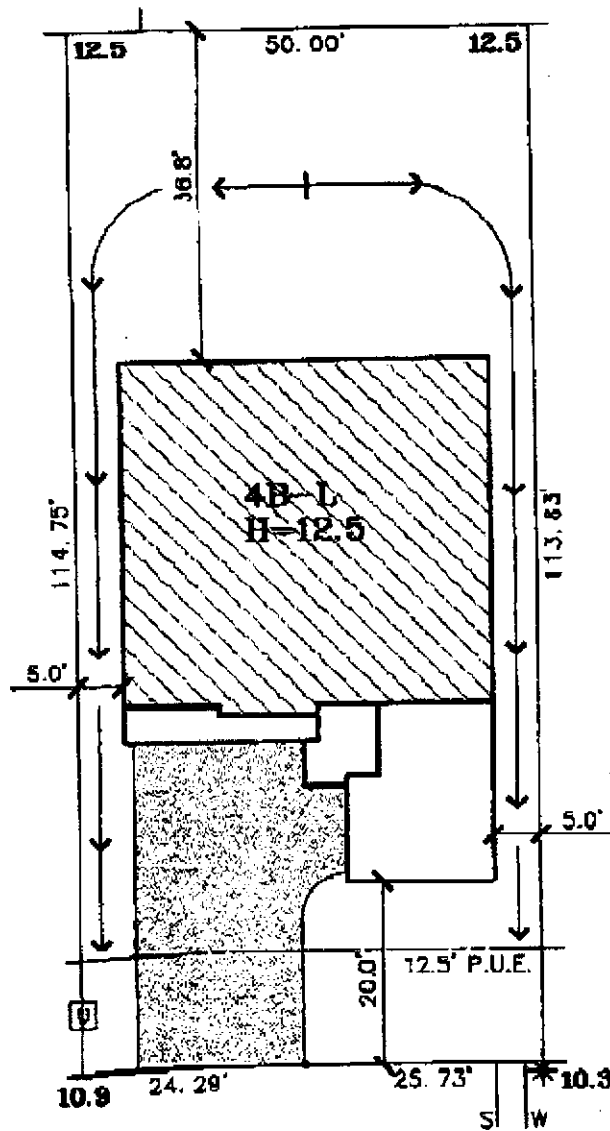

### INDIGO OAKS COURT

#### LEGEND

- PUBLIC UTILITY EASEMENT
- S SEWER SERVICE
- W WATER SERVICE
- ☐ UTILITY BOX
- \* STREET LIGHT
- ▣ DRAIN INLET
- ◆ FIRE HYDRANT

DATE: 2-15-01  
 LOT AREA: 5,899 SF  
 LOT COVERAGE: 32%

THIS PLAN IS PREPARED TO SHOW THE DIMENSIONAL RELATIONSHIP FROM BUILDING FOUNDATION TO PROPERTY LINE, DESIGN DRAINAGE CONTROL ELEVATIONS, AND DIRECTION OF DRAINAGE FLOW TO CONFORM WITH LOCAL ORDINANCES FOR THE PURPOSE OF BUILDING PERMIT ISSUANCE. INFORMATION SHOWN IS APPROXIMATE EXCEPT FOR THOSE SETBACKS WHICH ARE MINIMUMS REQUIRED BY ORDINANCE. THIS PLOT PLAN DOES NOT REFLECT AS BUILT CONDITIONS WHICH WILL LIKELY VARY FROM THIS PLAN.

**The Spink Corporation**  
 2590 VENTURE OAKS WAY  
 SACRAMENTO, CA 95833  
 PH:(916)925-5550 FAX:(916)921-9274

**NATOMAS CROSSING VILLAGE 22**  
 12 INDIGO OAKS CT.  
 A.P.N.:  
 LOT 41  
 PLAN 4B

**RYLAND HERITAGE**  
 CITY OF SACRAMENTO, CA  
 CLIENT: RYLAND HOMES  
 CONTACT: LINDA STEINFELDT  
 PHONE: 916-784-1390  
 JOB NO.: 7684-003