

CITY OF SACRAMENTO

1231 I Street, Sacramento, CA 95814

Permit No: 0506883

Insp Area: 4

Thos Bros: 276J7

Site Address: 2794 TRIGO WY SAC

Parcel No: 274-0430-059

Sub-Type: RES

Housing (Y/N): N

CONTRACTOR

OWNER

MINCEY WILLIE J JR/LINDA A
2794 TRIGO WY
SACRAMENTO, CA 95833

ARCHITECT

Nature of Work: INSTALL PULL ALARM FOR R2.2.1 OCCUPANCY

CONSTRUCTION LENDING AGENCY : I hereby affirm under penalty of perjury that there is a construction lending agency for the performance of the work for which this permit is issued (Sec. 3097, Civ. C).

Lender's Name _____ Lender's Address _____

LICENSED CONTRACTORS DECLARATION: I hereby affirm under penalty of perjury that I am licensed under provisions of Chapter 9 (commencing with section 7000) of Division 3 of the Business and Professions Code and my license is in full force and effect.

License Class _____ License Number _____ Date _____ Contractor Signature _____

OWNER-BUILDER DECLARATION: I hereby affirm under penalty of perjury that I am exempt from the contractors License Law for the following reason (Sec. 7031.5, Business and Professions Code; any city or county which requires a permit to construct, alter, improve, demolish, or repair any structure, prior to its issuance, also requires the applicant for such permit to file a signed statement that he or she is licensed pursuant to the provisions of the Contractors License Law (Chapter 9 (commencing with Section 7000) of Division 8 of the Business and Professions Code) or that he or she is exempt therefrom and the basis for the alleged exemption. Any violation of Section 7031.5 by any applicant for a permit subjects the applicant to a civil penalty of not more than five hundred dollars (\$500.00);

I, as a owner of the property, or my employees with wages as their sole compensation, will do the work, and the structure is not intended or offered for sale (Sec. 7044, Business and Professional Code: The Contractors License Law does not apply to an owner of property who builds or improves thereon, and who does such work himself or herself or through his/her own employees, provided that such improvements are not intended or offered for sale. If, however, the building or improvement is sold within one year of completion, the owner-builder will have the burden of proving that he/she did not build or improve for the purpose of sale.)

I, as owner of the property, am exclusively contracting with licensed contractors to construct the project (Sec. 7044, Business and Professions Code: The Contractors License Law does not apply to an owner of property who builds or improves thereon, and who contracts for such projects with a contractor(s) licensed pursuant to the Contractors License Law).

I am exempt under Sec. _____ B & PC for this reason: _____

Date 5.16.05 Owner Signature *Wanda Mincey*

IN ISSUING THIS BUILDING PERMIT, the applicant represents, and the city relies on the representation of the applicant, that the applicant verified all measurements and locations shown on the application or accompanying drawings and that the improvement to be constructed does not violate any law or private agreement relating to permissible or prohibited locations for such improvements. This building permit does not authorize any illegal location of any improvement or the violation of any private agreement relating to location of improvements.

I certify that I have read this application and state that all information is correct. I agree to comply with all city and county ordinances and state laws relating to building construction and hereby authorize representative(s) of this city to enter upon the abovementioned property for inspection purposes.

Date 5.16.05 Applicant/Agent Signature *Wanda Mincey*

WORKER'S COMPENSATION DECLARATION: I hereby affirm under penalty of perjury one of the following declarations:

I have and will maintain a certificate of consent to self-insure for workers' compensation as provided for by Section 3700 of the Labor Code, for the performance of work for which the permit is issued.

I have and will maintain workers' compensation insurance, as required by Section 3700 of the Labor Code, for the performance of the work for which this permit is issued. My workers' compensation insurance carrier and policy number are:

Carrier _____ Policy Number _____ Exp Date _____

(This section need not be completed if the permit is for \$100 or less) I certify that in the performance of the work for which this permit is issued, I shall not employ any person in any manner so as to become subject to the workers' compensation laws of California and agree that if I should become subject to the workers' compensation provisions of Section 3700 of the Labor Code, I shall forthwith comply with those provisions.

Date 5.16.05 Applicant Signature *Wanda Mincey*

WARNING: FAILURE TO SECURE WORKER'S COMPENSATION COVERAGE IS UNLAWFUL AND SHALL SUBJECT AN EMPLOYER TO CRIMINAL PENALTIES AND CIVIL FINES UP TO ONE HUNDRED THOUSAND DOLLARS (\$100,000) IN ADDITION TO THE COST OF COMPENSATION, DAMAGES AS PROVIDED FOR IN SECTION 3706 OF THE LABOR CODE, INTEREST AND ATTORNEY'S FEE.

THIS PERMIT SHALL EXPIRE BY LIMITATION IF WORK IS NOT COMMENCED WITHIN 180 DAYS.

PAID
CITY OF SACRAMENTO
MAY 16 2005
NOVILLI PERMITS
CENTER

City of Sacramento
Development Services Department
PLANNING REVIEW FOR BUILDING PERMIT SUBMITTAL

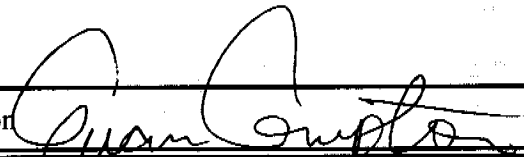
ADDRESS: 2794 Trigo Way	APN: 274-0430-059
DRPB AREA / PUD / SPD: Expanded North, River Ranch PUD	ZONING: R-1A PUD
EXISTING LAND USE: SFR with attached garage	
PROPOSED USE: Fire Pull for Care Facility (Less than 6 clients)	
<p>PLANNING STAFF WILL CHECK ONE OR MORE OF THE ITEMS BELOW:</p> <p><input checked="" type="checkbox"/> Planning review is NOT required.</p> <p><input type="checkbox"/> Use is NOT allowed; applicant CANNOT submit for plan check.</p> <p><input type="checkbox"/> Requires APPLICATION(s): PC ZA IR ER DR PB</p> <p style="padding-left: 20px;">Required Planning application must be approved <i>before</i> project can be submitted for plan check</p> <p><input type="checkbox"/> Application(s) IN PROGRESS: File Number:</p> <p style="padding-left: 20px;">Application must be approved before project can be submitted for plan check.</p> <p><input type="checkbox"/> Application(s) COMPLETED: File Number & approval date:</p> <p style="padding-left: 20px;">Building permit must conform to approved plans and comply with all conditions of approval. Do NOT accept applications for a building permit prior to the end of the 10-day appeal period.</p> <p><input checked="" type="checkbox"/> Plans may be submitted for plan check. Plan checker(s) shall confirm compliance with Zoning Ordinance requirements and all applicable development standards <i>prior to issuance</i> of building permit.</p> <p><input type="checkbox"/> Meets setback & lot coverage requirements as shown on site plan provided.</p> <p><input type="checkbox"/> Plans to be submitted have been stamped/signed by Planning counter staff.</p> <p><input type="checkbox"/> Route to SITE for plan check and inspection.</p> <p><input type="checkbox"/> Route to SITE for inspection only, plan check not required.</p> <p><input type="checkbox"/> Preliminary review ONLY; the information on this form must be reviewed again and confirmed at the time of building permit submittal.</p>	
CONDITIONS AND COMMENTS: No planning issues are apparent.	
DATE: April 25, 2005	BY: Evan Compton 

APPLICATION FOR COMMERCIAL BUILDING PERMIT

CITY OF SACRAMENTO
 DEVELOPMENT SERVICES DIVISION
 PERMIT SERVICES SECTION
 1231 I Street, Rm. 200
 Sacramento, CA 95814 (916) 264-7619 FAX: 264-7046

ACTIVITY # 050 6883	Insp. Area 4
-------------------------------	------------------------

Applicant **MUST** complete ALL Unshaded Areas

ADDRESS: 2794 TRIGO WAY Suite: _____

PARCEL #: 274-0430-059

<p style="text-align: center;">CONTACT</p> <p>Name: _____ Street Address: _____ City/State/Zip: _____ Phone: _____ E-Mail: _____</p>	<p style="text-align: center;">LICENSED CONTRACTOR Lic No. # _____</p> <p>Name: _____ Street Address: _____ City/State/Zip: _____ Phone: _____ E-Mail: _____</p>
<p style="text-align: center;">ARCHITECT/ENGINEER</p> <p>Name: _____ Street Address: _____ City/State/Zip: _____ Phone: _____ E-Mail: _____</p>	<p style="text-align: center;">OWNER</p> <p>Name: <u>William & Linda Mincey</u> Street Address: <u>2794 TRIGO WAY</u> City/State/Zip: <u>SACRAMENTO, CA 95833</u> Phone: <u>916 924 1174</u> E-Mail: _____</p>

⇒ Will permittee have any employees on the jobsite? No Yes ⇒ Insurance Co.: _____

⇒ WORKER'S COMPANSATION POLICY # _____ EXPRATION DATE: _____

NATURE OF WORK IN DETAIL: CONVERT SFR TO HOMECARE FACILITY WITH NO MORE THAN 6 ~~PER~~ AMBULATORY CLIENTS

OCCUPANT/TENANT: William & Linda Mincey VALUATION: 200.00

FLOOD STATUS:			S.C.A.T.							
JOB DISCRPTION	BLDG	SHELL	APT	TI()	REM()	SW	FIRE	ADD	OTH	
INSPECTION DISCIPLINES			BLDG	MECH	PLUMB	ELEC		SITE	FIRE	
# Stories	1 st Flr Area	Total Area	Use Zone	Occp Group	Coast type	Fire Req. Y / N		Fed Code	Vio. [H]	File [Quad]
						SPR	ALARM			
B	(L)	P	M	(E)	(F)	S		D	PW	UTIL

COMMENTS: _____

REGIONAL SANITATION FEES? Yes No HEALTH DEPARTMENT: Yes No

WATER FLOW TEST FOR NEW BUILDINGS OR ADDITIONS? Provided Faxed

1st Floor
Hallway
near kitchen

Pull station

2794 TRIGO Way
0506883
Area 4

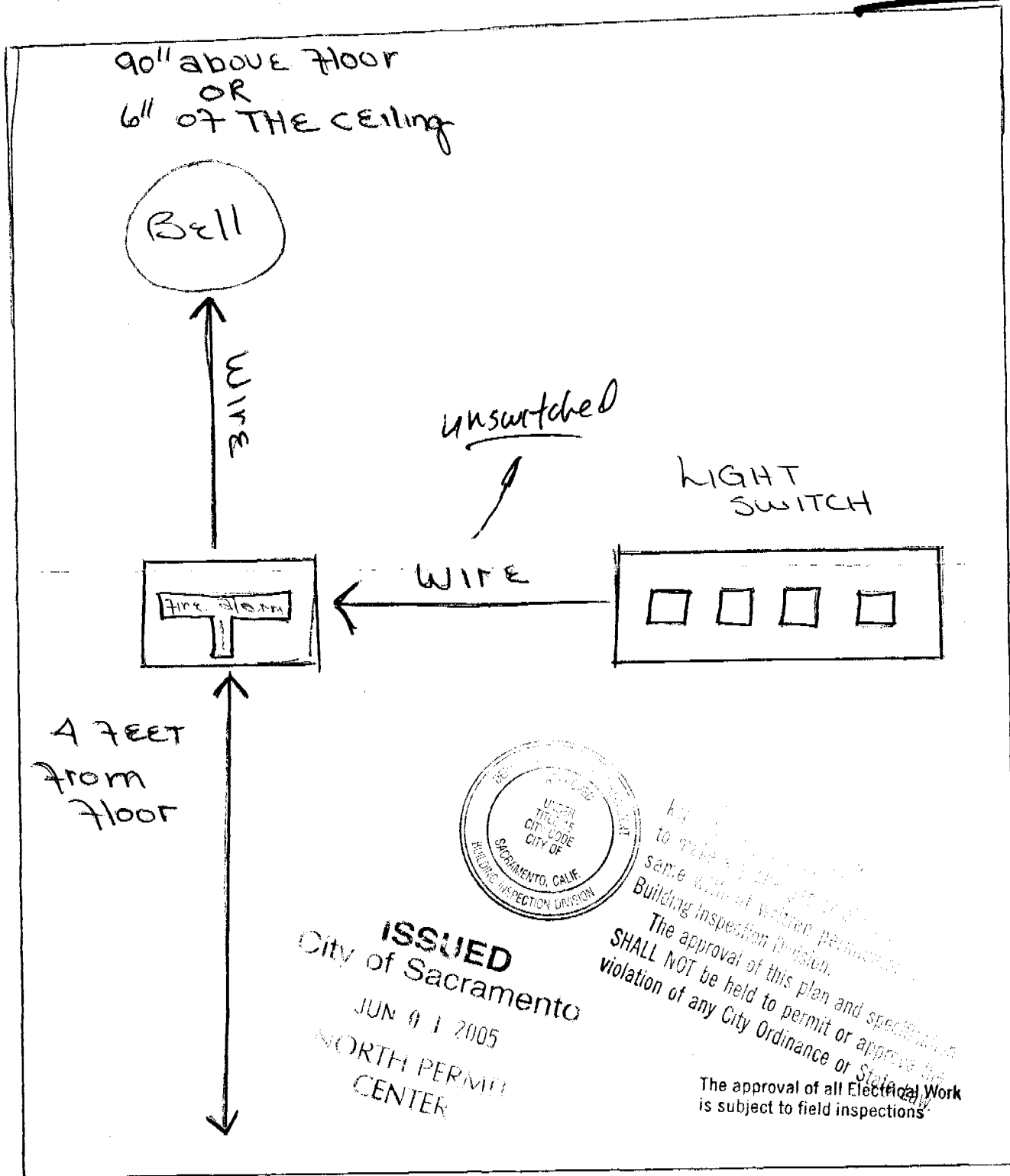

CITY COPY

0526883

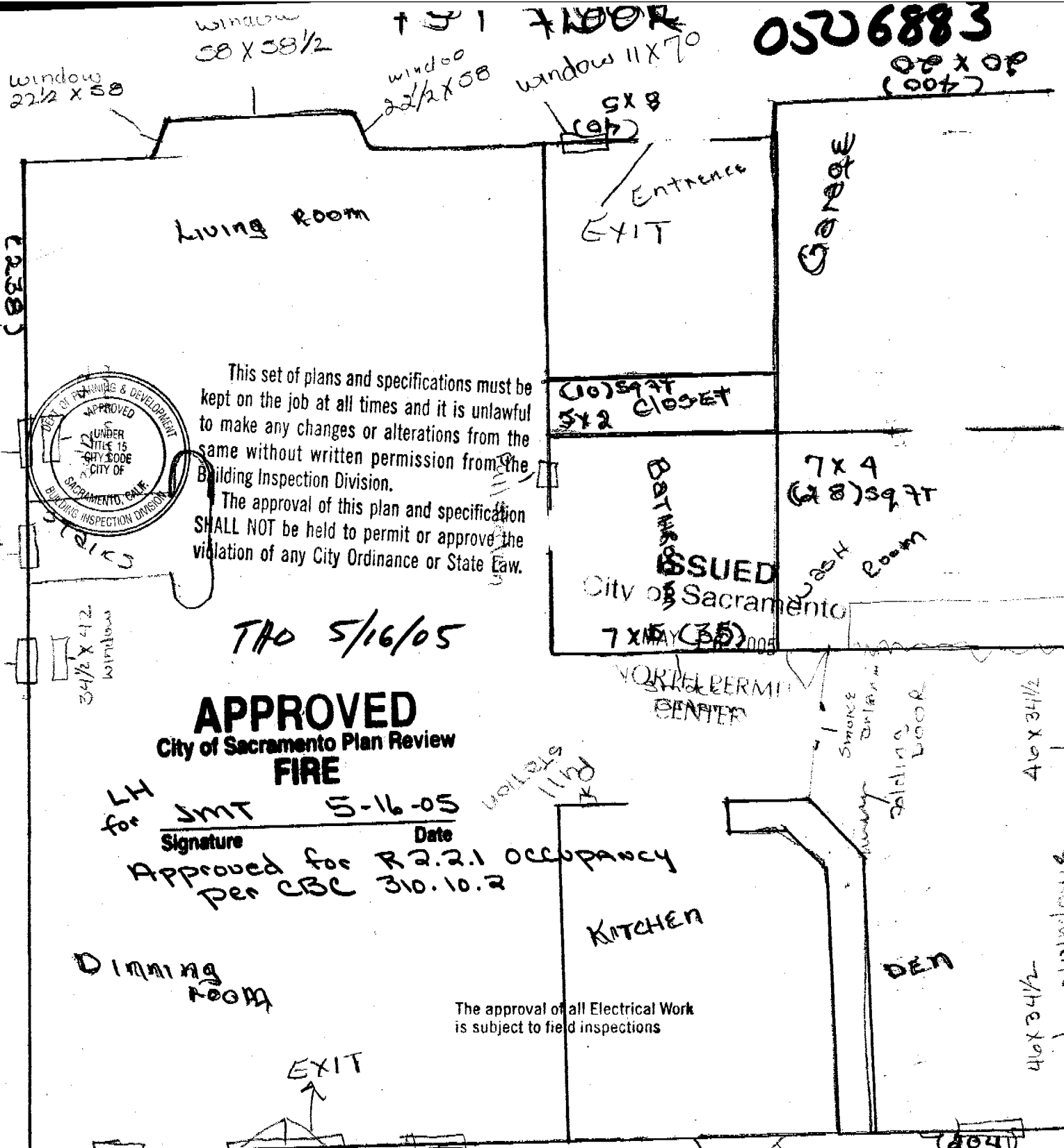

This set of plans and specifications must be kept on the job at all times and it is unlawful to make any changes or alterations from the same without written permission from the Building Inspection Division. The approval of this plan and specification SHALL NOT be held to permit or approve the violation of any City Ordinance or State Law.

APPROVED
City of Sacramento Plan Review
FIRE

LH for SMT 5-16-05
Signature Date

Approved for R2.2.1 OCCUPANCY
Per CBC 310.10.2

CITY COPY

Single Action
Hardware Req (Both Exits)
2794 TRIGO WY

2nd floor

14x12.5

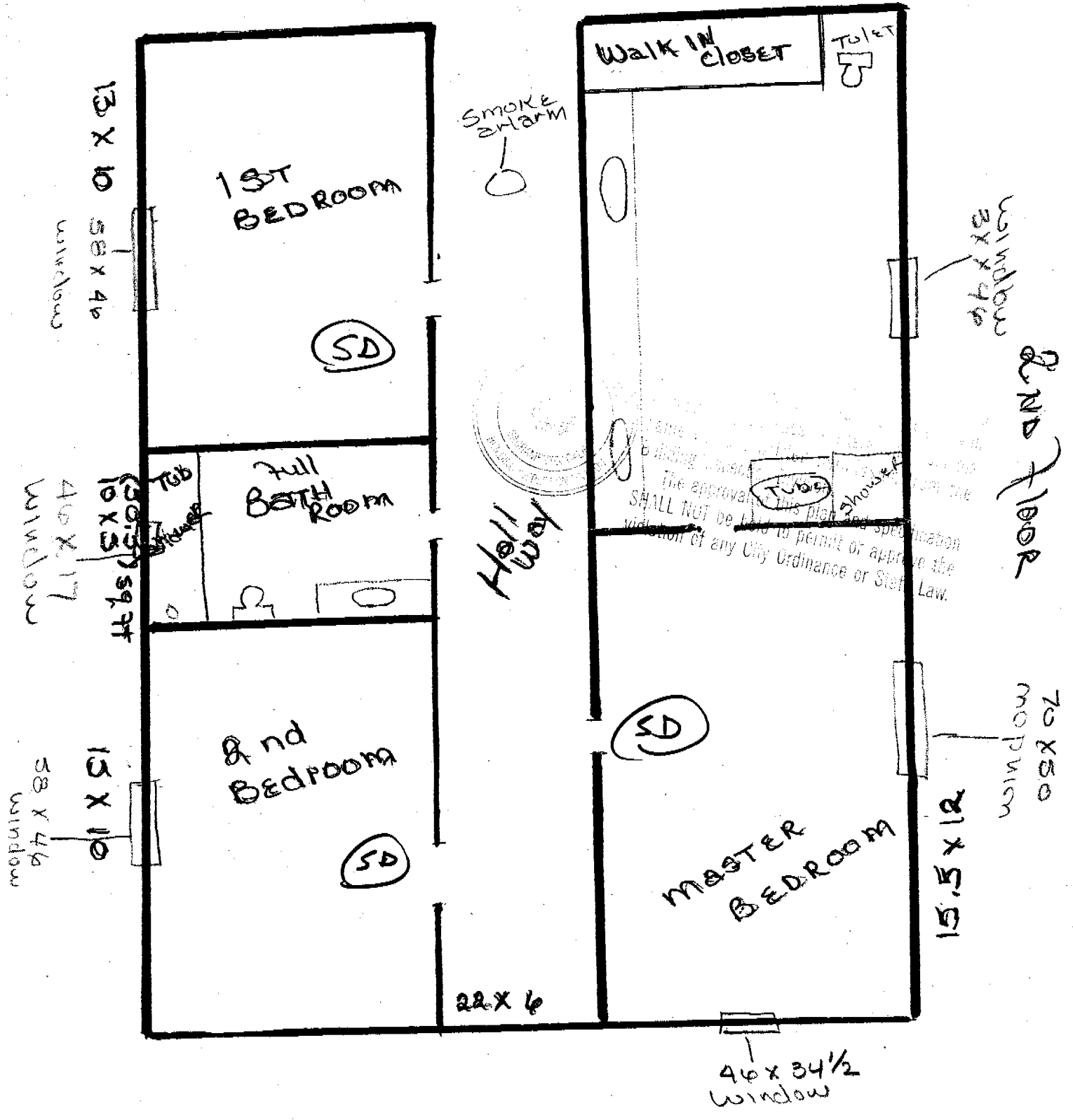

Installation and Service

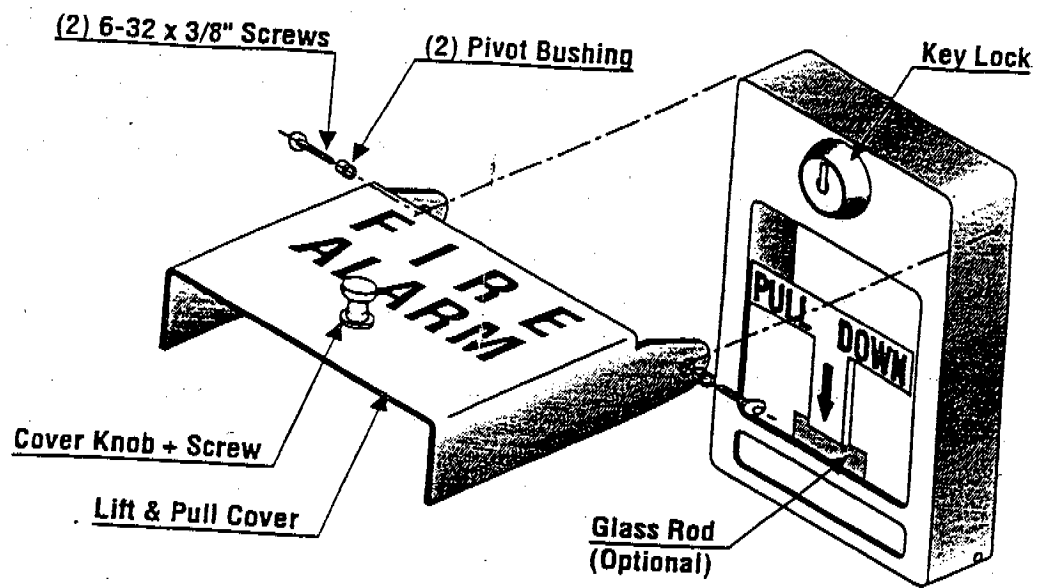

Installers Note:

The stations are supplied with glass rod removed. It is recommended that the station be activated and tested prior to installation of the glass rod.

- Glass Rods and Hardware are shipped with station in box.

Replacement of Glass Rod:

If broken, remove debris, then reset T-Handle to Normal Position. Insert one end of new Glass Rod under Spring Tab, then with one finger, lift other end of Spring Tab allowing Glass Rod to slip into place.

To Close Station:

If hex Screw Model, simply push station closed.
If Key Lock Model, hold station closed then turn key counterclockwise.

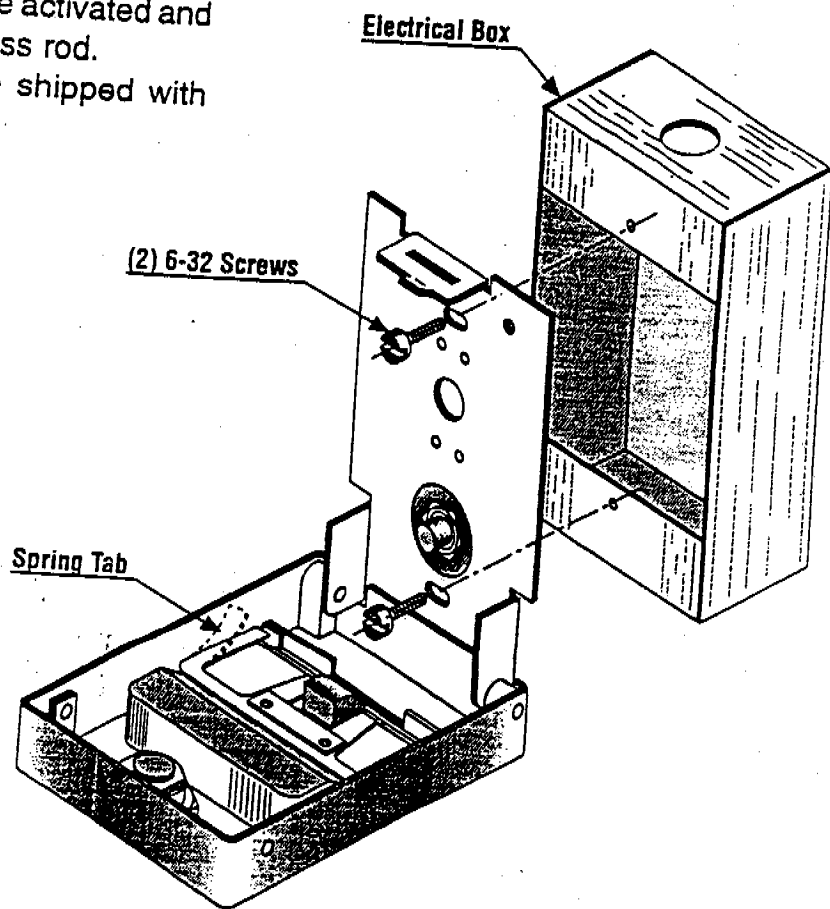

Wiring Instructions on Reverse Side

CALIFORNIA DEPARTMENT OF FORESTRY & FIRE PROTECTION
OFFICE OF THE STATE FIRE MARSHAL
FIRE ENGINEERING - BUILDING MATERIALS LISTING PROGRAM
LISTING SERVICE

Page 1 of 1

LISTING No. 7135-0587:005

CATEGORY: Audible Devices

LISTEE: American Security Equipment Co., Division of Kobishi America Inc., 228 E. Star of India Ln.
Carson CA 90746 Contact: Toby Tabata (310) 538-4670 FAX (310) 538-9932

DESIGN: Models MSB-6B, MSB-6B-PVT, MSB-8B, MSB-8B-PVT, MSB-10B and MSB-10B-PVT series motor-driven bells. Models with suffix G are for indoor use only; all other may be used outdoors when used with Models BBX-1 or BBX-4 backboxes.

INSTALLATION: In accordance with the listee's printed installation instructions, applicable codes and ordinances and in a manner acceptable to the authority having jurisdiction.

MARKING: Listee's name, model number, electrical rating and UL label.

APPROVAL: Listed as audible devices for use with separately listed compatible control units. If this appliance is required to produce a distinctive three-pulse Temporal Pattern Fire Alarm Evacuation Signal (for total evacuation) in accordance with NFPA 72, 1999 Edition, the appliance must be used with a fire alarm control unit that can generate the temporal pattern signal. Refer to manufacturer's Installation Manual for details.

XLF: 7135-0801:103

12-29-92



This listing is based upon technical data submitted by the applicant. CSFM Fire Engineering staff has reviewed the test results and/or other data but does not make an independent verification of any claims. This listing is not an endorsement or recommendation of the item listed. This listing should not be used to verify correct operational requirements or installation criteria. Refer to listee's data sheet, installation instructions and/or other suitable information sources.

Date Issued:

JUNE 21, 2004

- Listing Expires June 30, 2005

Authorized By:

**DIANE K. AREND, Senior Deputy
Program Manager**

PBA INSTALLATION INSTRUCTIONS

ALARM BELL MODEL 24/120VAC

INDOOR/OUTDOOR WALL MOUNT ONLY

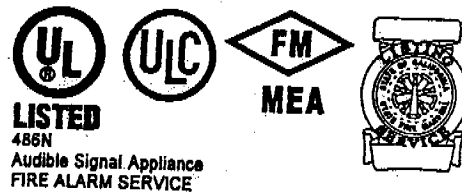

Instruction No. PBA6-H1008 020725a

Installation Note

1. Remove the gong
 2. Wire the bell in the circuit. Refer to Fig.1.
 3. Mount the base on a 4" square or 2" wide electrical box with the striker facing down. Refer to Fig.3.
 4. Replace the gong.
- *Note : The top of the bell must be mounted a minimum of 90" above the floor, or within 6" of the ceiling

Fig.1 Wiring (rear view)

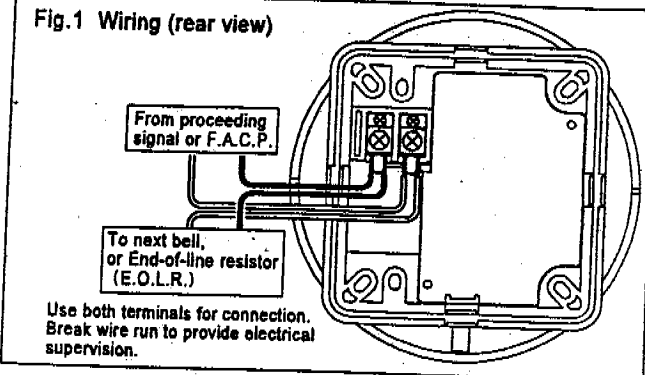

Fig.2 Basic Mechanism and Gongs Observe Polarity

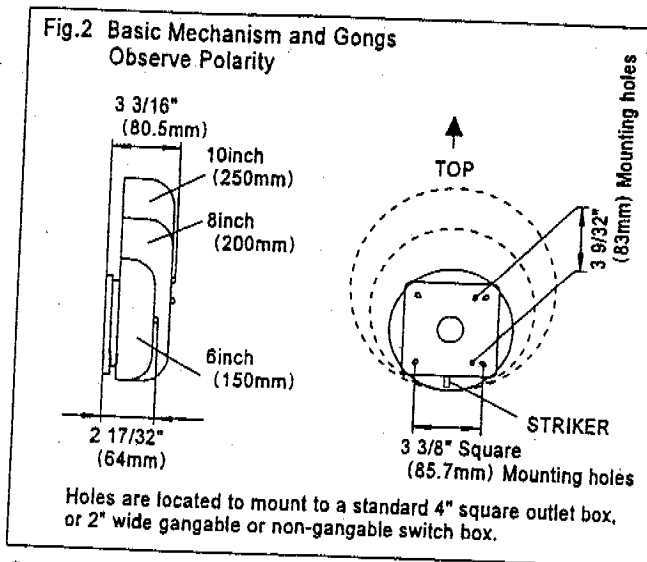
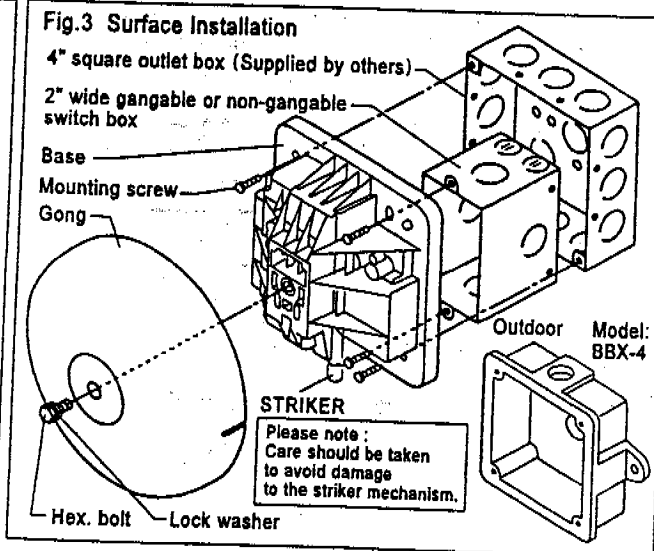

Fig.3 Surface Installation



Specifications

Model	Gong Size	Rating (Current Draw) mA						UL dB Rating (dB)					
		16VAC	24VAC	33VAC	96VAC	120VAC	132VAC	16VAC	24VAC	33VAC	96VAC	120VAC	132VAC
PBA-6 / PBA-6G	6inch	130	210	340	36	52	60	71.3	83.2	86.4	76.7	81.5	83.6
PBA-8 / PBA-8G	8inch							68.9	83.3	87.7	78.6	85.3	84.8
PBA-10 / PBA-10G	10inch							68.9	84.2	87.0	78.4	83.4	84.6

*Model #: PBA-6, PBA-8 and PBA-10 = Standard Red Color Gong. PBA-6G, PBA-8G and PBA-10G = Gray Color Gong

UL Spherical dB Measurement

Sound level measurement are made in accordance with UL standard 464. The sound power output is measured in a reverberant room qualified for pure tones under methods for the Determination of Sound Power Level of Small Sources in Reverberation Rooms. ANSI S1.21. bell shall be capable of providing a sound output equivalent to that of an omni-directional source with an A-weighted sound pressure level of at least the level specified in the unit marking but not less than 75 decibels in any case.

Indoor/Outdoor Measurement

Sound level in the indoor/outdoor installation may vary depending upon the spaces. Typical dB measurements with conventional sound level meters will be significantly higher in actual installations. UL and ULC dB values have different sound output measurement and calculation methods.

Note

Upon completion of initial installation. All bells shall be tested per NFPA 72. Periodic testing should be performed at least annually. Test more often if required by the authority having jurisdiction.

PBA INSTALLATION INSTRUCTIONS

ALARM BELL MODEL 24/120VAC

INDOOR/OUTDOOR WALL MOUNT ONLY

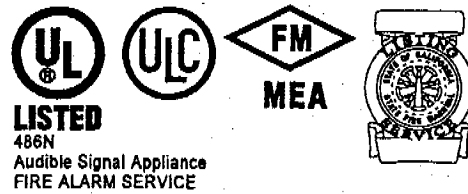

Installation Note

1. Remove the gong
 2. Wire the bell in the circuit. Refer to Fig. 1.
 3. Mount the base on a 4" square or 2" wide electrical box with the striker facing down. Refer to Fig. 3.
 4. Replace the gong.
- *Note : The top of the bell must be mounted a minimum of 90" above the floor, or within 6" of the ceiling

Fig.1 Wiring (rear view)

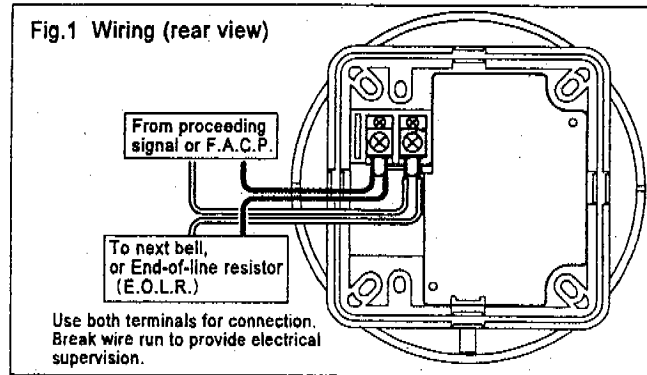

Fig.2 Basic Mechanism and Gongs Observe Polarity

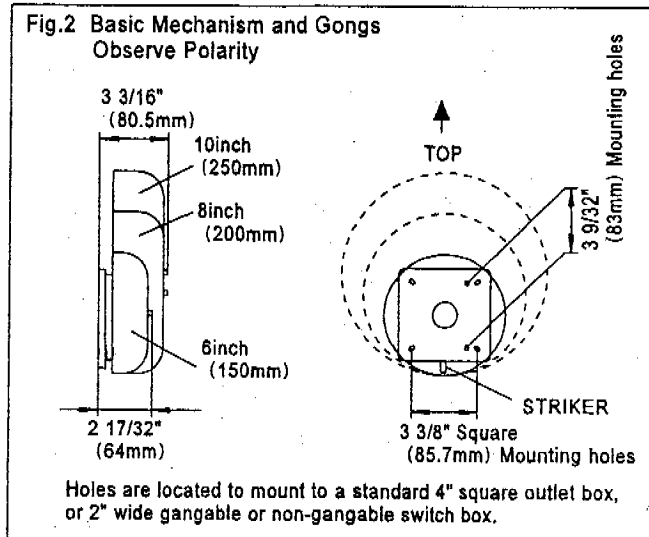
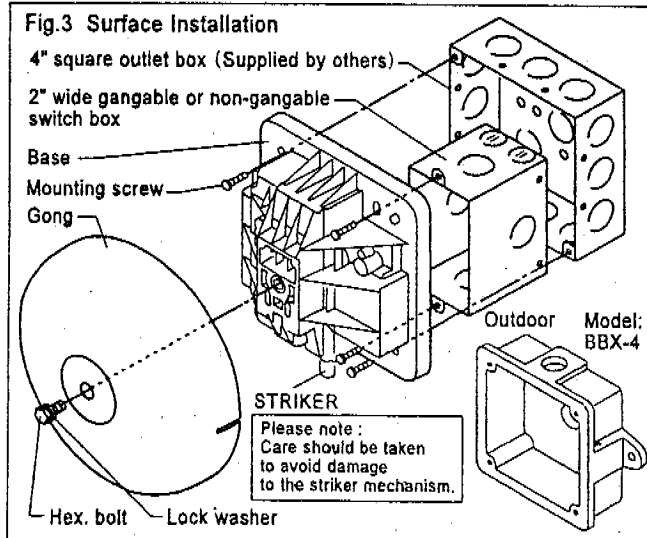

Fig.3 Surface Installation



Specifications

Model	Gong Size	Rating (Current Draw) mA						UL dB Rating (dB)					
		16VAC	24VAC	33VAC	96VAC	120VAC	132VAC	16VAC	24VAC	33VAC	96VAC	120VAC	132VAC
PBA-6 / PBA-6G	6inch	130	210	340	36	52	60	71.3	83.2	86.4	76.7	81.5	83.6
PBA-8 / PBA-8G	8inch							68.9	83.3	87.7	78.6	85.3	84.8
PBA-10 / PBA-10G	10inch							68.9	84.2	87.0	78.4	83.4	84.6

* Model #: PBA-6, PBA-8 and PBA-10 = Standard Red Color Gong. PBA-6G, PBA-8G and PBA-10G = Gray Color Gong

UL Spherical dB Measurement

Sound level measurement are made in accordance with UL standard 464. The sound power output is measured in a reverberant room qualified for pure tones under methods for the Determination of Sound Power Level of Small Sources in Reverberation Rooms. ANSI S1.21. bell shall be capable of providing a sound output equivalent to that of an omni-directional source with an A-weighted sound pressure level of at least the level specified in the unit marking but not less than 75 decibels in any case.

Indoor/Outdoor Measurement

Sound level in the indoor/outdoor installation may vary depending upon the spaces. Typical dB measurements with conventional sound level meters will be significantly higher in actual installations. UL and ULC dB values have different sound output measurement and calculation methods.

Note

Upon completion of initial installation. All bells shall be tested per NFPA 72. Periodic testing should be performed at least annually. Test more often if required by the authority having jurisdiction.

CALIFORNIA DEPARTMENT OF FORESTRY & FIRE PROTECTION
OFFICE OF THE STATE FIRE MARSHAL
FIRE ENGINEERING - BUILDING MATERIALS LISTING PROGRAM

LISTING SERVICE

LISTING No. 7150-0447:138

Page 1 of 1

CATEGORY: Boxes/Pull Stations

LISTEE: ESL/Sentrol, 12345 SW Leveton Drive, Tualatin, OR 97062
Contact: Gene Hukkanen (503) 691-7369 FAX (503) 691-7575

DESIGN: Model 103-20, 103-21, 103-22, 103-23, 103-24, 103-31, 103-32, 103-42, and 103-60
non-coded manual pull stations. Refer to listee's data sheet for additional detailed
product description and operational considerations.

INSTALLATION: In accordance with listee's printed installation instructions, applicable codes & ordinances
and in a manner acceptable to the authority having jurisdiction.

MARKING: Listee's name, model number, electrical rating and UL label.

APPROVAL: Listed as fire alarm manual pull stations for use with separately listed compatible fire
alarm control units. Model 103-60 is suitable for outdoor use.

XLF: 7150-1039:101

12-17-96



This listing is based upon technical data submitted by the applicant. CSFM Fire Engineering staff has reviewed the test results and/or other data but does not make an independent verification of any claims. This listing is not an endorsement or recommendation of the item listed. This listing should not be used to verify correct operational requirements or installation criteria. Refer to listee's data sheet, installation instructions and/or other suitable information sources.

Date Issued: **JUNE 21, 2004**

Listing Expires June 30, 2005

Authorized By: **DIANE K. AREND, Senior Deputy
Program Manager**