

CITY OF SACRAMENTO

1231 I Street, Sacramento, CA 95814

Permit No: 0114806

Insp Area: 4

Site Address: 2123 NEW HAMPSHIRE WY SAC

Thos Bros:

Parcel No: 225-1130-044

PARKWAY PLAZA UNIT 2 LOT 44

Sub-Type: NSFR

Housing (Y/N):

N

CONTRACTOR

**LENNAR RENAISSANCE INC
2240 DOUGLAS BL
ROSEVILLE, CA 95661**

OWNER

ARCHITECT

Nature of Work: MP 1968 PLAN 133 2 STORY 9 ROOM SFR

CONSTRUCTION LENDING AGENCY : I hereby affirm under penalty of perjury that there is a construction lending agency for the performance of the work for which this permit is issued (Sec. 3097, Civ. C).

Lender's Name _____

Lender's Address _____

LICENSED CONTRACTORS DECLARATION: I hereby affirm under penalty of perjury that I am licensed under provisions of Chapter 9 (commencing with section 7000) of Division 3 of the Business and Professions Code and my license is in full force and effect.

License Class B

License Number 732348

Date 1/8/02

Contractor Signature J. Price

OWNER-BUILDER DECLARATION: I hereby affirm under penalty of perjury that I am exempt from the contractors License Law for the following reason (Sec. 7031.5, Business and Professions Code; any city or county which requires a permit to construct, alter, improve, demolish, or repair any structure, prior to its issuance, also requires the applicant for such permit to file a signed statement that he or she is licensed pursuant to the provisions of the Contractors License Law (Chapter 9 (commencing with Section 7000) of Division 8 of the Business and Professions Code) or that he or she is exempt therefrom and the basis for the alleged exemption. Any violation of Section 7031.5 by any applicant for a permit subjects the applicant to a civil penalty of not more than five hundred dollars (\$500.00);

I, as a owner of the property, or my employees with wages as their sole compensation, will do the work, and the structure is not intended or offered for sale (Sec. 7044, Business and Professional Code: The Contractors License Law does not apply to an owner of property who builds or improves thereon, and who does such work himself or herself or through his/her own employees, provided that such improvements are not intended or offered for sale. If, however, the building or improvement is sold within one year of completion, the owner-builder will have the burden of proving that he/she did not build or improve for the purpose of sale.)

I, as owner of the property, am exclusively contracting with licensed contractors to construct the project (Sec. 7044, Business and Professions Code: The Contractors License Law does not apply to an owner of property who builds or improves thereon, and who contracts for such projects with a contractor(s) licensed pursuant to the Contractors License Law).

I am exempt under Sec. _____ B & PC for this reason: _____

Date _____

Owner Signature _____

IN ISSUING THIS BUILDING PERMIT, the applicant represents, and the city relies on the representation of the applicant, that the applicant verified all measurements and locations shown on the application or accompanying drawings and that the improvement to be constructed does not violate any law or private agreement relating to permissible or prohibited locations for such improvements. This building permit does not authorize any illegal location of any improvement or the violation of any private agreement relating to location of improvements.

I certify that I have read this application and state that all information is correct. I agree to comply with all city and county ordinances and state laws relating to building construction and hereby authorize representative(s) of this city to enter upon the abovementioned property for inspection purposes.

Date 1/8/02

Applicant/Agent Signature J. Price

WORKER'S COMPENSATION DECLARATION: I hereby affirm under penalty of perjury one of the following declarations:

I have and will maintain a certificate of consent to self-insure for workers' compensation as provided for by Section 3700 of the Labor Code, for the performance of work for which the permit is issued.

I have and will maintain workers' compensation insurance, as required by Section 3700 of the Labor Code, for the performance of the work for which this permit is issued. My workers' compensation insurance carrier and policy number are:

Carrier CNA INSURANCE COMPANY

Policy Number WC138201151

**PAID
CITY OF SACRAMENTO**

(This section need not be completed if the permit is for \$100 or less) I certify that in the performance of the work for which this permit is issued, I shall not employ any person in any manner so as to become subject to the workers' compensation laws of California and agree that if I should become subject to the workers' compensation provisions of Section 3700 of the Labor Code, I shall forthwith comply with those provisions.

Date 1/8/02

Applicant Signature J. Price

**NEIGHBORHOODS PLANNING
AND DEVELOPMENT SERVICES**

WARNING: FAILURE TO SECURE WORKER'S COMPENSATION COVERAGE IS UNLAWFUL AND SHALL SUBJECT AN EMPLOYER TO CRJMINAL PENALTIES AND CIVIL FINES UP TO ONE HUNDRED THOUSAND DOLLARS (\$100,000) IN ADDITION TO THE COST OF COMPENSATION, DAMAGES AS PROVIDED FOR IN SECTION 3706 OF THE LABOR CODE, INTEREST AND ATTORNEY'S FEE.

THIS PERMIT SHALL EXPIRE BY LIMITATION IF WORK IS NOT COMMENCED WITHIN 180 DAYS.

#44

OMEGA PRODUCTS INTERNATIONAL, INC.

DIAMOND WALL INSULATING STUCCO SYSTEM

JOB ADDRESS:

ICBO Report #4004

RENAISSANCE SPINDALWOOD

Date of Job Completion 5/29/02

PLASTERING CONTRACTOR:

Name: STUCCO WORKS, INC.

Address: 5900 Warehouse way Sacramento, CA. 95826

Telephone No: (916) 383-6699

Contractor Number of Diamond Wall System 2175

This is to certify that the exterior coating system on the building exterior at the above address has been installed in accordance with the evaluation report specified above and the manufacturer's instructions.

6/28/02

Date

[Signature]
Signature of authorized representative of
Plastering Contractor

This installation card must be presented to the building inspector after

CERTIFICATION OF INSULATION

<p style="text-align: center;">ADDRESS OR TRACT</p> <p style="font-size: 2em; font-family: cursive;">RENAISSANCE</p> <p style="text-align: right;">LOT # 44</p> <p style="font-size: 2em; font-family: cursive;">SANDLEWOOD</p>	<p style="text-align: center;">SACRAMENTO BUILDING PRODUCTS</p> <p><input checked="" type="checkbox"/> P.O. BOX 854, WEST SACRAMENTO, CA 95691 LIC. #202026</p> <p><input type="checkbox"/> 1309 MELODY ROAD, MARYSVILLE, CA 95901 LIC. #202026</p> <p><input type="checkbox"/> P.O. BOX 9651, FRESNO, CA 93793-9651 LIC. #202026</p> <p><input type="checkbox"/> P.O. BOX 1631, RENO, NV 89505 LIC. #10675</p> <p><input type="checkbox"/> 3326 A PONDEROSA WAY, LAS VEGAS, NV 89118 LIC. #10675</p> <p style="text-align: center;">DATE INSULATION COMPLETED 5-13-02</p>
--	--

WALLS		CEILINGS			FLOORS	
(SQUARE FEET)		(SQUARE FEET)			(SQUARE FEET)	
TYPE OF INSULATION		TYPE OF INSULATION			TYPE OF INSULATION	
MATERIAL FIBERGLASS		MATERIAL FIBERGLASS			MATERIAL FIBERGLASS	
FORM BATTS		FORM BATTS & BLOW			FORM BATTS	
MANUFACTURER'S PRODUCT I.D.		MANUFACTURER'S PRODUCT I.D.			MANUFACTURER'S PRODUCT I.D.	
MANUFACTURER		MANUFACTURER			MANUFACTURER	
OCF		OCF			OCF	
BAGS						
R - VALUE INSTALLED	APPLIED THICKNESS	R - VALUE INSTALLED	APPLIED THICKNESS	MIN. INSTALLED WEIGHT PER SQUARE FOOT	R - VALUE INSTALLED	APPLIED THICKNESS
13 19	3 5/8 5 1/4	30	9			
KNEE WALLS IF R-VALUE IS OTHER THAN WALLS ABOVE						
MATERIAL FIBERGLASS		FORM BATTS		R VALUE		MANUFACTURER OCF
AIR INFILTRATION SEALANT						
MATERIAL FOAM				MANUFACTURER W R GRACE		

THIS IS TO CERTIFY THAT INSULATION AND/OR SEALANT HAS BEEN INSTALLED IN CONFORMANCE WITH APPLICABLE CODES, MATERIAL STANDARDS AND REGULATIONS.

SIGNATURE—INSULATION CONTRACTOR <i>[Signature]</i>	TITLE MANAGER	DATE 5-15-02
SIGNATURE—GENERAL CONTRACTOR <i>[Signature]</i>	TITLE	DATE
REMARKS		

RESIDENTIAL BUILDING PERMIT APPLICATION

Lot: 44

- New Construction Addition Remodels Other

Project Address: 2123 New Hampshire Wy Assessor Parcel # 225-1130-044-00

OWNER INFORMATION: Parkway Plaza Village 2

Legal Property Owner: LENNAR RENAISSANCE Phone # (916) 773-7471
 Owner Address: 2240 DOUGLAS BLVD. City ROSEVILLE State CA Zip 95661

CONTRACTOR INFORMATION:

Contractor: LENNAR RENAISSANCE Lic. # 732348 Phone # (916) 773-7471 Fax # (916) 773-4086

PROJECT INFORMATION:

Land Use Zone R1A Occupancy Group RS Construction Type UN Fed Code IA
 No. of stories: 2 No. of rooms: _____ Street width: 40'
 1st Floor Area 993 2nd Floor Area 975 Basement N/A Roof Material Tile

AREA IN SQUARE FOOT OF:	EXISTING	NEW
Dwelling/Living	_____	<u>1968</u>
Garage/Storage	_____	<u>636</u>
Decks/Balconies	_____	_____
Carports	_____	_____

SCOPE OF WORK: _____

FOR OFFICE USE ONLY

- | | | |
|---|---|---|
| <input type="checkbox"/> Information above complete | <input type="checkbox"/> AR Flood Waiver required | <input type="checkbox"/> Planning Approval |
| <input type="checkbox"/> Violation files checked | <input type="checkbox"/> Flood Elevation Certificate Required | <input type="checkbox"/> Design Review Approval |
| <input type="checkbox"/> Standard setbacks | <input type="checkbox"/> Water Development Infill Area | <input type="checkbox"/> Special Fee Districts Apply: _____ |
| <input type="checkbox"/> County Sewer | | |

NEW STRUCTURES & ADDITIONS

*THE FOLLOWING MUST BE PROVIDED IN ORDER TO SUBMIT FOR PLAN REVIEW

- | | |
|---|---|
| <input type="checkbox"/> 2 COMPLETE PLANS, LEGIBLE & DRAWN TO SCALE | * Plans to include: site plan, floor plan, elevations, roof/ceiling plan, foundation and structural framing details, and structural calculations for non-conforming structures. |
| <input type="checkbox"/> 3 SETS IF PROJECT IS IN A DESIGN REVIEW AREA | |
| <input type="checkbox"/> Title 24 Energy Compliance documentation | <input type="checkbox"/> 11" x 17" copy of floor plan for County Assessor |
| <input type="checkbox"/> Grading and Erosion Control Questionnaire | <input type="checkbox"/> Plan Review Fees |

Date: _____ Received by: (staff) _____

ACTIVITY/PERMIT # _____

43
P=13.5

45
P=13.5

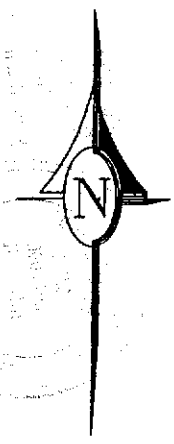
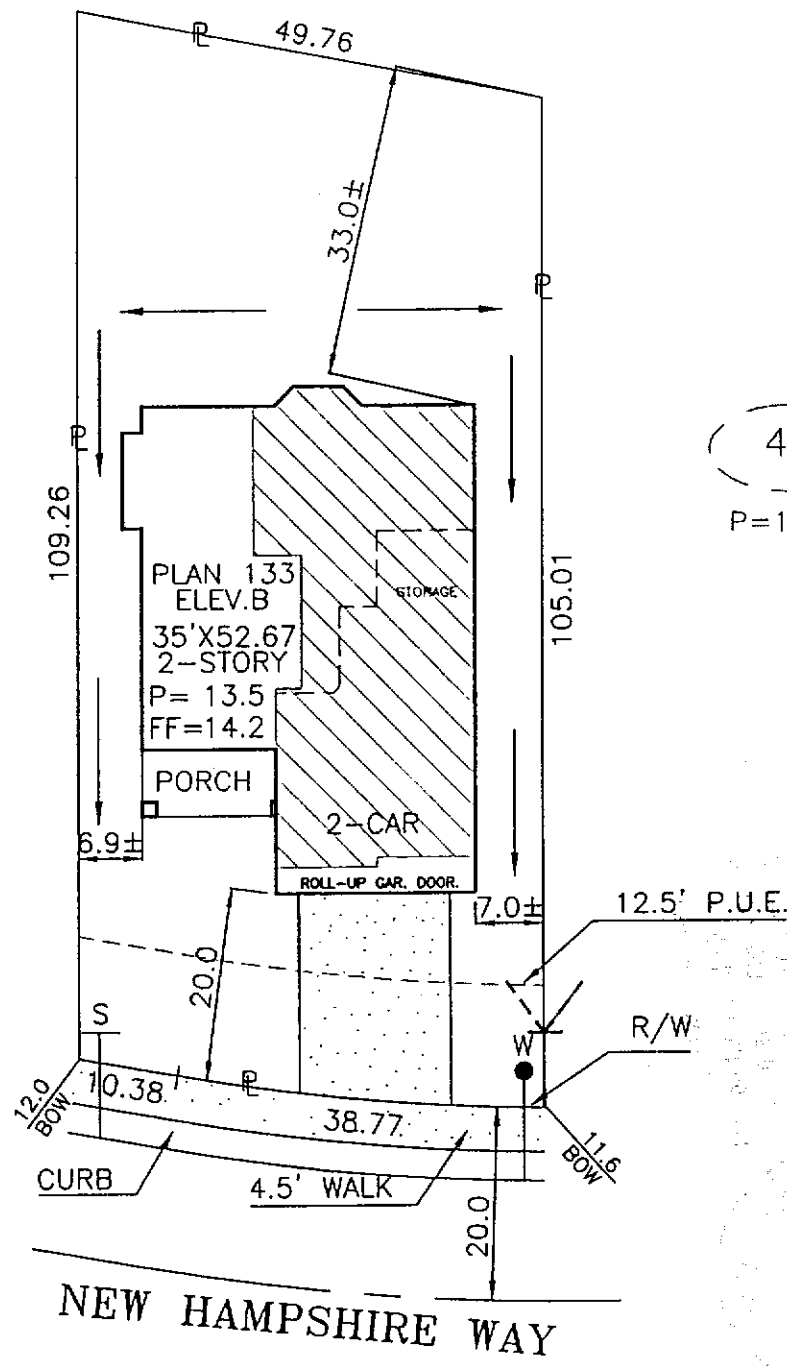

DIMENSIONS SHOWN ARE APPROXIMATE EXCEPT FOR MINIMUMS REQUIRED BY ORDINANCE. THIS PLOT DOES NOT REFLECT AS BUILT CONDITIONS AND MAY VARY FROM THIS PLAN.

RENAISSANCE HOMES 2240 DOUGLAS BLVD. SUITE 250 ROSEVILLE, CA. 95661 PHONE (916) 773-4083 FAX (916) 773-4086	PARKWAY PLAZA VILLAGE 2		PLOT PLAN
	PARKWAY PLAZA UNIT 2 CITY OF SACRAMENTO SACTO. COUNTY, CALIFORNIA		NOTES:
ADDRESS: 2123 NEW HAMPSHIRE WAY	LOT COV: 30%		
PLAN NO.: 133-B	LOT SQ. FT.: 5,269	APN: 225-113-044-000	
DRAWN BY: R.P.	APPROVED BY: <i>[Signature]</i>	DATE: 8/7/01	SCALE: 1"=20'
			LOT 44



CAPITOL ENGINEERING LABORATORIES, INC.

631 Commerce Drive, Suite #200 • Roseville, California 95678 • (916) 786-2488

JOB REPORT

PAGE: 1

PROJECT NAME: SANHEWOOD

FILE NO. 5317

INSPECTOR: marvin tohl

DATE: 4/12/04

PERSONS CONTACTED: ARMONDO

PERMIT #:

REFERENCE DOCUMENTS: ICBO Report #1945

WEATHER:

SERVICE PROVIDED: CONCRETE (INSP/SAMPLE ONLY/PU) MASONRY WELDING (SHOP/FIELD) SOILS

OTHER Epoxy Anchors

~~two~~ ~~two~~ proof loaded All $5/8"$ Epoxy Anchors
6015 lbs per ICBO without failures in
lots #44 one
#16 two

witness the installation of two $5/8"$ Epoxy Anchors
in lot # 17 ^{CLEAN Holes} ~~two~~ ^{AND the} ~~two~~ with the Embedment of ~~two~~
AND two $7/8"$ Epoxy Anchors AND ONE $5/8"$ Embedment
 $8"$ + AND $7/8"$ had Embedment $10"$ + into CLEAN Holes
using SIMPSON ET AL Exp Data of 2/04

COMPLIANCE OF WORK: Acceptable

ATTACHMENTS:

EQUIPMENT/SUPPLIES USED: Hydraulics

NEXT VISIT:

REMARKS:

REVIEWED BY: 

DATE: 4-12