

CITY OF SACRAMENTO  
1231 I Street, Sacramento, CA 95814

Permit No: 0011648

Insp Area: 2

Site Address: 11 NIEBAUM CT SAC

Parcel No: 117-1360-029

JACINTO VILLAGE LOT 29

Sub-Type: NSFR

Housing (Y/N): N

CONTRACTOR

BEAZER HOMES  
3009 DOUGLAS BL #150  
ROSEVILLE CA 95661

OWNER

ARCHITECT

Nature of Work: NSFR MP1441 7 RMS

**CONSTRUCTION LENDING AGENCY:** I hereby affirm under penalty of perjury that there is a construction lending agency for the performance of the work for which this permit is issued (Sec. 3097, Civ. C).

Lender's Name \_\_\_\_\_ Lender's Address \_\_\_\_\_

**LICENSED CONTRACTORS DECLARATION:** I hereby affirm under penalty of perjury that I am licensed under provisions of Chapter 9 (commencing with section 7000) of Division 3 of the Business and Professions Code and my license is in full force and effect.

License Class B License Number 724191 Date 10/4/00 Contractor Signature Sheuyf Van Maeren

**OWNER-BUILDER DECLARATION:** I hereby affirm under penalty of perjury that I am exempt from the contractors License Law for the following reason (Sec. 7031.5, Business and Professions Code; any city or county which requires a permit to construct, alter, improve, demolish, or repair any structure, prior to its issuance, also requires the applicant for such permit to file a signed statement that he or she is licensed pursuant to the provisions of the Contractors License Law (Chapter 9 (commencing with Section 7000) of Division 8 of the Business and Professions Code) or that he or she is exempt therefrom and the basis for the alleged exemption. Any violation of Section 7031.5 by any applicant for a permit subjects the applicant to a civil penalty of not more than five hundred dollars (\$500.00);

\_\_\_\_ I, as a owner of the property, or my employees with wages as their sole compensation, will do the work, and the structure is not intended or offered for sale (Sec. 7044, Business and Professional Code: The Contractors License Law does not apply to an owner of property who builds or improves thereon, and who does such work himself or herself or through his/her own employees, provided that such improvements are not intended or offered for sale. If, however, the building or improvement is sold within one year of completion, the owner-builder will have the burden of proving that he/she did not build or improve for the purpose of sale.)

\_\_\_\_ I, as owner of the property, am exclusively contracting with licensed contractors to construct the project (Sec. 7044, Business and Professions Code: The Contractors License Law does not apply to an owner of property who builds or improves thereon, and who contracts for such projects with a contractor(s) licensed pursuant to the Contractors License Law).

\_\_\_\_ I am exempt under Sec. \_\_\_\_\_ B & PC for this reason: \_\_\_\_\_

Date \_\_\_\_\_ Owner Signature \_\_\_\_\_

**IN ISSUING THIS BUILDING PERMIT,** the applicant represents, and the city relies on the representation of the applicant, that the applicant verified all measurements and locations shown on the application or accompanying drawings and that the improvement to be constructed does not violate any law or private agreement relating to permissible or prohibited locations for such improvements. This building permit does not authorize any illegal location of any improvement or the violation of any private agreement relating to location of improvements.

I certify that I have read this application and state that all information is correct. I agree to comply with all city and county ordinances and state laws relating to building construction and hereby authorize representative(s) of this city to enter upon the above mentioned property for inspection purposes.

Date 10/4/00 Applicant/Agent Signature Sheuyf Van Maeren

**WORKER'S COMPENSATION DECLARATION:** I hereby affirm under penalty of perjury one of the following declarations:

\_\_\_\_ I have and will maintain a certificate of consent to self-insure for workers' compensation as provided for by Section 3700 of the Labor Code, for the performance of work for which the permit is issued.

I have and will maintain workers' compensation insurance, as required by Section 3700 of the Labor Code, for the performance of the work for which this permit is issued. My workers' compensation insurance carrier and policy number are:

Carrier LIBERTY MUTUAL INS CO. Policy Number WA2-651-004147-080

\_\_\_\_ (This section need not be completed if the permit is for \$100 or less) I certify that in the performance of the work for which this permit is issued, I shall not employ any person in any manner so as to become subject to the workers' compensation laws of California and agree that I shall become subject to the workers' compensation provisions of Section 3700 of the Labor Code, and shall forthwith comply with those provisions.

Date 10/4/00 Applicant Signature Sheuyf Van Maeren

**WARNING: FAILURE TO SECURE WORKER'S COMPENSATION COVERAGE IS UNLAWFUL AND SHALL SUBJECT AN EMPLOYER TO CRIMINAL PENALTIES AND CIVIL FINES UP TO ONE HUNDRED THOUSAND DOLLARS (\$100,000) IN ADDITION TO THE COST OF COMPENSATION, DAMAGES AS PROVIDED FOR IN SECTION 3706 OF THE LABOR CODE, INTEREST AND ATTORNEY'S FEE.**

**THIS PERMIT SHALL EXPIRE BY LIMITATION IF WORK IS NOT COMMENCED WITHIN 180 DAYS.**

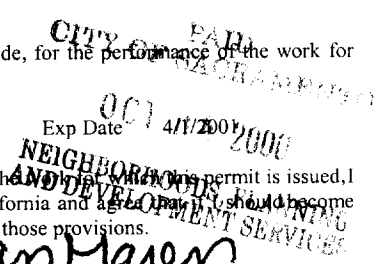

### RESIDENTIAL BUILDING PERMIT APPLICATION

New Construction     Addition     Remodels     Other

Project Address: 11 Meadow Pt. Lot 29    Assessor Parcel # 117-136-029

#### OWNER INFORMATION:

Legal Property Owner: Beazer Homes    Phone # 773-3888  
Owner Address: 3009 Douglas Blvd. 150    City Roseville    State CA    Zip 95661

#### CONTRACTOR INFORMATION:

Contractor: Beazer Homes    Lic. # B724191    Phone # 773-3888    Fax# 773-0425

#### PROJECT INFORMATION:

Land Use Zone \_\_\_\_\_ Occupancy Group \_\_\_\_\_ Construction Type \_\_\_\_\_ Fed Code \_\_\_\_\_  
 No. of stories: 1    No. of rooms: 7    Street width: 40'  
 1<sup>st</sup> Floor Area 1441    2<sup>nd</sup> Floor Area \_\_\_\_\_    Basement \_\_\_\_\_    Roof Material \_\_\_\_\_

AREA IN SQUARE FOOT OF:	EXISTING	NEW
Dwelling/Living	_____	<u>1441</u>
Garage/Storage	_____	<u>439</u>
Decks/Balconies	_____	<u>18</u>
Carports	_____	_____

SCOPE OF WORK: \_\_\_\_\_

#### FOR OFFICE USE ONLY

- Information above complete     AR Flood Waiver required     Planning Approval
- Violation files checked     Flood Elevation Certificate Required     Design Review Approval
- Standard setbacks     Water Development Infill Area     Special Fee Districts Apply : \_\_\_\_\_
- County Sewer

#### NEW STRUCTURES & ADDITIONS

◆ THE FOLLOWING MUST BE PROVIDED IN ORDER TO SUBMIT FOR PLAN REVIEW

- 2 COMPLETE PLANS, LEGIBLE & DRAWN TO SCALE    ◆ Plans to include: site plan, floor plan, elevations, roof/ceiling plan, foundation and structural framing details, and structural calculations for non-conforming structures.
- 3 SETS IF PROJECT IS IN A DESIGN REVIEW AREA
- Title 24 Energy Compliance documentation     11" x 17" copy of floor plan for County Assessor
- Grading and Erosion Control Questionnaire     Plan Review Fees

Date: \_\_\_\_\_

Received by: (staff) \_\_\_\_\_

ACTIVITY/PERMIT # \_\_\_\_\_

**KWIKKOTE**  
STUCCO SYSTEM  
INSTALLATION CARD

# 21006  
BEAZER HOMES  
BELLEFLEUR LOT 29  
11 NIEBAUM COURT SACRAMENTO

Stucco System Trade Name: KWIK KOTE  
Name Stucco Manufacturer: KWIK KOTE CORP  
ICBO Evaluation Service, Inc. Report No. 3607  
Date of Job Completion \_\_\_\_\_

Stucco Contractor Kenyon Plastering, Inc.  
Name John W. Kenyon, III  
Address P.O. Box 2077  
North Highlands, CA 95660  
Telephone # (916) 349-8191

Approved Contractor Number as issued by the Stucco Manufacturer: 1

This is to certify that the stucco system on the building exterior at the above address had been installed in accordance with the evaluation report specified above and the manufacturer's instructions.

Signature of authorized representative of stucco contractor:

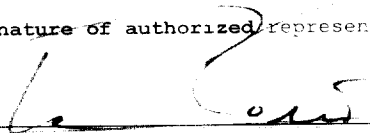

Date: 3-23-01

Builder Copy

# CERTIFICATION OF INSULATION

PART I GENERAL

PART II AREAS INSULATED

PART III COMMENTS

ADDRESS OR TRACT

SACRAMENTO INSULATION CONTRACTORS

BEAZER

OT-0029

- P.O. BOX 854, WEST SACRAMENTO, CA 95691 LIC. #202026
- 1309 MELODY ROAD, MARYSVILLE, CA 95901 LIC. #202026
- P.O. BOX 9651, FRESNO, CA 93793-9651 LIC. #202026
- P.O. BOX 1631, RENO, NV 89505 LIC. #10675
- 3326 A PONDEROSA WAY, LAS VEGAS, NV 89118 LIC. #10675

BELLE FLEUR

DATE INSULATION COMPLETED  
3/17/01

WALLS

CEILINGS

FLOORS

( SQUARE FEET)

( SQUARE FEET)

( SQUARE FEET)

TYPE OF INSULATION

TYPE OF INSULATION

TYPE OF INSULATION

MATERIAL

FIBERGLASS

MATERIAL

FIBERGLASS

MATERIAL

FIBERGLASS

FORM

BATTS

FORM

BATTS & BLOW

FORM

BATTS

MANUFACTURER'S PRODUCT ID

MANUFACTURER'S PRODUCT ID

MANUFACTURER'S PRODUCT ID

MANUFACTURER

MANUFACTURER

MANUFACTURER

OCF

OCF

OCF

R - VALUE INSTALLED

APPLIED THICKNESS

R - VALUE INSTALLED

APPLIED THICKNESS

MIN. INSTALLED WEIGHT PER SQUARE FOOT

R - VALUE INSTALLED

APPLIED THICKNESS

13

3 5/8

30

9"

30

12"

KNEE WALLS IF R-VALUE IS OTHER THAN WALLS ABOVE

MATERIAL

FIBERGLASS

FORM

BATTS

R VALUE

MANUFACTURER

OCF

AIR INFILTRATION SEALANT

MATERIAL

FOAM

MANUFACTURER

W R GRACE

**THIS IS TO CERTIFY THAT INSULATION AND/OR SEALANT HAS BEEN INSTALLED IN CONFORMANCE WITH APPLICABLE CODES, MATERIAL STANDARDS AND REGULATIONS.**

SIGNATURE - INSULATION CONTRACTOR

*Bill Grayson*

SIGNATURE - GENERAL CONTRACTOR

TITLE

MANAGER

DATE

3/5/01

TITLE

DATE

REMARKS

THIS PLOT PLAN IS NOT FOR SALES PURPOSES. THIS PLOT PLAN IS FOR THE PURPOSES OF INDICATING COMPLIANCE WITH ZONING SET BACKS, GENERAL DRAINAGE DIRECTION, AND APPROXIMATE UTILITY CONNECTION. ALL OTHER DATA SHOWN HEREON IS CONCEPTUAL. THIS PLOT PLAN DOES NOT REFLECT AS-BUILT CONDITION. RETAINING WALLS ARE OPTIONAL AND MAY OR MAY NOT BE CONSTRUCTED.

- W — WATER METER BOX
- E — ELECTRICAL BOX
- ⊕ — UTILITY RISERS
- ⊙ — SEWER CLEANOUT
- ⊠ — TELEPHONE PED.
- ⊗ — STREET LIGHT

# NIEBAUM CT.

FRONT YARD  
VARIABLE  
SETBACK  
15'-26'(TYP)

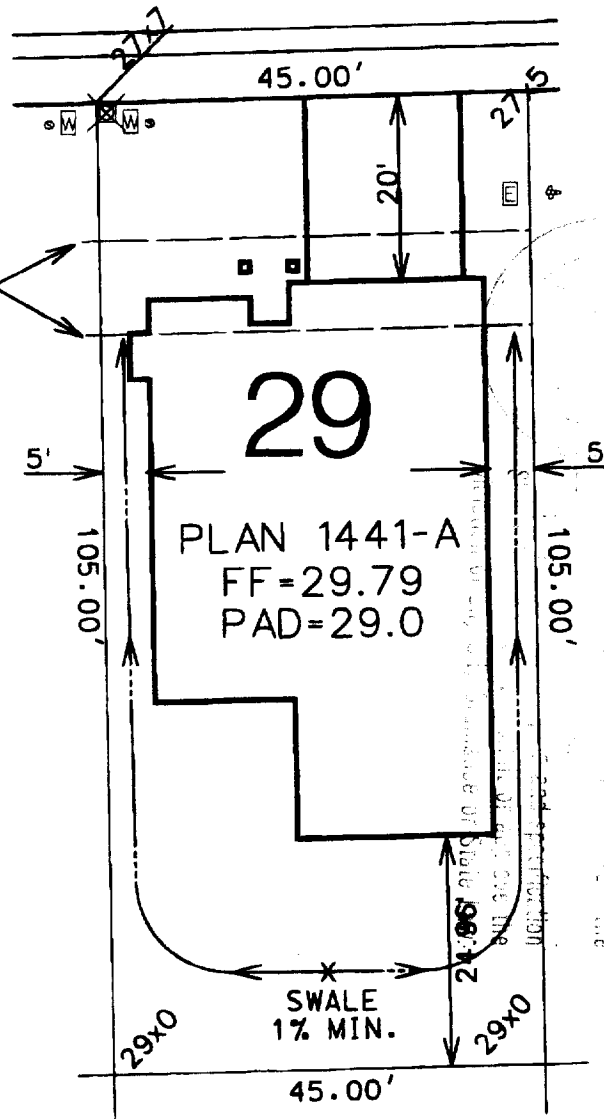

SCALE: 1"=20'

4725 SQUARE FEET

  <p>CML - WATER RESOURCES - SURVEYING</p>	PLOT PLAN FOR LOT 29		SCALE: 1"=20'
	JACINTO VILLAGE SOUTH		DATE: 09-06-00
	A.P.N. 117-1360-029 ADDRESS: COUNTY: SACRAMENTO		REVISED:
			DRAWN BY: PRA
			CHK'D. BY: LK
		W.O. 0435-01	