

RESOLUTION NO. 2007-823

Adopted by the Sacramento City Council

November 13, 2007

APPROVING AN AMENDMENT TO THE SOUTH SACRAMENTO COMMUNITY PLAN LAND USE MAP FROM RESIDENTIAL (4-8 DU/NA) TO RESIDENTIAL (7-15 DU/NA) FOR THE PROPERTY LOCATED AT 6524 LEMON HILL AVENUE (LEMON HILL ESTATES, P07-034) (APN 038-0111-016)

BACKGROUND

The City Council conducted a public hearing on November 13, 2007 concerning the South Sacramento Community Plan land use map and based on documentary and oral evidence submitted at the public hearing, the City Council hereby finds:

- A. The proposed Community Plan Land Use Map Amendment is compatible with the surrounding land uses;
- B. The subject site is suitable for single-family residential development; and
- C. The proposal is consistent with the policies of the General Plan and the South Sacramento Community Plan to promote a variety of housing types within neighborhoods to encourage economic diversity and housing choice.

BASED ON THE FACTS SET FORTH IN THE BACKGROUND, THE CITY COUNCIL RESOLVES AS FOLLOWS:

- Section 1. The City Council adopts the Community Plan Amendment for the property, as described on the attached Exhibit A, in the City of Sacramento, which hereby re-designates 2.55± acres on the South Sacramento Community Plan land use map from Residential (4-8 du/na) to Residential (7-15 du/na) (APN 038-0111-016).

Table of Contents:

Exhibit A: South Sacramento Community Plan Land Use Map Amendment
Exhibit

Adopted by the City of Sacramento City Council on November 13, 2007 by the following vote:

Ayes: Councilmembers Cohn, Fong, Hammond, McCarty, Pannell, Sheedy, and Waters.

Noes: None.

Abstain: None.

Absent: Councilmember Tretheway and Mayor Fargo.

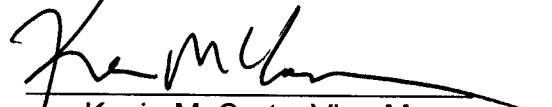

Kevin McCarty, Vice-Mayor

Attest:

Shirley Concolino, City Clerk

Exhibit A – South Sacramento Community Plan Land Use Map Amendment
Exhibit

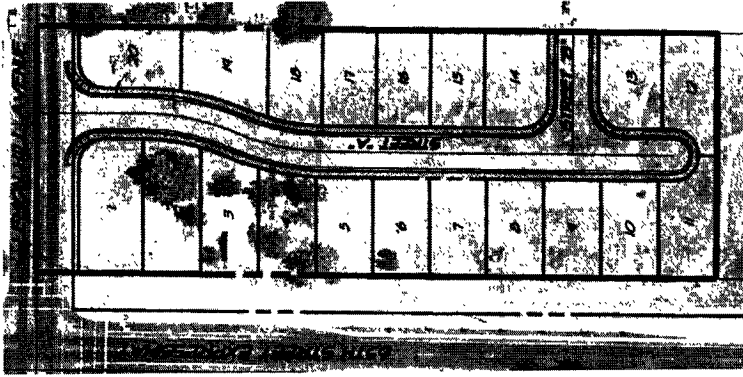
PROPOSED COMMUNITY PLAN
RESIDENTIAL (7-15 UNITS/ACRE)



EXISTING COMMUNITY PLAN
RESIDENTIAL (4-8 UNITS/ACRE)



RIECHERS SPENCE
CONSULTANTS
CITY ENGINEERS
LANDMARK & SURVEYING
3100 Watt Ave., Suite B
Sacramento, CA 95821
916-488-8263
916-488-1675

COMMUNITY PLAN AMMENDMENT
EXHIBIT

APN # 038-0111-016
6524 LEMON HILL AVENUE
CITY OF SACRAMENTO
COUNTY OF SACRAMENTO
STATE OF CALIFORNIA

