

RESOLUTION NO. 2008-192

Adopted by the Sacramento City Council

March 25, 2008

AMENDING THE GENERAL PLAN LAND USE MAP FROM LOW DENSITY RESIDENTIAL TO NEIGHBORHOOD/COMMUNITY COMMERCIAL AND OFFICE (7725 SHELDON ROAD) (P07-098) (APN: 117-0212-056)

BACKGROUND

The City Council conducted a public hearing on March 25, 2008 concerning the above plan amendment and based on documentary and oral evidence submitted at the public hearing, the Council hereby finds:

1. The proposed land use amendments are compatible with the surrounding land uses;
2. The subject site is suitable for neighborhood commercial development; and
3. The proposal is consistent with the policies of the General Plan.

BASED ON THE FACTS SET FORTH IN THE BACKGROUND, THE CITY COUNCIL RESOLVES AS FOLLOWS:

Section 1. The property described on the attached Exhibit A in the City of Sacramento is hereby redesignated on the General Plan Land Use Map as 1.49± net acres of Neighborhood/Community Commercial and Office. (APN: 117-0212-056)

Table of Contents:

Exhibit A - General Plan Amendment

Adopted by the City of Sacramento City Council on March 25, 2008 by the following vote:

Ayes: Councilmembers Cohn, Fong, Hammond, McCarty, Pannell, Sheedy, Tretheway, Waters, and Mayor Fargo.

Noes: None.

Abstain: None.

Absent: None.



Mayor Heather Fargo

Attest:



Dawn Bullwinkel, Assistant City Clerk

Exhibit A - General Plan Amendment

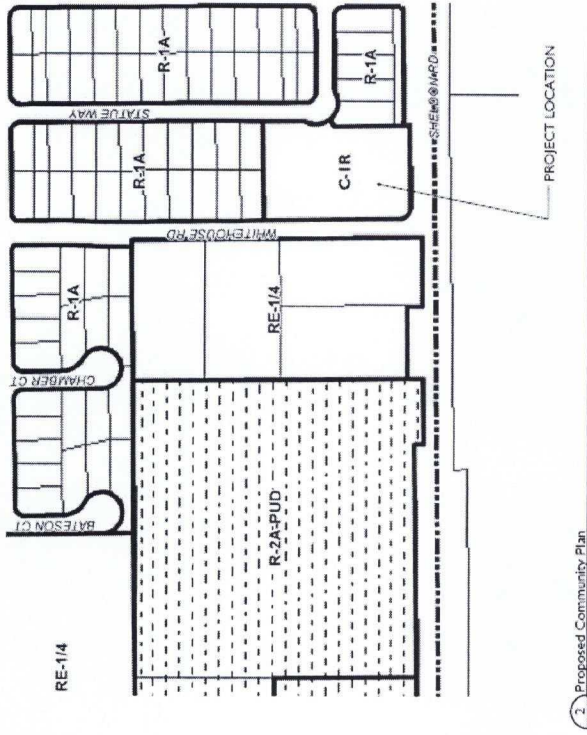

General Plan (P): Community/Neighborhood Commercial
 Community Plan (P): General Commercial
 Zoning (P): C-1R

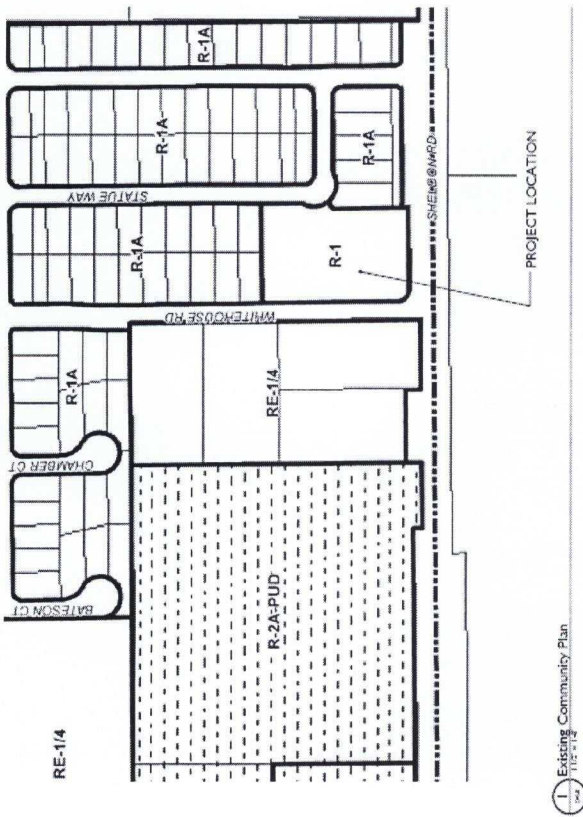

General Plan (E): Low Density Residential
 Community Plan (E): Low Density Residential
 Zoning (E): R-1