

CITY OF SACRAMENTO

Permit No: 9810874

1231 I Street, Sacramento, CA 95814

Insp Area: 2

Site Address: 7909 BRUCEVILLE RD SAC

Parcel No: 1170330007

Sub-Type: COM

Housing (Y/N): N

CONTRACTOR

INNERWORKS FIRE&CONSTRUCTION

OWNER

POB6388

VACAVILLE CA

95696-6388

1336

SAN JOSE CA

95125

ARCHITECT

M M D D SACRAMENTO PROJECTS

Nature of Work: HOOD FIRE SUPPRESSION SYSTEM

CONSTRUCTION LENDING AGENCY : I hereby affirm under penalty of perjury that there is a construction lending agency for the performance of the work for which this permit is issued (Sec. 3097, Civ. C).

Lender's Name _____ Lender's Address _____

LICENSED CONTRACTORS DECLARATION: I hereby affirm under penalty of perjury that I am licensed under provisions of Chapter 9 (commencing with section 7000) of Division 3 of the Business and Professions Code and my license is in full force and effect.

X License Class C License Number 673462 Date 11/4/98 Contractor Signature Tom Housou

OWNER-BUILDER DECLARATION: I hereby affirm under penalty of perjury that I am exempt from the contractors License Law for the following reason (Sec. 7031.5, Business and Professions Code; any city or county which requires a permit to construct, alter, improve, demolish, or repair any structure, prior to its issuance, also requires the applicant for such permit to file a signed statement that he or she is licensed pursuant to the provisions of the Contractors License Law (Chapter 9 (commencing with Section 7000) of Division 8 of the Business and Professions Code) or that he or she is exempt therefrom and the basis for the alleged exemption. Any violation of Section 7031.5 by any applicant for a permit subjects the applicant to a civil penalty of not more than five hundred dollars (\$500.00);

I, as a owner of the property, or my employees with wages as their sole compensation, will do the work, and the structure is not intended or offered for sale (Sec. 7044, Business and Professional Code: The Contractors License Law does not apply to an owner of property who builds or improves thereon, and who does such work himself or herself or through his/her own employees, provided that such improvements are not intended or offered for sale. If, however, the building or improvement is sold within one year of completion, the owner-builder will have the burden of proving that he/she did not build or improve for the purpose of sale.)

I, as owner of the property, am exclusively contracting with licensed contractors to construct the project (Sec. 7044, Business and Professions Code: The Contractors License Law does not apply to an owner of property who builds or improves thereon, and who contracts for such projects with a contractor(s) licensed pursuant to the Contractors License Law).

I am exempt under Sec. _____ B & PC for this reason: _____

Date _____ Owner Signature _____

IN ISSUING THIS BUILDING PERMIT, the applicant represents, and the city relies on the representation of the applicant, that the applicant verified all measurements and locations shown on the application or accompanying drawings and that the improvement to be constructed does not violate any law or private agreement relating to permissible or prohibited locations for such improvements. This building permit does not authorize any illegal location of any improvement or the violation of any private agreement relating to location of improvements.

I certify that I have read this application and state that all information is correct. I agree to comply with all city and county ordinances and state laws relating to building construction and herby authorize representative(s) of this city to enter upon the abovementioned property for inspection purposes.

X Date 11/4/98 Applicant/Agent Signature Tom Housou

WORKER'S COMPENSATION DECLARATION: I hereby affirm under penalty of perjury one of the following declarations:

X I have and will maintain a certificate of consent to self-insure for workers' compensation as provided for by Section 3700 of the Labor Code, for the performance of work for which the permit is issued.

I have and will maintain workers' compensation insurance, as required by Section 3700 of the Labor Code, for the performance of the work for which this permit is issued. My workers' compensation insurance carrier and policy number are:

Carrier NO EMPLOYEES

Policy Number

Exp Date

(This section need not be completed if the permit is for \$100 or less) I certify that in the performance of the work for which this permit is issued, I shall not employ any person in any manner so as to become subject to the workers' compensation laws of California and agree that if I should become subject to the workers' compensation provisions of Section 3700 of the Labor Code, I shall forthwith comply with those provisions.

X Date 11/4/98 Applicant Signature Tom Housou

WARNING: FAILURE TO SECURE WORKER'S COMPENSATION COVERAGE IS UNLAWFUL AND SHALL SUBJECT AN EMPLOYER TO CRIMINAL PENALTIES AND CIVIL FINES UP TO ONE HUNDRED THOUSAND DOLLARS (\$100,000) IN ADDITION TO THE COST OF COMPENSATION, DAMAGES AS PROVIDED FOR IN SECTION 3706 OF THE LABOR CODE, INTEREST AND ATTORNEY'S FEE.

THIS PERMIT SHALL EXPIRE BY LIMITATION IF WORK IS NOT COMMENCED WITHIN 180 DAYS.

MEMORANDUM

Sacramento Fire Department

To: BUILDING DEPARTMENT

Date: 1-14-99

From: Gordon Duncan,
Fire Marshal

Subject: FIRE SYSTEM INSPECTION

A final inspection of the newly installed fire system at:

7909 Bruceville Rd

has been conducted by Inspector F. Johnson

on 1-14-99.

98-10874-C

Permit Number

—
Square Footage

KIT HOOD

Type Inspection

The system is acceptable by this department.

R. Woodman

By: Ross L. Woodman,
Fire Prevention Officer II

98-353

F. D. Reference Number

SYSTEM LAYOUT

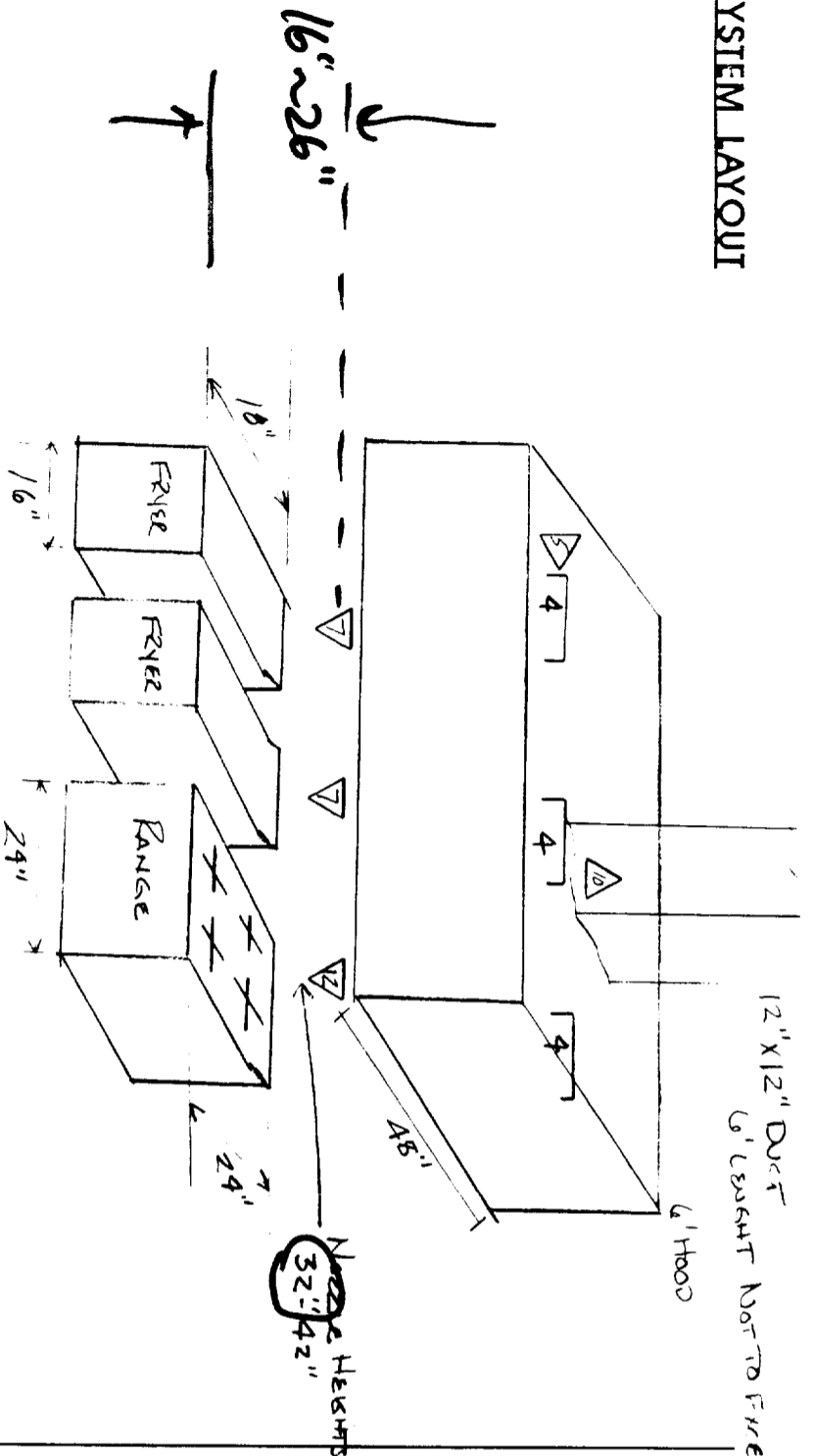

FLOOR PLAN

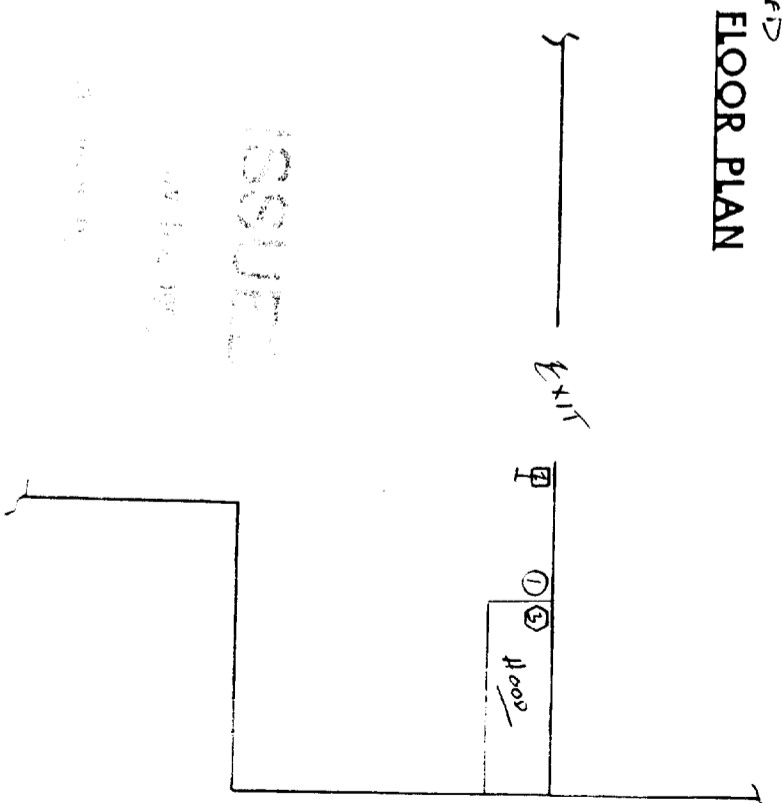

INSTALLING CONTRACTOR:

INNERWORKS FIRE & CONSTRUCTION, INC.

P.O. Box 6388, Vacaville, CA 95696 6388

Contractors Lic. # 730356

707 446 3383

Fax: 707 447 6252

JOB SITE

SAC SAC

909 Beverage Rd

SAC

CA

95823

No.	Description	Quan.	Part #	Flows Per	Comments
1	PYRO CHEM FIRE SYSTEM	/	PCU 240	8	A MAX. ALLOWABLE FLOWS 8
2	REMOTE MANUAL PULL	/	RBS-M	1	B ACTUAL NO. OF FLOWS 8
3	AUTO MECH. GAS VALVE	/	GVSO-1	1	C SINGLE BANK FILTERS /
4	DETECTOR BRACKET	3	FLK-1	1	D DUCT PERIMETER (S) 48"
5	PLENUM NOZZLE	/	NL-A	1	E 45° FUSIBLE LINKS /
6	DUCT NOZZLE	/	NL-D2	2	F DRAWINGS NOT TO SCALE
7	FRYER NOZZLE	2	NL-F2	2	
8	/RANGE NOZZLE	1	NL-F1	1	
9	BROILER NOZZLE	1	NL-R	1	
10	DUCT NOZZLE	1	NL-P	1	
11	GRID NOZZLE	1	NL-K	1	
12	RANGE NOZZLE	1	MURH2	1	

PIPING

ALL PIPE 3/8 SCH 40 BLACK SYSTEM PERULUM

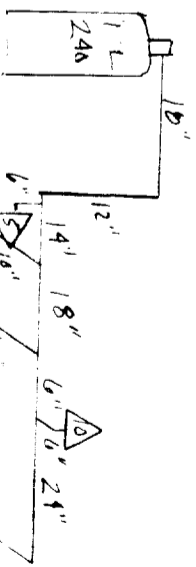

D. Day 200888
8
32"