

CITY OF SACRAMENTO
1231 I Street, Sacramento, CA 95814

Permit No: 0101889
Insp Area: 4

Site Address: 3221 SPINNING ROD WY SAC
Parcel No: RIVERWALK UNIT 2 LOT 47

Sub-Type: NSFR
Housing (Y/N): N

CONTRACTOR
MYERS HOMES INC.
3300 FITZGERALD RD
RANCHO CORDOVA CA 95742

OWNER

ARCHITECT

Nature of Work: NSFR MP2288 8 RMS 1 STORY

CONSTRUCTION LENDING AGENCY: I hereby affirm under penalty of perjury that there is a construction lending agency for the performance of the work for which this permit is issued (Sec. 3097, Civ. C).

Lender's Name _____ Lender's Address _____

LICENSED CONTRACTORS DECLARATION: I hereby affirm under penalty of perjury that I am licensed under provisions of Chapter 9 (commencing with section 7000) of Division 3 of the Business and Professions Code and my license is in full force and effect.

License Class B License Number _____ Date _____ Contractor Signature Phoncia Rose

OWNER-BUILDER DECLARATION: I hereby affirm under penalty of perjury that I am exempt from the contractors License Law for the following reason (Sec. 7031.5, Business and Professions Code; any city or county which requires a permit to construct, alter, improve, demolish, or repair any structure, prior to its issuance, also requires the applicant for such permit to file a signed statement that he or she is licensed pursuant to the provisions of the Contractors License Law (Chapter 9 (commencing with Section 7000) of Division 3 of the Business and Professions Code) or that he or she is exempt therefrom and the basis for the alleged exemption. Any violation of Section 7031.5 by any applicant for a permit subjects the applicant to a civil penalty of not more than five hundred dollars (\$500.00).

____ I, as a owner of the property, or my employees with wages as their sole compensation, will do the work, and the structure is not intended or offered for sale (Sec. 7044, Business and Professional Code). The Contractors License Law does not apply to an owner of property who builds or improves thereon, and who does such work himself or herself or through his/her own employees, provided that such improvements are not intended or offered for sale. If, however, the building or improvement is sold within one year of completion, the owner-builder will have the burden of proving that he/she did not build or improve for the purpose of sale.

____ I, as owner of the property, am exclusively contracting with licensed contractors to construct the project (Sec. 7044, Business and Professions Code). The Contractors License Law does not apply to an owner of property who builds or improves thereon, and who contracts for such projects with a contractor(s) licensed pursuant to the Contractors License Law.

____ I am exempt under Sec. _____ B & PC for this reason: _____

Date _____ Owner Signature _____

IN ISSUING THIS BUILDING PERMIT, the applicant represents, and the city relies on the representation of the applicant, that the applicant verified all measurements and locations shown on the application or accompanying drawings and that the improvement to be constructed does not violate any law or private agreement relating to permissible or prohibited locations for such improvements. This building permit does not authorize any illegal location of any improvement or the violation of any private agreement relating to location of improvements.

I certify that I have read this application and state that all information is correct. I agree to comply with all city and county ordinances and state laws relating to building construction and hereby authorize representative(s) of this city to enter upon the abovementioned property for inspection purposes.

Date 3/16/01 Applicant Agent Signature Phoncia Rose

WORKER'S COMPENSATION DECLARATION: I hereby affirm under penalty of perjury one of the following declarations:

____ I have and will maintain a certificate of consent to self-insure for workers' compensation as provided for by Section 3700 of the Labor Code, for the performance of work for which the permit is issued.

____ I have and will maintain workers' compensation insurance, as required by Section 3700 of the Labor Code, for the performance of the work for which this permit is issued. My workers' compensation insurance carrier and policy number are:

Carrier RELIANCE NAT INS CO Policy Number NWA0154613-01 Exp Date 04/01/2001

(This section need not be completed if the permit is for \$100 or less) I certify that in the performance of the work for which this permit is issued, I shall not employ any person in any manner so as to become subject to the workers' compensation laws of California and agree that if I should become subject to the workers' compensation provisions of Section 3700 of the Labor Code, I shall forthwith comply with those provisions.

Date 3/16/01 Applicant Signature Phoncia Rose

WARNING: FAILURE TO SECURE WORKER'S COMPENSATION COVERAGE IS UNLAWFUL AND SHALL SUBJECT AN EMPLOYER TO CRIMINAL PENALTIES AND CIVIL FINES UP TO ONE HUNDRED THOUSAND DOLLARS (\$100,000) IN ADDITION TO THE COST OF COMPENSATION, DAMAGES AS PROVIDED FOR IN SECTION 3706 OF THE LABOR CODE, INTEREST AND ATTORNEY'S FEE.

THIS PERMIT SHALL EXPIRE BY LIMITATION IF WORK IS NOT COMMENCED WITHIN 180 DAYS.

Lot 47

OMEGA PRODUCTS CORP.

DIAMOND WALL INSULATING STUCCO SYSTEM

JOB ADDRESS:

3221 Spinning Road Wx

ICBO Report #4004

Date of Job Completion 6/29/01

PLASTERING CONTRACTOR:

Name: Norscal Plastering

Address: Box 355 Lincoln, Ca 95648

Telephone No: (716) 645-7337

Contractor Number of Diamond Wall System 2130

This is to certify that the exterior coating system on the building exterior at the above address has been installed in accordance with the evaluation report specified above and the manufacturer's instructions.

Date _____

Jim Dueton
Signature of authorized representative of
Plastering Contractor

This installation card must be presented to the building inspector after completion of work and before final inspection.

CERTIFICATION OF INSULATION

<p>MEYERS</p> <p>RIVERWALK</p>	<p>LOT # 47</p>	<p><input checked="" type="checkbox"/> P.O. BOX 854, WEST SACRAMENTO, CA 95691 LIC. #202026</p> <p><input type="checkbox"/> 1308 MELODY ROAD, MARYSVILLE, CA 95901 LIC. #202026</p> <p><input type="checkbox"/> P.O. BOX 9651, FRESNO, CA 93793-9651 LIC. #202026</p> <p><input type="checkbox"/> P.O. BOX 1631, RENO, NV 89505 LIC. #10675</p> <p><input type="checkbox"/> 3326 A PONDEROSA WAY, LAS VEGAS, NV 89118 LIC. #10675</p> <p>DATE INSULATION COMPLETED</p>
--	------------------------	--

WALLS (SQUARE FEET)	CEILING (SQUARE FEET)	FLOORS (SQUARE FEET)
MATERIAL FIBERGLASS	MATERIAL FIBERGLASS	MATERIAL FIBERGLASS
FORM BATTS	FORM BATTS & BLOW	FORM BATTS
MANUFACTURER'S PRODUCT I.D.	MANUFACTURER'S PRODUCT I.D.	MANUFACTURER'S PRODUCT I.D.
MANUFACTURER OCF	MANUFACTURER OCF	MANUFACTURER OCF
	BAGS	
13	35/8	30
	9"	12"
30		

MATERIAL FIBERGLASS	FORM BATTS	R-VALUE	MANUFACTURER OCF
----------------------------	-------------------	---------	-------------------------

MATERIAL FOAM	MANUFACTURER W R GRACE
----------------------	-------------------------------

SIGNATURE - INSULATION CONTRACTOR <i>Bill Handberg</i>	TITLE MANAGER	DATE 7-9-01
SIGNATURE - GENERAL CONTRACTOR	TITLE	DATE

REMARKS

Norman

Scheel

Structural

Engineer

Sacramento
1022 Sunrise Blvd.
Fair Oaks, CA 95628
(916) 536-9585
(916) 536-0260 (fax)

NORMAN SCHEEL
Structural Engineer
Email: norm@nsse.com

ROBERT COON
Project Manager
Email: rob@nsse.com

AULO BANEZ
Project Manager
Email: aulo@nsse.com

TIM SLOAN
Project Manager
Email: tim@nsse.com

STEVE COOKSEY
AD Supervisor
Email: steve@nsse.com

TACY MARLIN
Office Manager
Email: tacy@nsse.com

JAVIS
13 E Street Suite B
Davis, CA 95616
(530) 753-5300
(530) 753-5380 (fax)

RACY HARRIS P.E.
Project Engineer
Email: racy@nsse.com

ARRELL PEREIRA
Design Engineer
Email: arrell@nsse.com

June 14, 2001

PHA Architects
1730 I Street, Suite 101
Sacramento, CA 95814

**Re: Meyers Homes – Riverwalk – Lot 47 Notched Holdown Post (Plan 4)
(Job #99114)**

To whom it may concern:

This letter is to verify that the attached detail is to be used to repair the 1 3/4" x 16" long notch in the holdown post of wall line P5. Add an additional 4x post next to the notched 4x-holdown post. Remove the lath and re-nail the shear wall to the added 4x post. Install the LTP4 clips as specified on the attached detail.

If there are further questions, please contact Tim Sloan at (916) 536-9585.

NORMAN SCHEEL
STRUCTURAL ENGINEER

cc: Jim Moltzen – Meyers Homes via fax – #565-1510

Enclosures: Repair detail



NORMAN SCHEEL
STRUCTURAL ENGINEER

JOB RIVERWALK

CLIENT MEYERS / PHA

DATE 6-14-81

JOB NO. 99114

BY T. SLOAN

SHEET NO. _____

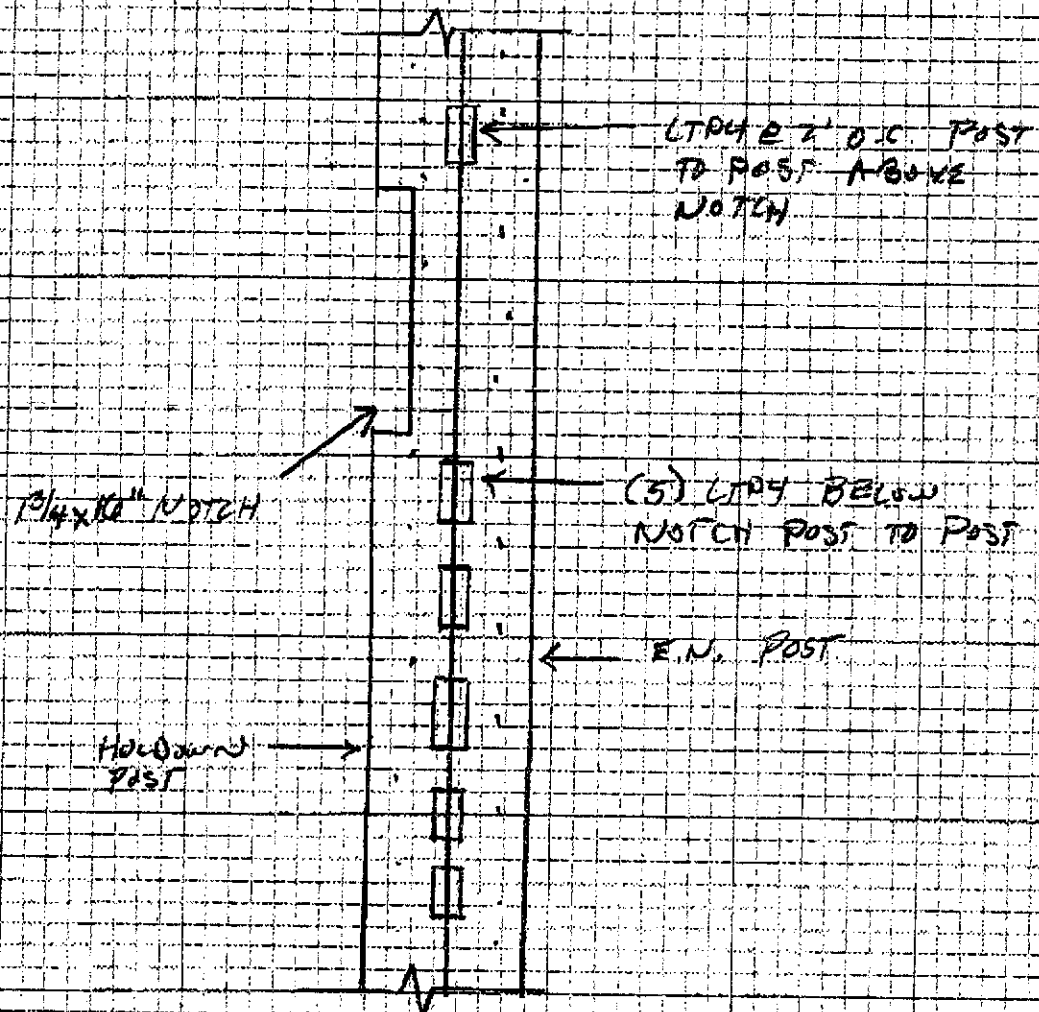

LOT 47 HOEDOWN POST REPAIR

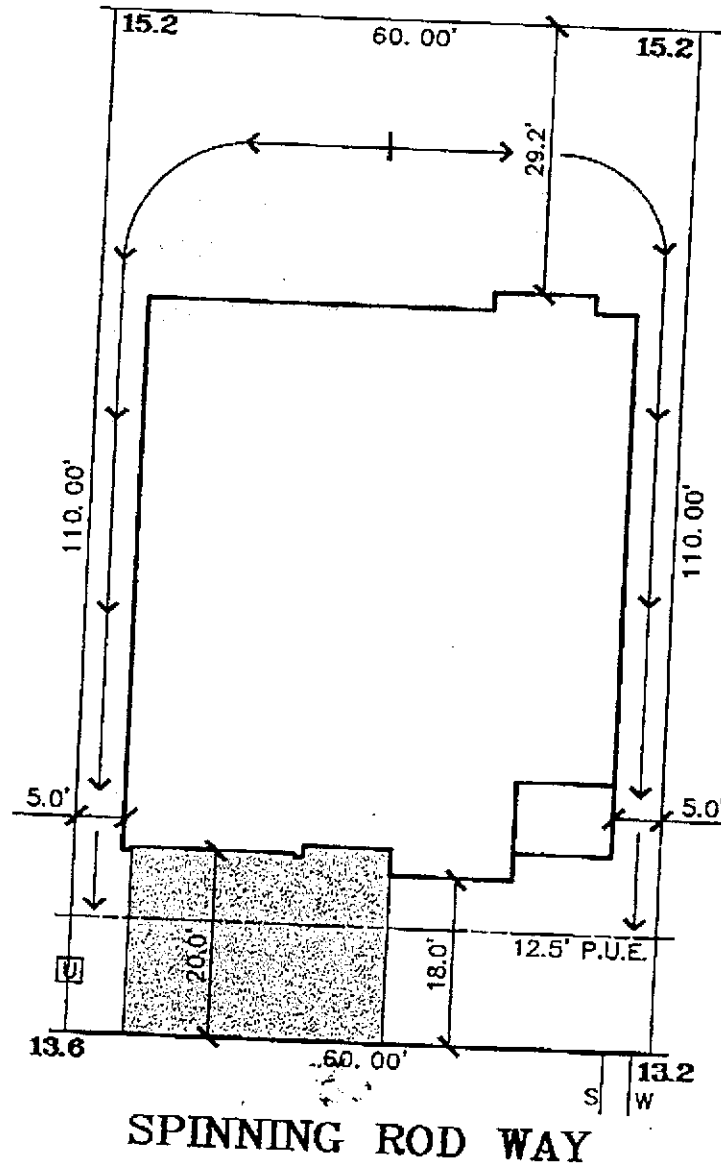

DATE: 11-15-00

A.P.N.:

ADDRESS: SPINNING ROD WAY

LOT AREA: 6,600 SF
LOT COVERAGE: 43%

The Spink Corporation
 2590 VENTURE OAKS WAY
 SACRAMENTO, CA. 95833
 T:(916)925-5550 FAX:(916)921-9274

**RIVERWALK
 UNIT NO. 2
 LOT 47
 PLAN 2288B**

RIVERWALK
 CITY OF SACRAMENTO, CA.
 CLIENT: MYERS HOMES
 JOB NO.: 1456-001