

SACRAMENTO CITY PLANNING COMMISSION

Report of City Planning Director -- R. L. Rathfon, 9-26-61

APPLICATION FOR SPECIAL USE PERMIT

APPLICANT: Rev. Edmund A. Gray, Rt 1, Box 52, Clarksburg, Calif.  
OWNERS: Roman Catholic Bishop of Sacramento, P. O. Box 1706.  
Sacramento 8, Calif.

PROPERTY: Metes and bounds parcel located on SW corner of  
71st Avenue & 24th Street.

LOCATION: SW corner 71st Ave. & 24th Street

SIZE: Irregularly shaped parcel of approx. 8.097 acres.

ZONING: R-1 One-family zone.

EXISTING USE: Vacant

PROPOSED USE: Church development

REQUEST: Application for Special Use Permit in order to erect  
church building with off-street parking in residential  
zone.

- 
1. Submitted plans indicate that the proposed church building, which will become the parish hall at a later date, will have a seating capacity for 456 persons. A church building with this number of seats calls for a minimum of 76 off-street parking spaces. 96 off-street parking spaces are designated on the layout shown on the plans, all of which meet the requirements of the Zoning Ordinance pertaining to size of stalls and maneuvering area. Plans also indicate that the off-street parking area which is to be located on that portion of the building site adjacent to the Street corner (24th St. & 71st Ave.) will be set back 30' from the property lines adjacent to both of these streets.
  2. Overall development plans for church property include school classrooms and a future church building.
  3. Subject property is in the Meadowview Annexed Area which became a part of the City of Sacramento in January of 1958, now an area of new subdivisions which are still undergoing development.

71st Avenue

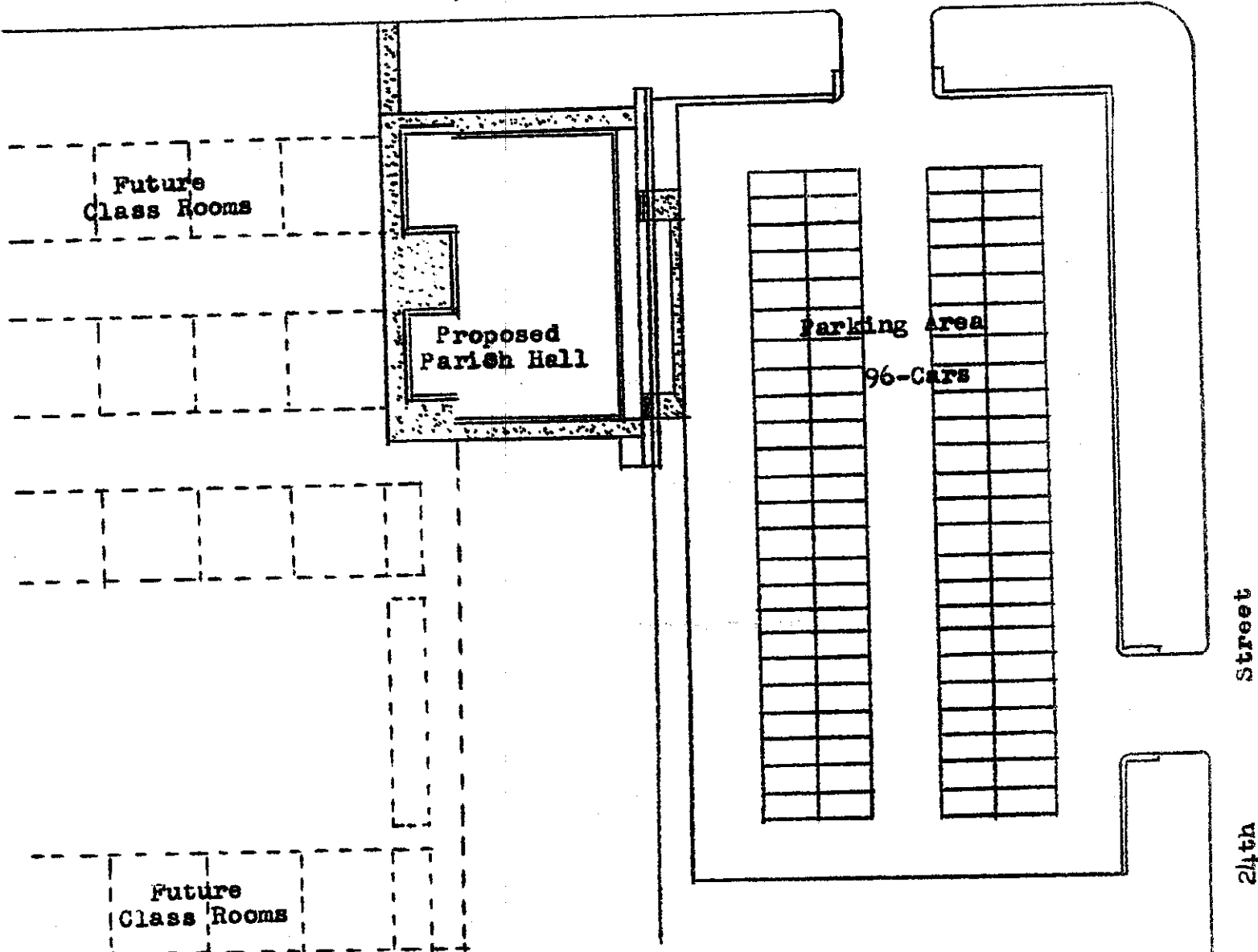

Roman Catholic Bishop of Sacramento  
 Property  
 Holy Infant School  
 Metes & Bounds Parcel on the  
 South-west Corner of 71st Avenue  
 and 24th Street.



Future Church

CITY PLANNING COMMISSION  
 September 26, 1961