

CITY OF SACRAMENTO
1231 I Street, Sacramento, CA 95814

Permit No: 0103619

Insp Area: 4

Site Address: 171 LYMAN CR SAC

Sub-Type: NSFR

Parcel No: 225-1290-070

NORTHPT PK 13-1 LOT 70

Housing (Y/N): N

CONTRACTOR

WESTERN PACIFIC HOUSING
1210 CENTRAL BLVD
BRENTWOOD CA 94513

OWNER

WESTERN PACIFIC HOUSING
1210 CENTRAL BLVD
BRENTWOOD CA 94513

ARCHITECT

Nature of Work: NSFR MP2999/OPT 2 STORY 11 RMS

CONSTRUCTION LENDING AGENCY : I hereby affirm under penalty of perjury that there is a construction lending agency for the performance of the work for which this permit is issued (Sec. 3097, Civ. C).

Lender's Name _____ Lender's Address _____

LICENSED CONTRACTORS DECLARATION: I hereby affirm under penalty of perjury that I am licensed under provisions of Chapter 9 (commencing with section 7000) of Division 3 of the Business and Professions Code and my license is in full force and effect.

License Class B License Number 675709 Date 4/3/01 Contractor Signature N. Collins

OWNER-BUILDER DECLARATION: I hereby affirm under penalty of perjury that I am exempt from the contractors License Law for the following reason (Sec. 7031.5, Business and Professions Code; any city or county which requires a permit to construct, alter, improve, demolish, or repair any structure, prior to its issuance, also requires the applicant for such permit to file a signed statement that he or she is licensed pursuant to the provisions of the Contractors License Law (Chapter 9 (commencing with Section 7000) of Division 8 of the Business and Professions Code) or that he or she is exempt therefrom and the basis for the alleged exemption. Any violation of Section 7031.5 by any applicant for a permit subjects the applicant to a civil penalty of not more than five hundred dollars (\$500.00).

_____, I, as a owner of the property, or my employees with wages as their sole compensation, will do the work, and the structure is not intended or offered for sale (Sec. 7044, Business and Professional Code. The Contractors License Law does not apply to an owner of property who builds or improves thereon, and who does such work himself or herself or through his/her own employees, provided that such improvements are not intended or offered for sale. If, however, the building or improvement is sold within one year of completion, the owner-builder will have the burden of proving that he/she did not build or improve for the purpose of sale.)

_____, I, as owner of the property, am exclusively contracting with licensed contractors to construct the project (Sec. 7044, Business and Professions Code. The Contractors License Law does not apply to an owner of property who builds or improves thereon, and who contracts for such projects with a contractor(s) licensed pursuant to the Contractors License Law).

_____ I am exempt under Sec. _____ B & PC for this reason: _____

Date _____ Owner Signature _____

IN ISSUING THIS BUILDING PERMIT, the applicant represents, and the city relies on the representation of the applicant, that the applicant verified all measurements and locations shown on the application or accompanying drawings and that the improvement to be constructed does not violate any law or private agreement relating to permissible or prohibited locations for such improvements. This building permit does not authorize any illegal location of any improvement or the violation of any private agreement relating to location of improvements.

I certify that I have read this application and state that all information is correct. I agree to comply with all city and county ordinances and state laws relating to building construction and hereby authorize representative(s) of this city to enter upon the abovementioned property for inspection purposes.

Date 4/3/01 Applicant/Agent Signature N. Collins

WORKER'S COMPENSATION DECLARATION: I hereby affirm under penalty of perjury one of the following declarations:

_____, I have and will maintain a certificate of consent to self-insure for workers' compensation as provided for by Section 3700 of the Labor Code, for the performance of work for which the permit is issued.

I have and will maintain workers' compensation insurance, as required by Section 3700 of the Labor Code, for the performance of the work for which this permit is issued. My workers' compensation insurance carrier and policy number are:

Carrier EAGLE INS. CO Policy Number 4S-0000273 Exp Date 03/19/2001

_____, (This section need not be completed if the permit is for \$100 or less) I certify that in the performance of the work for which this permit is issued, I shall not employ any person in any manner so as to become subject to the workers' compensation laws of California and agree that if I should become subject to the workers' compensation provisions of Section 3700 of the Labor Code, I shall forthwith comply with those provisions.

Date 4/3/01 Applicant Signature N. Collins

WARNING: FAILURE TO SECURE WORKER'S COMPENSATION COVERAGE IS UNLAWFUL AND SHALL SUBJECT AN EMPLOYER TO CRIMINAL PENALTIES AND CIVIL FINES UP TO ONE HUNDRED THOUSAND DOLLARS (\$100,000) IN ADDITION TO THE COST OF COMPENSATION, DAMAGES AS PROVIDED FOR IN SECTION 3706 OF THE LABOR CODE, INTEREST AND ATTORNEY'S FEE.

THIS PERMIT SHALL EXPIRE BY LIMITATION IF WORK IS NOT COMMENCED WITHIN 180 DAYS.

RESIDENTIAL SUBDIVISION BUILDING PERMIT APPLICATION

Project Address: 171 Lyman Circle Assessor Parcel # 225-1290-070
Lot Number: 70 Subdivision Northpointe Park Unit #13 Ph1

OWNER INFORMATION:

Legal Property Owner: Western Pacific Housing Phone# (925) 634-6023
Owner Address: 1210 Central Boulevard, City Brentwood, State Ca. Zip 94513

CONTRACTOR INFORMATION:

Contractor: Western Pacific Lic# 675709/B Phone # (925) 634-6023 Fax 634-6166

PROJECT INFORMATION:

Land Use Zone RIA Occupancy Group R3 Construction Type VN Fed Code IA
No. of Stories: 2 No. of Rooms: 11 Street Width: _____
1st Floor Area 689 2nd Floor Area _____ Basement _____ Roof Material _____

AREA IN SQUARE FOOT OF:

Dwelling/Living 3389
Garage/Storage 694
Decks/Balconies 136
Carports _____

SCOPE OF WORK: _____

- Information Above Complete
- Violation Files Checked
- Standard Setbacks
- County Sewer
- AR Flood Waiver Required
- Flood Elevation Certificate Required
- Water Development Infill Area
- Planning Approval
- Design Review Approval
- Special Fee Districts Apply:

~THE FOLLOWING MUST BE PROVIDED IN ORDER TO SUBMIT FOR PERMIT~

- 2 COMPLETE PLOT PLANS, LEGIBLE & DRAWN TO SCALE
- 11 X 17 COPY OF FLOOR PLAN WITH FOLLOWING INFORMATION
 - a) Assessor Parcel Number
 - b) New Floor Area
 - c) Owners Name
 - d) Project Address

Date:

Received by: (staff)

Permit #

2
3
4

Natomas Unified School District
 1515 Sports Drive, #1 • Sacramento, CA 95834-1905
 Phone 916/641-3300 • Fax 916/928-1629

CERTIFICATION OF COMPLIANCE
SCHOOL DISTRICT DEVELOPMENT FEES

PART I: TO BE COMPLETED BY APPLICANT			
Property Owner's Name	Western Pacific Housing	(916) 634-6023	
Owner's Address	1210 Central Blvd., Brentwood, Ca 94513		
Project Address	171 Lyman Circle		
Parcel Number	225-1290-070	Lot	70
Subdivision Name	Northpointe Park Unit #10 Village #1		
Number of Units	1		
Print Applicant's Name	Deanna Collins	Applicant's Signature	
Title of Applicant	Operations		
Date	3/28/2001	Telephone Number	801-8331
PART II: TO BE COMPLETED BY BUILDING DEPARTMENT			
Plan Identification Number	3389		
Building Type (Check One)			
<input checked="" type="checkbox"/> Residential	<input type="checkbox"/> Apartment/Condominium	<input type="checkbox"/> Commercial/Industrial	
Square Feet of Chargeable Building Area	3389		
Signature			
Title	2100	Date	3/28/01
PART III: TO BE COMPLETED BY NATOMAS UNIFIED SCHOOL DISTRICT			
District Certification Number	11621		
Fees Collected:			
Residential:	3389	Sq. Ft. X \$ 3.25	= \$ 11,014.25
Apartment/Condominium:		Sq. Ft. X \$	= \$
Commercial/Industrial:		Sq. Ft. X \$	= \$
NOTICE TO APPLICANT: Pursuant to government code section 66020 (d), this will serve to notify you that the 90-day approval period in which you may protest the fees, or other payment identified above, will begin to run on the date in which the building or installation permit for this project is issued, or on which they are paid to the District, or to another public entity authorized to collect them on behalf of the District, whichever is earlier.			
Applicant Signature:			Date: 3/29/01

This certification covers only the amount of square footage indicated above. Any additions or corrections to the square footage for this project will require an amendment to the Certificate of Compliance.

As the authorize Natomas Unified School District official, I hereby certify that the requirements of Government Code Section 95995 have been complied with by the above signed applicant.

SIGNATURE: Michael Morman DATE: 3/30/01
 TITLE: Michael Morman
Facilities Planning Director

KwikKote

No. 200-002653

Stucco System Installation Card

Job Name: BELLAGIO
Address: 171 LYMAN CIR.
SACRAMENTO, CA
Lot #: 0000070

Stucco System Trade Name: KWIK KOTE
Stucco System Manufacturer: KWIK KOTE CORP.

ICBO Evaluation Service, Inc.
Report No. 3607
Date of Job Completion:

Home Builder: WESTERN PACIFIC
Address: 1210 CENTRAL BLVD. WEST #200
BRENTWOOD, CA

Stucco Contractor: KENYON PLASTERING, INC.
Address: PO BOX 2077
North Highlands, CA

Telephone Number: 916/349-8191

Approved Contractor Number as
issued by the Stucco Manufacturer: 1001

Card Print Date: 06/19/2001

This is to certify that the stucco system on the building exterior at the above address had been installed in accordance with the evaluation report specified above and the manufacturer's instructions.



Signature of authorized representative of stucco contractor

7-12-01
Date

CERTIFICATION OF INSULATION

PART I GENERAL
PART II AREAS INSULATED
PART III CERTIFICATION

ADDRESS OR TRACT	SACRAMENTO INSULATION CONTRACTORS
WESTERN Pacific LOT # 70 BELLAGIO	<input checked="" type="checkbox"/> P.O. BOX 854, WEST SACRAMENTO, CA 95691 LIC. #202026 <input type="checkbox"/> 1309 MELODY ROAD, MARYSVILLE, CA 95901 LIC. #202026 <input type="checkbox"/> P.O. BOX 9651, FRESNO, CA 93793-9651 LIC. #202026 <input type="checkbox"/> P.O. BOX 1631, RENO, NV 89505 LIC. #10675 <input type="checkbox"/> 3326 A PONDEROSA WAY, LAS VEGAS, NV 89118 LIC. #10675 DATE INSULATION COMPLETED

WALLS		CEILINGS			FLOORS	
(SQUARE FEET)		(SQUARE FEET)			(SQUARE FEET)	
TYPE OF INSULATION		TYPE OF INSULATION			TYPE OF INSULATION	
MATERIAL	FIBERGLASS	MATERIAL	FIBERGLASS		MATERIAL	FIBERGLASS
FORM	BATTS	FORM	BATTS & BLOW		FORM	BATTS
MANUFACTURER'S PRODUCT I.D.		MANUFACTURER'S PRODUCT I.D.			MANUFACTURER'S PRODUCT I.D.	
MANUFACTURER		MANUFACTURER			MANUFACTURER	
OCF		OCF			OCF	
BAGS						
R-VALUE INSTALLED	APPLIED THICKNESS	R-VALUE INSTALLED	APPLIED THICKNESS	MIN. INSTALLED WEIGHT PER SQUARE FOOT	R-VALUE INSTALLED	APPLIED THICKNESS
13	3 5/8	30	9"			
		30	12 1/2"			

KNEE WALLS IF R-VALUE IS OTHER THAN WALLS ABOVE

MATERIAL	FORM	R-VALUE	MANUFACTURER
FIBERGLASS	BATTS		OCF

AIR INFILTRATION SEALANT

MATERIAL	MANUFACTURER
FOAM	W R GRACE

THIS IS TO CERTIFY THAT INSULATION AND/OR SEALANT HAS BEEN INSTALLED IN CONFORMANCE WITH APPLICABLE CODES, MATERIAL STANDARDS AND REGULATIONS.

SIGNATURE—INSULATION CONTRACTOR	TITLE	DATE
<i>Bill Geoghan</i>	MANAGER	6-13-1
SIGNATURE—GENERAL CONTRACTOR	TITLE	DATE

REMARKS

LEGEND

→ SWALE
□ MAILBOX

✂ WOOD FENCE
⌋ SIDEYARD GATE

SS SEWER SERVICE
WS WATER SERVICE

⊞ UTILITY SERVICE
F.F. FINISH FLOOR

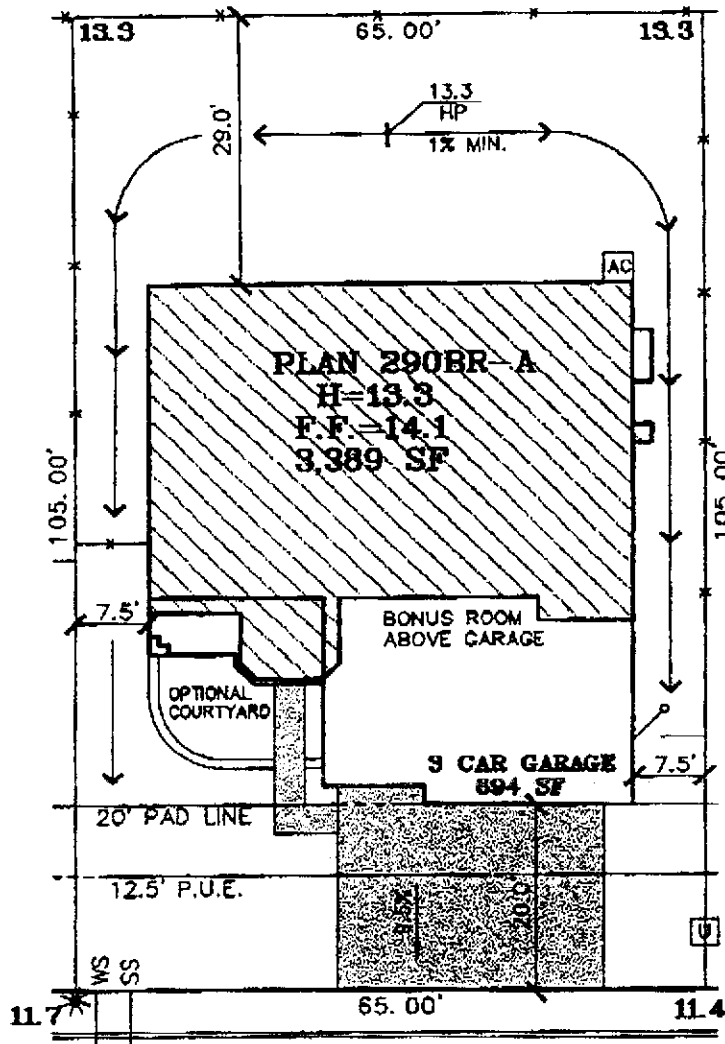

SCALE: 1" = 20'

LYMAN CIRCLE

This set of plans and specifications shall be kept on the job at all times and it is intended to make any changes or alterations from the same without written permission from the local planning department.
 This set of plans and specifications shall be prepared by Western Pacific Housing, a division of an Equal Opportunity Housing Act.

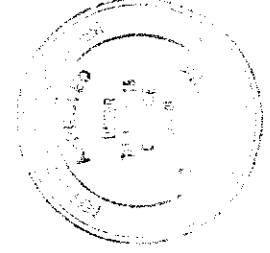

LOT 70
PLAN 290BR-A
A.P.N.:
ADDRESS: 171 LYMAN CIRCLE
LOT AREA: 6,825 SF

DUE TO THE UNIQUE CONDITIONS OF THIS LOT, THE BUYER HAS WALKED AND APPROVED THE SITE. FINAL GRADING CONDITIONS MAY VARY. THE INFORMATION ON THIS PLOT PLAN IS PROVIDED FOR YOUR CONVENIENCE AS A GUIDE TO THE GENERAL LOCATION OF THE SUBJECT PROPERTY. THE ACCURACY OF THIS PLOT PLAN IS NOT GUARANTEED NOR IS IT A PART OF ANY POLICY, REPORT OR GUARANTEE TO WHICH IT MAY BE ATTACHED. ACTUAL DIMENSIONS MAY VARY OR CHANGE WITHOUT PRIOR NOTICE DUE TO ACTUAL SITE CONDITIONS.

PLAN: 290br
 ELEVATION: A SIGNED (BUYER) _____ DATE _____
 ORIENTATION: R
 COLOR: 160

The Splink Corporation
 2590 VENTURE OAKS WAY
 SACRAMENTO, CA 95833
 PH:(916)925-5550 FAX:(916)921-9274

 **Western Pacific Housing**
 1210 Central Boulevard
 Brentwood, CA 94513
 office: (925) 634-6023
 fax: (925) 634-6063

BELLAGIO
 NORTHPOINTE PARK VILLAGE 13 PHASE 1
 City of Sacramento, California
 Scale: 1"=20' January 12, 2001