

CITY OF SACRAMENTO

1231 I Street, Sacramento, CA 95814

Permit No: 0113389

Insp Area: 4

Thos Bros:

Sub-Type: NSFR

N

Site Address: 3025 GUADALAJARA WY SAC

Parcel No: RIVERVIEW 1A LOT 49 Housing (Y/N):

CONTRACTOR

BEAZER HOMES
3009 DOUGLAS BL #150
ROSEVILLE CA 95661

OWNER

ARCHITECT

Nature of Work: NSFR MP1920 2 STORY 9 RMS

CONSTRUCTION LENDING AGENCY : I hereby affirm under penalty of perjury that there is a construction lending agency for the performance of the work for which this permit is issued (Sec. 3097, Civ. C).

Lender's Name _____ Lender's Address _____

LICENSED CONTRACTORS DECLARATION: I hereby affirm under penalty of perjury that I am licensed under provisions of Chapter 9 (commencing with section 7000) of Division 3 of the Business and Professions Code and my license is in full force and effect.

License Class B License Number 724191 Date 10/22/01 Contractor Signature Shung Van Ma

OWNER-BUILDER DECLARATION: I hereby affirm under penalty of perjury that I am exempt from the contractors License Law for the following reason (Sec. 7031.5, Business and Professions Code; any city or county which requires a permit to construct, alter, improve, demolish, or repair any structure, prior to its issuance, also requires the applicant for such permit to file a signed statement that he or she is licensed pursuant to the provisions of the Contractors License Law (Chapter 9 (commencing with Section 7000) of Division 8 of the Business and Professions Code) or that he or she is exempt therefrom and the basis for the alleged exemption. Any violation of Section 7031.5 by any applicant for a permit subjects the applicant to a civil penalty of not more than five hundred dollars (\$500.00);

I, as a owner of the property, or my employees with wages as their sole compensation, will do the work, and the structure is not intended or offered for sale (Sec. 7044, Business and Professional Code: The Contractors License Law does not apply to an owner of property who builds or improves thereon, and who does such work himself or herself or through his/her own employees, provided that such improvements are not intended or offered for sale. If, however, the building or improvement is sold within one year of completion, the owner-builder will have the burden of proving that he/she did not build or improve for the purpose of sale.)

I, as owner of the property, am exclusively contracting with licensed contractors to construct the project (Sec. 7044, Business and Professions Code: The Contractors License Law does not apply to an owner of property who builds or improves thereon, and who contracts for such projects with a contractor(s) licensed pursuant to the Contractors License Law).

I am exempt under Sec. _____ B & PC for this reason: _____

Date _____ Owner Signature _____

IN ISSUING THIS BUILDING PERMIT, the applicant represents, and the city relies on the representation of the applicant, that the applicant verified all measurements and locations shown on the application or accompanying drawings and that the improvement to be constructed does not violate any law or private agreement relating to permissible or prohibited locations for such improvements. This building permit does not authorize any illegal location of any improvement or the violation of any private agreement relating to location of improvements.

I certify that I have read this application and state that all information is correct. I agree to comply with all city and county ordinances and state laws relating to building construction and herby authorize representative(s) of this city to enter upon the above-mentioned property for inspection purposes.

Date 10/22/01 Applicant/Agent Signature Shung Van Ma

WORKER'S COMPENSATION DECLARATION: I hereby affirm under penalty of perjury one of the following declarations:

I have and will maintain a certificate of consent to self-insure for workers' compensation as provided for by Section 3700 of the Labor Code, for the performance of work for which the permit is issued.

I have and will maintain workers' compensation insurance, as required by Section 3700 of the Labor Code, for the performance of the work for which this permit is issued. My workers' compensation insurance carrier and policy number are:

Carrier LIBERTY MUTUAL INS CO. Policy Number WA2-651-004147-080 Exp Date 04/01/2002

(This section need not be completed if the permit is for \$100 or less) I certify that in the performance of the work for which this permit is issued, I shall not employ any person in any manner so as to become subject to the workers' compensation laws of California and agree that if I should become subject to the workers' compensation provisions of Section 3700 of the Labor Code, I shall forthwith comply with those provisions.

Date 10/22/01 Applicant Signature Shung Van Ma

WARNING: FAILURE TO SECURE WORKER'S COMPENSATION COVERAGE IS UNLAWFUL AND SHALL SUBJECT AN EMPLOYER TO CRIMINAL PENALTIES AND CIVIL FINES UP TO ONE HUNDRED THOUSAND DOLLARS (\$100,000) IN ADDITION TO THE COST OF COMPENSATION, DAMAGES AS PROVIDED FOR IN SECTION 3706 OF THE LABOR CODE, INTEREST AND ATTORNEY'S FEE.

THIS PERMIT SHALL EXPIRE BY LIMITATION IF WORK IS NOT COMMENCED WITHIN 180 DAYS.

RESIDENTIAL BUILDING PERMIT APPLICATION

New Construction Addition Remodels Other

Project Address: 3025 Guadalupe Way Assessor Parcel # _____

OWNER INFORMATION:

Legal Property Owner: Beazer Homes Phone # 773-3888
 Owner Address: 3009 Douglas Blvd., #150 City Roseville State CA Zip 95661

CONTRACTOR INFORMATION:

Contractor: Beazer Homes Lic. # 724191 Phone # 773-3888 Fax# 773-0425

PROJECT INFORMATION:

Land Use Zone _____ Occupancy Group _____ Construction Type _____ Fed Code _____
 No. of stories: 2 No. of rooms: 9 Street width: _____
 1st Floor Area 1110 2nd Floor Area 810 Basement -0- Roof Material -0-

AREA IN SQUARE FOOT OF:	EXISTING	NEW
Dwelling/Living	_____	1920
Garage/Storage	_____	448
Decks/Balconies	_____	-0- <u>20</u>
Carports	_____	-0-

SCOPE OF WORK: New SFD

FOR OFFICE USE ONLY

<input type="checkbox"/> Information above complete	<input type="checkbox"/> AR Flood Waiver required	<input type="checkbox"/> Planning Approval
<input type="checkbox"/> Violation files checked	<input type="checkbox"/> Flood Elevation Certificate Required	<input type="checkbox"/> Design Review Approval
<input type="checkbox"/> Standard setbacks	<input type="checkbox"/> Water Development Infill Area	<input type="checkbox"/> Special Fee Districts Apply: _____
<input type="checkbox"/> County Sewer		

NEW STRUCTURES & ADDITIONS

◆ THE FOLLOWING MUST BE PROVIDED IN ORDER TO SUBMIT FOR PLAN REVIEW

<input type="checkbox"/> 2 COMPLETE PLANS, LEGIBLE & DRAWN TO SCALE	◆ Plans to include: site plan, floor plan, elevations, roof/ceiling plan, foundation and structural framing details, and structural calculations for non-conforming structures.
<input type="checkbox"/> 3 SETS IF PROJECT IS IN A DESIGN REVIEW AREA	
<input type="checkbox"/> Title 24 Energy Compliance documentation	<input type="checkbox"/> 11" x 17" copy of floor plan for County Assessor
<input type="checkbox"/> Grading and Erosion Control Questionnaire	<input type="checkbox"/> Plan Review Fees

Date: _____ Received by: (staff) _____

ACTIVITY/PERMIT #
0113389

125,439.76



F. RODGERS INSULATION RESIDENTIAL, INC.

® THERMAL INSULATION CONTRACTORS
Residential

2720

7775 LAS POSITAS ROAD, SUITE A • LIVERMORE, CA 94550-0216
(925) 294-9400 • FAX (925) 294-9475
8541 YOUNGER CREEK DRIVE, SUITE 400 • SACRAMENTO, CA 95828
(916) 386-9400 • FAX (916) 386-9446



STREET BEAZER LOT # 49 TRACT # DEL SOL
CITY SAC

EXTERIOR WALLS:

MANUFACTURER o/c THICKNESS/TYPE _____ R-
VALUE 13.19

CEILING:

BATTS: o/c THICKNESS/TYPE _____ R-
VALUE 3.8

BLOWN IN:

MANUFACTURER o/c MINIMUM THICKNESS 4 3/4" R-
VALUE 3.8

SQUARE FOOTAGE COVERED

1175 NUMBER OF BAGS USED 29

FLOORS & OVERHANGS:

MANUFACTURER _____ THICKNESS/TYPE _____ R-
VALUE _____

OTHER:

MANUFACTURER _____ THICKNESS/TYPE _____ R-
VALUE _____

GENERAL CONTRACTOR

CALIFORNIA CONTRACTORS LICENSE # _____ DATE _____

SIGNATURE

TITLE

INSULATION CONTRACTOR F. RODGERS INSULATION RESIDENTIAL
CALIFORNIA CONTRACTORS LICENSE #771285

DATE

1-18-02

SIGNATURE

TITLE

B. J. H. A. F.

49

OMEGA PRODUCTS CORP.

DIAMOND WALL INSULATING STUCCO SYSTEM

JOB ADDRESS:

BEAZER PIAZZA DEL SOL

ICBO Report #4004

Date of Job Completion 11/11/02

PLASTERING CONTRACTOR:

Name: STUCCO WORKS INC.

Address: 5900 WAREHOUSE WAY. SACRAMENTO, CALIFORNIA 95826

Telephone No: (916) 383-6699

Contractor Number of Diamond Wall System 2175

This is to certify that the exterior coating system on the building exterior at the above address has been installed in accordance with the evaluation report specified above and the manufacturer's instructions.

11/18/02
Date

[Signature]
Signature of authorized representative of
Plastering Contractor

This installation card must be presented to the building inspector after completion of work and before final inspection.



CAPITOL ENGINEERING LABORATORIES, INC.

631 Commerce Drive, Suite #200 • Roseville, California 95678 • (916) 786-2488

JOB REPORT

PAGE: _____

PROJECT NAME: PIAZZA

FILE NO. 5222

INSPECTOR: KENNETH JOHN

DATE: 12-5-01

PERSONS CONTACTED: CVC

PERMIT #: _____

REFERENCE DOCUMENTS: ICBO Report #4945

WEATHER: SHOWERS

SERVICE PROVIDED: CONCRETE (INSP / SAMPLE ONLY / PU) MASONRY WELDING (SHOP / FIELD) SOILS

OTHER _____

PROOF LOADED EPOXYED BOLTS TO 150% OF ALLOWABLE PER ICBO REPORT #4945 OR TO 6015 lbs FOR 5/8" AND 4050 FOR 1/2" AND 12400 lbs FOR 7/8"

- LOT 53 - Loaded 6 of 12-1/2" & 13-5/8" without MOVEMENT
- LOT 52 - " 8 of 15-1/2" & 11-5/8" & 1-7/8" " "
- LOT 51 - " 10 of 20-1/2" & 8 of 15-5/8" & 1-7/8"
- LOT 50 - " 7 of 14-1/2" & 12 of 24-5/8" " "
- LOT 49 - " 8 of 15-1/2" & 9 of 17-5/8" " "
- LOT 57 - " 10 of 20-1/2" & 9 of 18-5/8" " "
- LOT 59 - " 11 of 21-1/2" & 7-5/8" " "
- LOT 60 - " 7 of 14-1/2" & 10-5/8" " "
- LOT 61 - " 8 of 16-1/2" & 13 of 25-5/8" " "
- LOT 45 - " 10 of 20-1/2" & 4-5/8" " "
- LOT 46 - " 9 of 17-1/2" & 6-5/8" & 1-7/8" " "
- LOT 47 - " 9 of 17-1/2" & 7-5/8" without MOVEMENT

ATTACHMENTS: _____

EQUIPMENT/SUPPLIES USED: _____

NEXT VISIT: _____

REMARKS: _____

REVIEWED BY: Kenneth John DATE: _____

THIS PLOT PLAN IS NOT FOR SALES PURPOSES. THIS PLOT PLAN IS FOR THE PURPOSES OF INDICATING COMPLIANCE WITH ZONING SET BACKS, GENERAL DRAINAGE DIRECTION, AND APPROXIMATE UTILITY CONNECTION. ALL OTHER DATA SHOWN HEREON IS CONCEPTUAL. THIS PLOT PLAN DOES NOT REFLECT AS-BUILT CONDITION, RETAINING WALL ARE OPTIONAL AND MAY OR MAY NOT BE CONSTRUCTED.

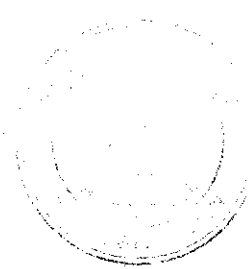

Should not be held to account for any violation of any City Ordinance or State Law.

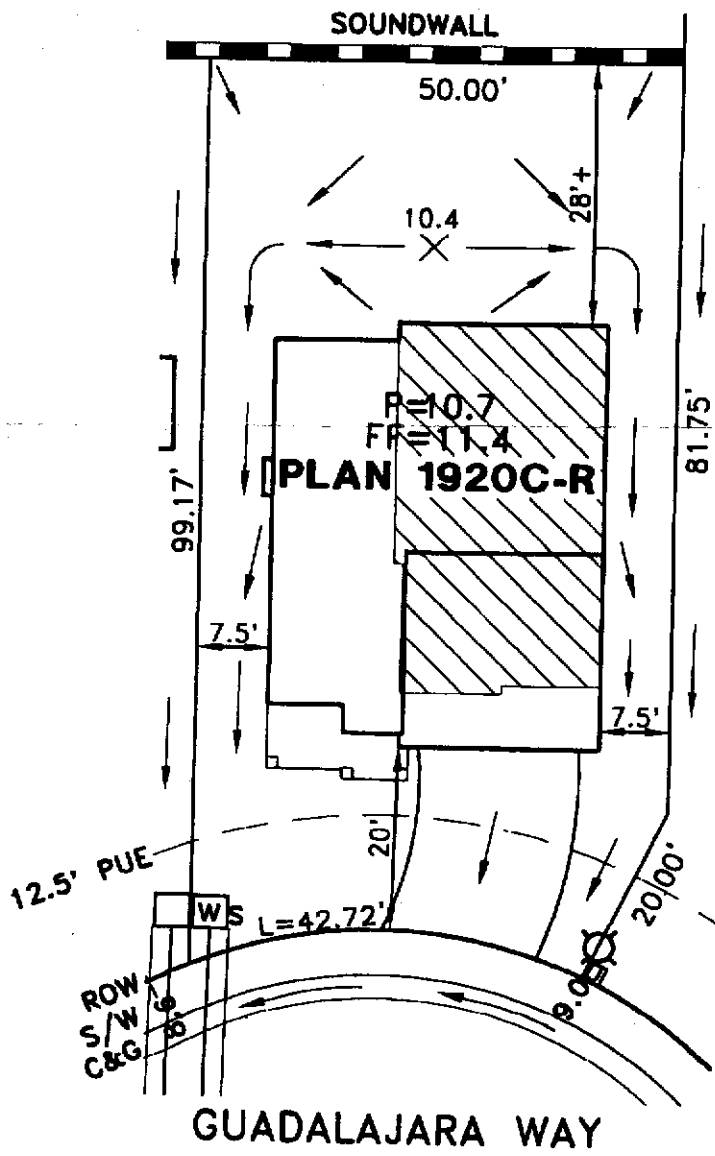
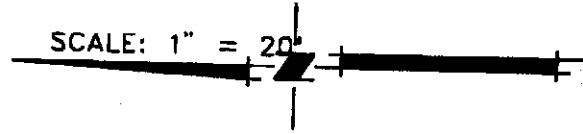

- TRANSFORMER
- UTILITY SERVICE BOX
- STREET LIGHT

PLOT PLAN			
LOT 49			
RIVER VIEW #1 VILLAGE A			
FOR			
BEAZER HOMES			
CITY OF SACRAMENTO		CALIFORNIA	
WOOD RODGERS INC.			
ENGINEERING PLANNING MAPPING SURVEYING 3301 D STREET, BLDG. 100-B, SACRAMENTO, CA 95816 PHONE: (916) 361-7260 FAX: (916) 361-7267			
DATE:	DRAWN:	CHECKED:	PROJECT NO:
AUG. 2001	DBJ	JWH 8-31-01	1055.016

J:\JOBS\RIVERVIEW\DWG\FROMREY\UNIT1\PHASE-A\PLOTPLANS\LOT-49.DWG 08/28/01 15:20