

CITY OF SACRAMENTO

Permit No: 9810739

1231 I Street, Sacramento, CA 95814

Insp Area: 2

Site Address: 6205 RIVERSIDE BL SAC

Parcel No: 0300361009

#217

Sub-Type: COM

Housing (Y/N): N

CONTRACTOR

DOUBLE D BUILDERS INC
6217 32 ST
NORTH HIGHLANDS CA

OWNER

CENTURION ASSOCIATES
CONCORD, C A.

ARCHITECT

95660

94522

**Nature of Work: KITCHEN FIRE: REPLACE KIT CABS,COUNTER TOPS, DRYWALL,
ELECTRICAL, LINO,**

CONSTRUCTION LENDING AGENCY : I hereby affirm under penalty of perjury that there is a construction lending agency for the performance of the work for which this permit is issued (Sec. 3097, Civ. C).

Lender's Name _____ Lender's Address _____

LICENSED CONTRACTORS DECLARATION: I hereby affirm under penalty of perjury that I am licensed under provisions of Chapter 9 (commencing with section 7000) of Division 3 of the Business and Professions Code and my license is in full force and effect.

License Class B License Number S24046 Date 10-28-98 Contractor Signature [Signature]

OWNER-BUILDER DECLARATION: I hereby affirm under penalty of perjury that I am exempt from the contractors License Law for the following reason (Sec. 7031.5, Business and Professions Code; any city or county which requires a permit to construct, alter, improve, demolish, or repair any structure, prior to its issuance, also requires the applicant for such permit to file a signed statement that he or she is licensed pursuant to the provisions of the Contractors License Law (Chapter 9 (commencing with Section 7000) of Division 8 of the Business and Professions Code) or that he or she is exempt therefrom and the basis for the alleged exemption. Any violation of Section 7031.5 by any applicant for a permit subjects the applicant to a civil penalty of not more than five hundred dollars (\$500.00);

____ I, as a owner of the property, or my employees with wages as their sole compensation, will do the work, and the structure is not intended or offered for sale (Sec. 7044, Business and Professional Code: The Contractors License Law does not apply to an owner of property who builds or improves thereon, and who does such work himself or herself or through his/her own employees, provided that such improvements are not intended or offered for sale. If, however, the building or improvement is sold within one year of completion, the owner-builder will have the burden of proving that he/she did not build or improve for the purpose of sale.)

____ I, as owner of the property, am exclusively contracting with licensed contractors to construct the project (Sec. 7044, Business and Professions Code: The Contractors License Law does not apply to an owner of property who builds or improves thereon, and who contracts for such projects with a contractor(s) licensed pursuant to the Contractors License Law).

____ I am exempt under Sec. _____ B & PC for this reason: _____

Date _____ Owner Signature _____

IN ISSUING THIS BUILDING PERMIT, the applicant represents, and the city relies on the representation of the applicant, that the applicant verified all measurements and locations shown on the application or accompanying drawings and that the improvement to be constructed does not violate any law or private agreement relating to permissible or prohibited locations for such improvements. This building permit does not authorize any illegal location of any improvement or the violation of any private agreement relating to location of improvements.

I certify that I have read this application and state that all information is correct. I agree to comply with all city and county ordinances and state laws relating to building construction and hereby authorize representative(s) of this city to enter upon the above mentioned property for inspection purposes.

Date 10-28-98 Applicant/Agent Signature [Signature]

WORKER'S COMPENSATION DECLARATION: I hereby affirm under penalty of perjury one of the following declarations:

____ I have and will maintain a certificate of consent to self-insure for workers' compensation as provided for by Section 3700 of the Labor Code, for the performance of work for which the permit is issued.

I have and will maintain workers' compensation insurance, as required by Section 3700 of the Labor Code, for the performance of the work for which this permit is issued. My workers' compensation insurance carrier and policy number are:

Carrier Liberty Mutual

Policy Number 032963-018

Exp Date 3-17-99
1999

____ (This section need not be completed if the permit is for \$100 or less) I certify that in the performance of the work for which this permit is issued, I shall not employ any person in any manner so as to become subject to the workers' compensation laws of California and agree that if I should become subject to the workers' compensation provisions of Section 3700 of the Labor Code, I shall forthwith comply with those provisions.

Date 10-28-98 Applicant Signature [Signature]

WARNING: FAILURE TO SECURE WORKER'S COMPENSATION COVERAGE IS UNLAWFUL AND SHALL SUBJECT AN EMPLOYER TO CRIMINAL PENALTIES AND CIVIL FINES UP TO ONE HUNDRED THOUSAND DOLLARS (\$100,000) IN ADDITION TO THE COST OF COMPENSATION, DAMAGES AS PROVIDED FOR IN SECTION 3706 OF THE LABOR CODE, INTEREST AND ATTORNEY'S FEE.

THIS PERMIT SHALL EXPIRE BY LIMITATION IF WORK IS NOT COMMENCED WITHIN 180 DAYS.

Sacramento Fire Department - Incident Report

Incident No : 980024444 Call# : 98053117 Date: 06/15/98 Time: 17:14
Address : 6205 RIVERSIDE BL #217 DBA: RIVERSIDE COMMONS
Type : 11 BUILDING FIRE
Action Taken: 13 EXTINGUISH, SALVAGE, OVERHAUL
Property : APARTMENTS: APT:9-10 UNITS
UBC : HOTELS APT HOUSES CONVENTS

Weather : 92 Degrees / Clear
Resources : 2 Engines, 1 Truck
2 Other Apparatus
1 Fire Rescue Unit

Fire Casualties : None

Fire Damage : Confined to part of room or area of origin
Smoke Damage : Confined to structure of origin
Property Loss : \$6,000 Contents Loss : \$1,200
Property Value : \$1,000,000 Contents Value: \$30,000
Area of Origin : Kitchen area
Caused by : Stove/grill/fixd stationary surface unit
Form of Heat : Heat/properly operating electrical equip
Ignition Factor : Equipment unattended
Type of Material : Fat, grease (food)
Form of Material : Cooking materials
Type of Material : Fat, grease (food)
Form of Material : Cooking materials
Smoke Travel : Doorway, passageway
Other Factors : Careless act

Level: A02

Detection of fire
Extinguished by : Portable extinguisher
Structure Type : Building with one specific property use
Structure Status : In use
Occupied
Construction Type: Type V - Wood Frame
Roof Type : Built up
Number of Stories: 2

Detector Type : Smoke detector - ionization
Power : Battery
Performance : Detector operated but not a factor in discovery
Reason Failed : No failure

Extinguishing Sys: No extinguishing system

Report Author : F282

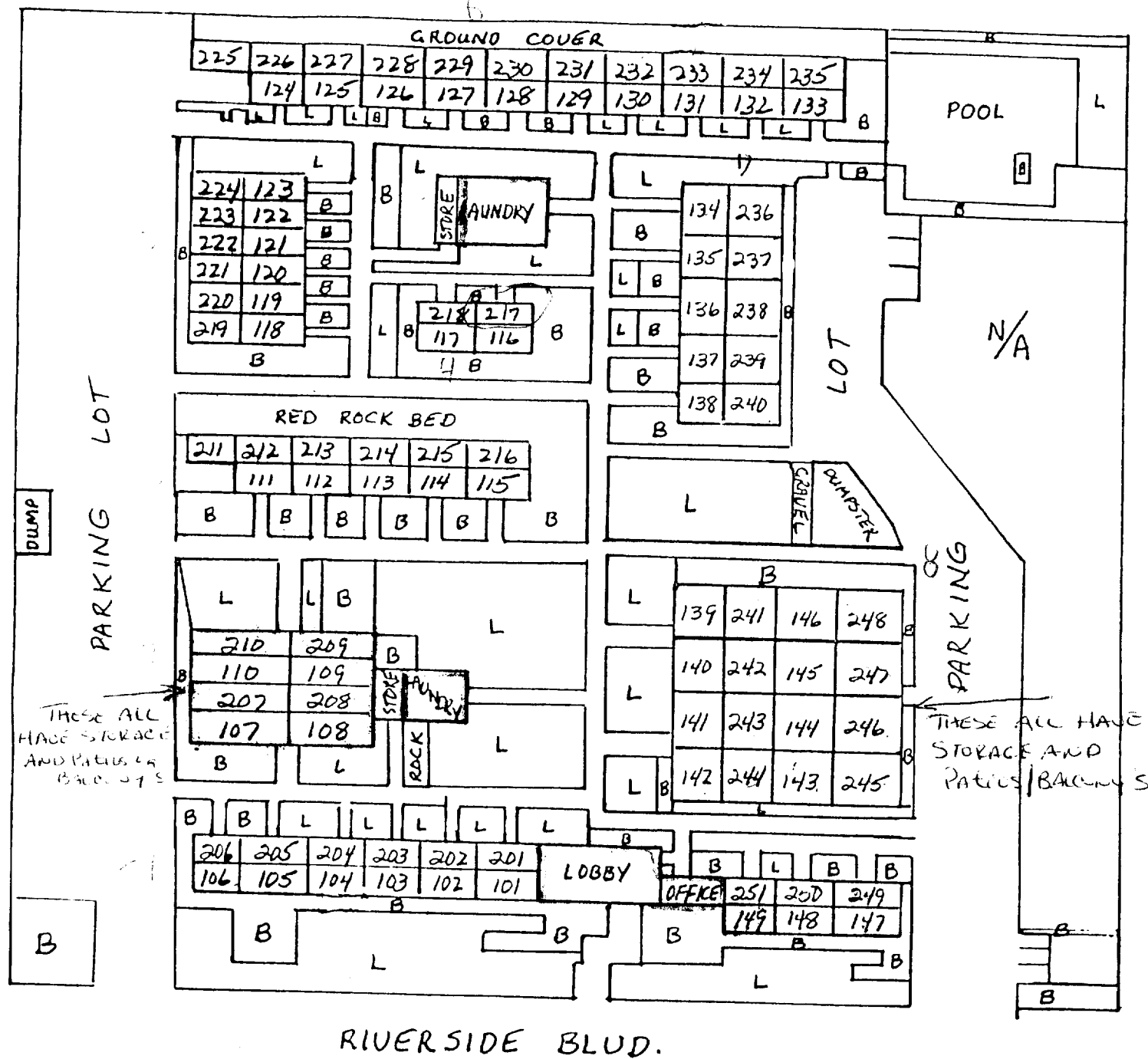

1X1 M = 13
 1X1 LG = 21
 2X1 M = 24
 2X1 LG = 28
 3X1 = 9

100 UNITS

Prepared By:

JOHN G. KALOSTOS & SONS
 LANDSCAPE SERVICES
 7856 VISTARIDGE DRIVE
 CITRUS HEIGHTS, CA 95610

100'S ARE DOWN
 200'S ARE UP