

APPROVED
BY THE CITY COUNCIL

SEP 7 1999

1.10

OFFICE OF THE
CITY CLERK

DEPARTMENT OF
PUBLIC WORKS

CITY OF SACRAMENTO
CALIFORNIA

DEVELOPMENT SERVICES
1231 I STREET
ROOM 200
SACRAMENTO, CA
95814
PH 916-264-7995
FAX 916-448-8450

TECHNICAL SERVICES DIVISION

August 17, 1999

City Council
Sacramento, California

Honorable Members In Session:

SUBJECT: APPROVAL OF PARCEL MAP ENTITLED "PLAT OF 13TH AND 'F'
STREET" - (P98-088)

LOCATION/COUNCIL DISTRICT:

Southwest corner of 13th and 'F' Streets
Council District 1

RECOMMENDATION:

This report recommends that the attached resolution for the Parcel Map entitled " Plat of 13th and 'F' Street" be approved.

CONTACT PERSON:

Faramarz Ansari, Associate Engineer, 264-7493

FOR COUNCIL MEETING OF:

September 7, 1999

SUMMARY:

On November 19, 1998, the City Planning Commission approved a Tentative Parcel Map by adopting a Notice of Decision. All conditions of the tentative map have been met by the subdivider, Anderson - Krambs, LLC, A California Limited Liability Company. This Parcel Map requires approval by the City Council.

COMMITTEE/COMMISSION ACTION:

None.

City Council
Parcel Map (P98-088)
August 17, 1999

BACKGROUND:

On November 19, 1998, the City Planning Commission approved a Tentative Parcel Map by adopting a Notice of Decision. Pursuant to Sacramento City Code, Chapter 40.08.813, and Government Code Section 66458, the City Council may, by resolution, approve parcel maps. The map presented conforms to all the requirements of the Government Code and Title 40 of the City Code, applicable at the time of conditional approval of the Tentative Map. The Parcel Map is consistent with the Central City Community Plan. All conditions in the staff subdivision report have been met and the Parcel Map is presented for approval.

FINANCIAL CONSIDERATIONS:

All subdivision costs are being paid by the subdivider, Anderson - Krambs, LLC, a California Limited Liability Company.

ENVIRONMENTAL CONSIDERATIONS:

On November 19, 1998, the City Planning Commission adopted a Notice of Decision ratifying the Negative Declaration and approving the mitigation monitoring plan for this project.

POLICY CONSIDERATIONS:

Pursuant to Sacramento City Code, Chapter 40.08.813, and Government Code Section 66458, the City Council may, by resolution, approve parcel maps. The map presented conforms to all the requirements of the Government Code and Title 40 of the City Code, applicable at the time of conditional approval of the Tentative Map.

City Council
Parcel Map (P98-088)
August 17, 1999

ESBD CONSIDERATIONS:

City Council adoption of the attached ordinance and the resolution is not affected by City policy related to the ESBD Program.

Respectfully submitted,

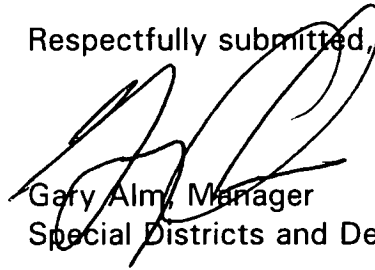

Gary Alm, Manager
Special Districts and Development Services

Approved:

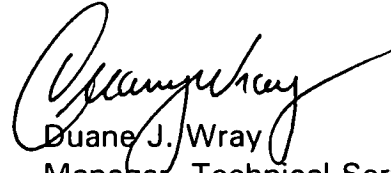

Duane J. Wray
Manager, Technical Services Division

RECOMMENDATION APPROVED:



ROBERT P. THOMAS
City Manager

APPROVED:



Michael Kashiwagi
Director of Public Works

JL:GA:dt
S:\techsvs\projdel\devsvs\council\P98-088
08.1799.1

Attachment

RESOLUTION NO. 99-509

APPROVED
BY THE CITY COUNCIL
SEP 7 1999
OFFICE OF THE
CITY CLERK

ADOPTED BY THE SACRAMENTO CITY COUNCIL

ON DATE OF _____

APPROVING PARCEL MAP ENTITLED "PLAT OF 13TH AND 'F' STREET (P98-088)

WHEREAS, THE COUNCIL OF THE CITY OF SACRAMENTO FINDS AND DETERMINES AS FOLLOWS:

- A. The Parcel Map entitled "Plat of 13th and 'F' Street", located at the southwest corner of 13th and F Street, with provisions for its design and improvement, is consistent with the Central City Community Plan. See Exhibit 'A' for project location.
- B. The Parcel Map is in substantial compliance with the previously approved tentative parcel map.

NOW, THEREFORE, BE IT RESOLVED BY THE COUNCIL OF THE CITY OF SACRAMENTO AS FOLLOWS:

- 1. The Parcel Map is hereby approved.
- 2. All offers of dedication shown on said map are hereby accepted.

MAYOR

ATTEST:

CITY CLERK

S:\techsvs\projdel\devsvs\council\P98-088
08.1799.1

FOR CITY CLERK USE ONLY

RESOLUTION NO.: _____

DATE ADOPTED: _____

**PLAT OF
13TH AND "F" STREET
LOTS 4 & 5 IN THE BLOCK BOUNDED BY
"F" & "G", 12TH & 13TH STREETS AS SHOWN
ON THE OFFICIAL PLAT OF THE CITY OF SACRAMENTO
CITY OF SACRAMENTO, SACRAMENTO COUNTY, CALIFORNIA
AUGUST, 1999
PEABODY ENGINEERING
SHEET 2 OF 2**



BASIS OF BEARINGS:
THE BASIS OF BEARINGS FOR THIS SURVEY IS IDENTICAL TO THAT
CERTAIN RECORD OF SURVEY FILED IN BOOK 38 OF SURVEYS AT
PAGE 14 IN THE RECORDER'S OFFICE OF SACRAMENTO COUNTY
MEASURED BETWEEN FOUND MONUMENTS SHOWN HEREON AND
TAKEN TO BE "NORTH 18°30'48" EAST."

MARKER	BEARING	DISTANCE
①	N71°33'32"W	18.51'
②	N71°33'32"W	0.26'
③	N71°33'32"W	0.26'
④	N71°33'32"W	5.71'
⑤	N71°33'32"W	8.58'
⑥	N18°28'28"E	4.18'
⑦	N71°33'32"W	12.29'
⑧	N63°29'28"E	0.41'

- LEGEND:**
- DIMENSION POINT
 - ✕ 5/8" CHISELED "I" IN CONCRETE
 - 1/2" IRON NAIL, WEDGED BY CITY TIES
 - FOUND CONCRETE NAIL
 - (-)- RECORD PLOT NO. R.S. 14
 - P.U.E. PUBLIC UTILITY'S EASEMENT
 - - - PRIVATE RECIPROCAL WALKWAY/EGRESS EASEMENT, DRAINAGE EASEMENT, FIRE LANE AND P.U.E. (COMMON DRIVEWAY AREA)

- NOTES:**
1. THE TOTAL AREA CONTAINED WITHIN THIS SUBDIVISION IS 0.59 ACRES.
 2. THE COMMON DRIVEWAY AREA SHOWN HEREON SHALL BE DEDICATED AS PRIVATE RECIPROCAL WALKWAY/EGRESS EASEMENTS, DRAINAGE EASEMENTS AND FIRE LANE WITH THE SALE OF LOTS 1-4 AND 7-10.
 3. PRIVATE WATER EASEMENTS SHALL BE DEDICATED WITH THE SALE OF EACH LOT.

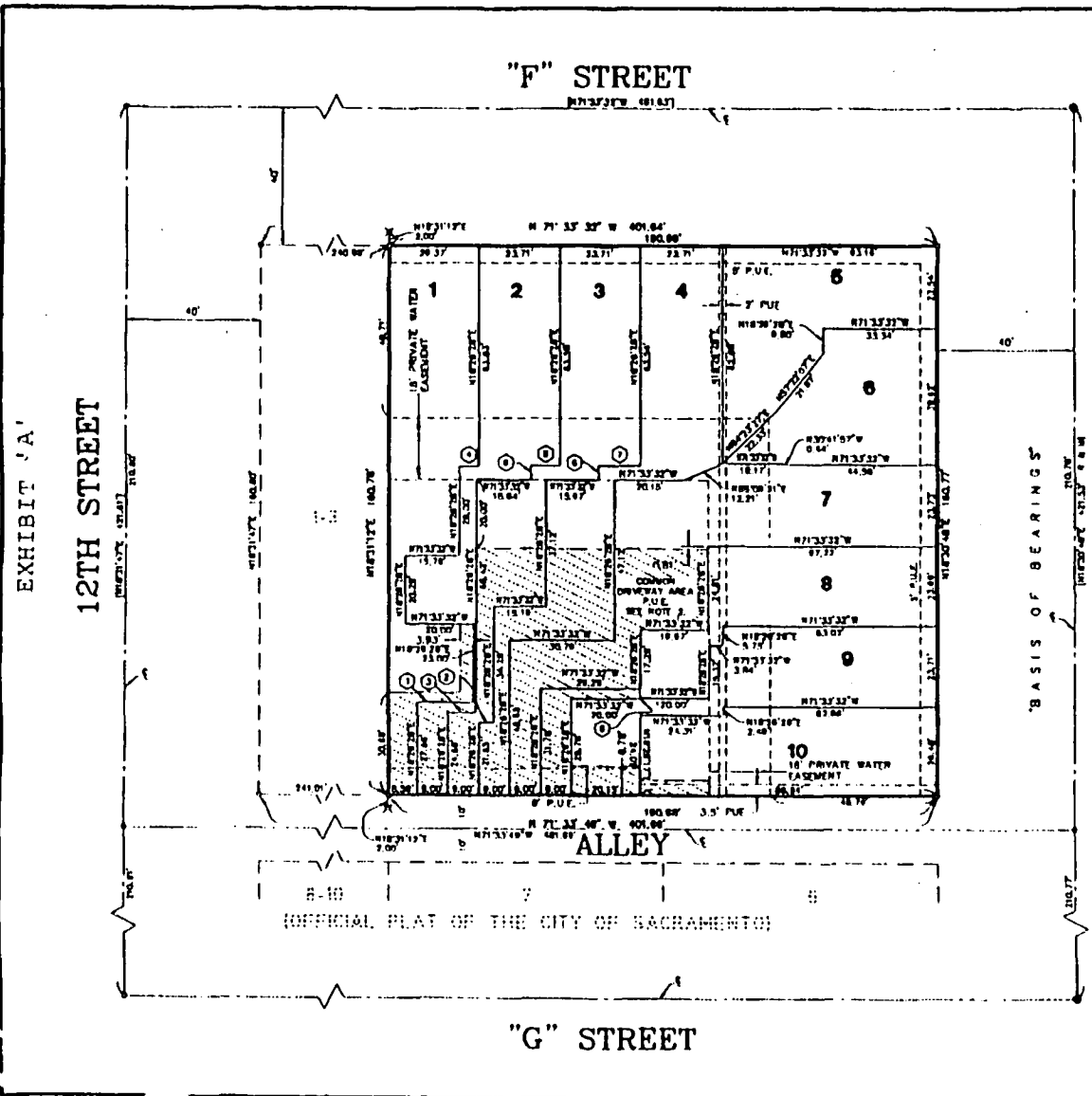

RESOLUTION NO.:

DATE ADOPTED:

FOR CITY CLERK USE ONLY