

**CITY OF SACRAMENTO**  
1231 I Street, Sacramento, CA 95814

**Permit No: 0318331**

**Insp Area: 2**  
**Thos Bros: 337 F3**

**Site Address: 7579 32ND ST SAC**  
**Parcel No: 049-0233-001**

**Sub-Type: RES**  
**Housing (Y/N): N**

CONTRACTOR

OWNER  
MALDONADO MANUEL/SOPHIE J  
7579 32ND STREET  
SACRAMENTO CA 95822

ARCHITECT

**Nature of Work: SMUD SAFETY INSPECTION, REPAIR AS NEEDED**

**CONSTRUCTION LENDING AGENCY:** I hereby affirm under penalty of perjury that there is a construction lending agency for the performance of the work for which this permit is issued (Sec. 3097, Civ. C).

Lender's Name \_\_\_\_\_ Lender's Address \_\_\_\_\_

**LICENSED CONTRACTORS DECLARATION:** I hereby affirm under penalty of perjury that I am licensed under provisions of Chapter 9 (commencing with section 7000) of Division 3 of the Business and Professions Code and my license is in full force and effect.

License Class \_\_\_\_\_ License Number \_\_\_\_\_ Date \_\_\_\_\_ Contractor Signature \_\_\_\_\_

**OWNER-BUILDER DECLARATION:** I hereby affirm under penalty of perjury that I am exempt from the contractors License Law for the following reason (Sec. 7031.5, Business and Professions Code; any city or county which requires a permit to construct, alter, improve, demolish, or repair any structure, prior to its issuance, also requires the applicant for such permit to file a signed statement that he or she is licensed pursuant to the provisions of the Contractors License Law (Chapter 9 (commencing with Section 7000) of Division 8 of the Business and Professions Code) or that he or she is exempt therefrom and the basis for the alleged exemption. Any violation of Section 7031.5 by any applicant for a permit subjects the applicant to a civil penalty of not more than five hundred dollars (\$500.00);

\_\_\_\_\_, I, as a owner of the property, or my employees with wages as their sole compensation, will do the work, and the structure is not intended or offered for sale (Sec. 7044, Business and Professional Code: The Contractors License Law does not apply to an owner of property who builds or improves thereon, and who does such work himself or herself or through his/her own employees, provided that such improvements are not intended or offered for sale. If, however, the building or improvement is sold within one year of completion, the owner-builder will have the burden of proving that he/she did not build or improve for the purpose of sale.)

LF I, as owner of the property, am exclusively contracting with licensed contractors to construct the project (Sec. 7044, Business and Professions Code: The Contractors License Law does not apply to an owner of property who builds or improves thereon, and who contracts for such projects with a contractor(s) licensed pursuant to the Contractors License Law).

\_\_\_\_\_, I am exempt under Sec. \_\_\_\_\_ B & PC for this reason: \_\_\_\_\_

Date 11/25/03 Owner Signature [Signature]

IN ISSUING THIS BUILDING PERMIT, the applicant represents, and the city relies on the representation of the applicant, that the applicant verified all measurements and locations shown on the application or accompanying drawings and that the improvement to be constructed does not violate any law or private agreement relating to permissible or prohibited locations for such improvements. This building permit does not authorize any illegal location of any improvement or the violation of any private agreement relating to location of improvements.

I certify that I have read this application and state that all information is correct. I agree to comply with all city and county ordinances and state laws relating to building construction and herby authorize representative(s) of this city to enter upon the abovementioned property for inspection purposes.

Date 11/25/03 Applicant/Agent Signature [Signature]

**WORKER'S COMPENSATION DECLARATION:** I hereby affirm under penalty of perjury one of the following declarations:  
\_\_\_\_\_, I have and will maintain a certificate of consent to self-insure for workers' compensation as provided for by Section 3700 of the Labor Code, for the performance of work for which the permit is issued.

\_\_\_\_\_, I have and will maintain workers' compensation insurance, as required by Section 3700 of the Labor Code, for the performance of the work for which this permit is issued. My workers' compensation insurance carrier and policy number are:

Carrier

**NEIGHBORHOODS PLANNING AND DEVELOPMENT SERVICES**

Exp Date

LF (This section need not be completed if the permit is for \$100 or less) I certify that in the performance of the work for which this permit is issued, I shall not employ any person in any manner so as to become subject to the workers' compensation laws of California and agree that if I should become subject to the workers' compensation provisions of Section 3700 of the Labor Code, I shall forthwith comply with those provisions.

Date 11/25/03 Applicant Signature [Signature]

**WARNING: FAILURE TO SECURE WORKER'S COMPENSATION COVERAGE IS UNLAWFUL AND SHALL SUBJECT AN EMPLOYER TO CRIMINAL PENALTIES AND CIVIL FINES UP TO ONE HUNDRED THOUSAND DOLLARS (\$100,000) IN ADDITION TO THE COST OF COMPENSATION, DAMAGES AS PROVIDED FOR IN SECTION 3706 OF THE LABOR CODE, INTEREST AND ATTORNEY'S FEE.**

**THIS PERMIT SHALL EXPIRE BY LIMITATION IF WORK IS NOT COMMENCED WITHIN 180 DAYS.**



INSULATION CONTRACTORS ASSOCIATION OF AMERICA

0218331

INSULATION CERTIFICATE  
52380

1321 DUKE STREET, SUITE 303 • ALEXANDRIA, VA 22314 • (703) 739-0356

THIS IS TO CERTIFY THAT INSULATION HAS BEEN INSTALLED IN CONFORMANCE WITH CURRENT ENERGY REGULATIONS, CALIFORNIA ADMINISTRATIVE CODE, TITLE 24, STATE OF CALIFORNIA, IN THE BUILDING LOCATED AT:

STREET 2874 Rockaway Ln CITY San Jose TRACT # MARLEY

EXTERIOR WALLS:

MANUFACTURER F/L THICKNESS/TYPE \_\_\_\_\_ R- VALUE 13

CEILING: BATT: \_\_\_\_\_ R- VALUE 38

MANUFACTURER F/L THICKNESS/TYPE \_\_\_\_\_ R- VALUE 38

BLOWN IN: \_\_\_\_\_ MINIMUM THICKNESS 1 3/4 R- VALUE 38

MANUFACTURER \_\_\_\_\_ THICKNESS/TYPE \_\_\_\_\_ R- VALUE \_\_\_\_\_

SQUARE FOOTAGE COVERED 250 NUMBER OF BAGS USED 47

FLOORS: MANUFACTURER \_\_\_\_\_ THICKNESS/TYPE \_\_\_\_\_ R- VALUE \_\_\_\_\_

SLAB ON GRADE: MANUFACTURER \_\_\_\_\_ THICKNESS/TYPE \_\_\_\_\_ R- VALUE \_\_\_\_\_

WIDTH OF INSULATION \_\_\_\_\_ INCHES

FOUNDATION WALLS: MANUFACTURER \_\_\_\_\_ THICKNESS/TYPE \_\_\_\_\_ R- VALUE \_\_\_\_\_

GENERAL CONTRACTOR \_\_\_\_\_ DATE \_\_\_\_\_

CALIFORNIA CONTRACTORS LICENSE # \_\_\_\_\_

INSULATION CONTRACTOR ARCADE INSULATION TITLE \_\_\_\_\_

CALIFORNIA CONTRACTORS LICENSE #815286 DATE 10-8-03

NEVADA CONTRACTORS LICENSE #0055201 SIGNATURE \_\_\_\_\_ TITLE \_\_\_\_\_

# KwikKote

No. 200-913609

## Stucco System Installation Card

Job Name: MONTEREY COLLECTION  
Address: 2874 ROCKAWAY LANE  
SACRAMENTO, CA  
Lot #: 00024-5

Stucco System Trade Name: KWIK KOTE  
Stucco System Manufacturer: KWIK KOTE CORP.

ICBO Evaluation Service, Inc.  
Report No. 3607  
Date of Job Completion:

Home Builder: LENNAR RENAISSANCE  
Address: 2240 DOUGLAS BLVD #250  
ROSEVILLE, CA

Stucco Contractor: KENYON PLASTERING, INC.  
Address: PO BOX 2077  
North Highlands, CA

Telephone Number: 916/349-8191

Approved Contractor Number as  
issued by the Stucco Manufacturer: 1001

Card Print Date: 01/29/2003

This is to certify that the stucco system on the building exterior at the above address had been installed in accordance with the evaluation report specified above and the manufacturer's instructions.

  
\_\_\_\_\_  
Signature of authorized representative of stucco contractor

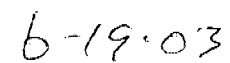
  
\_\_\_\_\_  
Date

**INSTALLATION CERTIFICATE**

CF-6R

**2874 Rockaway Ln RENAISSANCE- Heritage Park Monterey**  
 Site Address

**0218331**  
 Permit Number

An installation certificate is required to be posted at the building site or made available for all appropriate inspections. (The information provided on this form is required; however, use of this form to provide the information is optional.) After completion of final inspection a copy must be provided to the building department (upon request) and the building owner at occupancy, per Section 10-103(b).

**HVAC SYSTEMS:**

**Heating Equipment**

Equip. Type (pkg. Heat pump)	CEC Certified Mfr name and Model #	# of Identical Systems	(1) Efficiency (ΔFUE, etc.) > CF-1R value	Duct Location (attic, etc.)	Duct or Piping R-value	Heating Load (Btu/hr)	Heating Capacity (Btu/hr)	
Furnace	Carrier 58MVP080-20	1	0.94	Attic	R-6	42,168	80,000	Plan 1161
Furnace	Carrier 58MVP080-20	1	0.94	Attic	R-6	43,993	80,000	Plan 1162
Furnace	Carrier 58MVP100-20	1	0.94	Attic	R-6	45,120	100,000	Plan 1163
Furnace	Carrier 58MVP100-20	1	0.94	Attic	R-6	45,609	100,000	Plan 1164

**Cooling Equipment**

Equip. Type (pkg. Heat pump)	CEC Certified Compressor Unit Mfr Name and Model #	# of Identical Systems	(1) Efficiency (SEER, etc.) > CF-1R value	Duct Location (attic, etc.)	Duct R-value	Cooling Load (Btu/hr)	Cooling Capacity (Btu/hr)	
Condenser	Carrier 38TDB048-3 *	1	16.0	Attic	R-6	38,978	47,500	Plan 1161
Condenser	Carrier 38TDB048-3 *	1	16.0	Attic	R-6	37,695	47,500	Plan 1162
Condenser	Carrier 38TDB060-3 *	1	16.0	Attic	R-6	40,038	60,000	Plan 1163
Condenser	Carrier 38TDB060-3 *	1	16.0	Attic	R-6	39,376	60,000	Plan 1164

\*TXV - Indicates Thermal Expansion Valve On Coil

(1) ≥ reads greater than or equal to.

I, the undersigned, verify that equipment listed above is: 1) the actual equipment installed; 2) equivalent to or more efficient than that specified in the certificate of compliance (Form CF-1R) submitted for compliance with the Energy Efficiency Standards for residential buildings; and 3) equipment that meets or exceeds the appropriate requirements for manufactured devices (from the Appliance Efficiency Regulations or Part 6), where applicable.

*Mark Haddock* 8-20-03  
 Signature, Date

Beutler Corporation

OR General Contractor (Co. Name) OR Owner

**WATER HEATING SYSTEMS:**

Heater Type	CEC Certified Mfr Name & Model #	Distribution Type (Std. point of use)	If Recirculation Control Type	# of Identical Systems	(2) Rated Input (kW or Btu/hr)	Tank Volume (gallons)	(2) Efficiency (EF, RE)	(2) Standby Loss (%)	External Insulation R-value
GIAS		STO	N/A	N/A	40,000	50			

(2) For small gas storage (rated input of less than or equal to 75,000 Btu/hr), electric resistance and heat pump water heaters, list Energy Factor. For large gas storage water heaters (rated input of greater than 75,000 Btu/hr), list Recovery Efficiency, Standby Loss and Rated Input. For instantaneous gas water heaters, list Recovery efficiency and Rated Input.

(3) R-12 external insulation is mandatory for storage water heaters with an energy factor of less than 0.58

**Facets & Shower Heads:**

All facets and showerheads installed are certified to the Commission, pursuant to Title 24, Part 6, Section 111.

I, the undersigned, verify that equipment listed above my signature is: 1) the actual equipment installed; 2) equivalent to or more efficient than that specified in the certificate of compliance (Form CF-1R) submitted for compliance with the Energy Efficiency Standards for residential buildings; and 3) equipment that meets or exceeds the appropriate requirements for manufactured devices (from the Appliance Efficiency Regulations or Part 6), where applicable.

*Paul Schmitt*  
 Signature, Date

RENAISSANCE HOMES  
 Installing Subcontractor (Co. Name)  
 OR General Contractor (Co. Name) OR Owner

COPY TO: Building Department  
 HERS Provider (if applicable)  
 Building Owner at Occupancy

## A. CONTI ENGINEERING SERVICES

CIVIL CONSULTING ENGINEER

PO Box 1396 Woodbridge, CA 95258 ph.: (209) 476-0970 fax: (209) 476-0977 email: acontiengineer@aol.com

### GRADING CERTIFICATION

I hereby certify that a site inspection (based on field measurements and surveys) was made under my direction on October 16, 2003 at **2874 Rockaway Lane, Sacramento, CA, Lot # 24**. This lot has been final graded and the front yard landscaped. To the best of my knowledge, information and beliefs:

1. Grades create positive drainage away from the structure.
2. The backyard will drain through the side yard to the front yard as shown in the attached plat.



Antonio M. Conti, PE

COPY

9/26/03

9/20/03

23

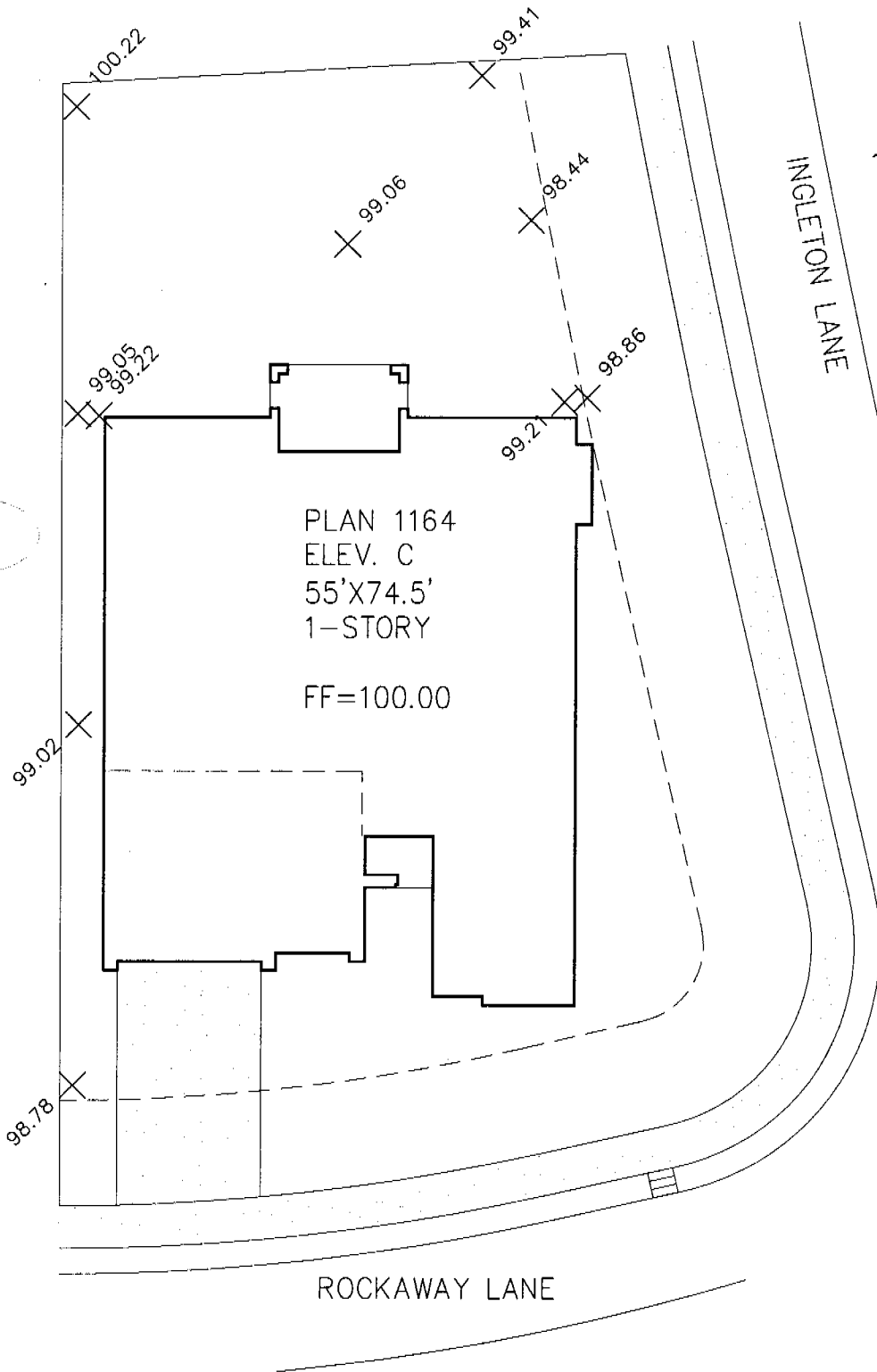

**A. CONTI  
ENGINEERING SERVICES**

P.O. BOX 1396  
Woodbridge, CA 95258  
(209) 476-0970  
acontiengineer@aol.com

RENAISSANCE HOMES - HERITAGE PARK VILLAGE 5  
MONTEREY COLLECTION

**LOT 24**  
**2874 ROCKAWAY LANE**  
**PLAT**

DRAWN AMC

CHECK AMC

SCALE NTS

DATE 10/19/03

FILE NO. 03-27

SHEET 1 OF 1

OWNER-BUILDER VERIFICATION

ATTENTION PROPERTY OWNERS

An owner-builder building permit has been applied for in your name and bearing your signature.

Please complete and return this information in the envelope provided at your earliest opportunity to avoid unnecessary delay in processing and issuing your building permit. No building permit will be issued until this verification is received.

1. I personally plan to provide the major labor and materials for construction of the proposed Improvement (yes or no) ~~YES~~ NO
2. I (have/have not) HAVE signed an application for A building permit for the proposed work.
3. I have contracted with the following person (firm) to provide the proposed construction:

Name \_\_\_\_\_ Address \_\_\_\_\_

City \_\_\_\_\_ Telephone \_\_\_\_\_

Contractors License No. \_\_\_\_\_

4. I plan to provide portions of the work, but I have hired the following person to coordinate, Supervise, and provide the major work.

Name \_\_\_\_\_ Address \_\_\_\_\_

City \_\_\_\_\_ Telephone \_\_\_\_\_

Contractors License No. \_\_\_\_\_

5. I will provide some of the work but I have contracted (hired) the following to provide the Work indicated:

Name	Address	Phone	Type of work

X Signed Regina Fy

Job Address 7579 32<sup>nd</sup> St

Permit No: 0318331



DEPARTMENT OF  
NEIGHBORHOODS, PLANNING  
AND DEVELOPMENT SERVICES

CITY OF SACRAMENTO  
CALIFORNIA

1231 I STREET  
ROOM 200  
SACRAMENTO, CA  
95814-2904

DEVELOPMENT SERVICES  
DIVISION

916-264-7619  
FAX 916-264-7046

EXHIBIT 1

I have read and am familiar with the contents of the City's Standard  
Owner-Builder Notification and Owner-Builder Verification, as required by  
California Health and Safety Code Section 19830 and 19831. I authorize my  
agent(s) LEIGHTON FONG

to sign the Owner-Builder Verification on my behalf.

Signature Rose M. Guido  
Print Name ROSE M. GUIDO  
Address 7579 32nd St.  
SACTO. CA. 95822  
Telephone 916-392-2119

City of Sacramento