

CITY OF SACRAMENTO
1231 I Street, Sacramento, CA 95814

Permit No: 0101063
Insp Area: 2

Site Address: 7852 CALZADA WY SAC
Parcel No: 117-1310-021 JACINTO VILLAGE 2 LOT 21

Sub-Type: NSFR
Housing (Y/N): N

CONTRACTOR
BEAZER HOMES
3009 DOUGLAS BL #150
ROSEVILLE CA 95661

OWNER

ARCHITECT

Nature of Work: NSFR MP1659 8 RMS

CONSTRUCTION LENDING AGENCY: I hereby affirm under penalty of perjury that there is a construction lending agency for the performance of the work for which this permit is issued (Sec. 3097, C.V.C.)

Lender's Name _____ Lender's Address _____

LICENSED CONTRACTORS DECLARATION: I hereby affirm under penalty of perjury that I am licensed under provisions of Chapter 9 (commencing with section 7000) of Division 3 of the Business and Professions Code and my license is in full force and effect.

License Class B License Number 724191 Date 2/20/01 Contractor Signature Sheryl Van Maeren

OWNER-BUILDER DECLARATION: I hereby affirm under penalty of perjury that I am exempt from the contractor's License Law for the following reason (Sec. 7031.5, Business and Professions Code): any city or county which requires a permit to construct, alter, improve, demolish, or repair any structure, prior to its issuance, also requires the applicant for such permit to file a signed statement that he or she is licensed pursuant to the provisions of the Contractors License Law (Chapter 9 (commencing with Section 7000) of Division 8 of the Business and Professions Code) or that he or she is exempt therefrom and the basis for the alleged exemption. Any violation of Section 7031.5 by any applicant for a permit subjects the applicant to a civil penalty of not more than five hundred dollars (\$500.00).

____ I, as a owner of the property, or my employees with wages as their sole compensation, will do the work, and the structure is not intended or offered for sale (Sec. 7044, Business and Professional Code). The Contractors License Law does not apply to an owner of property who builds or improves thereon, and who does such work himself or herself or through his/her own employees, provided that such improvements are not intended or offered for sale. If, however, the building or improvement is sold within one year of completion, the owner-builder will have the burden of proving that he/she did not build or improve for the purpose of sale.)

____ I, as owner of the property, am exclusively contracting with licensed contractors to construct the project (Sec. 7044, Business and Professions Code). The Contractors License Law does not apply to an owner of property who builds or improves thereon, and who contracts for such projects with a contractor(s) licensed pursuant to the Contractors License Law.)

____ I am exempt under Sec. _____ B & PC for this reason: _____

Date _____ Owner Signature _____

IN ISSUING THIS BUILDING PERMIT, the applicant represents, and the city relies on the representation of the applicant, that the applicant verified all measurements and locations shown on the application or accompanying drawings and that the improvement to be constructed does not violate any law or private agreement relating to permissible or prohibited locations for such improvements. This building permit does not authorize any illegal location of any improvement or the violation of any private agreement relating to location of improvements.

I certify that I have read this application and state that all information is correct. I agree to comply with all city and county ordinances and state laws relating to building construction and hereby authorize representative(s) of this city to enter upon the above mentioned property for inspection purposes.

Date 2/20/01 Applicant Agent Signature Sheryl Van Maeren

WORKER'S COMPENSATION DECLARATION: I hereby affirm under penalty of perjury one of the following declarations:

____ I have and will maintain a certificate of consent to self-insure for workers' compensation as provided for by Section 3700 of the Labor Code, for the performance of work for which the permit is issued.

I have and will maintain workers' compensation insurance, as required by Section 3700 of the Labor Code, for the performance of the work for which this permit is issued. My workers' compensation insurance carrier and policy number are:

Carrier LIBERTY MUTUAL INS CO. Policy Number WA2-651-004147-080 Exp Date 04/01/2001

____ (This section need not be completed if the permit is for \$100 or less) I certify that in the performance of the work for which this permit is issued, I shall not employ any person in any manner so as to become subject to the workers' compensation laws of California and agree that if I should become subject to the workers' compensation provisions of Section 3700 of the Labor Code, I shall forthwith comply with those provisions.

Date 2/20/01 Applicant Signature Sheryl Van Maeren

WARNING: FAILURE TO SECURE WORKER'S COMPENSATION COVERAGE IS UNLAWFUL AND SHALL SUBJECT AN EMPLOYER TO CRIMINAL PENALTIES AND CIVIL FINES UP TO ONE HUNDRED THOUSAND DOLLARS (\$100,000) IN ADDITION TO THE COST OF COMPENSATION, DAMAGES AS PROVIDED FOR IN SECTION 3706 OF THE LABOR CODE, INTEREST AND ATTORNEY'S FEE.

THIS PERMIT SHALL EXPIRE BY LIMITATION IF WORK IS NOT COMMENCED WITHIN 180 DAYS.

RESIDENTIAL BUILDING PERMIT APPLICATION

- New Construction
 Addition
 Remodels
 Other

Project Address: 7952 Calzada Way lot 21 Assessor Parcel # 117 1310 021

Jacinto Village 2

OWNER INFORMATION:

Legal Property Owner: Beazer Homes Holdings Corp. Phone # 916-773-3888
 Owner Address: 3009 Douglas Blvd. 150 City Roseville State CA Zip 95661

CONTRACTOR INFORMATION:

Contractor: Beazer Homes Lic. # B724191 Phone # 916-773-3888 Fax# 916-773-0425

PROJECT INFORMATION:

Land Use Zone _____ Occupancy Group _____ Construction Type _____ Fed Code _____
 No. of stories: 1 No. of rooms: _____ Street width: _____
 1st Floor Area 11059 2nd Floor Area _____ Basement _____ Roof Material _____

AREA IN SQUARE FOOT OF:	EXISTING	NEW
Dwelling/Living	_____	<u>11059</u>
Garage/Storage	_____	<u>4100</u>
Decks/Balconies	_____	<u>11</u>
Carports	_____	_____

SCOPE OF WORK: Single Family Dwelling

FOR OFFICE USE ONLY

- | | | |
|---|---|--|
| <input type="checkbox"/> Information above complete | <input type="checkbox"/> AR Flood Waiver required | <input type="checkbox"/> Planning Approval |
| <input type="checkbox"/> Violation files checked | <input type="checkbox"/> Flood Elevation Certificate Required | <input type="checkbox"/> Design Review Approval |
| <input type="checkbox"/> Standard setbacks | <input type="checkbox"/> Water Development Infill Area | <input type="checkbox"/> Special Fee Districts Apply : _____ |
| <input type="checkbox"/> County Sewer | | |

NEW STRUCTURES & ADDITIONS

◆ THE FOLLOWING MUST BE PROVIDED IN ORDER TO SUBMIT FOR PLAN REVIEW

- | | |
|---|---|
| <input type="checkbox"/> 2 COMPLETE PLANS, LEGIBLE & DRAWN TO SCALE | ◆ Plans to include: site plan, floor plan, elevations, roof/ceiling plan, foundation and structural framing details, and structural calculations for non-conforming structures. |
| <input type="checkbox"/> 3 SETS IF PROJECT IS IN A DESIGN REVIEW AREA | |
| <input type="checkbox"/> Title 24 Energy Compliance documentation | <input type="checkbox"/> 11" x 17" copy of floor plan for County Assessor |
| <input type="checkbox"/> Grading and Erosion Control Questionnaire | <input type="checkbox"/> Plan Review Fees |

Date: _____

Received by: (staff) _____

CITY OF SACRAMENTO
ACTIVITY/PERMIT
PERMIT ASSISTANCE

JAN 08 2001

RECEIVED

CERTIFICATION OF INSULATION

<p>ADDRESS OR TRACT</p> <p style="font-size: 2em; font-family: cursive;">BEAZER</p> <p style="font-size: 2em; font-family: cursive;">BELLE FLEUR II</p> <p style="margin-left: 200px;">LOT # 1071</p>	<p style="text-align: center;">SACRAMENTO INSULATION CONTRACTORS</p> <p><input checked="" type="checkbox"/> P.O. BOX 854, WEST SACRAMENTO, CA 95691 LIC. #202026</p> <p><input type="checkbox"/> 1309 MELODY ROAD, MARYSVILLE, CA 95901 LIC. #202026</p> <p><input type="checkbox"/> P.O. BOX 9651, FRESNO, CA 93793-9651 LIC. #202026</p> <p><input type="checkbox"/> P.O. BOX 1631, RENO, NV 89505 LIC. #10675</p> <p><input type="checkbox"/> 3326 A PONDEROSA WAY, LAS VEGAS, NV 89118 LIC. #10675</p> <p>DATE INSULATION COMPLETED</p>
--	--

WALLS	CEILINGS	FLOORS				
(SQUARE FEET)	(SQUARE FEET)	(SQUARE FEET)				
TYPE OF INSULATION	TYPE OF INSULATION	TYPE OF INSULATION				
MATERIAL FIBERGLASS	MATERIAL FIBERGLASS	MATERIAL FIBERGLASS				
FORM BATTS	FORM BATTS & BLOW	FORM BATTS				
MANUFACTURER'S PRODUCT I.D.	MANUFACTURER'S PRODUCT I.D.	MANUFACTURER'S PRODUCT I.D.				
MANUFACTURER	MANUFACTURER	MANUFACTURER				
OCF	OCF	OCF				
	BAGS					
R - VALUE INSTALLED	APPLIED THICKNESS	R - VALUE INSTALLED	APPLIED THICKNESS	MIN. INSTALLED WEIGHT PER SQUARE FOOT	R - VALUE INSTALLED	APPLIED THICKNESS
13	3 5/8"	30 30	9" 12"			
KNEE WALLS IF R-VALUE IS OTHER THAN WALLS ABOVE						
MATERIAL FIBERGLASS	FORM BATTS	R VALUE	MANUFACTURER OCF			
AIR INFILTRATION SEALANT						
MATERIAL FOAM	MANUFACTURER W R GRACE					

THIS IS TO CERTIFY THAT INSULATION AND/OR SEALANT HAS BEEN INSTALLED IN CONFORMANCE WITH APPLICABLE CODES, MATERIAL STANDARDS AND REGULATIONS.

SIGNATURE - INSULATION CONTRACTOR <i>Bill Gilroy</i>	TITLE MANAGER	DATE 7-9-01
SIGNATURE - GENERAL CONTRACTOR	TITLE	DATE
REMARKS		

KwikKote

No. 200-000319

Stucco System Installation Card

Job Name: BELLEFLEUR II
Address: 7852 CALZADA WY
Elk Grove, CA
Lot #: 0001021

Stucco System Trade Name: KWIK KOTE
Stucco System Manufacturer: KWIK KOTE CORP.

ICBO Evaluation Service, Inc.
Report No. 3607
Date of Job Completion:

Home Builder: BEAZER HOMES
Address: 3009 DOUGLAS BLVD #150
ROSEVILLE, CA

Stucco Contractor: KENYON PLASTERING, INC.
Address: PO BOX 2077
North Highlands, CA

Telephone Number: 916/349-8191

Approved Contractor Number as
issued by the Stucco Manufacturer: 1001

Card Print Date: 06/13/2001

This is to certify that the stucco system on the building exterior at the above address had been installed in accordance with the evaluation report specified above and the manufacturer's instructions.



Signature of authorized representative of stucco contractor

7-23-01
Date

THIS PLOT PLAN IS NOT FOR SALES PURPOSES. THIS PLOT PLAN IS FOR THE PURPOSES OF INDICATING COMPLIANCE WITH ZONING SET BACKS, GENERAL DRAINAGE DIRECTION, AND APPROXIMATE UTILITY CONNECTION. ALL OTHER DATA SHOWN HEREON IS CONCEPTUAL. THIS PLOT PLAN DOES NOT REFLECT AS-BUILT CONDITION. RETAINING WALLS ARE OPTIONAL AND MAY OR MAY NOT BE CONSTRUCTED.

CALZADA WAY

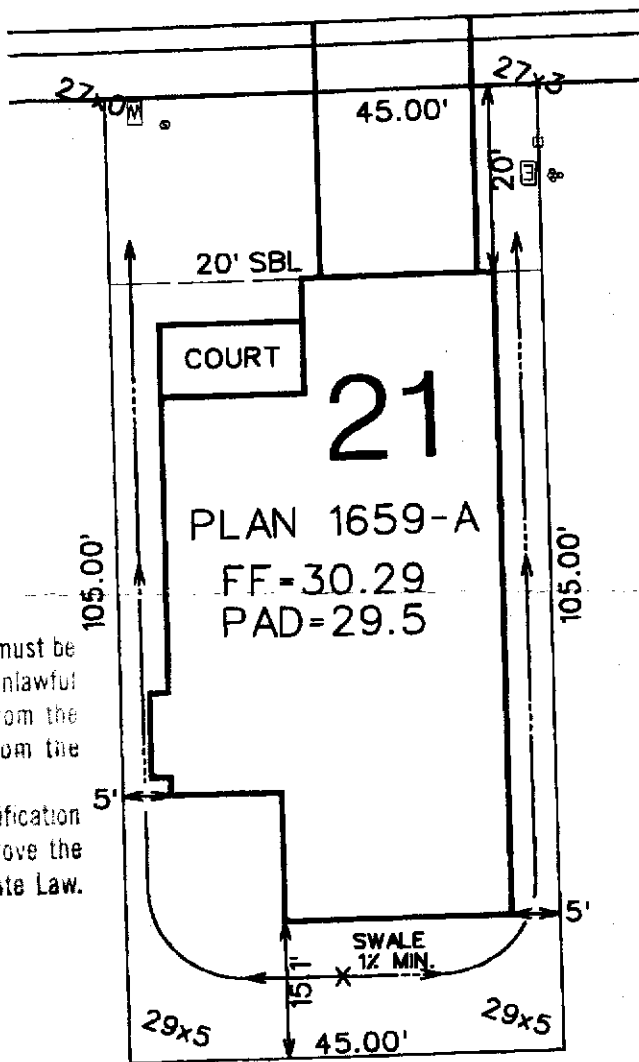
- ☐ — WATER METER BOX
- ☐ — ELECTRICAL BOX
- ⊕ — UTILITY RISERS
- — SEWER CLEANOUT
- ⊗ — STREET LIGHT
- ⊗ — FIRE HYDRANT
- ☐ — TRANSFORMER
- ☐ — ELECTRICAL VAULT
- ☐ — TELEPHONE PED.
- — DRAIN INLET



This set of plans and specifications must be kept on the job at all times, and it is unlawful to make any changes or alterations from the same without written permission from the Building Inspection Division.

The approval of this plan and specification SHALL NOT be held to permit or approve the violation of any City Ordinance or State Law.

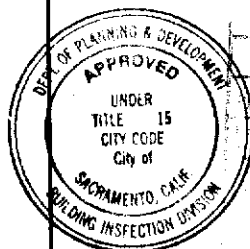

SCALE: 1"=20'

4725 SQUARE FEET

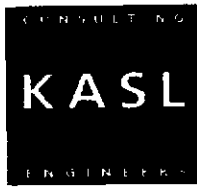
 <p>CIVIL - WATER RESOURCES - SURVEYING</p>	<p>PLOT PLAN FOR LOT 21</p>	<p>SCALE: 1"=20'</p>
	<p>JACINTO VILLAGE UNIT 1</p>	<p>DATE: 12-29-00</p>
	<p>A.P.N.</p>	<p>REVISED:</p>
	<p>ADDRESS:</p>	<p>DRAWN BY: PWG</p>
<p>COUNTY: SACRAMENTO</p>	<p>CHK'D. BY: LK</p>	<p>W.O. 0435-02</p>