

CITY OF SACRAMENTO

1231 I Street, Sacramento, CA 95814

Permit No: 0009228

Insp Area: 4

Site Address: 2415 WATERS EDGE WY SAC

Parcel No: 274-0510-030

RIVERWALK UNIT 1 LOT 30

Sub-Type: NSFR

Housing (Y/N): N

CONTRACTOR

MYERS HOMES INC
3300 FITZGERALD RD.
RANCHO CORDOVA CA. 95742

OWNER

ARCHITECT

Nature of Work: NSFR MP2288 8 RMS 1 STORY

CONSTRUCTION LENDING AGENCY: I hereby affirm under penalty of perjury that there is a construction lending agency for the performance of the work for which this permit is issued (Sec. 3097, Civ. C)

Lender's Name _____ Lender's Address _____

LICENSED CONTRACTORS DECLARATION: I hereby affirm under penalty of perjury that I am licensed under provisions of Chapter 9 (commencing with section 7000) of Division 3 of the Business and Professions Code and my license is in full force and effect.

License Class B License Number 74417 Date 8-11-00 Contractor Signature [Signature]

OWNER-BUILDER DECLARATION: I hereby affirm under penalty of perjury that I am exempt from the contractors License Law for the following reason (Sec. 7031.5, Business and Professions Code; any city or county which requires a permit to construct, alter, improve, demolish, or repair any structure, prior to its issuance, also requires the applicant for such permit to file a signed statement that he or she is licensed pursuant to the provisions of the Contractors License Law (Chapter 9 (commencing with Section 7000) of Division 8 of the Business and Professions Code) or that he or she is exempt therefrom and the basis for the alleged exemption. Any violation of Section 7031.5 by any applicant for a permit subjects the applicant to a civil penalty of not more than five hundred dollars (\$500.00):

I, as a owner of the property, or my employees with wages as their sole compensation, will do the work, and the structure is not intended or offered for sale (Sec. 7044, Business and Professional Code: The Contractors License Law does not apply to an owner of property who builds or improves thereon, and who does such work himself or herself or through his/her own employees, provided that such improvements are not intended or offered for sale. If, however, the building or improvement is sold within one year of completion, the owner-builder will have the burden of proving that he/she did not build or improve for the purpose of sale.)

I, as owner of the property, am exclusively contracting with licensed contractors to construct the project (Sec. 7044, Business and Professions Code: The Contractors License Law does not apply to an owner of property who builds or improves thereon, and who contracts for such projects with a contractor(s) licensed pursuant to the Contractors License Law).

I am exempt under Sec. _____ B & PC for this reason: _____

Date 8-11-00 Owner Signature [Signature]

IN ISSUING THIS BUILDING PERMIT, the applicant represents, and the city relies on the representation of the applicant, that the applicant verified all measurements and locations shown on the application or accompanying drawings and that the improvement to be constructed does not violate any law or private agreement relating to permissible or prohibited locations for such improvements. This building permit does not authorize any illegal location of any improvement or the violation of any private agreement relating to location of improvements.

I certify that I have read this application and state that all information is correct. I agree to comply with all city and county ordinances and state laws relating to building construction and hereby authorize representative(s) of this city to enter upon the abovementioned property for inspection purposes.

Date 8-11-00 Applicant/Agent Signature [Signature]

WORKER'S COMPENSATION DECLARATION: I hereby affirm under penalty of perjury one of the following declarations:

I have and will maintain a certificate of consent to self-insure for workers' compensation as provided for by Section 3700 of the Labor Code, for the performance of work for which the permit is issued.

I have and will maintain workers' compensation insurance, as required by Section 3700 of the Labor Code, for the performance of the work for which this permit is issued. My workers' compensation insurance carrier and policy number are:

Carrier RELIANCE NAT INS CO Policy Number NWAO154613-01 Exp Date 04/01/2001

(This section need not be completed if the permit is for \$100 or less) I certify that in the performance of the work for which this permit is issued, I shall not employ any person in any manner so as to become subject to the workers' compensation laws of California and agree that if I should become subject to the workers' compensation provisions of Section 3700 of the Labor Code, I shall comply with those provisions.

Date 8-11-00 Applicant Signature [Signature]

WARNING: FAILURE TO SECURE WORKER'S COMPENSATION COVERAGE IS UNLAWFUL AND SHALL SUBJECT AN EMPLOYER TO CRIMINAL PENALTIES AND CIVIL FINES UP TO ONE HUNDRED THOUSAND DOLLARS (\$100,000) IN ADDITION TO THE COST OF COMPENSATION, DAMAGES AS PROVIDED FOR IN SECTION 3706 OF THE LABOR CODE, INTEREST AND ATTORNEY'S FEE.

THIS PERMIT SHALL EXPIRE BY LIMITATION IF WORK IS NOT COMMENCED WITHIN 180 DAYS.

LOT 30 4

RESIDENTIAL BUILDING PERMIT APPLICATION

- New Construction Addition Remodels Other

Project Address: 2415 WATERS EDGE WAY Assessor Parcel # 274-0510-030
SACRAMENTO CA 95833

OWNER INFORMATION:

Legal Property Owner: MYERS HOMES OF CALIFORNIA, LLC Phone # 916-851-0530
 Owner Address: 3300 FITZGERALD RD. CITY RANCHO CORDOVA State CA Zip 95742

CONTRACTOR INFORMATION:

Contractor: MYERS HOMES, INC. Lic. # 744473 Phone # 916-851-0530 Fax # 916-851-0535

PROJECT INFORMATION:

Land Use Zone R-1A PUD Occupancy Group R-3 Construction Type V.N Fed. Code 1A

No. of stories: 1 No. of rooms: 12 Street width: 50 FT

1st Floor Area 2288 2nd Floor Area N/A Basement N/A Roof Material TILE

AREA IN SQUARE FOOT OF:	EXISTING	NEW
Dwelling/Living	_____	<u>2288</u>
Garage/Storage	_____	<u>576</u>
Decks/Balconies	_____	<u>77 COVERED FRONT PORCH</u>
Carports	_____	_____

SCOPE OF WORK: NEW CONSTRUCTION OF SINGLE FAMILY RESIDENCE; RIVERWALK SERIES II, PLAN 4 / 2288 III IN MASTER PLAN COMMUNITY P99-075

P99-005 AMENDED

FOR OFFICE USE ONLY:

- | | | |
|---|---|---|
| <input type="checkbox"/> Information above complete | <input type="checkbox"/> AR Flood Waiver required | <input type="checkbox"/> Planning Approval |
| <input type="checkbox"/> Violation files checked | <input type="checkbox"/> Flood Elevation Certificate Required | <input type="checkbox"/> Design Review Approval |
| <input type="checkbox"/> Standard setbacks | <input type="checkbox"/> Water Development Infill Area | <input type="checkbox"/> Special Fee Districts Apply: _____ |
| <input type="checkbox"/> County Sewer | | |

NEW STRUCTURES & ADDITIONS

THE FOLLOWING MUST BE PROVIDED IN ORDER TO SUBMIT FOR PLAN REVIEW

- PLOT 8.5' x 11' 5" DRAINAGE INFO
- 2 COMPLETE PLANS, LEGIBLE & DRAWN TO SCALE *Plans to include: site plan, floor plan, elevations, roof/ceiling plan, foundation and structural framing details, and structural calculations for non-conforming structures.*
 - 3 SETS IF PROJECT IS IN A DESIGN REVIEW AREA
 - Title 24 Energy Compliance documentation
 - 11" x 17" copy of floor plan for County Assessor
 - Grading and Erosion Control Questionnaire
 - Plan Review Fees

Date: _____

Received by: (staff) _____

ACTIVITY/PERMIT # _____

OMEGA PRODUCTS CORP.
CLAIMS MAIL LABELS FOR STAMP OFFICE

JOB ORDER:

LEAD Report (424)

LOT 30
2915 WATERS EDGE WAY

Date of Job Completion 12-14-00

PLUMBING CONTRACTOR:

Name: Special Plumbing

Address: Box 288, San Jose, CA 95147

Telephone No: (415) 245-7887

Contractor Number of Stamped Well System 2130

This is to certify that the exterior opening shown on the building exterior as the above address has been installed in accordance with the evaluation report attached above and the manufacturer's instructions.

3/16/01

[Signature]
PLUMBING CONTRACTOR

THIS INSTALLATION CARD MUST BE PRESENTED TO THE BUILDING DEPARTMENT AFTER COMPLETION OF WORK AND BEFORE FINAL INSPECTION.

CERTIFICATION OF INSULATION

PART I GENERAL

PART II AREAS INSULATED

PART III SIGNATURES

REMARKS

ADDRESS OR TRACT

SACRAMENTO INSULATION CONTRACTORS

MEYERS

30

- P.O. BOX 854, WEST SACRAMENTO, CA 95691 LIC #202026
- 1309 MELODY ROAD, MARYSVILLE, CA 95901 LIC. #202026
- P.O. BOX 9651, FRESNO, CA 93793-9651 LIC. #202026
- P.O. BOX 1631, RENO, NV 89505 LIC. #10675
- 3326 A PONDEROSA WAY, LAS VEGAS, NV 89118 LIC. #10675

DATE INSULATION COMPLETED

RIVER WALK

WALLS

CEILING

FLOORS

(SQUARE FEET)

(SQUARE FEET)

(SQUARE FEET)

TYPE OF INSULATION

TYPE OF INSULATION

TYPE OF INSULATION

MATERIAL

FIBERGLASS

MATERIAL

FIBERGLASS

MATERIAL

FIBERGLASS

FORM

BATTS

FORM

BATTS & BLOW

FORM

BATTS

MANUFACTURER'S PRODUCT ID

MANUFACTURER'S PRODUCT ID

MANUFACTURER'S PRODUCT ID

MANUFACTURER

MANUFACTURER

MANUFACTURER

OCF

OCF

OCF

R - VALUE
INSTALLED

APPLIED
THICKNESS

R - VALUE
INSTALLED

APPLIED
THICKNESS

MIN. INSTALLED
WEIGHT PER
SQUARE FOOT

R - VALUE
INSTALLED

APPLIED
THICKNESS

13

3 5/8"

30
30

9"
12"

KNEE WALLS IF R-VALUE IS OTHER THAN WALLS ABOVE

MATERIAL

FIBERGLASS

FORM

BATTS

R-VALUE

MANUFACTURER

OCF

AIR INFILTRATION SEALANT

MATERIAL

FOAM

MANUFACTURER

W R GRACE

THIS IS TO CERTIFY THAT INSULATION AND/OR SEALANT HAS BEEN INSTALLED IN CONFORMANCE WITH APPLICABLE CODES, MATERIAL STANDARDS AND REGULATIONS.

SIGNATURE - INSULATION CONTRACTOR

Bell Hirschgo

TITLE

MANAGER

DATE

12-7-00

SIGNATURE - GENERAL CONTRACTOR

TITLE

DATE

REMARKS

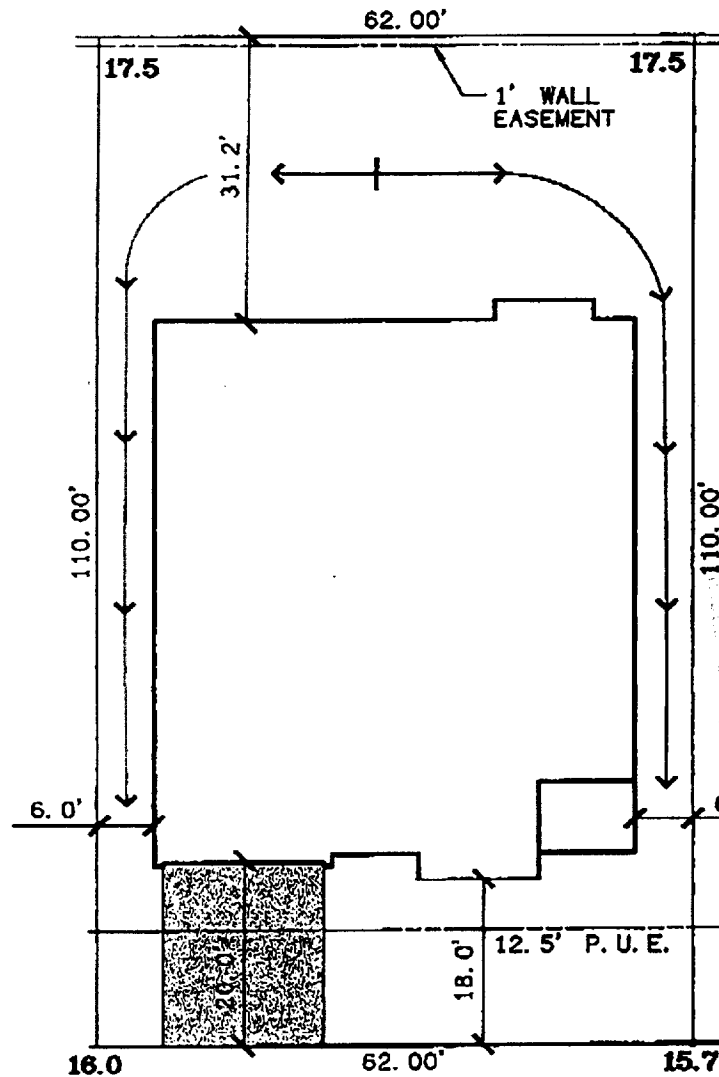

All operations must be in accordance with the City of Sacramento Ordinance of State Law. No work shall be done without the approval of this plan and specification. No work shall be done without the approval of the City of Sacramento. No work shall be done without the approval of the City of Sacramento.

WATERS EDGE WAY



DATE: 8-7-00

A.P.N.:

ADDRESS: WATERS EDGE WAY

LOT AREA: 6,820 SF
LOT COVERAGE: 42%

The Splink Corporation

2590 VENTURE OAKS WAY
SACRAMENTO, CA. 95833

PH:(916)925-5550 FAX:(916)921-9274

**RIVERWALK
UNIT NO. 1**

**LOT 30
PLAN 2288A**

RIVERWALK

CITY OF SACRAMENTO, CA.
CLIENT: MYERS HOMES
JOB NO.: 1456-001