

CITY OF SACRAMENTO

1231 I Street, Sacramento, CA 95814

Permit No: 0014814

Insp Area: 4

Site Address: 1730 MONTARA AV SAC

Parcel No: 225-1110-051

NORTHPT PK 12 LOT 51

Sub-Type: NSFR

Housing (Y/N): N

CONTRACTOR

L'ENNAR RENAISSANCE INC.
2240 DOUGLAS BL.
ROSEVILLE CA. 95661

OWNER

ARCHITECT

Nature of Work: NSFR MP653B 10 RMS 2 STORY

CONSTRUCTION LENDING AGENCY: I hereby affirm under penalty of perjury that there is a construction lending agency for the performance of the work for which this permit is issued (Sec. 3097, Civ. C.)

Lender's Name

Lender's Address

LICENSED CONTRACTORS DECLARATION: I hereby affirm under penalty of perjury that I am licensed under provisions of Chapter 9 (commencing with section 7000) of Division 3 of the Business and Professions Code and my license is in full force and effect.

License Class B License Number 732348 Date 1/30/01 Contractor Jennifer Price

OWNER-BUILDER DECLARATION: I hereby affirm under penalty of perjury that I am exempt from the contractors License Law for the following reason (Sec. 7031.5, Business and Professions Code, any city or county which requires a permit to construct, alter, improve, demolish, or repair any structure, prior to its issuance, also requires the applicant for such permit to file a signed statement that he or she is licensed pursuant to the provisions of the Contractors License Law (Chapter 9 (commencing with Section 7000) of Division 8 of the Business and Professions Code) or that he or she is exempt therefrom and the basis for the alleged exemption. Any violation of Section 7031.5 by any applicant for a permit subjects the applicant to a civil penalty of not more than five hundred dollars (\$500.00).

I, as a owner of the property, or my employees with wages as their sole compensation, will do the work, and the structure is not intended or offered for sale (Sec. 7044, Business and Professional Code: The Contractors License Law does not apply to an owner of property who builds or improves thereon, and who does such work himself or herself or through his/her own employees, provided that such improvements are not intended or offered for sale. If, however, the building or improvement is sold within one year of completion, the owner-builder will have the burden of proving that he/she did not build or improve for the purpose of sale.)

I, as owner of the property, am exclusively contracting with licensed contractors to construct the project (Sec. 7044, Business and Professions Code: The Contractors License Law does not apply to an owner of property who builds or improves thereon, and who contracts for such projects with a contractor(s) licensed pursuant to the Contractors License Law).

I am exempt under Sec. _____ B & PC for this reason: _____

Date _____ Owner Signature _____

IN ISSUING THIS BUILDING PERMIT, the applicant represents, and the city relies on the representation of the applicant, that the applicant verified all measurements and locations shown on the application or accompanying drawings and that the improvement to be constructed does not violate any law or private agreement relating to permissible or prohibited locations for such improvements. This building permit does not authorize any illegal location of any improvement or the violation of any private agreement relating to location of improvements.

I certify that I have read this application and state that all information is correct. I agree to comply with all city and county ordinances and state laws relating to building construction and hereby authorize representative(s) of this city to enter upon the abovementioned property for inspection purposes.

Date 1/30/01 Applicant/Agent Signature Jennifer Price

WORKER'S COMPENSATION DECLARATION: I hereby affirm under penalty of perjury one of the following declarations:

I have and will maintain a certificate of consent to self-insure for workers' compensation as provided for by Section 3700 of the Labor Code, for the performance of work for which the permit is issued.

I have and will maintain workers' compensation insurance, as required by Section 3700 of the Labor Code, for the performance of the work for which this permit is issued. My workers' compensation insurance carrier and policy number are:

Carrier TRANSCONTINENTAL INSURANCE CO. Policy Number WC166792277 Exp Date 06/01/2001

(This section need not be completed if the permit is for \$100 or less) I agree to comply with the performance of the work for which this permit is issued, I shall not employ any person in any manner so as to become subject to the workers' compensation laws of California, and agree that if I should become subject to the workers' compensation provisions of Section 3700 of the Labor Code, I shall forthwith comply with those provisions.

Date 1/30/01 Applicant Signature Jennifer Price

WARNING: FAILURE TO SECURE WORKER'S COMPENSATION COVERAGE IS UNLAWFUL AND SHALL SUBJECT AN EMPLOYER TO CRIMINAL PENALTIES AND CIVIL FINES UP TO ONE HUNDRED THOUSAND DOLLARS (\$100,000) IN ADDITION TO THE COST OF COMPENSATION, DAMAGES AS PROVIDED FOR IN SECTION 3706 OF THE LABOR CODE, INTEREST AND ATTORNEY'S FEE.

THIS PERMIT SHALL EXPIRE BY LIMITATION IF WORK IS NOT COMMENCED WITHIN 180 DAYS

#51

RESIDENTIAL BUILDING PERMIT APPLICATION

653X3
653B

New Construction

Addition

Remodels

Other

Project Address: 1730 Montara Ave.

Assessor Parcel # 225-111-051-000

OWNER INFORMATION:

Legal Property Owner: LENNAR RENAISSANCE, INC. Phone # (916) 773-4083
Owner Address: 2240 DOUGLAS BLVD. #250 City ROSEVILLE State CA Zip 95661

CONTRACTOR INFORMATION:

Contractor: SAME AS ABOVE Lic. # 732348 B Phone # 773-4083 Fax# 773-4086

PROJECT INFORMATION:

Land Use Zone R/A Occupancy Group R3 Construction Type VN Fed Code 1A
No. of stories: 2 No. of rooms: 10 Street width: 40
1st Floor Area 2182 2nd Floor Area 988 Basement _____ Roof Material _____

AREA IN SQUARE FOOT OF:

EXISTING

NEW

Dwelling/Living	_____	<u>3170</u>
Garage/Storage	_____	<u>489</u>
Decks/Balconies	_____	<u>153</u>
Carports	_____	_____

SCOPE OF WORK: MP 3170/ 653X3

FOR OFFICE USE ONLY

- | | | |
|---|---|--|
| <input type="checkbox"/> Information above complete | <input type="checkbox"/> AR Flood Waiver required | <input type="checkbox"/> Planning Approval |
| <input type="checkbox"/> Violation files checked | <input type="checkbox"/> Flood Elevation Certificate Required | <input type="checkbox"/> Design Review Approval |
| <input type="checkbox"/> Standard setbacks | <input type="checkbox"/> Water Development Infill Area | <input type="checkbox"/> Special Fee Districts Apply : _____ |
| <input type="checkbox"/> County Sewer | | |

NEW STRUCTURES & ADDITIONS

❖ THE FOLLOWING MUST BE PROVIDED IN ORDER TO SUBMIT FOR PLAN REVIEW

- | | |
|---|---|
| <input type="checkbox"/> 2 COMPLETE PLANS, LEGIBLE & DRAWN TO SCALE | ❖ Plans to include: site plan, floor plan, elevations, roof/ceiling plan, foundation and structural framing details, and structural calculations for non-conforming structures. |
| <input type="checkbox"/> 3 SETS IF PROJECT IS IN A DESIGN REVIEW AREA | |
| <input type="checkbox"/> Title 24 Energy Compliance documentation | <input type="checkbox"/> 11" x 17" copy of floor plan for County Assessor |
| <input type="checkbox"/> Grading and Erosion Control Questionnaire | <input type="checkbox"/> Plan Review Fees |

Date: _____

Received by: (staff) _____

ACTIVITY/PERMIT # _____

ENGEL INSULATION, INC.

CALIFORNIA CONTRACTOR'S LICENSE #745646

460 Roseville Road • Roseville, CA 95678

(916) 786-2088 / (916) 969-6191

THIS IS TO CERTIFY THAT INSULATION HAS BEEN INSTALLED IN CONFORMANCE WITH CURRENT ENERGY REGULATIONS, CALIFORNIA ADMINISTRATIVE CODE, TITLE 24, STATE OF CALIFORNIA, IN THE BUILDING LOCATED AT:

TRACT SOMERSET LOT 51/653X3
CITY SACRAMENTO
STREET _____

EXTERIOR WALLS: CT 2x4 3 1/2 13
CT 2x6 6 1/4 19
MANUFACTURER _____ THICKNESS _____ R-VALUE _____

CEILING AREA: BATTIS
MANUFACTURER _____ THICKNESS 12 R-VALUE 38
CT _____

CEILINGS: BLOWN IN
MANUFACTURER INUL-SAFE THICKNESS 14 3/4 R-VALUE 38
1967 NUMBER OF BAGS USED 45

SQUARE FOOTAGE
GARAGE 1/4
FLOOR AREA 1/4
MANUFACTURER _____ THICKNESS 6 1/4 R-VALUE 19
CT _____

EXTERIOR KNEEWALL:
MANUFACTURER _____ THICKNESS _____ R-VALUE _____
HWC _____

~~INTERIOR KNEEWALL:~~
MANUFACTURER _____ THICKNESS 6 1/4 R-VALUE 19
CT _____

APPLIED CAULK & SEALANT TO ALL EXTERIOR OPENINGS & PENETRATIONS
YES NO _____

GENERAL CONTRACTOR _____
CALIFORNIA CONTRACTORS
LICENSE # _____ DATE _____

SIGNATURE _____ TITLE _____
Ree Adams W. Heide Rec. Book Keeper 9/7/01
INSULATION CONT. SIGNATURE _____ DATE _____

INSTALLATION CARD

Job Address:

1730 Montara Ave
Sacramento Ca.
Lot 51

Glaze System Technology (GST) NOTE

Name of Glaze Manufacturer: GST GYTE CORP.

9-14-01
Date of Installation

Glaze Contractor:

Name: Kenyon Plastering
Address: Sacramento Ca.

Telephone Number:

Approved Contractor Number as listed by the Glaze Manufacturer:

This is to certify that the glaze system on the building exterior at the above address has been installed in accordance with the evaluation report specified above and the manufacturer's instructions.

Nester Perez 9-21-01
Signature of authorized representative of Glaze Contractor Date

FIGURE 3

DECLARATION

Project Address: _____ Date: _____

The field batching and mixing of all components and of the exterior wall coating at the address noted above has been continuously inspected before, during and after installation of the particular coating. The field batching and mixing have been found to comply with current evaluation report 812-0007 and approved plans.

Inspector Signature: _____
Inspector Name (Print): _____
Employer Name: _____
Employer Address: _____
Telephone Number: _____

This is to certify that the above noted inspector, approved by GST GYTE CORP., was authorized to inspect the project as noted and was found to properly discharge his duties.

Signature of Signature of Owner of Project Holder

Signer's Name (Print): _____ Date: _____

* Signature required only if inspector is not an employee of evaluation report holder.

FIGURE 4

50
PAD=14.0

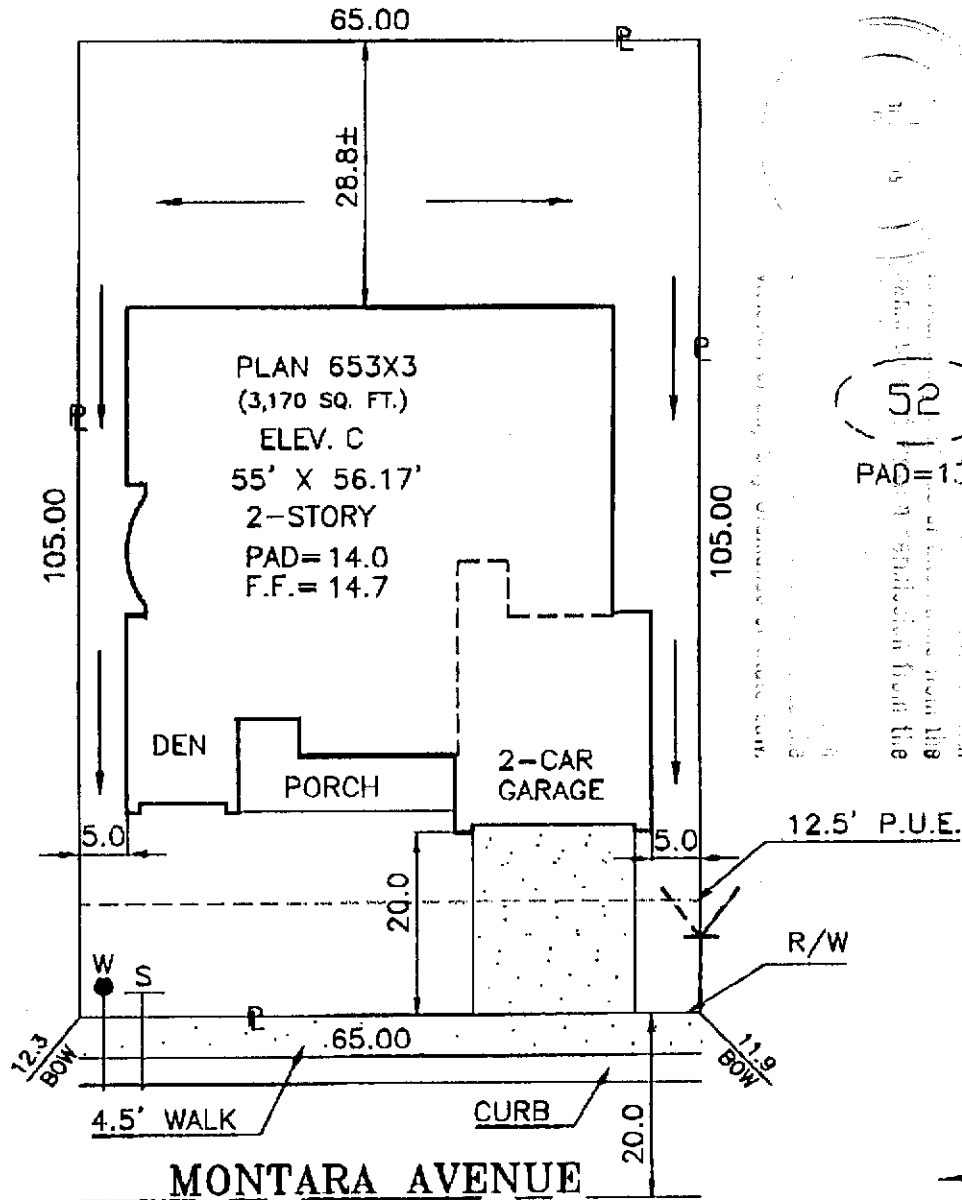

52
PAD=13.6

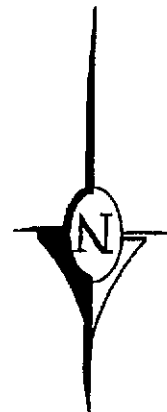

DIMENSIONS SHOWN ARE APPROXIMATE EXCEPT FOR MINIMUMS REQUIRED BY ORDINANCE. THIS PLOT DOES NOT REFLECT AS BUILT CONDITIONS AND MAY VARY FROM THIS PLAN.

<h1>RENAISSANCE</h1> <h2>HOMES</h2> <p>2240 DOUGLAS BLVD. SUITE 250, ROSEVILLE, CALIFORNIA 95661 PHONE (916) 773-4063 FAX (916) 773-4066</p>	SOMERSET		PLOT PLAN
	NORTHPOINTE PARK UNIT 12 CITY OF SACRAMENTO SACTO. COUNTY CALIFORNIA		NOTES:
ADDRESS: 1730 MONTARA AVENUE	LOT COV: 39.4 %	APN:	LOT 51
PLAN NO.:653X3-C	LOT SQ. FT.: 6,825	REAR YARD COVERAGE: %	
DRAWN BY: R.P.	APPROVED BY:	DATE: 12/5/00 SCALE: 1"=20'	