

CITY OF SACRAMENTO
1231 I Street, Sacramento, CA 95814

Permit No: 0000299
Insp Area: 1

Site Address: 1719 24TH ST SAC
Parcel No 007-0332-011

Sub-Type: ACOM
Housing (Y/N): N

CONTRACTOR
MARK H. ENGINEERING
5104 FLORIN PERKINS RD
SACRAMENTO CA 95826

OWNER
4TH STREET PARTNER
550 RODANTE WY
SACRAMENTO CA 95864

ARCHITECT

Nature of Work: REPAIR BROKEN TRUSS/BACK SPAN

CONSTRUCTION LENDING AGENCY: I hereby affirm under penalty of perjury that there is a construction lending agency for the performance of the work for which this permit is issued (Sec. 3097, Civ. C).

Agency Name _____ Lender's Address _____

LICENSED CONTRACTORS DECLARATION: I hereby affirm under penalty of perjury that I am licensed under provisions of Chapter 9 (commencing with section 7000) of Division 3 of the Business and Professions Code and my license is in full force and effect.

X License Class A/B License Number 574134 Date 1/12/00 Contractor Signature [Signature]

OWNER-BUILDER DECLARATION: I hereby affirm under penalty of perjury that I am exempt from the contractors License Law for the following reason: (Sec. 7031.5, Business and Professions Code) any city or county which requires a permit to construct, alter, improve, demolish, or repair any structure prior to its issuance, also requires the applicant for such permit to file a signed statement that he or she is licensed pursuant to the provisions of the Contractors License Law (Chapter 9 (commencing with Section 7000) of Division 8 of the Business and Professions Code) or that he or she is exempt therefrom and the basis for the alleged exemption. Any violation of Section 7031.5 by any applicant for a permit subjects the applicant to a civil penalty of not more than five hundred dollars (\$500.00).

I, as owner of the property, or my employees with wages as their sole compensation, will do the work, and the structure is not intended or offered for sale. (Sec. 7044, Business and Professions Code) The Contractors License Law does not apply to an owner of property who builds or improves thereon and who does such work himself or herself or through his/her own employees, provided that such improvements are not intended or offered for sale. If, however, the building or improvement is sold within one year of completion, the owner-builder will have the burden of proving that he/she did not build or improve for the purpose of sale.)

I, as owner of the property, am exclusively contracting with licensed contractors to construct the project (Sec. 7044, Business and Professions Code). The Contractors License Law does not apply to an owner of property who builds or improves thereon, and who contracts for such projects with a contractor(s) licensed pursuant to the Contractors License Law.

I am exempt under Sec. _____ B & PC for this reason: _____
Date _____ Owner Signature _____

IN ISSUING THIS BUILDING PERMIT, the applicant represents, and the city relies on the representation of the applicant, that the applicant verified all measurements and locations shown on the application or accompanying drawings and that the improvement to be constructed does not violate any law or private agreement relating to permissible or prohibited locations for such improvements. This building permit does not authorize any illegal location of an improvement or the violation of any private agreement relating to location of improvements.

I certify that I have read this application and state that all information is correct. I agree to comply with all city and county ordinances and state laws relating to building construction and hereby authorize representative(s) of this city to enter upon the above mentioned property for inspection purposes.

X Date 1/12/00 Applicant Agent Signature [Signature]

WORKER'S COMPENSATION DECLARATION: I hereby affirm under penalty of perjury one of the following declarations:

I have and will maintain a certificate of consent to self-insure for workers' compensation as provided for by Section 3700 of the Labor Code, for the performance of work for which the permit is issued.

I have and will maintain workers' compensation insurance, as required by Section 3700 of the Labor Code, for the performance of the work for which this permit is issued. My workers' compensation insurance carrier and policy number are:

Carrier: STATE FUND Policy Number 692-98 UNIT 0002087 Exp Date 10/01/2000

(This section need not be completed if the permit is for \$100 or less) I certify that in the performance of the work for which this permit is issued, I shall not employ any person in any manner so as to become subject to the workers' compensation laws of California and agree that if I should become subject to the workers' compensation provisions of Section 3700 of the Labor Code, I shall forthwith comply with those provisions.

X Date 1/12/00 Applicant Signature [Signature]

WARNING - FAILURE TO SECURE WORKER'S COMPENSATION COVERAGE IS UNLAWFUL AND SHALL SUBJECT AN EMPLOYER TO CRIMINAL PENALTIES AND CIVIL FINES UP TO ONE HUNDRED THOUSAND DOLLARS (\$100,000) IN ADDITION TO THE COST OF COMPENSATION, DAMAGES AS PROVIDED FOR IN SECTION 3706 OF THE LABOR CODE, INTEREST AND ATTORNEY'S FEE.

THIS PERMIT SHALL EXPIRE BY LIMITATION IF WORK IS NOT COMMENCED WITHIN 180 DAYS.

**CITY OF SACRAMENTO
APPLICATION FOR COMMERCIAL BUILDING PERMIT**

DEVELOPMENT SERVICES DIVISION
PERMIT SERVICES SECTION
1231 I Street, Rm. 200
Sacramento, CA 95814 (916) 264-7619 FAX 264-7046

ACTIVITY # 0000299 Insp. Area _____

Applicant MUST complete ALL Unshaded areas

ADDRESS 719 24th St SACRAMENTO Suite _____
PARCEL # _____

CONTACT Name <u>RON NEESE</u> Address <u>5101 FLORIN PERKINS, SACRAMENTO</u> Phone <u>916-9080</u> FAX <u>386-0363</u> E-mail <u>MARK.II@M3.COM</u>		LICENSED CONTRACTOR Lic No. # _____ Name <u>MARK III ENGINEERING</u> Address <u>5101 FLORIN PERKINS, SACRAMENTO</u> Phone <u>916-381-9080</u> FAX <u>916-586-0363</u> E-mail <u>MARK.II@M3.COM</u>	
ARCHITECT/ENGINEER Name <u>GARY PHILLIPS</u> Address <u>1304 PLACER LANE SUITE 6</u> Phone <u>916-3871</u> FAX _____ E-mail _____		OWNER Name _____ Address _____ Phone _____ FAX _____ E-mail _____	

→ Will permittee have any employees on the jobsite? No Yes → INSURANCE CO: STATE COMP. INS. FUND
 → WORKER'S COMPENSATION POLICY # 892-99 UNIT 0003087 EXPIRATION DATE: 10/01/00

NATURE OF WORK IN DETAIL: REPAIR BROKEN TRUSS

OCCUPANT/TENANT: CALIF. CONSERVATION CORPS VALUATION: \$ 2000.00

FLOOD STATUS:		S.C.A.T.								
JOB DESCRIPTION		BLDG	SHELL	APT	TI()	REM()	SW	FIRE	ADD	OTH
INSPECTION DISCIPLINES		BLDG	MECH	PLUMB	ELEC		SITE	FIRE		
# Stories	1st flr Area	Total Area	Use Zone	Occp Group	Const type	Fire Req. Y / N		Fed Code	Vio. File	
						SPR	ALARM		[H]	[Quad]
<u>B</u>	<u>L</u>	<u>P</u>	<u>M</u>	<u>E</u>	<u>F</u>	<u>S</u>		<u>D</u>	<u>PW</u>	<u>UTIL</u>
<u>1304</u>										

COMMENTS: _____

REGIONAL SANITATION FEES? Yes No HEALTH DEPARTMENT? Yes No
 WATER FLOW TEST FOR NEW BUILDINGS OR ADDITIONS? Provided Faxed

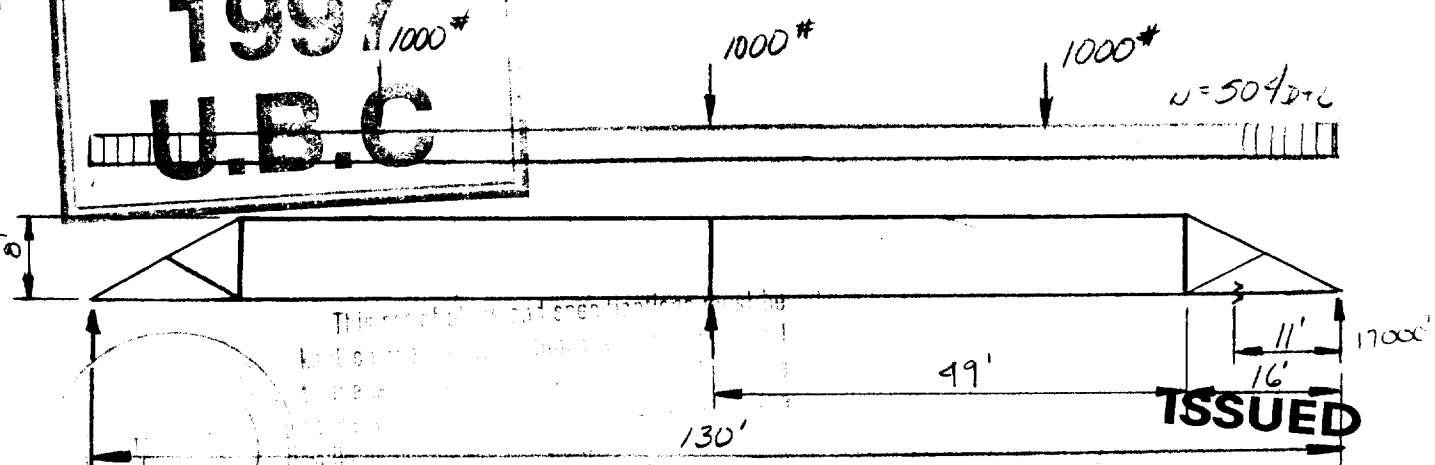
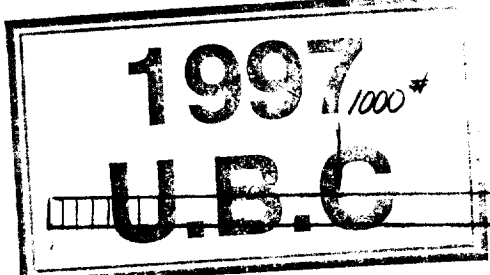

DEAD LOADS:

CAP. SHT.	4.4
2x12s @ 24"oc	2.2
1/2" PLYWOOD	1.5
SUSP. CEILING	1.0
INSULATION	1.0
MISC.	1.9
	<u>12.0 D</u>

JAN 12 2000

Sacramento Building Division

Sam Phillips
 3/31/02

for pages 1 thru 3

TENSION @ SPLICE:

$$T = \frac{M}{d} = \frac{17000 \times 11' - 504 \times (11)^2 / 2}{5'} = 31,300 \# \text{ (SEE BELOW) } \#$$

NUMBER OF BOLTS REQ.:

TRY 3/4" ϕ BOLT $C_D = 1.25$ $C_g = .61$

$$\frac{31300}{3170 \times 1.25} = 7.9 \div .61 = 12.95 \therefore \underline{\underline{\text{USE 13 - } 3/4" \phi \text{ M.B}}}$$

* NET RXN = $17000 \# - 4' \times 504 \# = 14984 \#$; $TAN \theta = .5$

\therefore TENSION = $2 \times 14984 \# = \underline{\underline{29968 \#}}$

John Tang

CHECK THICKNESS OF STEEL

$$31300 = [t(4) - t(1)] \cdot 5 (58000)$$

$$t = .36'' \div 2 = .18''$$

USE 3/8" x 4" x 8'-0" LONG STEEL PL (A36)

$$\text{BOLT SPACING REQ.} = 4 \times 3/4'' = 3''$$

$$\text{END DIST REQ.} = 7 \times 3/4'' = 5 1/4''$$

TENSION @ MIDSPAN BETWEEN SUPPORTS: (MAX T)

$$T = \frac{M}{s} = \frac{504(65')^2}{8} + \frac{1000(65)}{4} = 35300 \#$$

$$f_t = \frac{35300}{30'' \times 1.25} = 941 \text{ PSI @ FULL CROSS SECTION}$$

$$\frac{941}{825} = 1.14 = 14\% \text{ OVERSTRESS}$$

AT POINT OF REPAIR

$$f_{t \text{ GROSS}} = 29968 / 6 \times 5 = 998.9 \text{ PSI VS } 1.25 \times 825 = 1094 \text{ PSI}$$

\(\therefore\) GROSS MEMBER IS OK

CONSIDER NET SECTION

$$f_t = 29968 / 5(6 - 13/16) = 1155.4 \text{ PSI} > 1094 \text{ PSI}$$

$$\approx 5.6\% \text{ OVERSTRESS - OK}$$

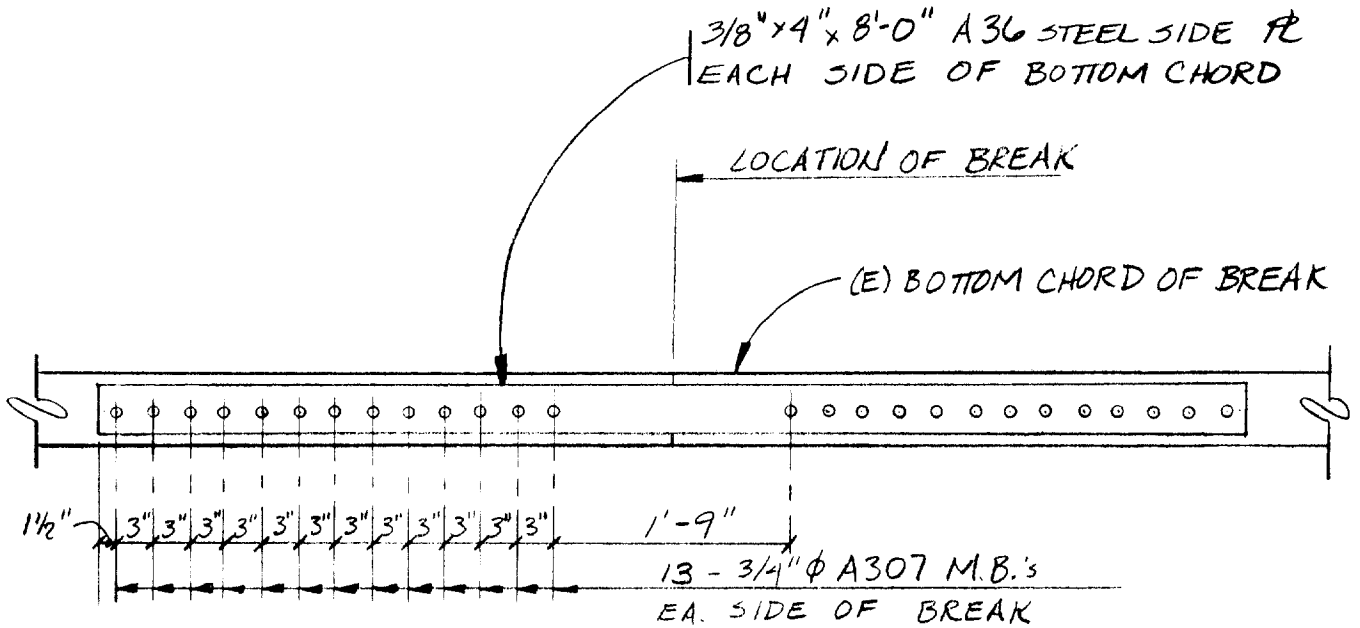

* PLEASE READ *

THE ABOVE REPAIR AND DESIGN CALCULATIONS ARE BASED ON THE FOLLOWING ASSUMPTIONS: THE BOTTOM CHORD IS 5" x 6" DEEP, THE TRUSS IS 8'-0" DEEP, AND THE WOOD GRADE IS D.F. No. 1. BASED ON THIS, THE BOTTOM CHORD IS OVERSTRESSED. THE AMOUNT OF OVERSTRESS VARIES BUT HAS BEEN FOUND TO BE AS MUCH AS 14%. AREAS WHERE BOLT HOLES EXIST (BECAUSE OF SPLICES OR WEB CONNECTIONS) MAY BE OVERSTRESSED WELL IN EXCESS OF 14% DEPENDING ON THE LOCATION OF THE SPLICES (WHICH IS CURRENTLY UNKNOWN). THE SPLICE CONNECTION SHOWN ABOVE IS REPRESENTATIVE OF OTHER SPLICES IN THE BOTTOM CHORD. AT THIS POINT (WHICH IS KNOWN - APPROX. 11' FROM THE NORTH WALL) THE WOOD IS NOT OVERSTRESSED. THE FAILURE WAS LIKELY CAUSED BY A KNOT AT THIS LOCATION. BOLTING THE MEMBER WHICH IS CONSISTANT WITH OTHER CONNECTIONS ON THIS TRUSS COMPUTES TO 5.6% OVERSTRESS ON NET AREA. WHICH IS ACCEPTABLE.