

CITY OF SACRAMENTO

Permit No: 9905346

1231 I Street, Sacramento, CA 95814

Insp Area: 4

Site Address: 3806 STEMMLER DR SAC

Sub-Type: NSFR

Parcel No: 225-1180-057

GATEWAY WEST LOT 57

Housing (Y/N): N

CONTRACTOR

OWNER

ARCHITECT

KAUFMAN AND BROAD
3300 DOUGLAS BLVD. STE 330
ROSEVILLE CA. 95661

Nature of Work: 2 STORY 10/11 RM SFR

CONSTRUCTION LENDING AGENCY : I hereby affirm under penalty of perjury that there is a construction lending agency for the performance of the work for which this permit is issued (Sec. 3097, Civ. C).

Lender's Name _____ Lender's Address _____

LICENSED CONTRACTORS DECLARATION: I hereby affirm under penalty of perjury that I am licensed under provisions of Chapter 9 (commencing with section 7000) of Division 3 of the Business and Professions Code and my license is in full force and effect.

License Class B License Number 225000000 Date 4/15/99 Contractor Signature [Signature]

OWNER-BUILDER DECLARATION: I hereby affirm under penalty of perjury that I am exempt from the contractors License Law for the following reason (Sec. 7031.5, Business and Professions Code; any city or county which requires a permit to construct, alter, improve, demolish, or repair any structure, prior to its issuance, also requires the applicant for such permit to file a signed statement that he or she is licensed pursuant to the provisions of the Contractors License Law (Chapter 9 (commencing with Section 7000) of Division 8 of the Business and Professions Code) or that he or she is exempt therefrom and the basis for the alleged exemption. Any violation of Section 7031.5 by any applicant for a permit subjects the applicant to a civil penalty of not more than five hundred dollars (\$500.00);

____ I, as a owner of the property, or my employees with wages as their sole compensation, will do the work, and the structure is not intended or offered for sale (Sec. 7044, Business and Professional Code: The Contractors License Law does not apply to an owner of property who builds or improves thereon, and who does such work himself or herself or through his/her own employees, provided that such improvements are not intended or offered for sale. If, however, the building or improvement is sold within one year of completion, the owner-builder will have the burden of proving that he/she did not build or improve for the purpose of sale.)

____ I, as owner of the property, am exclusively contracting with licensed contractors to construct the project (Sec. 7044, Business and Professions Code: The Contractors License Law does not apply to an owner of property who builds or improves thereon, and who contracts for such projects with a contractor(s) licensed pursuant to the Contractors License Law).

____ I am exempt under Sec. _____ B & PC for this reason: _____

Date _____ Owner Signature _____

IN ISSUING THIS BUILDING PERMIT, the applicant represents, and the city relies on the representation of the applicant, that the applicant verified all measurements and locations shown on the application or accompanying drawings and that the improvement to be constructed does not violate any law or private agreement relating to permissible or prohibited locations for such improvements. This building permit does not authorize any illegal location of any improvement or the violation of any private agreement relating to location of improvements.

I certify that I have read this application and state that all information is correct. I agree to comply with all city and county ordinances and state laws relating to building construction and hereby authorize representative(s) of this city to enter upon the abovementioned property for inspection purposes.

Date 4/15/99 Applicant/Agent Signature [Signature]

WORKER'S COMPENSATION DECLARATION: I hereby affirm under penalty of perjury one of the following declarations:

____ I have and will maintain a certificate of consent to self-insure for workers' compensation as provided for by Section 3700 of the Labor Code, for the performance of work for which the permit is issued.

____ I have and will maintain workers' compensation insurance, as required by Section 3700 of the Labor Code, for the performance of the work for which this permit is issued. My workers' compensation insurance carrier and policy number are:

Carrier CONTINENTAL CAS. CO. Policy Number WC188899094 Exp Date 05/01/2000

____ (This section need not be completed if the permit is for \$100 or less) I certify that in the performance of the work for which this permit is issued, I shall not employ any person in any manner so as to become subject to the workers' compensation laws of California and agree that if I should become subject to the workers' compensation provisions of Section 3700 of the Labor Code, I shall forthwith comply with those provisions.

Date _____ Applicant Signature [Signature]

WARNING: FAILURE TO SECURE WORKER'S COMPENSATION COVERAGE IS UNLAWFUL AND SHALL SUBJECT AN EMPLOYER TO CRIMINAL PENALTIES AND CIVIL FINES UP TO ONE HUNDRED THOUSAND DOLLARS (\$100,000) IN ADDITION TO THE COST OF COMPENSATION, DAMAGES AS PROVIDED FOR IN SECTION 3706 OF THE LABOR CODE, INTEREST AND ATTORNEY'S FEE.

THIS PERMIT SHALL EXPIRE BY LIMITATION IF WORK IS NOT COMMENCED WITHIN 180 DAYS.

WES PAC

INSULATION, INC.

INSULATION
CERTIFICATE

THIS IS TO CERTIFY THAT INSULATION HAS BEEN INSTALLED IN CONFORMANCE WITH CURRENT ENERGY REGULATIONS, CALIFORNIA ADMINISTRATIVE CODE, TITLE 24, STATE OF CALIFORNIA, IN THE BUILDING LOCATED AT:

LOT # _____ TRACT # _____
STREET 3806 Stemmer Dr CITY _____

EXTERIOR WALLS:

MANUFACTURER _____ THICKNESS/TYPE _____ R-VALUE 13

CEILINGS _____ R-VALUE _____

BATTS _____ THICKNESS/TYPE _____ R-VALUE 38

MANUFACTURER _____ THICKNESS/TYPE _____ R-VALUE _____

BLOWN-IN _____ THICKNESS/TYPE _____ R-VALUE 38

MANUFACTURER _____ THICKNESS/TYPE _____ R-VALUE _____

SQUARE FOOTAGE COVERED _____ NUMBER OF BAGS USED _____ R-VALUE _____

FLOORS _____ THICKNESS/TYPE _____ R-VALUE _____

MANUFACTURER _____ THICKNESS/TYPE _____ R-VALUE _____

SLAB ON GRADE _____ THICKNESS/TYPE _____ R-VALUE _____

MANUFACTURER _____ THICKNESS/TYPE _____ R-VALUE _____

WIDTH OF INSULATION _____ INCHES _____ R-VALUE _____

FOUNDATION WALLS _____ THICKNESS/TYPE _____ R-VALUE _____

MANUFACTURER _____ THICKNESS/TYPE _____ R-VALUE _____

GENERAL CONTRACTOR _____

CALIFORNIA CONTRACTORS LICENSE # _____ DATE _____

SIGNATURE _____ TITLE _____

INSULATION CONTRACTOR: WES PAC INSULATION, INC.

4145 JORDAN AVENUE, SUITE 100, FRESNO, CA 93726

#187778

DATE 1/11

SIGNATURE _____ TITLE _____

SEWER IMPACT FEE

PROPERTY ADDRESS		APPLICANT'S NAME	
3806 STEMMER		STEMMER	
CITY - STATE - ZIP		CITY - STATE - ZIP	
SAN FRANCISCO - CA 94118		SAN FRANCISCO - CA 94118	
APPLICANT'S PHONE NUMBER		APPLICANT'S PHONE NUMBER	
415 775 1234		415 775 1234	
APPLICANT'S MAILING ADDRESS		APPLICANT'S MAILING ADDRESS	
1234 MAIN ST		1234 MAIN ST	
SAN FRANCISCO, CA 94118		SAN FRANCISCO, CA 94118	
APPLICANT'S BUSINESS PHONE NUMBER		APPLICANT'S BUSINESS PHONE NUMBER	
415 775 5678		415 775 5678	
APPLICANT'S FAX NUMBER		APPLICANT'S FAX NUMBER	
415 775 9012		415 775 9012	
APPLICANT'S E-MAIL ADDRESS		APPLICANT'S E-MAIL ADDRESS	
STEMMER@EXAMPLE.COM		STEMMER@EXAMPLE.COM	
APPLICANT'S SIGNATURE		APPLICANT'S SIGNATURE	
[Signature]		[Signature]	
DATE		DATE	
01/15/2024		01/15/2024	
APPLICANT'S TITLE		APPLICANT'S TITLE	
OWNER		OWNER	
APPLICANT'S COMPANY NAME		APPLICANT'S COMPANY NAME	
STEMMER & ASSOCIATES		STEMMER & ASSOCIATES	
APPLICANT'S COMPANY ADDRESS		APPLICANT'S COMPANY ADDRESS	
1234 MARKET ST		1234 MARKET ST	
SAN FRANCISCO, CA 94102		SAN FRANCISCO, CA 94102	
APPLICANT'S COMPANY PHONE NUMBER		APPLICANT'S COMPANY PHONE NUMBER	
415 775 3456		415 775 3456	
APPLICANT'S COMPANY FAX NUMBER		APPLICANT'S COMPANY FAX NUMBER	
415 775 7890		415 775 7890	
APPLICANT'S COMPANY E-MAIL ADDRESS		APPLICANT'S COMPANY E-MAIL ADDRESS	
STEMMER@STEMMER.COM		STEMMER@STEMMER.COM	
APPLICANT'S COMPANY WEBSITE		APPLICANT'S COMPANY WEBSITE	
WWW.STEMMER.COM		WWW.STEMMER.COM	
APPLICANT'S COMPANY TYPE		APPLICANT'S COMPANY TYPE	
COMMERCIAL		COMMERCIAL	
APPLICANT'S COMPANY INDUSTRY		APPLICANT'S COMPANY INDUSTRY	
CONSTRUCTION		CONSTRUCTION	
APPLICANT'S COMPANY EMPLOYMENT		APPLICANT'S COMPANY EMPLOYMENT	
29		29	
APPLICANT'S COMPANY REVENUE		APPLICANT'S COMPANY REVENUE	
2385		2385	
APPLICANT'S COMPANY TYPE CODE		APPLICANT'S COMPANY TYPE CODE	
01		01	
APPLICANT'S COMPANY INDUSTRY CODE		APPLICANT'S COMPANY INDUSTRY CODE	
10		10	
APPLICANT'S COMPANY EMPLOYMENT CODE		APPLICANT'S COMPANY EMPLOYMENT CODE	
01		01	
APPLICANT'S COMPANY REVENUE CODE		APPLICANT'S COMPANY REVENUE CODE	
01		01	
APPLICANT'S COMPANY TYPE UNIT		APPLICANT'S COMPANY TYPE UNIT	
1		1	
APPLICANT'S COMPANY INDUSTRY UNIT		APPLICANT'S COMPANY INDUSTRY UNIT	
1		1	
APPLICANT'S COMPANY EMPLOYMENT UNIT		APPLICANT'S COMPANY EMPLOYMENT UNIT	
1		1	
APPLICANT'S COMPANY REVENUE UNIT		APPLICANT'S COMPANY REVENUE UNIT	
1		1	
TOTAL FEE		2914	
APN:		2914	
DESCRIPTION/ SUBDIVISION		LOT:	
3806 STEMMER		1	
PROPERTY ADDRESS		3806 Stemmer	
OWNER		STEMMER	
MAILING ADDRESS		STEMMER	
CITY - STATE - ZIP		PHONE	
SAN FRANCISCO - CA 94118		415 775 1234	
ADDITIONAL FEES MAY BE DUE IF CHANGES IN USE INCREASE SEWER IMPACT.		ADDITIONAL FEES MAY BE DUE IF CHANGES IN USE INCREASE SEWER IMPACT.	
APPLICANT SIGNATURE		APPLICANT SIGNATURE	
[Signature]		[Signature]	
CONSOLIDATED UTILITY BILLING USE ONLY		CONSOLIDATED UTILITY BILLING USE ONLY	
ACCT		INPUT	
1234		5678	
START		START	
01/15/2024		01/15/2024	

UNIVERSITY OF CALIFORNIA, BERKELEY, NO. 1
SCHOOL OF PUBLIC AFFAIRS, BERKELEY, CALIF. 94720-1680
AN AFFILIATION OF THE UNIVERSITY OF CALIFORNIA

Natomas Unified School District

1515 Sports Drive, #1 • Sacramento, CA 95834-1905

Phone 916-641-3300 • Fax 916/928-1629

CERTIFICATION OF COMPLIANCE

SCHOOL DISTRICT DEVELOPMENT FEES

PART I: TO BE COMPLETED BY APPLICANT

Property Owner's Name _____
 Owner's Address _____
 Project Address 3806 Stemmer Ln lot 57
 Parcel Number _____
 Subdivision Name _____
 Name of City _____
 Print Applicant's Name _____ Applicant's Signature _____
 Title of Applicant _____ Telephone Number _____
 Date _____

PART II: TO BE COMPLETED BY BUILDING DEPARTMENT

Plan Identification Number _____
 Building Type (Check One)
 Residential Apartment/Condominium Commercial/Industrial
 Square Feet of Chargeable Building Area 2323
 Signatory _____ Date _____
 Title _____

PART III: TO BE COMPLETED BY NATOMAS UNIFIED SCHOOL DISTRICT

District Identification Number	_____		
Fees Collected:	_____		
Residential	<u>2323</u>	Sq. Ft. X \$ <u>4.57</u>	= \$ <u>10616.11</u>
Apartment/Condominium		Sq. Ft. X \$	= \$
Commercial/Industrial		Sq. Ft. X \$	= \$

NOTICE TO APPLICANT: Pursuant to government code section 66020 (d), this will serve to notify you that the 90-day approval period in which you may protest the fees, or other payment identified above, will begin to run on the date on which the building or installation permit for this project is issued, or on which they are paid to the District or to another public entity authorized to collect them on behalf of the District, whichever is earlier.

Applicant Signature: _____ Date: _____

This certification covers only the amount of square footage indicated above. Any additions or corrections to the square footage for this project will require an amendment to the Certificate of Compliance.

As the authorize Natomas Unified School District official, I hereby certify that the requirements of Government Code Section 95995 have been complied with by the above signed applicant.

SIGNATURE: _____ DATE: 6-1-99

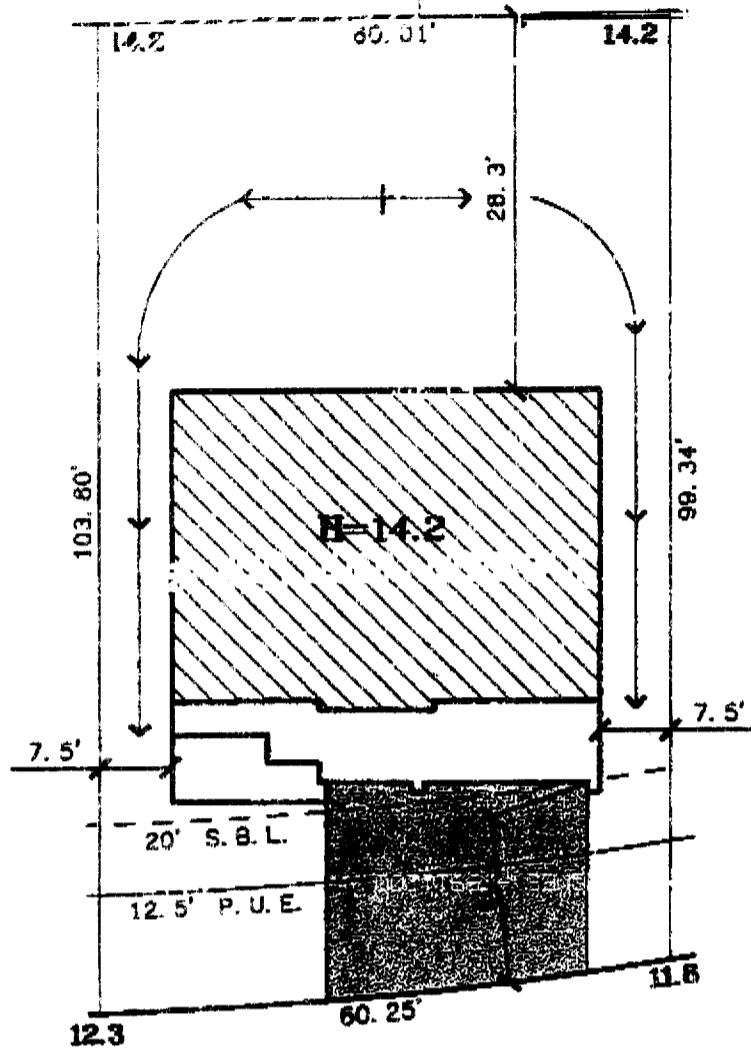

STEMMLER DRIVE

DATE: 4-23-99
 A.P.N.:
 ADDRESS: 3806 STEMLER DRIVE

LOT AREA: 6,133 SF
 LOT COVERAGE: 31%

The Spink Corporation
 2590 VENTURE OAKS WAY
 SACRAMENTO, CA. 95833
 PH:(916)925-5550 FAX:(916)921-9274

GATEWAY WEST
VILLAGE 1 UNIT 4
LOT 57
PLAN 5B

GATEWAY WEST
 CITY OF SACRAMENTO, CA.
 CLIENT: KAUFMAN & BROAD
 JOB NO.: 4734-042