

CITY OF SACRAMENTO
1231 I Street, Sacramento, CA 95814

Permit No: 0112918
Insp Area: 4
Thos Bros:
Sub-Type: NSFR
Housing (Y/N):

Site Address: 1721 BAINES AV SAC
Parcel No: 225-1110-010
N

NORTHPOINTE PARK VIL. 12 LOT 10

CONTRACTOR
LENNAR RENAISSANCE INC
2240 DOUGLAS BL
ROSEVILLE, CA 95661

OWNER

ARCHITECT

Nature of Work: MP 654 W/ OPT 1, 2 STORY 11 ROOM SFR

CONSTRUCTION LENDING AGENCY : I hereby affirm under penalty of perjury that there is a construction lending agency for the performance of the work for which this permit is issued (Sec. 3097, Civ. C).

Lender's Name _____ Lender's Address _____

LICENSED CONTRACTORS DECLARATION: I hereby affirm under penalty of perjury that I am licensed under provisions of Chapter 9 (commencing with section 7000) of Division 3 of the Business and Professions Code and my license is in full force and effect.

License Class B License Number 732348 Date 10/19/01 Contractor Signature J. Price

OWNER-BUILDER DECLARATION: I hereby affirm under penalty of perjury that I am exempt from the contractors License Law for the following reason (Sec. 7031.5, Business and Professions Code; any city or county which requires a permit to construct, alter, improve, demolish, or repair any structure, prior to its issuance, also requires the applicant for such permit to file a signed statement that he or she is licensed pursuant to the provisions of the Contractors License Law (Chapter 9 (commencing with Section 7000) of Division 8 of the Business and Professions Code) or that he or she is exempt therefrom and the basis for the alleged exemption. Any violation of Section 7031.5 by any applicant for a permit subjects the applicant to a civil penalty of not more than five hundred dollars (\$500.00);

_____, I, as a owner of the property, or my employees with wages as their sole compensation, will do the work, and the structure is not intended or offered for sale (Sec. 7044, Business and Professional Code: The Contractors License Law does not apply to an owner of property who builds or improves thereon, and who does such work himself or herself or through his/her own employees, provided that such improvements are not intended or offered for sale. If, however, the building or improvement is sold within one year of completion, the owner-builder will have the burden of proving that he/she did not build or improve for the purpose of sale.)

_____, I, as owner of the property, am exclusively contracting with licensed contractors to construct the project (Sec. 7044, Business and Professions Code: The Contractors License Law does not apply to an owner of property who builds or improves thereon, and who contracts for such projects with a contractor(s) licensed pursuant to the Contractors License Law).

_____, I am exempt under Sec. _____ B & PC for this reason: _____

Date 10/19/01 Owner Signature J. Price

IN ISSUING THIS BUILDING PERMIT, the applicant represents, and the city relies on the representation of the applicant, that the applicant verified all measurements and locations shown on the application or accompanying drawings and that the improvement to be constructed does not violate any law or private agreement relating to permissible or prohibited locations for such improvements. This building permit does not authorize any illegal location of any improvement or the violation of any private agreement relating to location of improvements.

I certify that I have read this application and state that all information is correct. I agree to comply with all city and county ordinances and state laws relating to building construction and hereby authorize representative(s) of this city to enter upon the above mentioned property for inspection purposes.

Date 10/19/01 Applicant/Agent Signature J. Price

WORKER'S COMPENSATION DECLARATION: I hereby affirm under penalty of perjury one of the following declarations:

_____, I have and will maintain a certificate of consent to self-insure for workers' compensation as provided for by Section 3700 of the Labor Code, for the performance of work for which the permit is issued.

J. Price I have and will maintain workers' compensation insurance, as required by Section 3700 of the Labor Code, for the performance of the work for which this permit is issued. My workers' compensation insurance carrier and policy number are:

Carrier CNA INSURANCE COMPANY Policy Number WC138201151 Exp Date 06/01/2002

_____, (This section need not be completed if the permit is for \$100 or less) I certify that in the performance of the work for which this permit is issued, I shall not employ any person in any manner so as to become subject to the workers' compensation laws of California and agree that if I should become subject to the workers' compensation provisions of Section 3700 of the Labor Code, I shall forthwith comply with those provisions.

Date 10/17/01 Applicant Signature J. Price

WARNING: FAILURE TO SECURE WORKER'S COMPENSATION COVERAGE IS UNLAWFUL AND SHALL SUBJECT AN EMPLOYER TO CRIMINAL PENALTIES AND CIVIL FINES UP TO ONE HUNDRED THOUSAND DOLLARS (\$100,000) IN ADDITION TO THE COST OF COMPENSATION, DAMAGES AS PROVIDED FOR IN SECTION 3706 OF THE LABOR CODE, INTEREST AND ATTORNEYS FEE.

THIS PERMIT SHALL EXPIRE BY LIMITATION IF WORK IS NOT COMMENCED WITHIN 180 DAYS.

EGCEL INSULATION INC.

CALIFORNIA CONTRACTOR'S LICENSE #745646

460 Roseville Road • Roseville, CA 95678

(916) 786-2088 / (916) 969-6191

THIS IS TO CERTIFY THAT INSULATION HAS BEEN INSTALLED IN CONFORMANCE WITH CURRENT ENERGY REGULATIONS, CALIFORNIA ADMINISTRATIVE CODE, TITLE 24, STATE OF CALIFORNIA, IN THE BUILDING LOCATED AT:

TRACT	<u>SCHEISSIT</u>	LOT	<u>1922045983</u>
STREET		CITY	<u>ALHAMBRA</u>
EXTERIOR WALLS:	<u>CT</u>	<u>2011</u>	<u>312</u>
		<u>250</u>	<u>679</u>
MANUFACTURER		THICKNESS	R-VALUE
			<u>13</u>
CELLING AREA: BATS			
MANUFACTURER	<u>CT</u>	THICKNESS	R-VALUE
		<u>12</u>	<u>38</u>
CELLINGS: BLOWN IN			
MANUFACTURER	<u>USUAL SPK</u>	THICKNESS	R-VALUE
	<u>2072</u>	<u>679</u>	<u>38</u>
SQUARE FOOTAGE		NUMBER OF BAGS USED	
<u>250</u>		<u>477</u>	
FLOOR AREA:			
MANUFACTURER	<u>CT</u>	THICKNESS	R-VALUE
		<u>679</u>	<u>19</u>
EXTERIOR KNEEWALL:			
MANUFACTURER	<u>CT</u>	THICKNESS	R-VALUE
		<u>679</u>	<u>19</u>
INTERIOR KNEEWALL:			
MANUFACTURER	<u>CT</u>	THICKNESS	R-VALUE
		<u>679</u>	<u>19</u>
APPLIED CAULK & SEALANT TO ALL EXTERIOR OPENINGS & PENETRATIONS			
YES <input checked="" type="checkbox"/> NO <input type="checkbox"/>			
GENERAL CONTRACTOR			
CALIFORNIA CONTRACTORS			
LICENSE #		DATE	
SIGNATURE		TITLE	
INSULATION CONT. SIGNATURE		TITLE	
DATE		DATE	

KwikKote

No. 200-005223

Stucco System Installation Card

Job Name: SOMERSET
Address: 1721 BAINES AVE.
SACRAMENTO, CA
Lot #: 0000010

Stucco System Trade Name: KWIK KOTE
Stucco System Manufacturer: KWIK KOTE CORP.

ICBO Evaluation Service, Inc.
Report No. 3607
Date of Job Completion:

Home Builder: LENNAR RENAISSANCE
Address: 2240 DOUGLAS BLVD #250
ROSEVILLE, CA

Stucco Contractor: KENYON PLASTERING, INC.
Address: PO BOX 2077
North Highlands, CA

Telephone Number: 916/349-8191

Approved Contractor Number as
issued by the Stucco Manufacturer: 1001

Card Print Date: 02/14/2002

This is to certify that the stucco system on the building exterior at the above address had been installed in accordance with the evaluation report specified above and the manufacturer's instructions.

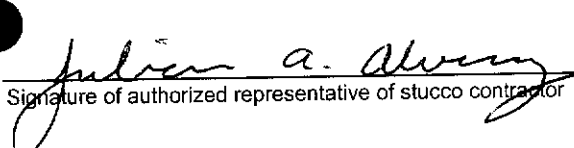

Signature of authorized representative of stucco contractor

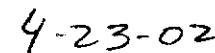

Date

RESIDENTIAL BUILDING PERMIT APPLICATION

New Construction

Addition

Remodels

Other Lot: 10

Project Address: 1721 Baines Ave

Assessor Parcel # 225-110-010-00

OWNER INFORMATION: North Pointe Park Village #12

Legal Property Owner: LENNAR RENAISSANCE

Phone # (916) 773-7471

Owner Address: 2240 DOUGLAS BLVD.

City ROSEVILLE

State CA

Zip 95661

CONTRACTOR INFORMATION:

0112918

Contractor: LENNAR RENAISSANCE

Lic. # 732348

Phone # (916) 773-747 Fax # (916) 773-4086

PROJECT INFORMATION:

Land Use Zone R/A

Occupancy Group R3

Construction Type UN

Fed Code 1A

No. of stories: 2

No. of rooms: _____

Street width: 40'

1st Floor Area 2030

2nd Floor Area 1481

Basement N/A

Roof Material TILE

AREA IN SQUARE FOOT OF:

EXISTING

NEW

Dwelling/Living

3711

Garage/Storage

446

Decks/Saloonies

Carports

OPT 1

SCOPE OF WORK:

NEW CONSTRUCTION SFD

FOR OFFICE USE ONLY:

Information above complete

AR Flood Waiver required

Planning Approval

Violation files checked

Flood Elevation Certificate Required

Design Review Approval

Standard setbacks

Water Development Infill Area

Special Fee District Apply: _____

County Sewer

NEW STRUCTURES & ADDITIONS

*THE FOLLOWING MUST BE PROVIDED IN ORDER TO SUBMIT FOR PLAN REVIEW:

2 COMPLETE PLANS, LEGIBLE & DRAWN TO SCALE

* Plans to include: site plan, floor plan, elevations, roof/ceiling plan, foundation and structural framing details, and structural calculations for non-conforming structures.

3 SETS IF PROJECT IS IN A DESIGN REVIEW AREA

Title 24 Energy Compliance documentation

11" x 17" copy of floor plan for County Assessor

Grading and Erosion Control Questionnaire

Plan Review Fees

Date: _____

Received by: (staff) _____

ACTIVITY PERMIT #

11
P=14.0

9
P=13.5

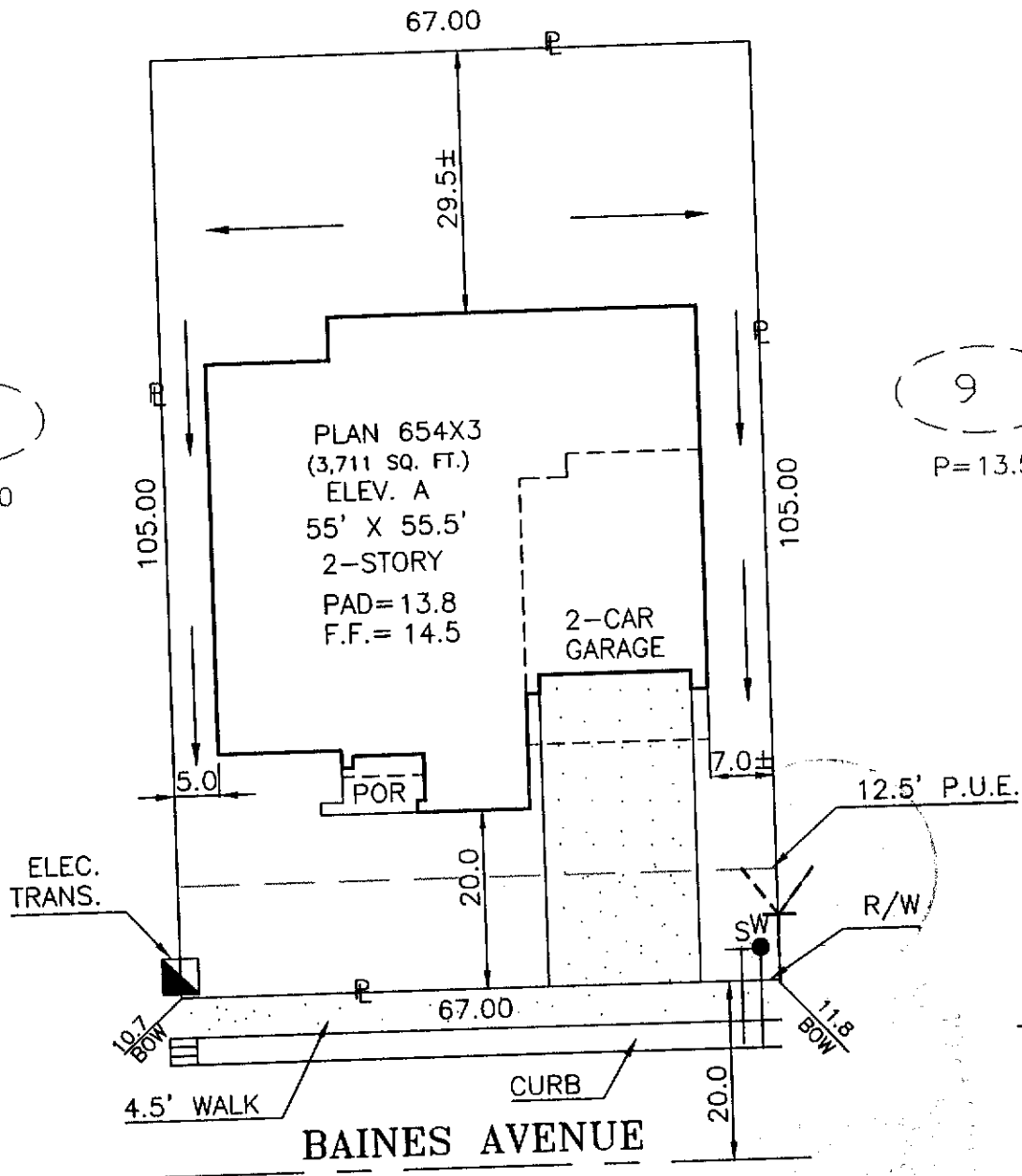

DIMENSIONS SHOWN ARE APPROXIMATE EXCEPT FOR MINIMUMS REQUIRED BY ORDINANCE. THIS PLOT DOES NOT REFLECT AS BUILT CONDITIONS AND MAY VARY FROM THIS PLAN.

RENAISSANCE HOMES 2240 DOUGLAS BLVD. SUITE 250, ROSEVILLE, CALIFORNIA 95661 PHONE (916) 773-4083 FAX (916) 773-4086	SOMERSET		PLOT PLAN NOTES:
	NORTHPOINTE PARK UNIT 12 CITY OF SACRAMENTO SACTO. COUNTY CALIFORNIA		
ADDRESS: 1721 BAINES AVENUE	LOT COV: 35.2 %	APN:	LOT 10
PLAN NO.:654X3-A	LOT SQ. FT.: 7,035	REAR YARD COVERAGE: %	
DRAWN BY: R.P.	APPROVED BY: <i>[Signature]</i>	DATE: 8/31/01 SCALE: 1"=20'	