

CITY OF SACRAMENTO
1231 I Street, Sacramento, CA 95814

Permit No: 0008324
Insp Area: 4

Site Address: 2624 SERENATA WY SAC
Parcel No: 201-0400-095
N

NORTHBOROUGH 1 VIL 1 LOT 95

Sub-Type: NSFR
Housing (Y/N):

CONTRACTOR
LENNAR RENAISSANCE INC.
2240 DOUGLAS BL
ROSEVILLE CA 95661

OWNER

ARCHITECT

Nature of Work: NSFR MP172 1 STORY 8 RMS

CONSTRUCTION LENDING AGENCY: I hereby affirm under penalty of perjury that there is a construction lending agency for the performance of the work for which this permit is issued (Sec. 3097, Civ. C).

Lender's Name _____ Lender's Address _____

LICENSED CONTRACTORS DECLARATION: I hereby affirm under penalty of perjury that I am licensed under provisions of Chapter 9 (commencing with section 7000) of Division 3 of the Business and Professions Code and my license is in full force and effect.

License Class B License Number 732348 Date 2/28/01 Contractor Signature [Signature]

OWNER-BUILDER DECLARATION: I hereby affirm under penalty of perjury that I am exempt from the contractors License Law for the following reason (Sec. 7031.5, Business and Professions Code; any city or county which requires a permit to construct, alter, improve, demolish, or repair any structure, prior to its issuance, also requires the applicant for such permit to file a signed statement that he or she is licensed pursuant to the provisions of the Contractors License Law (Chapter 9 (commencing with Section 7000) of Division 8 of the Business and Professions Code) or that he or she is exempt therefrom and the basis for the alleged exemption. Any violation of Section 7031.5 by any applicant for a permit subjects the applicant to a civil penalty of not more than five hundred dollars (\$500.00):

____ I, as a owner of the property, or my employees with wages as their sole compensation, will do the work, and the structure is not intended or offered for sale (Sec. 7044, Business and Professional Code: The Contractors License Law does not apply to an owner of property who builds or improves thereon, and who does such work himself or herself or through his/her own employees, provided that such improvements are not intended or offered for sale. If, however, the building or improvement is sold within one year of completion, the owner-builder will have the burden of proving that he/she did not build or improve for the purpose of sale.)

____ I, as owner of the property, am exclusively contracting with licensed contractors to construct the project (Sec. 7044, Business and Professions Code: The Contractors License Law does not apply to an owner of property who builds or improves thereon, and who contracts for such projects with a contractor(s) licensed pursuant to the Contractors License Law).

____ I am exempt under Sec. _____ B & PC for this reason: _____

Date _____ Owner Signature _____

IN ISSUING THIS BUILDING PERMIT, the applicant represents, and the city relies on the representation of the applicant, that the applicant verified all measurements and locations shown on the application or accompanying drawings and that the improvement to be constructed does not violate any law or private agreement relating to permissible or prohibited locations for such improvements. This building permit does not authorize any illegal location of any improvement or the violation of any private agreement relating to location of improvements.

I certify that I have read this application and state that all information is correct. I agree to comply with all city and county ordinances and state laws relating to building construction and hereby authorize representative(s) of this city to enter upon the abovementioned property for inspection purposes.

Date 8-11-00 Applicant/Agent Signature [Signature]

WORKER'S COMPENSATION DECLARATION: I hereby affirm under penalty of perjury one of the following declarations:
[Signature] have and will maintain a certificate of consent to self-insure for workers' compensation as provided for by Section 3700 of the Labor Code, for the performance of work for which the permit is issued.

[Signature] have and will maintain workers' compensation insurance, as required by Section 3700 of the Labor Code, for the performance of the work for which this permit is issued. My workers' compensation insurance carrier and policy number are:

Carrier FRANCONCONTINENTAL INSURANCE CO Policy Number WC166792277 Exp Date 06/01/2001

[Signature] This section need not be completed if the permit is for \$100 or less) I certify that in the performance of the work for which this permit is issued, I shall not employ any person in any manner so as to become subject to the workers' compensation laws of California and agree that if I should become subject to the workers' compensation provisions of Section 3700 of the Labor Code, I shall forthwith comply with those provisions.

Date 8-11-00 Applicant Signature [Signature]

WARNING: FAILURE TO SECURE WORKER'S COMPENSATION COVERAGE IS UNLAWFUL AND SHALL SUBJECT AN EMPLOYER TO CRIMINAL PENALTIES AND CIVIL FINES UP TO ONE HUNDRED THOUSAND DOLLARS (\$100,000) IN ADDITION TO THE COST OF COMPENSATION. DAMAGES AS PROVIDED FOR IN SECTION 3706 OF THE LABOR CODE, INTEREST AND ATTORNEY'S FEE.

THIS PERMIT SHALL EXPIRE BY LIMITATION IF WORK IS NOT COMMENCED WITHIN 180 DAYS.

WIMACREST

RESIDENTIAL BUILDING PERMIT APPLICATION

New Construction

Addition

Remodels

Other

Project Address: 2624 SERENATA WAY

Assessor Parcel # 201-040-095

OWNER INFORMATION:

NORTHBROUGH VILLAGE 1 LOT #95

Legal Property Owner: <u>LENNAR RENAISSANCE</u>	Phone # <u>(916)773-7471</u>
Owner Address: <u>2240 DOUGLAS BLVD.</u>	City <u>ROSEVILLE</u> State <u>CA</u> Zip <u>95661</u>

CONTRACTOR INFORMATION:

Contractor: <u>LENNAR RENAISSANCE</u>	Lic. # <u>732348</u>	Phone # <u>(916)773-747</u>	Fax# <u>(916)773-4086</u>
---------------------------------------	----------------------	-----------------------------	---------------------------

PROJECT INFORMATION:

Land Use Zone <u>RA</u>	Occupancy Group <u>R3</u>	Construction Type <u>UN</u>	Fed Code <u>1A</u>
No. of stories <u>1</u>	No. of rooms: _____	Street width: <u>40'</u>	
1 st Floor Area <u>1686</u>	2 nd Floor Area _____	Basement _____	Roof Material <u>TILE</u>

AREA IN SQUARE FOOT OF:	EXISTING	NEW
Dwelling/Living	_____	<u>1686</u>
Garage/Storage	_____	<u>415</u>
Decks/Balconies	_____	_____
Carports	_____	_____

SCOPE OF WORK: _____

FOR OFFICE USE ONLY:

- | | | |
|---|---|--|
| <input type="checkbox"/> Information above complete | <input type="checkbox"/> AR Flood Waiver required | <input type="checkbox"/> Planning Approval |
| <input type="checkbox"/> Violation files checked | <input type="checkbox"/> Flood Elevation Certificate Required | <input type="checkbox"/> Design Review Approval |
| <input type="checkbox"/> Standard setbacks | <input type="checkbox"/> Water Development Infill Area | <input type="checkbox"/> Special Fee Districts Apply : _____ |
| <input type="checkbox"/> County Sewer | | |

NEW STRUCTURES & ADDITIONS

❖ THE FOLLOWING MUST BE PROVIDED IN ORDER TO SUBMIT FOR PLAN REVIEW

- | | |
|---|---|
| <input type="checkbox"/> 2 COMPLETE PLANS, LEGIBLE & DRAWN TO SCALE | ❖ Plans to include: site plan, floor plan, elevations, roof/ceiling plan, foundation and structural framing details, and structural calculations for non-conforming structures. |
| <input type="checkbox"/> 3 SETS IF PROJECT IS IN A DESIGN REVIEW AREA | |
| <input type="checkbox"/> Title 24 Energy Compliance documentation | <input type="checkbox"/> 11" x 17" copy of floor plan for County Assessor |
| <input type="checkbox"/> Grading and Erosion Control Questionnaire | <input type="checkbox"/> Plan Review Fees |

Date: _____

Received by: (staff) _____

ACTIVITY/PERMIT # _____

COUNTY SANITATION DISTRICT NO. 1
 SACRAMENTO REGIONAL COUNTY SANITATION DISTRICT
SEWER IMPACT FEE *gmr*
 PERMIT AND CALCULATION SHEET *8/1/11*

APPLICATION NO		BLDG PERMIT NO: <i>CITY</i>	
GENERAL INFORMATION		THIS PERMIT GOOD ONLY WHEN VALIDATED BY THE CASHIER PAID <i>8-3-11</i> <i>2011 371</i> THIS PERMIT TO CONNECT EXPIRES ONE YEAR FROM DATE OF ISSUANCE	
FEE CALCULATION		BUILDING USE	
INSPECTION		RESIDENTIAL SF <input checked="" type="checkbox"/>	MF <input type="checkbox"/>
CSD-1	<i>473</i>	COMMERCIAL USE	UNITS
SRCSD	<i>2404</i>		
CONSTRUCTION			
IN-LIEU			
TOTAL FEE	<i>2877</i>		
APN: <i>201-041 095</i>			
DESCRIPTION/ SUBDIVISION <i>NORTHBOROUGH VILLAGE #1</i> LOT: <i>95</i>			
PROPERTY ADDRESS <i>2624 Severata Way</i>			
OWNER <i>LENAIR LORANCE</i>			
MAILING ADDRESS <i>2201 DOUGLAS BLVD</i>			
CITY-STATE-ZIP <i>ROSBVILLE CA 95661</i> PHONE <i>773-7471</i>			
ADDITIONAL FEES MAY BE DUE IF CHANGES IN USE INCREASE SEWER IMPACT.			
APPLICANT SIGNATURE <i>[Signature]</i>			
CONSOLIDATED UTILITY BILLING USE ONLY			
ACCT _____ INPUT _____ START _____			

INSPECTOR'S COPY

Natomas Unified School District
 1515 Sports Drive, #1 • Sacramento, CA 95834-1905
 Phone 916/641-3300 • Fax 916/928-1629

CERTIFICATION OF COMPLIANCE

SCHOOL DISTRICT DEVELOPMENT FEES

PART I: TO BE COMPLETED BY APPLICANT			
Property Owner's Name	LEONAR RENAISSANCE		
Owner's Address	2740 Drexel Ave Roseville CA 95661		
Project Address	2624 Sorenata Way LOT # 95		
Parcel Number	201-040-005		
Subdivision Name	NORTH BIRCH VILLAGE #1		
Number of Units	ONE		
Print Applicant's Name	JUDITH A. HALL	Applicant's Signature	<i>[Signature]</i>
Title of Applicant	PROCESSOR	Telephone Number	863 5931
Date	7-13-00		
PART II: TO BE COMPLETED BY BUILDING DEPARTMENT			
Plan Identification Number	000332AR		
Building Type (Check One)	<input checked="" type="checkbox"/> Residential <input type="checkbox"/> Apartment/Condominium <input type="checkbox"/> Commercial/Industrial		
Square Feet of Chargeable Building Area	1686		
Signature	<i>[Signature]</i>		
Title	Bldg Insp	Date	7/22/00
PART III: TO BE COMPLETED BY NATOMAS UNIFIED SCHOOL DISTRICT			
District Certification Number	11-20		
Fees Collected:			
Residential:	1686	Sq. Ft. X \$ 3.25	= \$ 5479.50
Apartment/Condominium:		Sq. Ft. X \$	= \$
Commercial/Industrial:		Sq. Ft. X \$	= \$
NOTICE TO APPLICANT: Pursuant to government code section 66020 (d), this will serve to notify you that the 90-day approval period in which you may protest the fees, or other payment identified above, will begin to run on the date in which the building or installation permit for this project is issued, or on which they are paid to the District, or to another public entity authorized to collect them on behalf of the District, whichever is earlier.			
Applicant Signature:	<i>[Signature]</i>		Date: 7-13-00

This certification covers only the amount of square footage indicated above. Any additions or corrections to the square footage for this project will require an amendment to the Certificate of Compliance.

As the authorize Natomas Unified School District official, I hereby certify that the requirements of Government Code Section 95995 have been complied with by the above signed applicant.

SIGNATURE: _____ DATE: 8/9/00
 TITLE: _____

PLOT PLAN

THIS PLOT PLAN IS FOR THE PURPOSE OF SHOWING THE HOUSE TO BE CONSTRUCTED ON THE LOT AND MAY NOT REPRESENT THE FINAL AS-BUILT CONFIGURATION OF THE PROPERTY OR IMPROVEMENTS THEREON. THE ACCURACY OF THIS PLOT PLAN IS NOT GUARANTEED, NOR IS IT A PART OF ANY POLICY, REPORT OR GUARANTEE TO WHICH IT MAY BE ATTACHED. ACTUAL DIMENSIONS, OTHER THAN MINIMUM ORDINANCE, MAY VARY OR CHANGE WITHOUT PRIOR NOTICE, DUE TO ACTUAL SITE CONDITIONS.

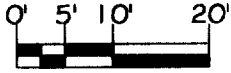

SCALE: 1 IN. = 20 FT.

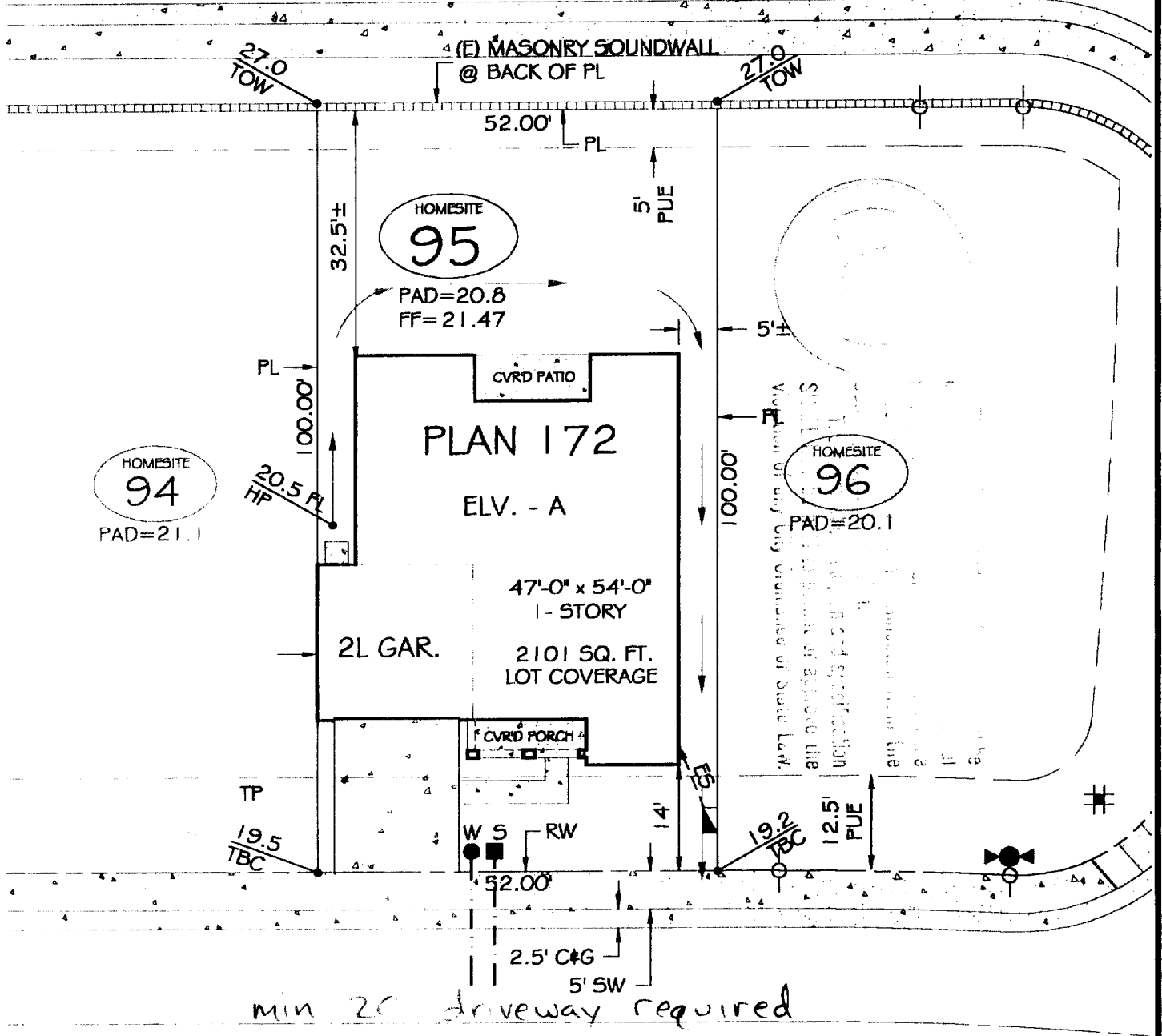

2624 SERENATA WAY

LOT COVERAGE	
LOT AREA:	5200 S.F.
BUILDING:	2101 S.F.
BLDG./ LOT AREA:	40 %

RETAINING WALL	
HEIGHT:	_____
LENGTH:	_____
DISTANCE FROM P.L.:	_____

SYMBOLS LEGEND	
DROP INLET:	
ELECTRIC SERVICE BOX:	
FIRE HYDRANT:	
GAS SERVICE:	
PAD-MOUNT TRANSFORMER:	
SEWER SVC.:	
STREET LIGHT:	
SPOT ELEVATION:	
SWALE (FLOW DIRECTION):	
WATER SVC.:	
EXTENTS OF UPPER STORY LEVEL:	



Phase 1.2
ASHFORD PLACE
at Natomas Park

HOME SITE #95
NORTHBOROUGH VILLAGE I
CITY OF SACRAMENTO, CALIFORNIA
A.P.N.: 201-040-095-000

- NOTES**
- MEASUREMENTS ALONG CURVED LINES ARE CHORD LENGTHS, U.O.N.
 - MAXIMUM ALLOWABLE LOT COVERAGE IS 45% FOR 1-STORY & 40% FOR 2-STORY
 - SETBACK DIMENSIONS ARE ROUNDED DOWN TO NEAREST HALF UNIT, U.O.N.

BCB	7/10/00		20:1
DRAWN BY	ISSUE		SCALE