

6



CITY OF SACRAMENTO

CITY MANAGER'S OFFICE
RECEIVED
JUL 13 1983

DEPARTMENT OF ENGINEERING
915 I STREET SACRAMENTO, CALIFORNIA 95814
CITY HALL ROOM 207 TELEPHONE (916) 449-5281

J.F. VAROZZA
CITY ENGINEER
M.H. JOHNSON
ASSISTANT CITY ENGINEER

July 12, 1983

City Council
Sacramento, California

Honorable Members in Session:

SUBJECT: Revocable Encroachment Permit - RJB III
1515 K Street and Southwest Corner of 16th and K

SUMMARY:

RJB III has applied for a revocable encroachment permit for the purpose of constructing exposed aggregate sidewalk and bricks around tree planters. The City Engineer recommends that the permit be granted.

BACKGROUND:

The area for which this request is being made consists of an area adjacent to permittee's property 16' x 160' along the east side of 15th Street immediately north of K Street, and an area 16' x 240' along the north side of K Street, immediately east of 15th Street, and a portion of the area 16' x 155' along the west side of 16th Street immediately south of K Street and a portion of the area 16' x 200' along the south side of K Street immediately west of 16th Street.

RECOMMENDATION:

The City Engineer recommends that the attached resolution be passed granting a revocable encroachment permit to RJB III in the area and for the purpose outlined above.

Respectfully submitted,

Recommendation Approved:

Walter J. Slips
Walter J. Slips, City Manager

J. F. Varozza
J. F. VAROZZA
Director of Public Works

JFV/GNM/hma

14-R-030-00-0

cc: Glenn Marshall
Bill Seeber
Jim Bloodgood
Will Weitman

APPROVED
BY THE CITY COUNCIL

JUL 19 1983

OFFICE OF THE
CITY CLERK

July 19, 1983
District #1

RESOLUTION No. 83-547

Adopted by The Sacramento City Council on date of

July 19, 1983

RESOLUTION GRANTING REVOCABLE ENCROACHMENT TO:

RJB III

BE IT RESOLVED BY THE COUNCIL OF THE CITY OF SACRAMENTO:

That a revocable encroachment permit for the purpose of constructing exposed aggregate sidewalk and bricks around the planters is hereby granted to RJB III, whose address is as follows: 2856 Arden Way, Suite 200, Sacramento, CA 98525.

The encroachment area is described as follows:

An area adjacent to permittee's property. An area 16' x 160' along the east side of 15th Street immediately north of K Street and an area 16' x 240' along the north side of K Street immediately east of 15th Street, and a portion of the area 16' x 155' along the west side of 16th Street immediately south of K Street and a portion of the area 16' x 200' along the south side of K Street immediately west of 16th Street (County Assessor's Parcel Numbers 6-121-12, 13 14, 15, 19 and 6-122-3, 11.).

This permit is granted subject to the "General Provisions - Revocable Encroachment Permit", which were adopted by the City Council in Resolution No. 81-845 dated November 17, 1981, and the hereinafter specified special conditions, if any. This permit shall be effective only after the applicant files with the Department of Finance of the City of Sacramento, the insurance certificates required by the General Provisions.

SPECIAL CONDITIONS

- 1. Permittee shall contact the City Sidewalk Inspector at 449-5236 prior to constructing sidewalks and driveways.

APPROVED
BY THE CITY COUNCIL

JUL 19 1983

OFFICE OF THE
CITY CLERK

2. Encroachment permits must be obtained for Caltrans for work on 15th and 16th Streets.

MAYOR

ATTEST:

CITY CLERK

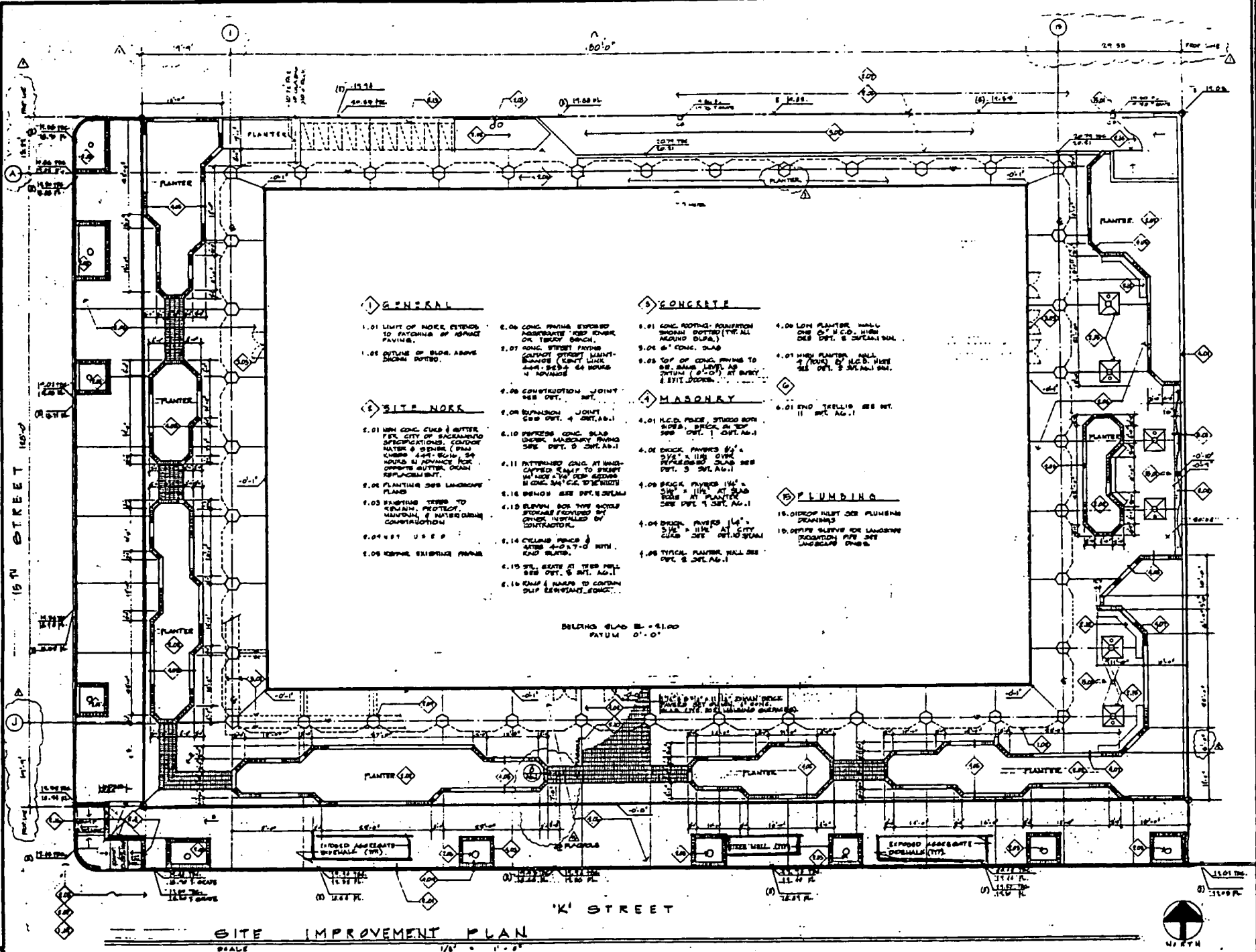

1 GENERAL

- 1.01 LIMIT OF NOISE EXTERIOR TO PATCHING OF ASPHALT PAVING.
- 1.02 OUTLINE OF SLIPS ABOVE SHOWN DUTIES.

2 SITE WORK

- 2.01 MIN CONC CURB & UTTER PER CITY OF SACRAMENTO SPECIFICATIONS. CONDUIT WATER & SEWER (P&S) UNDER 4'-0" SLAB 30 HOURS IN ADVANCE FOR CONCRETE UTTER. CLEAN REPLACEMENT.
- 2.02 PLANTING SEE LANDSCAPE PLANS
- 2.03 BRUSHING TREES TO REMAIN. PRUNING. MAINTENANCE & WATER DRAIN CONSTRUCTION
- 2.04 USE P
- 2.05 REMOVE EXISTING FENCES

3 CONCRETE

- 3.01 CONC. FINISH EXPOSED AGGREGATE KEY SEWER ON TERRY BRANCH.
- 3.02 CONC. STREET FINISH CONDUIT STREET MAINTENANCE (KEY LINK AND 6" DIA. 48 HOURS IN ADVANCE)
- 3.03 CONSTRUCTION JOINT SEE DET. 111.
- 3.04 EXPANSION JOINT SEE DET. 4 DET. AG.1
- 3.05 FINISHED CONC. SLAB UNDER MASONRY FINISH SEE DET. 5 DET. AG.1
- 3.06 INTERRUPTED CONC. AT MANHOLE CAP TO BE SET IN CONC. 2" DIA. 48 HOURS IN ADVANCE
- 3.07 BENCH SEE DET. 5 DET. AG.1
- 3.08 ELEVATION FOR THE SLOPE STORAGE PROVIDED BY OWNER INSTALLED BY CONTRACTOR.
- 3.09 CYLINDRICAL PIPES & FITS 4'-0" X 7'-0" WITH END FLANGES.
- 3.10 STEEL SEATS AT THESE WALLS SEE DET. 5 DET. AG.1
- 3.11 CURB & UTTER TO CONFORM WITH EXISTING CONC.

4 MASONRY

- 4.01 H.C.D. FACE STUCCO BOTH SIDES BRICK ON TOP SEE DET. 1 DET. AG.1
- 4.02 BRICK PAVING 8" x 16" x 11/2" SILE RECESSED CONC. SEE DET. 5 DET. AG.1
- 4.03 BRICK PAVING 14" x 14" x 11/2" AT CURB SEE DET. 1 DET. AG.1
- 4.04 BRICK PAVING 14" x 14" x 11/2" AT CURB SEE DET. 1 DET. AG.1
- 4.05 TYPICAL PLANTER WALL SEE DET. 5 DET. AG.1

5 PLUMBING

- 5.00 LOW PLANTER WALL ONE 6" H.C.D. HIGH SEE DET. 5 DET. AG.1
- 5.01 HIGH PLANTER WALL 4' HIGH OF H.C.D. WITH SEE DET. 5 DET. AG.1
- 5.02 END TELLER SEE DET. 11 DET. AG.1
- 5.03 DROP INLET SEE PLUMBING DRAWINGS
- 5.04 OPENING SERVICE FOR LANDSCAPE PROTECTION PIPE SEE LANDSCAPE PLAN B.

BUILDING SLAB E. + 61.00
PATUM 0'-0"

SITE IMPROVEMENT PLAN
SCALE 1/4" = 1'-0"

DEAN F. UNGER
AIA INC.
ARCHITECTURE AND
ENVIRONMENTAL
PLANNING
700 Alhambra Blvd
Sacramento California 95831
916-441-5247

1-14-84 MARKED
6-10-82
revisions

This drawing is not final
and is not to be used for
construction until signed
by the Architect.

architect
Dean F. Unger
Drawn by
Checked by
job no. 21-84
date 6-8-84
Drawing no.

C-2

sheet title
sheet no.
of sheets

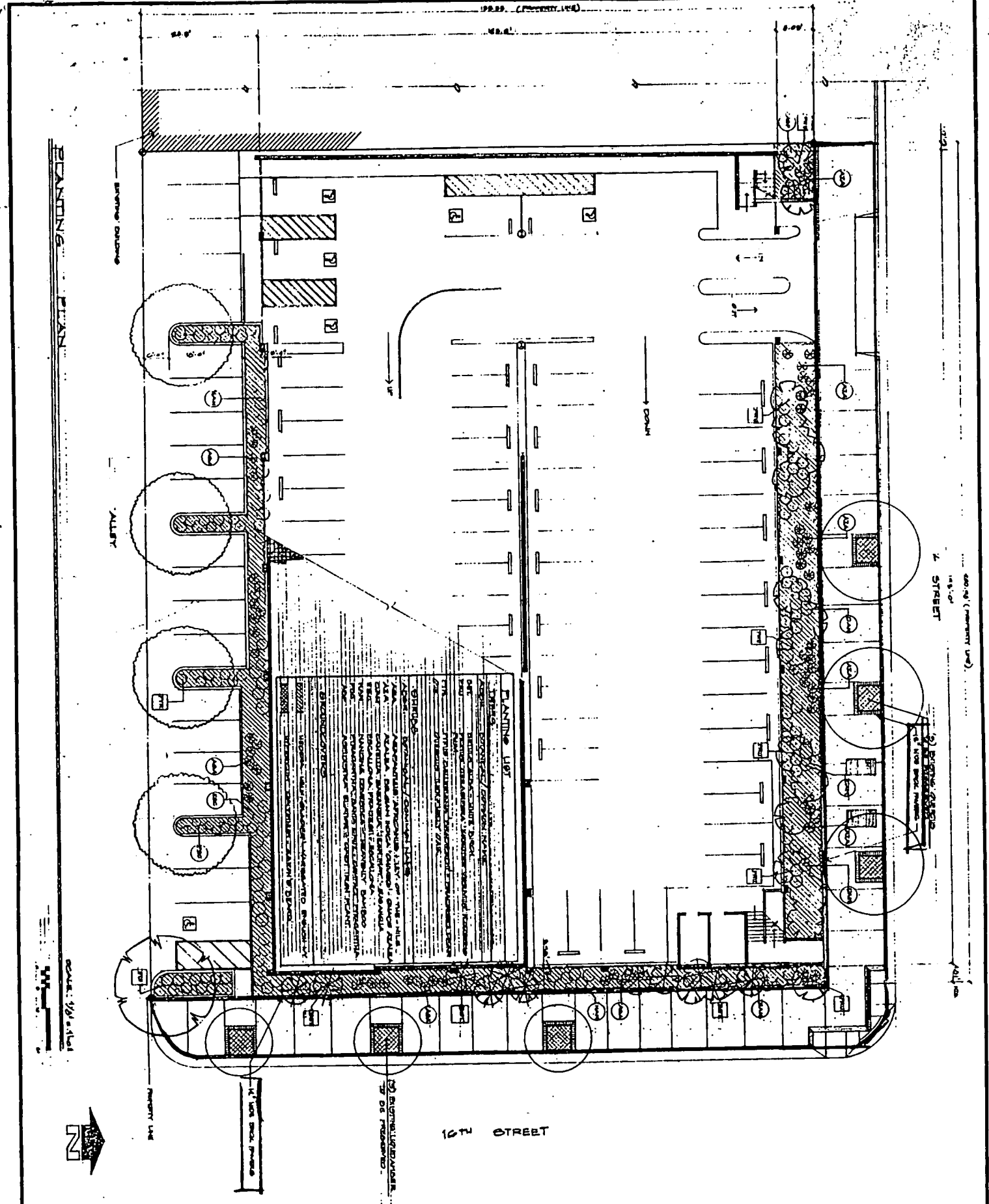

PLANING LOT

PLANING LOT

ARCHITECT: DEAN E. UNDER
 PROJECT: [illegible]
 DATE: [illegible]
 SHEET: [illegible]

NOTES:

1. ALL DIMENSIONS ARE TO FACE UNLESS OTHERWISE NOTED.
2. FINISHES ARE AS NOTED ON THE DRAWING.
3. SEE SPECIFICATIONS FOR MATERIALS AND METHODS OF CONSTRUCTION.
4. THE ARCHITECT IS NOT RESPONSIBLE FOR THE ACCURACY OF THE INFORMATION PROVIDED BY OTHER PROFESSIONALS.
5. THE ARCHITECT HAS CONDUCTED VISUAL GENERAL VERIFICATION OF THE INFORMATION PROVIDED BY OTHER PROFESSIONALS.
6. THE ARCHITECT HAS CONDUCTED VISUAL GENERAL VERIFICATION OF THE INFORMATION PROVIDED BY OTHER PROFESSIONALS.
7. THE ARCHITECT HAS CONDUCTED VISUAL GENERAL VERIFICATION OF THE INFORMATION PROVIDED BY OTHER PROFESSIONALS.
8. THE ARCHITECT HAS CONDUCTED VISUAL GENERAL VERIFICATION OF THE INFORMATION PROVIDED BY OTHER PROFESSIONALS.
9. THE ARCHITECT HAS CONDUCTED VISUAL GENERAL VERIFICATION OF THE INFORMATION PROVIDED BY OTHER PROFESSIONALS.
10. THE ARCHITECT HAS CONDUCTED VISUAL GENERAL VERIFICATION OF THE INFORMATION PROVIDED BY OTHER PROFESSIONALS.

DATE: 1/18/11



<p>DEAN E. UNDER ARCHITECTURE AND PLANNING 201 University Blvd Raleigh, NC 27609 Phone: 919.876.5288</p>	<p>PROJECT: [illegible]</p>
	<p>DATE: 1/18/11</p>

6

July 20, 1983

RJB III
2856 Arden Way, Suite 200
Sacramento, CA 95825

Dear Gentlemen:

On July 19, 1983, the Sacramento City Council adopted Resolution No. 83-547 granting the following Revocable Encroachment Permit in accordance with "General Provisions - Revocable Encroachment Permit," adopted by Council Resolution 81-845 as amended.

The permit is for the purpose of constructing exposed aggregate sidewalk and bricks around planters located southwest corner of 16th and K Streets.

This permit shall be effective only after you file with the Risk Management and Insurance Division of the City of Sacramento, **800 10th Street, Suite 4, Sacramento, CA 95814**, the insurance certificates required by the General Provisions.

Enclosed, for your records, is a copy of the resolution granting the permit, and Council Resolution 81-845, as amended.

Sincerely,

Lorraine Magana
City Clerk

LM/km/6
Enclosures

cc: Risk Management