

**CITY OF SACRAMENTO**

**Permit No: 9810469**

**1231 I Street, Sacramento, CA 95814**

**Insp Area: 1**

**Site Address: 5608 CALEB AV SAC**

**Sub-Type: ASFR**

**Parcel No: 0050131008**

**Housing (Y/N): N**

**CONTRACTOR**

**OWNER**

**ARCHITECT**

NIETHAMMER WILLIAM G/MARCELLE A  
5608 CALEB AV  
SACRAMENTO CA 95819

**Nature of Work: REMODEL KITCHEN AND FAMILY ROOM**

**CONSTRUCTION LENDING AGENCY :** I hereby affirm under penalty of perjury that there is a construction lending agency for the performance of the work for which this permit is issued (Sec. 3097, Civ. C).

Lender's Name \_\_\_\_\_ Lender's Address \_\_\_\_\_

**LICENSED CONTRACTORS DECLARATION:** I hereby affirm under penalty of perjury that I am licensed under provisions of Chapter 9 (commencing with section 7000) of Division 3 of the Business and Professions Code and my license is in full force and effect.

License Class \_\_\_\_\_ License Number \_\_\_\_\_ Date \_\_\_\_\_ Contractor Signature \_\_\_\_\_

**OWNER-BUILDER DECLARATION:** I hereby affirm under penalty of perjury that I am exempt from the contractors License Law for the following reason (Sec. 7031.5, Business and Professions Code; any city or county which requires a permit to construct, alter, improve, demolish, or repair any structure, prior to its issuance, also requires the applicant for such permit to file a signed statement that he or she is licensed pursuant to the provisions of the Contractors License Law (Chapter 9 (commencing with Section 7000) of Division 8 of the Business and Professions Code) or that he or she is exempt therefrom and the basis for the alleged exemption. Any violation of Section 7031.5 by any applicant for a permit subjects the applicant to a civil penalty of not more than five hundred dollars (\$500.00);

\_\_\_\_\_, I, as a owner of the property, or my employees with wages as their sole compensation, will do the work, and the structure is not intended or offered for sale (Sec. 7044, Business and Professional Code: The Contractors License Law does not apply to an owner of property who builds or improves thereon, and who does such work himself or herself or through his/her own employees, provided that such improvements are not intended or offered for sale. If, however, the building or improvement is sold within one year of completion, the owner-builder will have the burden of proving that he/she did not build or improve for the purpose of sale.)

\_\_\_\_\_, I, as owner of the property, am exclusively contracting with licensed contractors to construct the project (Sec. 7044, Business and Professions Code: The Contractors License Law does not apply to an owner of property who builds or improves thereon, and who contracts for such projects with a contractor(s) licensed pursuant to the Contractors License Law).

\_\_\_\_\_, I am exempt under Sec. \_\_\_\_\_ B & PC for this reason: \_\_\_\_\_

Date 10/20/98 Owner Signature

**IN ISSUING THIS BUILDING PERMIT,** the applicant represents, and the city relies on the representation of the applicant, that the applicant verified all measurements and locations shown on the application or accompanying drawings and that the improvement to be constructed does not violate any law or private agreement relating to permissible or prohibited locations for such improvements. This building permit does not authorize any illegal location of any improvement or the violation of any private agreement relating to location of improvements.

I certify that I have read this application and state that all information is correct. I agree to comply with all city and county ordinances and state laws relating to building construction and hereby authorize representative(s) of this city to enter upon the abovementioned property for inspection purposes.

Date 10/20/98 Applicant/Agent Signature

**WORKER'S COMPENSATION DECLARATION:** I hereby affirm under penalty of perjury one of the following declarations:

\_\_\_\_\_, I have and will maintain a certificate of consent to self-insure for workers' compensation as provided for by Section 3700 of the Labor Code, for the performance of work for which the permit is issued.

\_\_\_\_\_, I have and will maintain workers' compensation insurance, as required by Section 3700 of the Labor Code, for the performance of the work for which this permit is issued. My workers' compensation insurance carrier and policy number are:

Carrier \_\_\_\_\_ Policy Number \_\_\_\_\_

(This section need not be completed if the permit is for \$100 or less) I certify that in the performance of the work for which this permit is issued, I shall not employ any person in any manner so as to become subject to the workers' compensation laws of California and agree that if I should become subject to the workers' compensation provisions of Section 3700 of the Labor Code, I shall forthwith comply with those provisions.

Date 10/20/98 Applicant Signature

**WARNING: FAILURE TO SECURE WORKER'S COMPENSATION COVERAGE IS UNLAWFUL AND SHALL SUBJECT AN EMPLOYER TO CRIMINAL PENALTIES AND CIVIL FINES UP TO ONE HUNDRED THOUSAND DOLLARS (\$100,000) IN ADDITION TO THE COST OF COMPENSATION, DAMAGES AS PROVIDED FOR IN SECTION 3706 OF THE LABOR CODE, INTEREST AND ATTORNEY'S FEE.**

**THIS PERMIT SHALL EXPIRE BY LIMITATION IF WORK IS NOT COMMENCED WITHIN 180 DAYS.**

PERMIT NO.

981069R

CITY OF SACRAMENTO  
1231 I ST. ROOM 200  
BUILDING INSPECTIONS DIVISION

AREA NO.

1

WHEN CORRECTIONS HAVE BEEN MADE, CALL **264-5191** FOR REINSPECTION OF WORK

JOB LOCATION

5608 Cabell Av

Final

INSPECTION REQUESTED

~~PLUMBING~~ ~~MCHANICAL~~ ~~ELECTRICAL~~  
THE UNDERSIGNED INSPECTOR THIS DAY INSPECTED THIS STRUCTURE FOR THE REQUESTED INSPECTION AND FOUND THE FOLLOWING VIOLATIONS OF CITY AND/OR STATE LAWS GOVERNING SAME:

- 1) complete fireplace / chimney chase
- 2) provide spark arrester
- 3) GFCI does not trip with tester
- 4) outlet to left of sink test shows open ground
- 5) exposed Romex to under cabinet lighting prohibited
- 6) seal gas pipe Penetration into fireplace
- 7) seal conduit Penetration into attic
- 8) re install elect. svc panel covers plate
- 9) provide fipic. installation instructions  
Recall

INSPECTOR

*William J. ...*

DATE

12 / 11 / 98

BUILDING INSPECTIONS 264-5716

INSPECTOR'S OFFICE

GARY, NIETHAMMER RESIDENCE PAGE 2

THIS IS THE AREA OF CONCERN

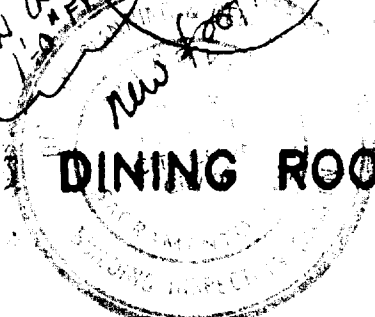
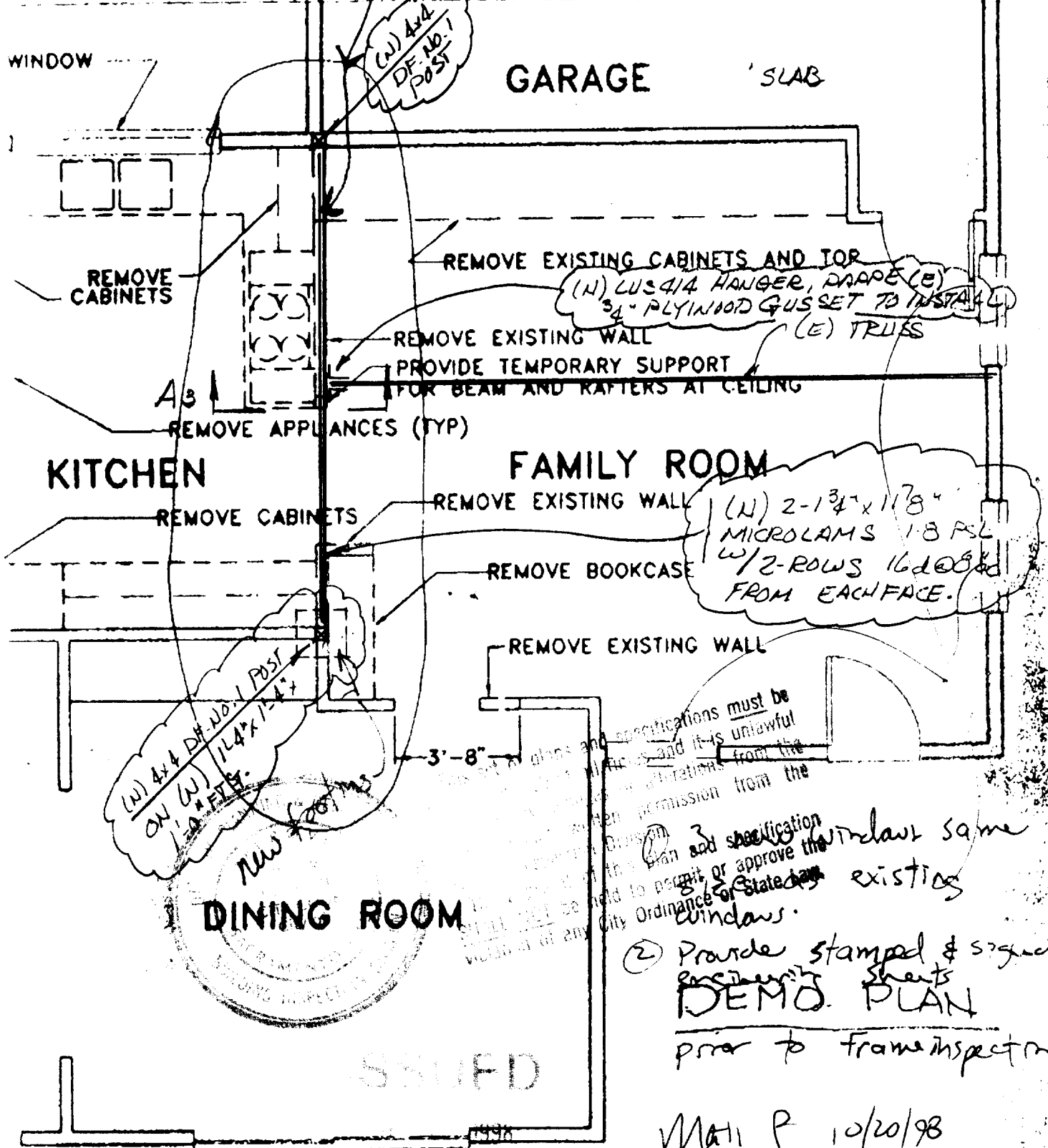

Specifications must be provided and it is unlawful to alter specifications from the original without the permission from the City of Portland.

3. Provide stamped & signed specification sheets **DEMO. PLAN** prior to frame inspection.

Mat P 10/20/98