

CITY OF SACRAMENTO
1231 I Street, Sacramento, CA 95814

Permit No: **0314404**
Insp Area: 4
Thos Bros: 256-J4

Site Address: **341 PELICAN BAY CR SAC**
Parcel No: 201-0730-087
N

Sub-Type: NSFR
HERITAGE @ NATOMAS PARK 1B LOT 25
Housing (Y/N):

CONTRACTOR
US HOME
2366 GOLD MEADOW DR STE 100
GOLD RIVER, CA 95670 77041

OWNER

ARCHITECT

Nature of Work: MP1797 1 STORY 8 ROOM SFR

CONSTRUCTION LENDING AGENCY : I hereby affirm under penalty of perjury that there is a construction lending agency for the performance of the work for which this permit is issued (Sec. 3097, Civ. C).

Lender's Name _____ Lender's Address _____

LICENSED CONTRACTORS DECLARATION: I hereby affirm under penalty of perjury that I am licensed under provisions of Chapter 9 (commencing with section 7000) of Division 3 of the Business and Professions Code and my license is in full force and effect.

License Class B License Number 451839 Date 10/8/13 Contractor Signature Don McCloskey

OWNER-BUILDER DECLARATION: I hereby affirm under penalty of perjury that I am exempt from the contractors License Law for the following reason (Sec. 7031.5, Business and Professions Code; any city or county which requires a permit to construct, alter, improve, demolish, or repair any structure, prior to its issuance, also requires the applicant for such permit to file a signed statement that he or she is licensed pursuant to the provisions of the Contractors License Law (Chapter 9 (commencing with Section 7000) of Division 8 of the Business and Professions Code) or that he or she is exempt therefrom and the basis for the alleged exemption. Any violation of Section 7031.5 by any applicant for a permit subjects the applicant to a civil penalty of not more than five hundred dollars (\$500.00);

I, as a owner of the property, or my employees with wages as their sole compensation, will do the work, and the structure is not intended or offered for sale (Sec. 7044, Business and Professional Code: The Contractors License Law does not apply to an owner of property who builds or improves thereon, and who does such work himself or herself or through his/her own employees, provided that such improvements are not intended or offered for sale. If, however, the building or improvement is sold within one year of completion, the owner-builder will have the burden of proving that he/she did not build or improve for the purpose of sale.)

I, as owner of the property, am exclusively contracting with licensed contractors to construct the project (Sec. 7044, Business and Professions Code: The Contractors License Law does not apply to an owner of property who builds or improves thereon, and who contracts for such projects with a contractor(s) licensed pursuant to the Contractors License Law).

I am exempt under Sec. _____ B & PC for this reason: _____

Date _____ Owner Signature _____

IN ISSUING THIS BUILDING PERMIT, the applicant represents, and the city relies on the representation of the applicant, that the applicant verified all measurements and locations shown on the application or accompanying drawings and that the improvement to be constructed does not violate any law or private agreement relating to permissible or prohibited locations for such improvements. This building permit does not authorize any illegal location of any improvement or the violation of any private agreement relating to location of improvements.

I certify that I have read this application and state that all information is correct. I agree to comply with all city and county ordinances and state laws relating to building construction and hereby authorize representative(s) of this city to enter upon the abovementioned property for inspection purposes.

Date 10/8/13 Applicant/Agent Signature Don McCloskey

WORKER'S COMPENSATION DECLARATION: I hereby affirm under penalty of perjury one of the following declarations:

I have and will maintain a certificate of consent to self-insure for workers' compensation as provided for by Section 3700 of the Labor Code, for the performance of work for which the permit is issued.

I have and will maintain workers' compensation insurance, as required by Section 3700 of the Labor Code, for the performance of the work for which this permit is issued. My workers' compensation insurance carrier and policy number are:

Carrier OLD REPUBLIC INS. CO. Policy Number MWC10815000 Exp Date 11/01/2003

(This section need not be completed if the permit is for \$100 or less) I certify that in the performance of the work for which this permit is issued, I shall not employ any person in any manner so as to become subject to the workers' compensation laws of California and agree that if I should become subject to the workers' compensation provisions of Section 3700 of the Labor Code, I shall forthwith comply with those provisions.

Date 10/8/13 Applicant Signature Don McCloskey

WARNING: FAILURE TO SECURE WORKER'S COMPENSATION COVERAGE IS UNLAWFUL AND SHALL SUBJECT AN EMPLOYER TO CRIMINAL PENALTIES AND CIVIL FINES UP TO ONE HUNDRED THOUSAND DOLLARS (\$100,000) IN ADDITION TO THE COST OF COMPENSATION, DAMAGES AS PROVIDED FOR IN SECTION 3706 OF THE LABOR CODE, INTEREST AND ATTORNEY'S FEE.

THIS PERMIT SHALL EXPIRE BY LIMITATION IF WORK IS NOT COMMENCED WITHIN 180 DAYS.

RESIDENTIAL SUBDIVISION BUILDING PERMIT APPLICATION

Project Address: 344 Pelican Bay Cir.
 Lot Number: 25

Assessor Parcel # 201-0730-087
 Subdivision Heritage @ Natomas Park Village 1B

OWNER INFORMATION:

0314403

Legal Property Owner: US Home Phone# (916) 858-3900
 Owner Address 2366 Gold Meadow Way City Gold River State CA Zip 95670

CONTRACTOR INFORMATION:

Contractor: US Home Lic. # 451839 Phone # (916) 858-3900 Fax (916) 858-3925

Don McCloskey (916) 719-9050

PROJECT INFORMATION:

Land Use Zone RIA Occupancy Group R3 Construction Type VN Fed Code 1A
 No. of Stories: 1 No. of Rooms: _____ Street Width: _____
 1st Floor Area 1797 2nd Floor Area _____ Basement _____ Roof Material _____

AREA IN SQUARE FOOT OF:

Dwelling/Living 1797
 Garage/Storage 457
 Decks/Balconies 41
 Carports _____

SCOPE OF WORK: _____

FOR OFFICE USE ONLY

- Information Above Complete
- Violation Files Checked
- Standard Setbacks
- County Sewer
- AR Flood Waiver Required
- Flood Elevation Certificate Required
- Water Development Infill Area
- Planning Approval
- Design Review Approval
- Special Fee Districts Apply:

---THE FOLLOWING MUST BE PROVIDED IN ORDER TO SUBMIT FOR PERMIT---

- 2 COMPLETE PLOT PLANS, LEGIBLE & DRAWN TO SCALE
- 11 X 17 COPY OF FLOOR PLAN WITH FOLLOWING INFORMATION
 - a) Assessor's Parcel Number
 - b) New Floor Area
 - c) Owners Name
 - d) Project Address

THIS PLAN IS PREPARED TO SHOW THE DIMENSIONAL RELATIONSHIP FROM BUILDING FOUNDATION TO PROPERTY LINES, DRAINAGE CONTROL ELEVATIONS AND DIRECTION OF DRAINAGE FLOW. THIS IS DONE TO CONFORM TO LOCAL ORDINANCES FOR THE PURPOSE OF BUILDING PERMIT ISSUANCE. INFORMATION SHOWN ON THIS PLAN IS APPROXIMATE EXCEPT FOR MINIMUM SETBACKS WHICH ARE REQUIRED BY LOCAL ORDINANCE. THIS PLAN DOES NOT REFLECT AS BUILT CONDITIONS WHICH WILL LIKELY VARY FROM THIS PLAN.

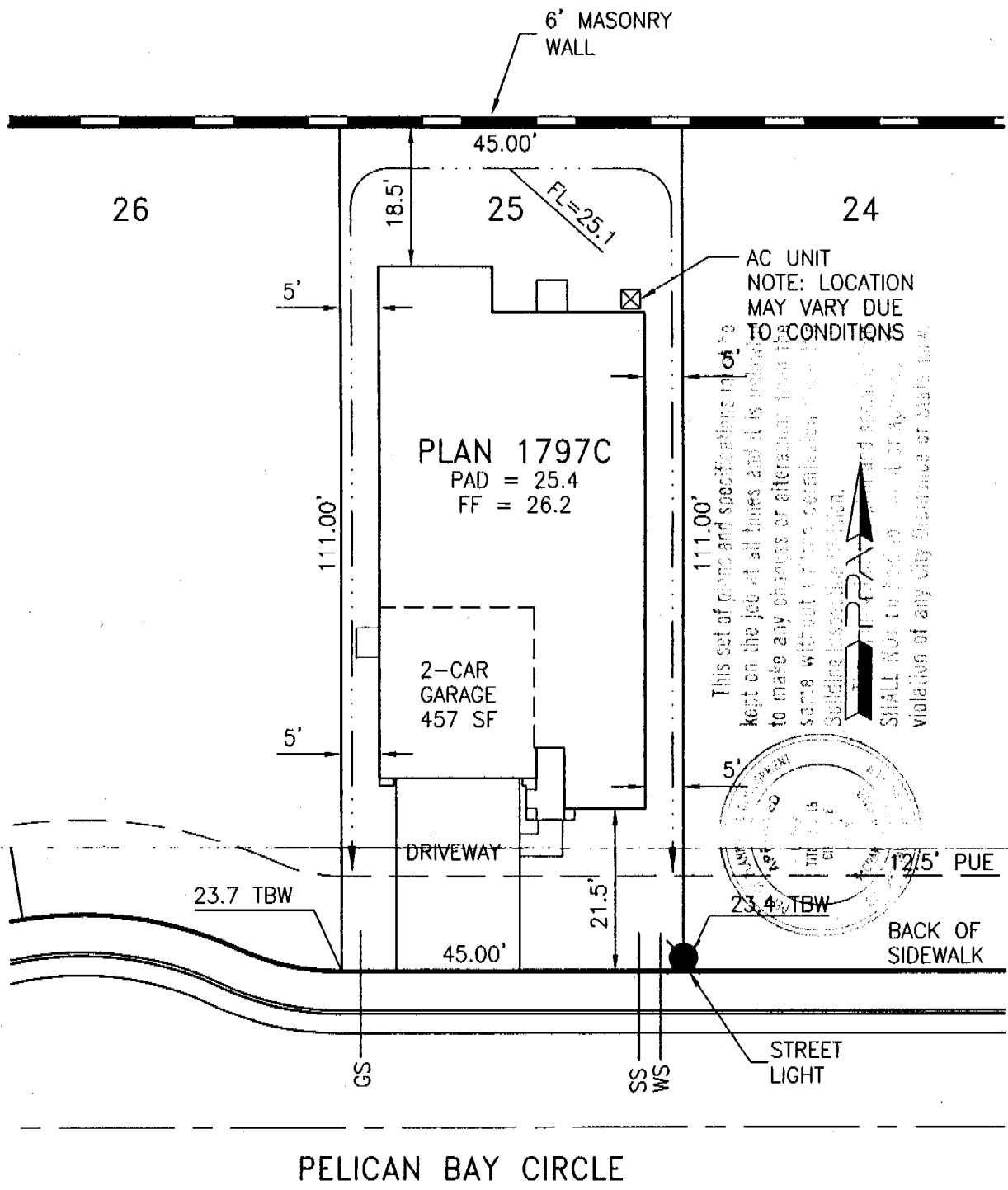

AC UNIT
NOTE: LOCATION
MAY VARY DUE
TO CONDITIONS

This set of plans and specifications is to be kept on the job at all times and it is intended to make any changes or alterations from the same without written notification to the Building Department of the City of Sacramento. SHALL NOT be construed as approval or violation of any City Ordinance or State Law.

PELICAN BAY CIRCLE

Approved By:	US Home Corp. Rep.	Date
Revision	Approved By	Date
▲		
▲		

LOT AREA: 4995 SF
 ALLOWED LOT COVERAGE: 2248 SF = 45.0%
 ACTUAL LOT COVERAGE: 2025 SF = 40.5%
 REAR YARD AREA: 980 SF
 NUMBER OF BEDROOMS:

It is understood that the drainage areas, slopes and grades shall not be altered, changed, blocked, modified or in any way be reconstructed by Owner contrary to what is depicted on this Plot Plan. THESE CONDITIONS RUN WITH THE LAND AND ARE BINDING ON ALL SUBSEQUENT OWNERS. All setback dimensions and elevations as shown may be adjusted to fit field conditions.

Plot Plan for Heritage at Natomas Park Village 1B
Heritage Park - Caribbean
 341 Pelican Bay Circle, Sacramento, CA 95835
 PPA Job #005010
Lot 25
 APN 201-0730-087

US Home Corporation - Sacramento Division
 2366 Gold Meadow Way, Suite 200, Gold River, CA 95670 Phone (916) 858-3900 Fax (916) 858-3925

Plot Plan Associates www.plotplans.org
 PO Box 435 Citrus Heights CA 95611-0435 (916) 769-9063
 Date Drawn: 09/11/03 Scale: 1"=20'
 Date Revised: - Drawn By: BEB



Planning and Building Department
 Building Division

CITY OF SACRAMENTO
 CALIFORNIA

Downtown Permits Center
 1231 I Street, #200
 Sacramento, CA 95814-2998
 North Permits Center
 2101 Arena Blvd., Suite 200
 Sacramento, CA 95834

ADDRESS 341 PELICAN BAY CR PERMIT NO. 0314404

INSPECTION COMMENTS	PERMIT DOCUMENTS
3-1-04 B26 C/N JKB	
3-02-04 B17 AP [signature]	
3-23-04 B81/C.N K.L.C.	
4-2-04 GAS T.C.G. AP SA	
5/25/04 C/H Final T.N.G.	

FINAL APPROVALS	
BUILDING	<i>[signature]</i>
ELECTRICAL	
PLUMBING	
MECHANICAL	
FIRE	
SITE	

REINFORCED CONCRETE DAILY FIELD REPORT

POSTM-T COPY

YOUNGDAHL

CONSULTING GROUP INC.

1234 Glenhaven Court
El Dorado Hills, CA 95762
PH 916.933.0633
FX 916.933.6482

502 Giuseppe Court, Suite 2
Roseville, Ca 95678
PH 916.773.7633
FX 916.773.7833

Project Name: **HEAVY DUTY - NADMAS V-1-B** Project No: **03230-1**
 Project Location: **PALENA GAY + WHEATSTREET** NADMAS Date: **3-4-09**
 Unit #: **222564** Lot #: **222564** Contractor: **CVC**
 Client: **US HOMES** Weather: **WARM + CLEAR**
 Requested By: **RAY** Met With: _____ Copies To: _____

SCOPE OF WORK:	SUBJECT AREAS	STATUS OF PROJECT	SAMPLE AND TEST DATA
Concrete Placement Inspection <input type="checkbox"/>	Footings <input checked="" type="checkbox"/>	On-Going <input checked="" type="checkbox"/>	Concrete Mix #(s):
Concrete Testing Only <input type="checkbox"/>	Slab on Grade <input type="checkbox"/>	Complete <input type="checkbox"/>	Design Strength(s):
Rebar / Tendon Inspection <input type="checkbox"/>	Structural Slab or Deck <input type="checkbox"/>	Completed For This Phase <input type="checkbox"/>	Yards Placed
Tendon Stressing Inspection <input type="checkbox"/>	Slab or Metal Deck <input type="checkbox"/>	On Hold Due To: <input type="checkbox"/>	Cast: Set(s) of: Compression Test Cylinders Per: Cylinders Per:
Batch Plant Inspection <input type="checkbox"/>	Structural Member: <input type="checkbox"/>	Signed, Stamped, Daily <input type="checkbox"/>	Slump: _____
Backmeter Detection <input type="checkbox"/>	Cast In Place Walls <input type="checkbox"/>	Letter To Follow <input type="checkbox"/>	% Air: _____
Sample Reinforcing Steel <input type="checkbox"/>	Tilt Up Panels <input type="checkbox"/>		Sampled Rebar for Bend & Tensile Tests <input type="checkbox"/>
Proof Loading EPXY <input checked="" type="checkbox"/>	Curb and Gutter <input type="checkbox"/>		Rebar Grade: _____ Size(s): _____
Rebar 5/8" A/B <input type="checkbox"/>	Sidewalk or Driveway <input type="checkbox"/>	ATTACHED TO THIS REPORT	Other Tests: _____

NOTES:

AS REQUESTED APPLIED ON JOBSITE FOR PROOF-LOADING EPXY
 ALL REBAR IN EXISTING FOOTINGS. LOTS 22, 25 + 64
 ALL BOUTS LOADED TO 1" SIMPSON SET SPECIFICATIONS
 ALL BOUTS TESTED WERE 5/8" DIAMETER LOADED TO:
 3,400 PSI - PER GAUGE = 6,700 LBS AREA
 W/ 1" FT NO FAILURES

LOT 25 - TESTED 1/1 BACK-NORTHWARD 8' IN FROM WEST PERIM. W/ PHDS

LOT 22 - TESTED 2/5 1 - EAST WALL 2' IN FROM BACK N. WALL
 1 - BACK-NORTHWARD 12' IN FROM EAST PERIM. W/ PHDS

LOT 64 - TESTED 6/12 - ALL BACK-NORTHWARD WEST WALL - 4 W/ HT 22

* SEE RED PAINT INITIALS AT TEST LOCATIONS.

To The Building Official: Regarding Special Inspection

I hereby certify that the noted portions of the work at the above address which required periodic and/or continuous inspection, and which I was employed to inspect, were inspected and, in my opinion, and to the best of my knowledge, comply with the provisions of the approved plans and specifications, except as noted.

Note: The verb, "inspect" or "inspection" or "inspector", as used by Youngdahl and Associates, Inc., means observation and monitoring, and does not mean the right to control the contractors work

Field Rep (print): **AL CHAVIS** Signed: **AL CHAVIS** Reported To: _____
 ICBO#: **5208985** Page _____ of _____

NOTE: No guarantee or warranty of the contractor's work is made, expressed or implied.

CERTIFICATION OF INSULATION

ADDRESS OR TRACT US HOMES Heritage Park Carabita LOT # 25	SACRAMENTO BUILDING PRODUCTS <input checked="" type="checkbox"/> P.O. BOX 854, WEST SACRAMENTO, CA 95691 LIC. #202026 <input type="checkbox"/> 1309 MELODY ROAD, MARYSVILLE, CA 95901 LIC. #202026 <input type="checkbox"/> P.O. BOX 9651, FRESNO, CA 93793-9651 LIC. #202026 <input type="checkbox"/> P.O. BOX 1631, RENO, NV 89505 LIC. #10675 <input type="checkbox"/> 3326 A PONDEROSA WAY, LAS VEGAS, NV 89118 LIC. #10675 DATE INSULATION COMPLETED 5-21-04
---	---

WALLS			CEILINGS			FLOORS		
(SQUARE FEET)			(SQUARE FEET)			(SQUARE FEET)		
TYPE OF INSULATION			TYPE OF INSULATION			TYPE OF INSULATION		
MATERIAL FIBERGLASS			MATERIAL FIBERGLASS			MATERIAL FIBERGLASS		
FORM BATTS			FORM BATTS & BLOW			FORM BATTS		
MANUFACTURER'S PRODUCT I.D.			MANUFACTURER'S PRODUCT I.D.			MANUFACTURER'S PRODUCT I.D.		
MANUFACTURER			MANUFACTURER			MANUFACTURER		
CT	OC	JM	CT	OC	JM	CT	OC	JM
BAGS								
R - VALUE INSTALLED	APPLIED THICKNESS	R - VALUE INSTALLED	APPLIED THICKNESS	MIN. INSTALLED WEIGHT PER SQUARE FOOT	R - VALUE INSTALLED	APPLIED THICKNESS		
R 13	3 1/2 / 5 1/2	R38	14 3/4					
KNEE WALLS IF R-VALUE IS OTHER THAN WALLS ABOVE								
MATERIAL FIBERGLASS		FORM BATTS	R VALUE			MANUFACTURER		
						CT	OC	JM
AIR INFILTRATION SEALANT								
MATERIAL foam					MANUFACTURER HILTI		MANUFACTURER HANDY FOAM	

THIS IS TO CERTIFY THAT INSULATION AND/OR SEALANT HAS BEEN INSTALLED IN CONFORMANCE WITH APPLICABLE CODES, MATERIAL STANDARDS AND REGULATIONS.

SIGNATURE — INSULATION CONTRACTOR J.C.	TITLE MANAGER	DATE 5-21-04
SIGNATURE — GENERAL CONTRACTOR	TITLE	DATE
REMARKS		