

CITY OF SACRAMENTO  
1231 I Street, Sacramento, CA 95814

Permit No: 0109277  
Insp Area: 4

Site Address: 5078 DODSON LN SAC  
Parcel No: 225-1540-006 WESTBR 5 LOT 6

Sub-Type: NSFR  
Housing (Y/N): N

CONTRACTOR

ES HOME  
2366 GOLD MEADOW DR STE 100  
GOLD RIVER, CA 95670-77041

OWNER

ES HOME  
2366 GOLD MEADOW WY  
GOLD RIVER CA 95670

ARCHITECT

Nature of Work: MP 2732 1 STORY 9 ROOM SFR

**CONSTRUCTION LENDING AGENCY:** I hereby affirm under penalty of perjury that there is a construction lending agency for the performance of the work for which this permit is issued (Sec. 3097, Civ. C.)

Lender's Name \_\_\_\_\_ Lender's Address \_\_\_\_\_

**LICENSED CONTRACTORS DECLARATION:** I hereby affirm under penalty of perjury that I am licensed under provisions of Chapter 9 commencing with section 7000 of Division 8 of the Business and Professions Code and my license is in full force and effect.

License Class B License Number 451839 Date 8/7/01 Contractor Signature Don McCluskey

**OWNER-BUILDER DECLARATION:** I hereby affirm under penalty of perjury that I am exempt from the contractors License Law for the following reason (Sec. 7031.5, Business and Professions Code): any city or county which requires a permit to construct, alter, improve, demolish, or repair any structure, prior to its issuance, also requires the applicant for such permit to file a signed statement that he or she is licensed pursuant to the provisions of the Contractors License Law (Chapter 9 commencing with Section 7000) of Division 8 of the Business and Professions Code) or that he or she is exempt therefrom and the basis for the alleged exemption. Any violation of Section 7031.5 by any applicant for a permit subjects the applicant to a civil penalty of not more than five hundred dollars (\$500.00).

I, as a owner of the property, or my employees with wages as their sole compensation, will do the work, and the structure is not intended or offered for sale (Sec. 7044, Business and Professions Code). The Contractors License Law does not apply to an owner of property who builds or improves thereon, and who does such work himself or herself or through his/her own employees, provided that such improvements are not intended or offered for sale. If, however, the building or improvement is sold within one year of completion, the owner-builder will have the burden of proving that he/she did not build or improve for the purpose of sale.

I, as owner of the property, am exclusively contracting with licensed contractors to construct the project (Sec. 7044, Business and Professions Code). The Contractors License Law does not apply to an owner of property who builds or improves thereon, and who contracts for such projects with a contractor(s) licensed pursuant to the Contractors License Law.

I am exempt under Sec. \_\_\_\_\_ B & P. for this reason: \_\_\_\_\_  
Date \_\_\_\_\_ Owner Signature \_\_\_\_\_

**IN ISSUING THIS BUILDING PERMIT,** the applicant represents, and the city relies on the representation of the applicant, that the applicant verified all measurements and locations shown on the application or accompanying drawings and that the improvement to be constructed does not violate any law or private agreement relating to permissible or prohibited locations for such improvements. This building permit does not authorize any illegal location of any improvement or the violation of any private agreement relating to location of improvements.

I certify that I have read this application and state that all information is correct. I agree to comply with all city and county ordinances and state laws relating to building construction and hereby authorize representative(s) of this city to enter upon the abovementioned property for inspection purposes.

Date 8/7/01 Applicant Agent Signature Don McCluskey

**WORKER'S COMPENSATION DECLARATION:** I hereby affirm under penalty of perjury one of the following declarations:

I have and will maintain a certificate of consent to self-insure for workers' compensation as provided for by Section 3700 of the Labor Code, for the performance of work for which the permit is issued:

I have and will maintain workers' compensation insurance, as required by Section 3700 of the Labor Code, for the performance of the work for which this permit is issued. My workers' compensation insurance carrier and policy number are:

Carrier GOLD REPUBLIC INS. CO Policy Number MWC107468 00 Exp Date 11/01/2001

(This section need not be completed if the permit is for \$100 or less) I certify that in the performance of the work for which this permit is issued, I shall not employ any person in any manner so as to become subject to the workers' compensation laws of California and agree that if I should become subject to the workers' compensation provisions of Section 3700 of the Labor Code, I shall forthwith comply with these provisions.

Date 8/7/01 Applicant Signature Don McCluskey

**WARNING: FAILURE TO SECURE WORKER'S COMPENSATION COVERAGE IS UNLAWFUL AND SHALL SUBJECT AN EMPLOYER TO CRIMINAL PENALTIES AND CIVIL FINES UP TO ONE HUNDRED THOUSAND DOLLARS (\$100,000) IN ADDITION TO THE COST OF COMPENSATION DAMAGES AS PROVIDED FOR IN SECTION 3706 OF THE LABOR CODE, INTEREST AND ATTORNEY'S FEE.**

**THIS PERMIT SHALL EXPIRE BY LIMITATION IF WORK IS NOT COMMENCED WITHIN 180 DAYS.**

RESIDENTIAL SUBDIVISION BUILDING PERMIT APPLICATION

Project Address: 5078 Dodson Lane  
Lot Number: 6

Assessor Parcel # 225-1540-006  
Subdivision Westborough Village S

OWNER INFORMATION:

Legal Property Owner: US HOME Phone# 858-3900  
Owner Address 366 GOLD MEADOW WAY City GOLD RIVER State CA. Zip 95670

CONTRACTOR INFORMATION:

Contractor: US HOME Lic. # 451839 Phone # 858-3900 Fax 858-3925  
DON McCLOSKEY 719-9059

PROJECT INFORMATION:

Land Use Zone RIA Occupancy Group R3 Construction Type VN Fed Code 1A  
No. of Stories: 1 No. of Rooms: 9 Street Width: \_\_\_\_\_  
1<sup>st</sup> Floor Area 2732 2<sup>nd</sup> Floor Area \_\_\_\_\_ Basement \_\_\_\_\_ Roof Material \_\_\_\_\_  
AREA IN SQUARE FOOT OF:  
Dwelling/Living 2732  
Garage/Storage 660  
Decks/Balconies \_\_\_\_\_  
Carports \_\_\_\_\_  
SCOPE OF WORK: \_\_\_\_\_

FOR OFFICE USE ONLY

- Information Above Complete
- Violation Files Checked
- Standard Setbacks
- County Sewer
- AR Flood Waiver Required
- Flood Elevation Certificate Required
- Water Development Infill Area
- Planning Approval
- Design Review Approval
- Special Fee Districts Apply:

THE FOLLOWING MUST BE PROVIDED IN ORDER TO SUBMIT FOR PERMIT

- 2 COMPLETE PLOT PLANS, LEGIBLE & DRAWN TO SCALE
- 11 X 17 COPY OF FLOOR PLAN WITH FOLLOWING INFORMATION
  - a) Assessor's Parcel Number
  - b) New Floor Area
  - c) Owners Name
  - d) Project Address

0109277

# CERTIFICATION OF INSULATION

PART I GENERAL

ADDRESS OR TRACT <p style="font-size: 1.5em; margin: 0;">U.S. Home</p> <p style="margin: 0;">LOT # 6</p> <p style="font-size: 1.5em; margin: 0;">Westlake</p>	SACRAMENTO BUILDING PRODUCTS <input checked="" type="checkbox"/> P.O. BOX 854, WEST SACRAMENTO, CA 95691 LIC. #202026 <input type="checkbox"/> 1309 MELODY ROAD, MARYSVILLE, CA 95901 LIC. #202026 <input type="checkbox"/> P.O. BOX 9651, FRESNO, CA 93793-9651 LIC. #202026 <input type="checkbox"/> P.O. BOX 1631, RENO, NV 89505 LIC. #10675 <input type="checkbox"/> 3326 A PONDEROSA WAY, LAS VEGAS, NV 89118 LIC. #10675 DATE INSULATION COMPLETED
--	---

PART II AREAS INSULATED

WALLS			CEILING			FLOORS		
( SQUARE FEET)			( SQUARE FEET)			( SQUARE FEET)		
TYPE OF INSULATION			TYPE OF INSULATION			TYPE OF INSULATION		
MATERIAL FIBERGLASS			MATERIAL FIBERGLASS			MATERIAL FIBERGLASS		
FORM BATTS			FORM BATTS & BLOW			FORM BATTS		
MANUFACTURER'S PRODUCT I.D.			MANUFACTURER'S PRODUCT I.D.			MANUFACTURER'S PRODUCT I.D.		
MANUFACTURER			MANUFACTURER			MANUFACTURER		
CT	OC	JM	CT	OC	JM	CT	OC	JM
BAGS								
R-VALUE INSTALLED	APPLIED THICKNESS		R-VALUE INSTALLED	APPLIED THICKNESS	MIN. INSTALLED WEIGHT PER SQUARE FOOT	R-VALUE INSTALLED	APPLIED THICKNESS	
13	3 1/2		38	12"				
			38	14 3/4"				
KNEE WALLS IF R-VALUE IS OTHER THAN WALLS ABOVE								
MATERIAL FIBERGLASS		FORM	BATT		R-VALUE	MANUFACTURER		
						CT	OC	JM
AIR INFILTRATION SEALANT								
MATERIAL					MANUFACTURER			
Foam					HILTI		HANDY FOAM	

PART III CERTIFICATION

THIS IS TO CERTIFY THAT INSULATION AND/OR SEALANT HAS BEEN INSTALLED IN CONFORMANCE WITH APPLICABLE CODES, MATERIAL STANDARDS AND REGULATIONS.

SIGNATURE — INSULATION CONTRACTOR	TITLE	DATE
	MANAGER	9/30/02
SIGNATURE — GENERAL CONTRACTOR	TITLE	DATE
REMARKS		



# CAPITOL ENGINEERING LABORATORIES, INC.

631 Commerce Drive, Suite #200 • Roseville, California 95678 • (916) 780-2888

## JOB REPORT

PAGE: \_\_\_\_\_

PROJECT NAME: Maailun

FILE NO. \_\_\_\_\_

INSPECTOR: MARVIN TOL

DATE: 9/

PERSONS CONTACTED: ARMANDO

PERMIT # \_\_\_\_\_

REFERENCE DOCUMENTS: TCBO Report #4945

WEATHER \_\_\_\_\_

SERVICE PROVIDED: CONCRETE (INSP/SAMPLE ONLY/PU)  MASONRY  WELDING (SHOP/FIELD)

OTHER  Epoxy Anchors

pieces loaded all 5/8" Epoxy Anchors

in lots #6 4-5/8" #9 5-3/8" #60 6-5/8" #242 4-3/8"

without

COMPLIANCE OF WORK: Acceptable

ATTACHMENTS: \_\_\_\_\_

EQUIPMENT/SUPPLIES USED: Hydraulics

NEXT VISIT: \_\_\_\_\_

REMARKS: \_\_\_\_\_

REVIEWED BY: [Signature]

DATE: 9-5





This set of plans and specifications must be kept on the job at all times and it is unlawful to make any changes or alterations to the same without written permission from the Building Inspection Division.

The responsibility of this plan and specifications SHALL NOT be held to permit or cause the violation of any City Ordinance or State Law.

THIS PLOT PLAN IS NOT FOR SALES PURPOSES. THIS PLOT PLAN IS FOR THE PURPOSES OF INDICATING COMPLIANCE WITH ZONING SET BACKS, GENERAL DRAINAGE DIRECTION, AND APPROXIMATE UTILITY CONNECTION. ALL OTHER DATA SHOWN HEREON IS CONCEPTUAL. THIS PLOT PLAN DOES NOT REFLECT AS-BUILT CONDITIONS. RETAINMENT WALLS ARE OPTIONAL AND MAY OR MAY NOT BE CONSTRUCTED.

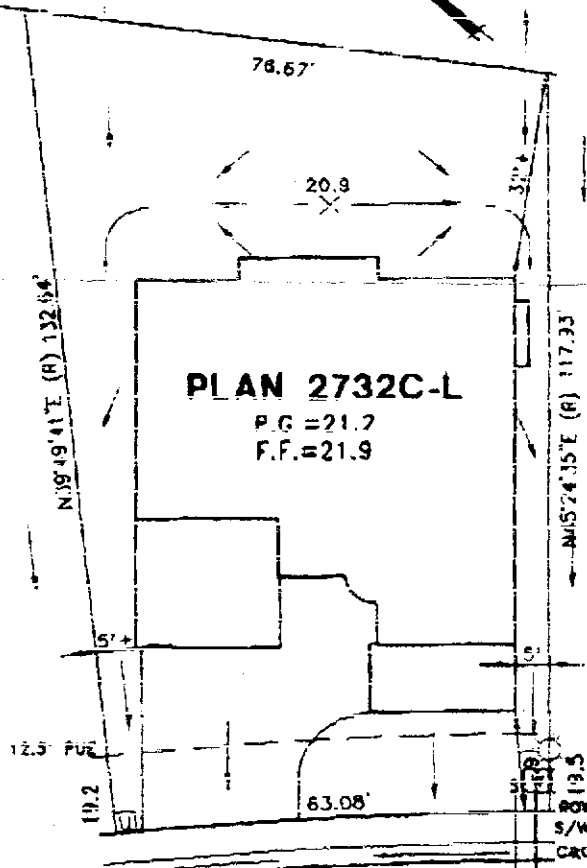
**PRELIMINARY**



-  = STREET LIGHT
-  = UTILITY SERVICE BOX

<b>LOT 08</b>			
WESTBOROUGH VILLAGE 6-1			
FOR			
U.S. HOMES			
CITY OF SACRAMENTO CALIFORNIA			
<b>WILLIAMS RODGERS INC.</b>			
ENGINEERING PLANNING MAPPING SURVEYING			
3301 O STREET, BLDG. 100-6, SACRAMENTO, CA 95814			
PHONE: (916) 486-1100 FAX: (916) 486-1100			
DATE:	DRAWN:	CHECKED:	PROJECT NO:
JUNE 2001	HMB		1122.032

E:\WORK\1515\BUDGET\1515\SPR\1515\1515\101\_06.DWG 06/29/01 10:11