

CITY OF SACRAMENTO

Permit No: 0002778

1231 I Street, Sacramento, CA 95814

Insp Area: 4

Site Address: 1473 MAYFIELD ST SAC

Sub-Type: NSFR

Parcel No: 225-1120-015

LOT 15 NORTHPT PK 14

Housing (Y/N): N

CONTRACTOR

OWNER

ARCHITECT

I ENNAR RENAISSANCE INC.
2240 DOUGLAS BL
ROSEVILLE CA. 95661

Nature of Work: NSFR MP202 1 STORY 9 RMS

CONSTRUCTION LENDING AGENCY : I hereby affirm under penalty of perjury that there is a construction lending agency for the performance of the work for which this permit is issued (Sec. 3097, Civ. C).

Lender's Name Lender's Address

LICENSED CONTRACTORS DECLARATION: I hereby affirm under penalty of perjury that I am licensed under provisions of Chapter 9 (commencing with section 7000) of Division 3 of the Business and Professions Code and my license is in full force and effect.

License Class B License Number 732348 Date 2/28/01 Contractor Signature [Signature]

OWNER-BUILDER DECLARATION: I hereby affirm under penalty of perjury that I am exempt from the contractors License Law for the following reason (Sec. 7031.5, Business and Professions Code; any city or county which requires a permit to construct, alter, improve, demolish, or repair any structure, prior to its issuance, also requires the applicant for such permit to file a signed statement that he or she is licensed pursuant to the provisions of the Contractors License Law (Chapter 9 (commencing with Section 7000) of Division 8 of the Business and Professions Code) or that he or she is exempt therefrom and the basis for the alleged exemption. Any violation of Section 7031.5 by any applicant for a permit subjects the applicant to a civil penalty of not more than five hundred dollars (\$500.00);

I, as a owner of the property, or my employees with wages as their sole compensation, will do the work, and the structure is not intended or offered for sale (Sec. 7044, Business and Professional Code: The Contractors License Law does not apply to an owner of property who builds or improves thereon, and who does such work himself or herself or through his/her own employees, provided that such improvements are not intended or offered for sale. If, however, the building or improvement is sold within one year of completion, the owner-builder will have the burden of proving that he/she did not build or improve for the purpose of sale.)

I, as owner of the property, am exclusively contracting with licensed contractors to construct the project (Sec. 7044, Business and Professions Code: The Contractors License Law does not apply to an owner of property who builds or improves thereon, and who contracts for such projects with a contractor(s) licensed pursuant to the Contractors License Law).

I am exempt under Sec. B & PC for this reason:

Date Owner Signature

IN ISSUING THIS BUILDING PERMIT, the applicant represents, and the city relies on the representation of the applicant, that the applicant verified all measurements and locations shown on the application or accompanying drawings and that the improvement to be constructed does not violate any law or private agreement relating to permissible or prohibited locations for such improvements. This building permit does not authorize any illegal location of any improvement or the violation of any private agreement relating to location of improvements.

I certify that I have read this application and state that all information is correct. I agree to comply with all city and county ordinances and state laws relating to building construction and hereby authorize representative(s) of this city to enter upon the above mentioned property for inspection purposes.

Date 5-9-00 Applicant/Agent Signature [Signature]

WORKER'S COMPENSATION DECLARATION: I hereby affirm under penalty of perjury one of the following declarations:

I have and will maintain a certificate of consent to self-insure for workers' compensation as provided for by Section 3700 of the Labor Code, for the performance of work for which the permit is issued.

X I have and will maintain workers' compensation insurance, as required by Section 3700 of the Labor Code, for the performance of the work for which this permit is issued. My workers' compensation insurance carrier and policy number are:

Carrier CONTINENTAL CAS. INC. Policy Number WC166792277 Exp Date 6/1/2000

(This section need not be completed if the permit is for \$100 or less) I certify that in the performance of the work for which this permit is issued, I shall not employ any person in any manner so as to become subject to the workers' compensation laws of California and agree that if I should become subject to the workers' compensation provisions of Section 3700 of the Labor Code I shall forthwith comply with those provisions.

Date 5-9-00 Applicant Signature [Signature]

WARNING FAILURE TO SECURE WORKER'S COMPENSATION COVERAGE IS UNLAWFUL AND SHALL SUBJECT AN EMPLOYER TO CRIMINAL PENALTIES AND CIVIL FINES UP TO ONE HUNDRED THOUSAND DOLLARS (\$100,000) IN ADDITION TO THE COST OF COMPENSATION. DAMAGES AS PROVIDED FOR IN SECTION 3706 OF THE LABOR CODE, INTEREST AND ATTORNEY'S FEE.

THIS PERMIT SHALL EXPIRE BY LIMITATION IF WORK IS NOT COMMENCED WITHIN 180 DAYS.

RESIDENTIAL BUILDING PERMIT APPLICATION

- New Construction     Addition     Remodels     Other

Project Address: 1473 MAYFIELD STREET Assessor Parcel # 225-112-015

OWNER INFORMATION:

Legal Property Owner: LENNAR RENAISSANCE Phone # (916) 773-7471  
 Owner Address: 2240 DOUGLAS BLVD. City ROSEVILLE State CA Zip 95661

CONTRACTOR INFORMATION:

Contractor: LENNAR RENAISSANCE Lic. # 732348 Phone # (916) 773-7471 Fax# (916) 773-4086

PROJECT INFORMATION:

Land Use Zone RA Occupancy Group R3 Construction Type VN Fed Code IA  
 No. of stories: 1 No. of rooms: \_\_\_\_\_ Street width: 40 FT  
 1<sup>st</sup> Floor Area 1803 2<sup>nd</sup> Floor Area \_\_\_\_\_ Basement N.A. Roof Material TILE

AREA IN SQUARE FOOT OF:	EXISTING	NEW
Dwelling/Living	<u>N/A</u>	<u>1803</u>
Garage/Storage	_____	<u>496</u>
Decks/Balconies	_____	<u>150</u>
Carports	_____	_____

SCOPE OF WORK: NEW CONSTRUCTION SFD

FOR OFFICE USE ONLY

- |   |   |  |
|---|---|--|
| <input type="checkbox"/> Information above complete | <input type="checkbox"/> AR Flood Waiver required             | <input type="checkbox"/> Planning Approval                   |
| <input type="checkbox"/> Violation files checked    | <input type="checkbox"/> Flood Elevation Certificate Required | <input type="checkbox"/> Design Review Approval              |
| <input type="checkbox"/> Standard setbacks          | <input type="checkbox"/> Water Development Infill Area        | <input type="checkbox"/> Special Fee Districts Apply : _____ |
| <input type="checkbox"/> County Sewer               |   |  |

NEW STRUCTURES & ADDITIONS

❖ THE FOLLOWING MUST BE PROVIDED IN ORDER TO SUBMIT FOR PLAN REVIEW

- |   |   |
|---|---|
| <input type="checkbox"/> 2 COMPLETE PLANS, LEGIBLE & DRAWN TO SCALE   | ❖ Plans to include: site plan, floor plan, elevations, roof/ceiling plan, foundation and structural framing details, and structural calculations for non-conforming structures. |
| <input type="checkbox"/> 3 SETS IF PROJECT IS IN A DESIGN REVIEW AREA |   |
| <input type="checkbox"/> Title 24 Energy Compliance documentation     | <input type="checkbox"/> 11" x 17" copy of floor plan for County Assessor   |
| <input type="checkbox"/> Grading and Erosion Control Questionnaire    | <input type="checkbox"/> Plan Review Fees   |

Date: \_\_\_\_\_ Received by: (staff) \_\_\_\_\_

ACTIVITY/PERMIT # \_\_\_\_\_

COUNTY SANITATION DISTRICT NO. 1  
 SACRAMENTO REGIONAL COUNTY SANITATION DISTRICT  
**SEWER IMPACT FEE** 4-27-00  
 PERMIT AND CALCULATION SHEET *Bob*

APPLICATION NO:  
 GENERAL INFORMATION

BUDG PERMIT NO: **CITY**

THIS PERMIT GOOD ONLY WHEN  
 VALIDATED BY THE CASHIER

258943

THIS PERMIT TO CONNECT EXPIRES  
 ONE YEAR FROM DATE OF ISSUANCE

FEE CALCULATION

BUILDING USE

INSPECTION	RESIDENTIAL	SF	MF	UNITS
CSD-1		473	<input checked="" type="checkbox"/>	
SRCS		2404		
CONSTRUCTION				
IN-LIEU				
<b>TOTAL FEE</b>		<b>2877</b>		

APN: 225-112-015

DESCRIPTION/  
 SUBDIVISION NORTHPOINTE PARK 14 LOT: 15

PROPERTY ADDRESS 1473 MAVETELD STREET

OWNER LENNAR RENAISSANCE

MAILING ADDRESS 2240 DOUGLAS BLVD

CITY-STATE-ZIP ROSEVILLE CA 95661 PHONE 773-7471

ADDITIONAL FEES MAY BE DUE IF CHANGES IN USE INCREASE SEWER IMPACT.

APPLICANT SIGNATURE

CONSOLIDATED UTILITY BILLING USE ONLY

ACCT \_\_\_\_\_ INPUT \_\_\_\_\_ START \_\_\_\_\_

INSPECTOR'S COPY

**Natomas Unified School District**  
 1515 Sports Drive, #1 • Sacramento, CA 95834-1905  
 Phone 916/641-3300 • Fax 916/928-1629

**CERTIFICATION OF COMPLIANCE**  
**SCHOOL DISTRICT DEVELOPMENT FEES**

PART I: TO BE COMPLETED BY APPLICANT			
Property Owner's Name	LENNAR RENAISSANCE		
Owner's Address	2240 DOUGLAS BLVD ROSEVILLE CA 95661		
Project Address	1473 MAYFIELD STREET		
Parcel Number	225-112-015 LOT 15		
Subdivision Name	NORTHPOINTE PARK UNIT 14		
Number of Units	ONE (1)		
Print Applicant's Name	DOUGLAS A. HORRELL	Applicant's Signature	<i>[Signature]</i>
Title of Applicant	PROCESSOR		
Date	3-11-00	Telephone Number	773-7471
PART II: TO BE COMPLETED BY BUILDING DEPARTMENT			
Plan Identification Number	0002175R		
Building Type (Check One)	<input checked="" type="checkbox"/> Residential <input type="checkbox"/> Apartment/Condominium <input type="checkbox"/> Commercial/Industrial		
Square Feet of Chargeable Building Area	1803		
Signature	<i>[Signature]</i>		
Title	Bldg Insp	Date	3/10/00
PART III: TO BE COMPLETED BY NATOMAS UNIFIED SCHOOL DISTRICT			
District Certification Number	00-1134		
Fees Collected:			
Residential:	1803	Sq. Ft. X \$ 3.25	= \$ 5,859.75
Apartment/Condominium:		Sq. Ft. X \$	= \$
Commercial/Industrial:		Sq. Ft. X \$	= \$
<b>NOTICE TO APPLICANT:</b> Pursuant to government code section 66020 (d), this will serve to notify you that the 90-day approval period in which you may protest the fees, or other payment identified above, will begin to run on the date in which the building or installation permit for this project is issued, or on which they are paid to the District, or to another public entity authorized to collect them on behalf of the District, whichever is earlier.			
Applicant Signature:	<i>[Signature]</i>		Date: 3-11-00

This certification covers only the amount of square footage indicated above. Any additions or corrections to the square footage for this project will require an amendment to the Certificate of Compliance.

As the authorize Natomas Unified School District official, I hereby certify that the requirements of Government Code Section 95995 have been complied with by the above signed applicant.

SIGNATURE: *[Signature]* DATE: 5/3/00  
 TITLE: *[Signature]*

# CERTIFICATION OF INSULATION

PART I GENERAL

ADDRESS OR TRACT

WINNCREST HOMES

LOT # 15

SACRAMENTO INSULATION CONTRACTORS

- P.O. BOX 854, WEST SACRAMENTO, CA 95691 LIC. #202026
- 1309 MELODY ROAD, MARYSVILLE, CA 95901 LIC. #202026
- P.O. BOX 9651, FRESNO, CA 93793-9651 LIC. #202026
- P.O. BOX 1631, RENO, NV 89505 LIC. #10675
- 3326 A PONDEROSA WAY, LAS VEGAS, NV 89118 LIC. #10675

DATE INSULATION COMPLETED

GLENMERE

PART II AREAS INSULATED

WALLS		CEILINGS			FLOORS	
( SQUARE FEET)		( SQUARE FEET)			( SQUARE FEET)	
TYPE OF INSULATION		TYPE OF INSULATION			TYPE OF INSULATION	
MATERIAL <b>FIBERGLASS</b>		MATERIAL <b>FIBERGLASS</b>			MATERIAL <b>FIBERGLASS</b>	
FORM <b>BATTS</b>		FORM <b>BATTS &amp; BLOW</b>			FORM <b>BATTS</b>	
MANUFACTURER'S PRODUCT I.D.		MANUFACTURER'S PRODUCT I.D.			MANUFACTURER'S PRODUCT I.D.	
MANUFACTURER		MANUFACTURER			MANUFACTURER	
<b>OCF</b>		<b>OCF</b>			<b>OCF</b>	
		BAGS				
R-VALUE INSTALLED	APPLIED THICKNESS	R-VALUE INSTALLED	APPLIED THICKNESS	MIN. INSTALLED WEIGHT PER SQUARE FOOT	R-VALUE INSTALLED	APPLIED THICKNESS
R-13	3 5/8"	R-38	1 3/4"			
KNEE WALLS IF R-VALUE IS OTHER THAN WALLS ABOVE						
MATERIAL <b>FIBERGLASS</b>		FORM <b>BATTS</b>		R VALUE		MANUFACTURER <b>OCF</b>

AIR INFILTRATION SEALANT	
MATERIAL <b>FOAM</b>	MANUFACTURER <b>W R GRACE</b>

THIS IS TO CERTIFY THAT INSULATION AND/OR SEALANT HAS BEEN INSTALLED IN CONFORMANCE WITH APPLICABLE CODES, MATERIAL STANDARDS AND REGULATIONS.

SIGNATURE - INSULATION CONTRACTOR 	TITLE MANAGER	DATE 11-3-00
SIGNATURE - GENERAL CONTRACTOR	TITLE	DATE

REMARKS

OCT. 24. 2000 5:10PM

NO. 7044 P. 2/2

LUMBER SPECIFICATIONS

SIZE	SPECIE GRADE	PANEL (S)
2x 4	TOP CHORDS:	1
2x 6	BOTTOM CHORDS:	1
2x 4	STAND	1-3

LOADING	IC UNIF LL (	32.0+0L (	20.0) -	80.0 PLF 0'	0' 7.0	7.0' VERT
	BC UNIF LL (	62.9+0L (	80.0) -	143.0 PLF 0'	0' 7.0	7.0' VERT

NOTE: REPAIR FOR SPLIT IN LOWER THIRD OF ENTIRE BOTTOM CHORD. ATTACH (1) 2X10 DF #2 AND-O-W TO FACE SUPPORTING B-3-B SPANS W/180 NAILS STAGGERED AT 6" OC THROUGHOUT 6 CLUSTERS IN AMOUNTS SHOWN IN ( ). DO NOT NAIL WITHIN 2" OF SPLIT.

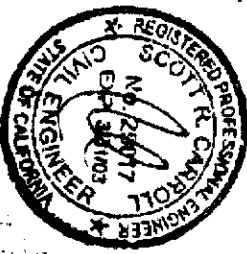
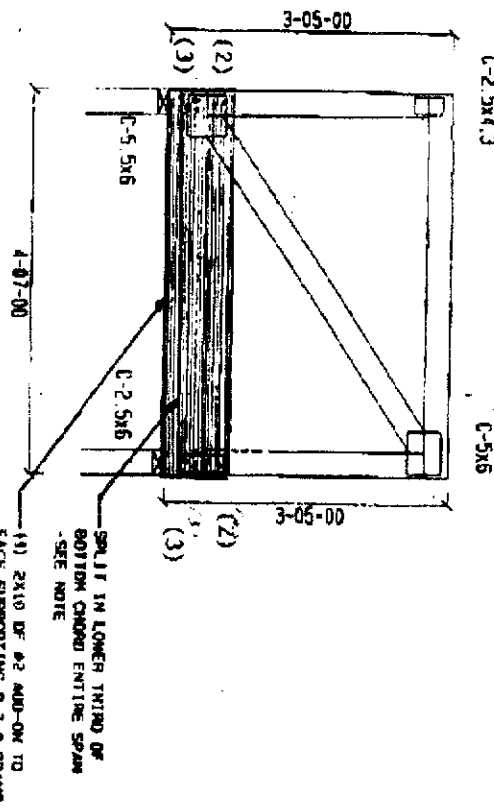

*Handwritten notes:*  
 1/2" = 1'-0"  
 Truss fix fee  
 1/2" = 1'-0"  
 1/2" = 1'-0"

DATE: 2/3/1998  
 DES. BY: AJ  
 SED: 286505  
 R-195023 R 10/24/00 BS

1. Read all General Notes and Working Notes, understand all features.
2. Under and overcut openings should be specified at all corners and
3. Working Notes, understand all features.
4. All dimensions, including those for framing, shall be given in feet and inches.
5. All framing members shall be specified by size, species, grade, and
6. All framing members shall be specified by size, species, grade, and
7. All framing members shall be specified by size, species, grade, and
8. All framing members shall be specified by size, species, grade, and
9. All framing members shall be specified by size, species, grade, and
10. All framing members shall be specified by size, species, grade, and

1. General Notes, Working Notes, and all other notes shall be read and understood by the contractor.
2. All framing members shall be specified by size, species, grade, and
3. All framing members shall be specified by size, species, grade, and
4. All framing members shall be specified by size, species, grade, and
5. All framing members shall be specified by size, species, grade, and
6. All framing members shall be specified by size, species, grade, and
7. All framing members shall be specified by size, species, grade, and
8. All framing members shall be specified by size, species, grade, and
9. All framing members shall be specified by size, species, grade, and
10. All framing members shall be specified by size, species, grade, and

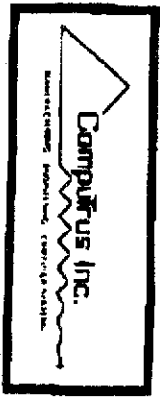

Antiter: 1.01 (11)

This Plot Plan is for the purpose of showing the house to be constructed on the lot and may not represent the final as-built configuration of the property or improvements thereon. Setbacks, other than minimum ordinance, are approximate only and must not be assumed to be precise.

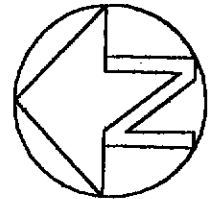

SCALE: 1" = 20'

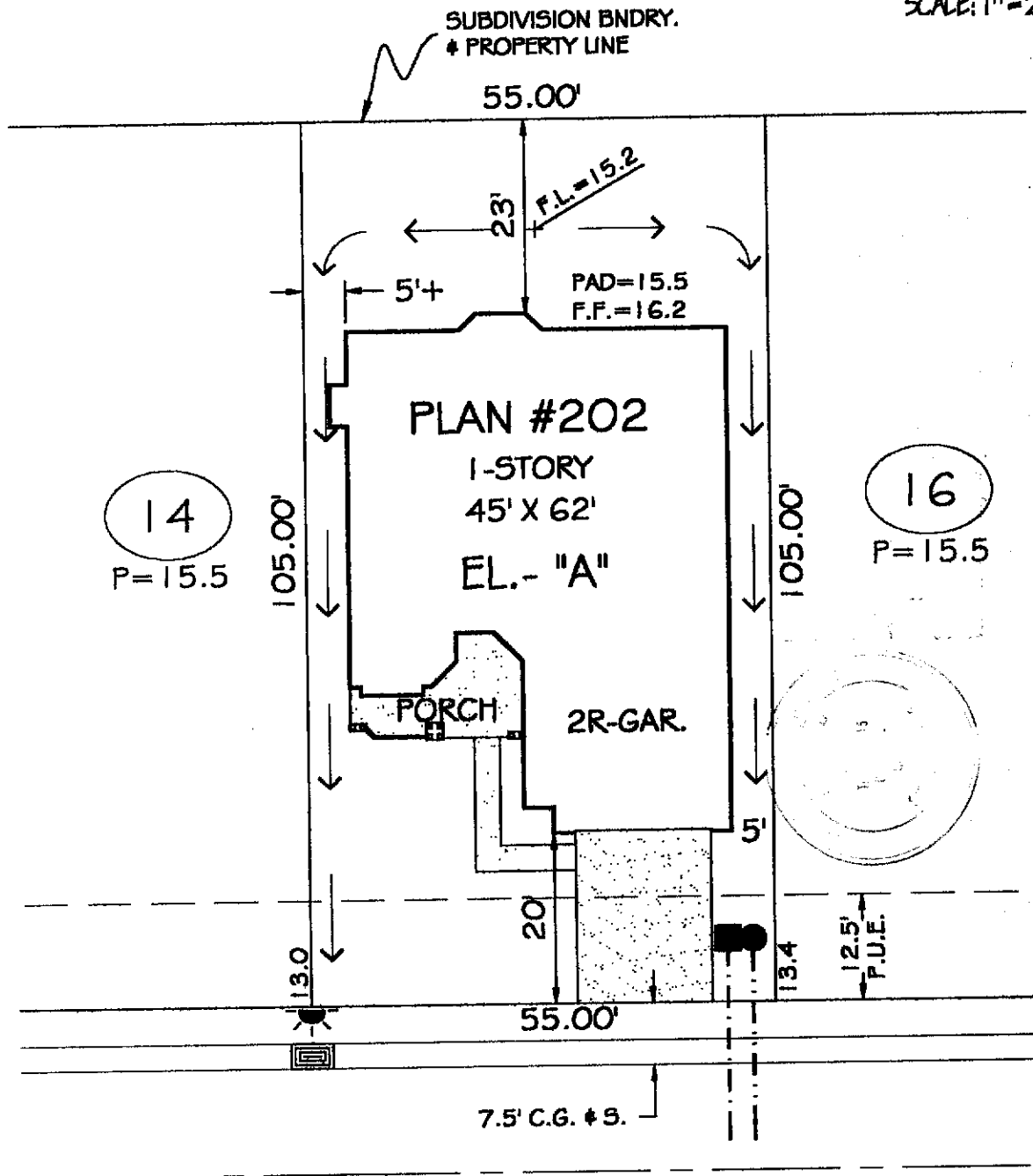

# 1473 MAYFIELD STREET

LOT COVERAGE	
Lot Area:	5775 s.f.
Building:	2299 s.f.
Building/ Lot Area:	40 %

RETAINING WALL	
Height:	_____
Length:	_____
Distance From P.L.:	_____

SYMBOLS	
Drainage Inlet:	
Fire Hydrant:	
Street Light:	
Sewer:	
Sign:	
Water:	
Transformer Pad:	



**Home Site #15**  
 @  
 NORTHPOINTE PARK VILLAGE No. 14  
 CITY OF SACRAMENTO, CALIFORNIA  
 A.P.N.: 225-112-015-000

**NOTES**  
 1. MEASUREMENTS ALONG CURVED LINES ARE ARC LENGTHS, U.O.N.

BCB	2/22/00	GRS	
DRAWN BY	DATE	CHKD BY	DATE

1" = 20'  
 DRWG SCALE