

CITY PLANNING COMMISSION

REPORT OF PLANNING DIRECTOR, R. L. RATHFON -----DECEMBER 17, 1963

PETITION TO REZONE

APPLICANT: Don P. Magee, 907-5th Street, Sacramento
OWNERS: Sierra Pacific Properties, Inc. 7215 Lindale Drive, Sacramento
PROPERTY: Lots 1 & 2 and portions of Lots 3, 46, 47 and 82 of South Land Park Hills Unit No. 31.

SIZE: Two lots and remnant portions of four other lots, with total area of approx 77.9 acres or 339,332 sq ft.

LOCATION: Riverside Blvd & 43rd Avenue

EXISTING USE: Vacant

PROPOSED USE: Multiple Family dwelling in connection with development of adjacent R-3 zoned properties, and abutting streets, proposed for abandonment, said streets being 43rd Avenue and Lake Glenn Way

EXISTING ZONING: R-1 One Family Zone

PROPOSED ZONING: R-3 Light Density Multiple Family Zone

REQUEST: Petition to rezone property in the R-1 Zone to R-3 Light Density Multiple Family Zone, to permit multiple family development.

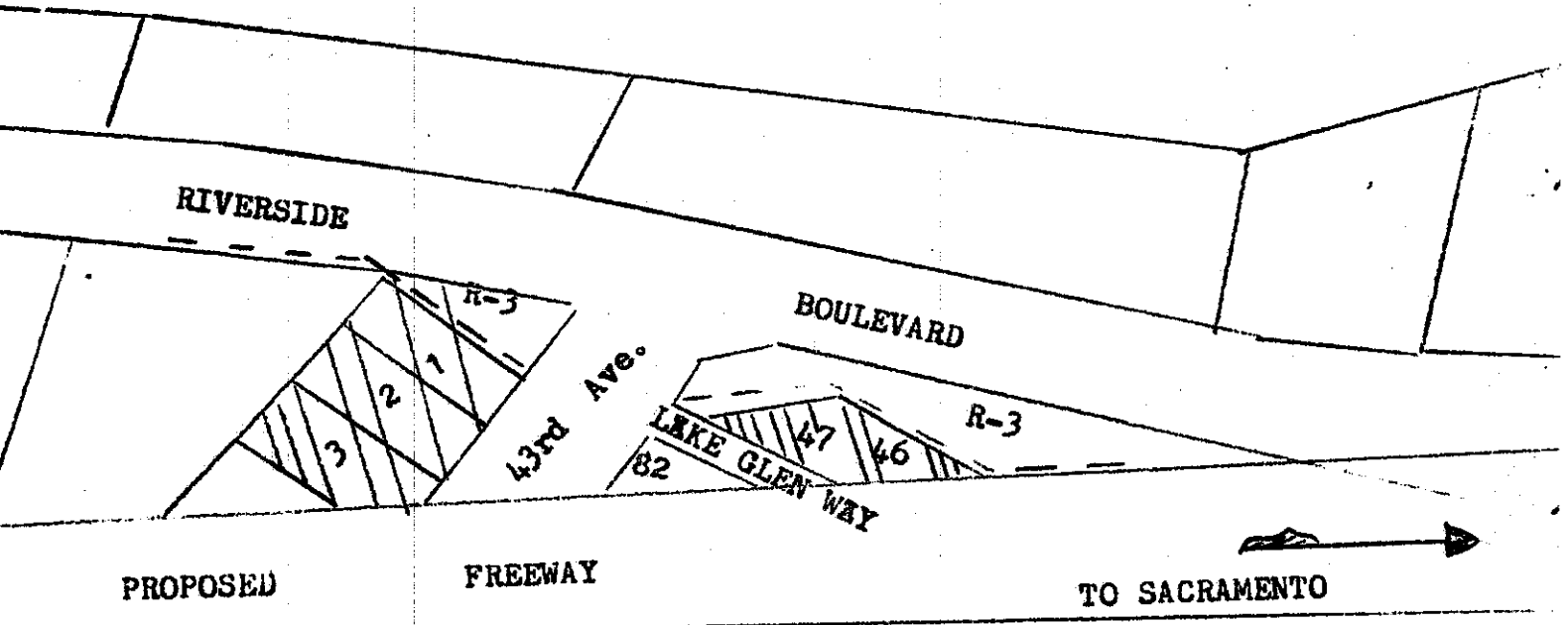

Item #****1
65- 16

South Land Park Hills #31

South Land Park Hills #30