

CITY OF SACRAMENTO
1231 I Street, Sacramento, CA 95814

Permit No: 9908909
Insp Area: 4

Site Address: 40 SHADY ARBOR CT SAC
Parcel No: 274-0490-061

Sub-Type: NSFR
CALIFORNIA GARDENS LOT 61 Housing (Y/N): N

CONTRACTOR
KAL EMAN & BROAD
5 NORTH SUNRISE AV #1012
ROSELILLE CA 95661

OWNER

ARCHITECT

Nature of Work: NEW HOME, MP1706, 8 ROOMS

CONSTRUCTION LENDING AGENCY : I hereby affirm under penalty of perjury that there is a construction lending agency for the performance of the work for which this permit is issued (Sec. 3097, Civ. C).

Lender's Name _____ Lender's Address _____

LICENSED CONTRACTORS DECLARATION: I hereby affirm under penalty of perjury that I am licensed under provisions of Chapter 9 (commencing with section 7000) of Division 3 of the Business and Professions Code and my license is in full force and effect.

License Class B License Number 20054722 Date 8/25/99 Contractor Signature N. Collins

OWNER-BUILDER DECLARATION: I hereby affirm under penalty of perjury that I am exempt from the contractors License Law for the following reason (Sec. 7031.5, Business and Professions Code: any city or county which requires a permit to construct, alter, improve, demolish, or repair any structure, prior to its issuance, also requires the applicant for such permit to file a signed statement that he or she is licensed pursuant to the provisions of the Contractors License Law (Chapter 9 (commencing with Section 7000) of Division 8 of the Business and Professions Code) or that he or she is exempt therefrom and the basis for the alleged exemption. Any violation of Section 7031.5 by any applicant for a permit subjects the applicant to a civil penalty of not more than five hundred dollars (\$500.00).

I, _____, as a owner of the property, or my employees with wages as their sole compensation, will do the work, and the structure is not intended or offered for sale (Sec. 7044, Business and Professional Code). The Contractors License Law does not apply to an owner of property who builds or improves thereon, and who does such work himself or herself or through his/her own employees, provided that such improvements are not intended or offered for sale. (I, however, the building or improvement is sold within one year of completion, the owner-builder will have the burden of proving that he/she did not build or improve for the purpose of sale.)

I, _____, as owner of the property, am exclusively contracting with licensed contractors to construct the project (Sec. 7044, Business and Professions Code). The Contractors License Law does not apply to an owner of property who builds or improves thereon, and who contracts for such projects with a contractor(s) licensed pursuant to the Contractors License Law.

I am exempt under Sec. _____ B & PC for this reason: _____

Date _____ Owner Signature _____

IN ISSUING THIS BUILDING PERMIT, the applicant represents, and the city relies on the representation of the applicant, that the applicant verified all measurements and locations shown on the application or accompanying drawings and that the improvement to be constructed does not violate any law or private agreement relating to permissible or prohibited locations for such improvements. This building permit does not authorize any illegal location of any improvement or the violation of any private agreement relating to location of improvements.

I certify that I have read this application and state that all information is correct. I agree to comply with all city and county ordinances and state laws relating to building construction and hereby authorize representative(s) of this city to enter upon the abovementioned property for inspection purposes.

Date 8/25/99 Applicant Agent Signature N. Collins

WORKER'S COMPENSATION DECLARATION: I hereby affirm under penalty of perjury one of the following declarations:
I have and will maintain a certificate of consent to self-insure for workers' compensation as provided for by Section 3700 of the Labor Code, for the performance of work for which the permit is issued.

I have and will maintain workers' compensation insurance, as required by Section 3700 of the Labor Code, for the performance of the work for which this permit is issued. My workers' compensation insurance carrier and policy number are:

Carrier CCC Policy Number WC1888999094 Exp Date 04-30-01

This section need not be completed if the permit is for \$100 or less. I certify that in the performance of the work for which this permit is issued, I shall not employ any person in any manner so as to become subject to the workers' compensation laws of California and agree that if I should become subject to the workers' compensation provisions of Section 3700 of the Labor Code, I shall forthwith comply with those provisions.

Date 8/25/99 Applicant Signature N. Collins

WARNING - FAILURE TO SECURE WORKER'S COMPENSATION COVERAGE IS UNLAWFUL AND SHALL SUBJECT AN EMPLOYER TO CRIMINAL PENALTIES AND CIVIL FINES UP TO ONE HUNDRED THOUSAND DOLLARS (\$100,000) IN ADDITION TO THE COST OF COMPENSATION, DAMAGES AS PROVIDED FOR IN SECTION 3706 OF THE LABOR CODE, INTEREST AND ATTORNEY'S FEE.

THIS PERMIT SHALL EXPIRE BY LIMITATION IF WORK IS NOT COMMENCED WITHIN 180 DAYS.

Field Details

for

Alt. Blocking at Detail 16 on S4

CA Gardens (Natomas West)

City of Sacramento, California

for

Kaufman & Broad, North Bay

611 Orange Drive

Vacaville, CA, 95687

Phone: (707)469-2400 Fax: (707)469-2401

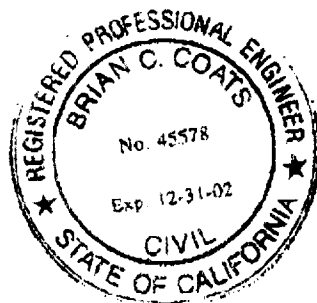

Brian C Coats, C45578, Exp. 12-31-02

Per a request for an alternate field built block detail to replace the shop made blocks shown in detail 16/S4.

& Associates, Inc. 171 Coleman Ave, Suite 200, San Jose, California 95110 Phone: (408)293-0813 Fax: (408)293-0890

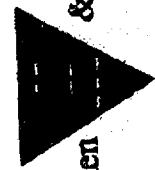

Chien

CA Gardens Plan I

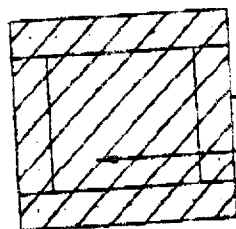

3/8" CDX W/ 2x4 AT 6" O.C. AT ALL EDGES

SHEAR BLOCK W/ 4 BOUNDARY MEMBERS

Alt. Block Detail

(2) A35, EA END OF EA BLOCK OFF-SET AT TRUSS

PRE-FAB TRUSS BLOCKING (LAT. = 360°/BLK)

ROOF CDX

U.O.N 2x4 @ 6" O.C.

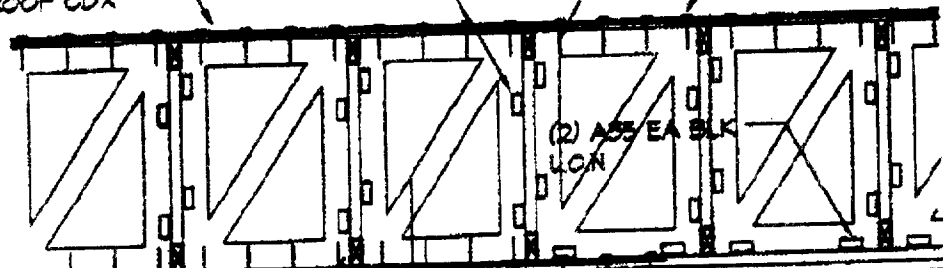

ROOF TRUSS AT 24" O.C.

2x4 @ 6" O.C. IN EA CS16

CS16 STRAP(S) PER PLAN

SHEAR WALL PER PLAN

SEE PLAN

30" (USE EVERY OTHER NAIL HOLE)

14" (USE ALL NAIL HOLES)

LOCATION AWAY FROM WALL

WALL LOCATION

2x BLK'S W/ 3-16d EA BLK WHEN 2-CS16 USED

SECTION A

DETAIL 505-10

16 / 54

CA Gardens Plan 1

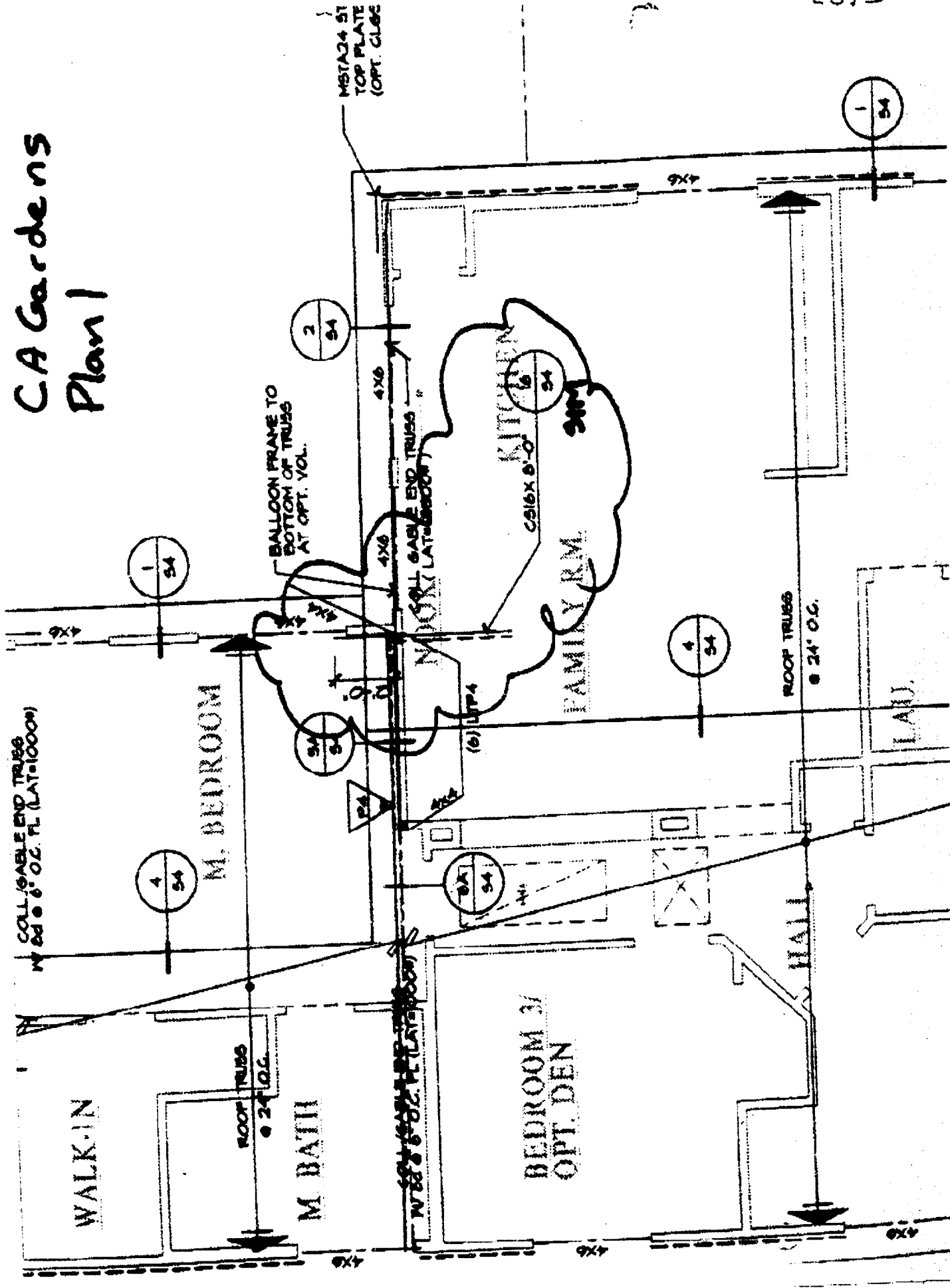

RESIDENTIAL BUILDING PERMIT APPLICATION

- New Construction
 Addition
 Remodels
 Other

Project Address: 40 SHADY ARBOR CT Assessor Parcel # 274-0490-061

OWNER INFORMATION: LOT 65 NATOMAS WEST

Legal Property Owner: _____	Phone # _____
Owner Address: _____	City _____ State _____ Zip _____

CONTRACTOR INFORMATION:

Contractor: _____	Lic. # _____	Phone # _____	Fax# _____
-------------------	--------------	---------------	------------

PROJECT INFORMATION:

Land Use Zone _____	Occupancy Group _____	Construction Type _____	Fed Code _____
No. of stories: _____	No. of rooms: _____	Street width: _____	
1 st Floor Area _____	2 nd Floor Area _____	Basement _____	Roof Material _____

AREA IN SQUARE FOOT OF:	EXISTING	NEW
Dwelling/Living	_____	1700
Garage/Storage	_____	436
Decks/Balconies	_____	_____
Carports	_____	_____

SCOPE OF WORK: _____

FOR OFFICE USE ONLY

- | | | |
|---|---|--|
| <input type="checkbox"/> Information above complete | <input type="checkbox"/> AR Flood Waiver required | <input type="checkbox"/> Planning Approval |
| <input type="checkbox"/> Violation files checked | <input type="checkbox"/> Flood Elevation Certificate Required | <input type="checkbox"/> Design Review Approval |
| <input type="checkbox"/> Standard setbacks | <input type="checkbox"/> Water Development Infill Area | <input type="checkbox"/> Special Fee Districts Apply : _____ |
| <input type="checkbox"/> County Sewer | | |

NEW STRUCTURES & ADDITIONS

❖ THE FOLLOWING MUST BE PROVIDED IN ORDER TO SUBMIT FOR PLAN REVIEW

- | | |
|---|---|
| <input type="checkbox"/> 2 COMPLETE PLANS, LEGIBLE & DRAWN TO SCALE
<input type="checkbox"/> 3 SETS IF PROJECT IS IN A DESIGN REVIEW AREA

<input type="checkbox"/> Title 24 Energy Compliance documentation
<input type="checkbox"/> Grading and Erosion Control Questionnaire | ❖ Plans to include: site plan, floor plan, elevations, roof/ceiling plan, foundation and structural framing details, and structural calculations for non-conforming structures.

<input type="checkbox"/> 11" x 17" copy of floor plan for County Assessor
<input type="checkbox"/> Plan Review Fees |
|---|---|

Date: _____ Received by: (staff) _____

ACTIVITY/PERMIT #
