

CITY OF SACRAMENTO
1231 I Street, Sacramento, CA 95814

Permit No: 0010067
Insp Area: 4

Site Address: 71 ARUBA CR SAC
Parcel No: 117-1340-041
N

REGENCY PLACE UNIT 2 LOT 41

Sub-Type: NSFR
Housing (Y/N):

CONTRACTOR
BEATTIE CONSTRUCTION
P.O. BOX 77768
STOCKTON CA 95267

OWNER

ARCHITECT

Nature of Work: MP 1650 1 STORY 7 ROOM SFR

CONSTRUCTION LENDING AGENCY: I hereby affirm under penalty of perjury that there is a construction lending agency for the performance of the work for which this permit is issued (Sec. 3097, Civ. C).

Lender's Name _____ Lender's Address _____

LICENSED CONTRACTORS DECLARATION: I hereby affirm under penalty of perjury that I am licensed under provisions of Chapter 9 (commencing with section 7000) of Division 3 of the Business and Professions Code and my license is in full force and effect.

License Class B License Number 75254 Date 9-11-00 Contractor Signature Charles W. Beattie

OWNER-BUILDER DECLARATION: I hereby affirm under penalty of perjury that I am exempt from the contractors License Law for the following reason (Sec. 7031.5, Business and Professions Code: any city or county which requires a permit to construct, alter, improve, demolish, or repair any structure, prior to its issuance, also requires the applicant for such permit to file a signed statement that he or she is licensed pursuant to the provisions of the Contractors License Law (Chapter 9 (commencing with Section 7000) of Division 8 of the Business and Professions Code) or that he or she is exempt therefrom and the basis for the alleged exemption. Any violation of Section 7031.5 by any applicant for a permit subjects the applicant to a civil penalty of not more than five hundred dollars (\$500.00).

I, as a owner of the property, or my employees with wages as their sole compensation, will do the work, and the structure is not intended or offered for sale (Sec. 7044, Business and Professional Code: The Contractors License Law does not apply to an owner of property who builds or improves thereon, and who does such work himself or herself or through his/her own employees, provided that such improvements are not intended or offered for sale. If, however, the building or improvement is sold within one year of completion, the owner-builder will have the burden of proving that he/she did not build or improve for the purpose of sale.)

I, as owner of the property, am exclusively contracting with licensed contractors to construct the project (Sec. 7044, Business and Professions Code: The Contractors License Law does not apply to an owner of property who builds or improves thereon, and who contracts for such projects with a contractor(s) licensed pursuant to the Contractors License Law).

I am exempt under Sec. _____ B & PC for this reason: _____
Date _____ Owner Signature _____

IN ISSUING THIS BUILDING PERMIT, the applicant represents, and the city relies on the representation of the applicant, that the applicant verified all measurements and locations shown on the application or accompanying drawings and that the improvement to be constructed does not violate any law or private agreement relating to permissible or prohibited locations for such improvements. This building permit does not authorize any illegal location of any improvement or the violation of any private agreement relating to location of improvements.

I certify that I have read this application and state that all information is correct. I agree to comply with all city and county ordinances and state laws relating to building construction and hereby authorize representative(s) of this city to enter upon the abovementioned property for inspection purposes.

Date 9-11-00 Applicant/Agent Signature Charles W. Beattie

WORKER'S COMPENSATION DECLARATION: I hereby affirm under penalty of perjury one of the following declarations:

I have and will maintain a certificate of consent to self-insure for workers' compensation as provided for by Section 3700 of the Labor Code, for the performance of work for which the permit is issued.

I have and will maintain workers' compensation insurance, as required by Section 3700 of the Labor Code, for the performance of the work for which this permit is issued. My workers' compensation insurance carrier and policy number are:

Carrier

PAID
CITY OF SACRAMENTO

Exp Date

(This section need not be completed if the permit is for \$100 or less) I certify that in the performance of the work for which this permit is issued, I shall not employ any person in any manner so as to become subject to the workers' compensation laws of California and agree that if I should become subject to the workers' compensation provisions of Section 3700 of the Labor Code, I shall forthwith comply with those provisions.

Date 9-11-00 Applicant Signature Charles W. Beattie

WARNING: FAILURE TO SECURE WORKER'S COMPENSATION COVERAGE IS UNLAWFUL AND SHALL SUBJECT AN EMPLOYER TO CRIMINAL PENALTIES AND CIVIL FINES UP TO ONE HUNDRED THOUSAND DOLLARS (\$100,000) IN ADDITION TO THE COST OF COMPENSATION, DAMAGES AS PROVIDED FOR IN SECTION 3706 OF THE LABOR CODE, INTEREST AND ATTORNEY'S FEE.

THIS PERMIT SHALL EXPIRE BY LIMITATION IF WORK IS NOT COMMENCED WITHIN 180 DAYS.

COUNTY SANITATION DISTRICT NO. 1
 SACRAMENTO REGIONAL COUNTY SANITATION DISTRICT
SEWER IMPACT FEE ⁹⁻¹¹⁻⁰⁰
 PERMIT AND CALCULATION SHEET ^{Bob}

APPLICATION NO:		BLDG PERMIT NO: <u>CCTV</u>	
GENERAL INFORMATION		THIS PERMIT GOOD ONLY WHEN VALIDATED BY THE CASHIER <u>Bob 9-11-00</u> <u>262859</u> THIS PERMIT TO CONNECT EXPIRES ONE YEAR FROM DATE OF ISSUANCE	
FEE CALCULATION		BUILDING USE	
INSPECTION		RESIDENTIAL SF <input checked="" type="checkbox"/>	MF <input type="checkbox"/>
CSD-1	<u>473-</u>	COMMERCIAL USE	UNITS
SRCSD	<u>2404-</u>		
CONSTRUCTION			
IN-LIEU			
TOTAL FEE	<u>2877-</u>		
APN: <u>117-1340-041</u>			
DESCRIPTION/ SUBDIVISION <u>REGENCY PLACE No 2</u> LOT: <u>41</u>			
PROPERTY ADDRESS <u>71 ARUBA CIR., SACRAMENTO</u>			
OWNER <u>REGENCY PLACE PARTNERS</u>			
MAILING ADDRESS <u>P.O. Box 77768</u>			
CITY-STATE-ZIP <u>STOCKTON, CA, 95267</u> PHONE <u>(416) 681-0457</u>			
ADDITIONAL FEES MAY BE DUE IF CHANGES IN USE INCREASE SEWER IMPACT.			
APPLICANT SIGNATURE <u>Charles M. Beattie</u>			
CONSOLIDATED UTILITY BILLING USE ONLY			
ACCT _____ INPUT _____ START _____			

INSPECTOR'S COPY

INSULATION CERTIFICATE

THIS IS TO CERTIFY THAT INSULATION HAS BEEN INSTALLED IN CONFORMANCE WITH THE CURRENT ENERGY REGULATIONS, CALIFORNIA ADMINISTRATION CODE, TITLE 24, STATE OF CALIFORNIA, IN THE BUILDING LOCATED AT:

SITE ADDRESS: LOT 41 REGENCY PLACE SACRAMENTO, CA
NUMBER STREET CITY STATE

CEILINGS:

BLOW: MANUFACTURER GREENSTONE THICKNESS 10.3" R-VALUE 38
SQUARE FEET 1690 # BAGS/LBS PER BAGS 67

BATTS: MANUFACTURER JOHNS MANVILLE THICKNESS 13" R-VALUE 38
JOHNS MANVILLE

EXTERIOR WALLS:

MANUFACTURER JOHNS MANVILLE THICKNESS 3.5" R-VALUE 13
JOHNS MANVILLE

FLOOR INSULATION:

MANUFACTURER JOHNS MANVILLE THICKNESS N/A R-VALUE N/A

AIR INFILTRATION:

(TITLE 24)
YES XX NO _____

OTHER:

GENERAL CONTRACTOR: WESTERN RETIREMENT COMM LICENSE # _____

BY: _____ TITLE _____ DATE _____

INSULATION CONTRACTOR: WESTERN INSULATION, INC. LICENSE # 481278

BY: Jamie Blair TITLE _____ AUTH. AGENT _____ DATE 1/15/01
JAMIE BLAIR

**REGENCY PLACE
UNIT # 2**

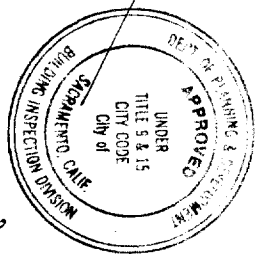
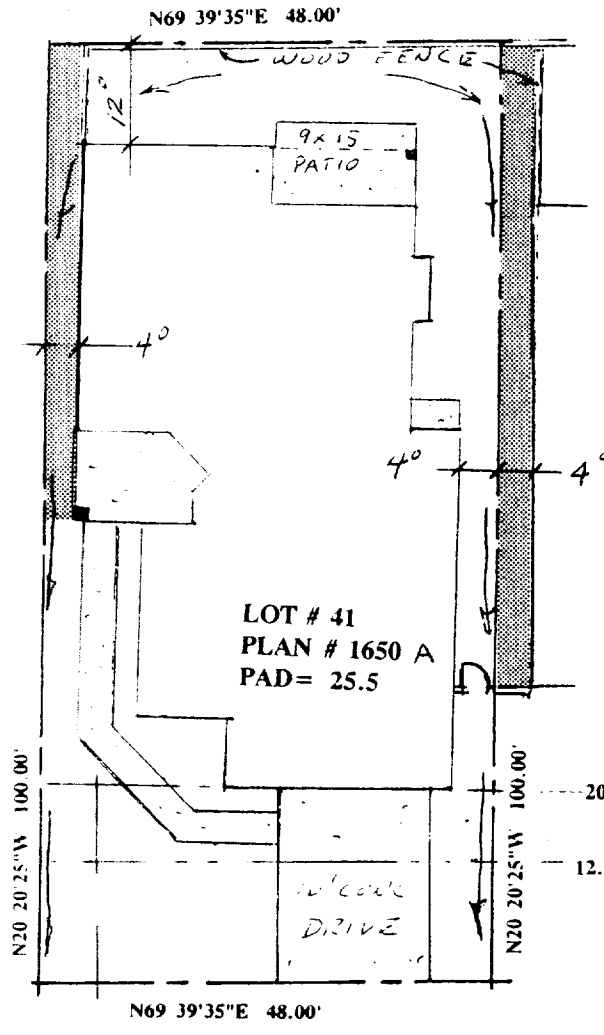

It is the policy of the City of Stockton to make any changes to the same without written approval of the Building Inspection Division. The approval of this plan and specification SHALL NOT be held to permit or approve the violation of any City Ordinance or State Law.

71 ARUBA CIRCLE
SCALE 1" = 20'

WESTERN RETIREMENT COMMUNITIES INC.
P.O. BOX 77768
STOCKTON, CA 95267
PHONE (916) 681-0457