

RESOLUTION NO. 2004-445

ADOPTED BY THE SACRAMENTO CITY COUNCIL

ON DATE OF JUN 08 2004

**RESOLUTION TO AMEND THE SOUTH NATOMAS COMMUNITY PLAN
LAND DESIGNATION FOR 1.05± VACANT ACRES FROM MEDIUM DENSITY
RESIDENTIAL (7-15 DU/NA) TO HIGH DENSITY RESIDENTIAL (21-29
DU/NA) FOR PROPERTY LOCATED AT 2350 NORTHVIEW DRIVE.**

(APNs: 274-0232-012) (P03-051)

WHEREAS, the Planning Commission conducted a public hearing on March 25, 2004, and the City Council conducted a public hearing on June 8, 2004 concerning the above plan amendment and based documentary and oral evidence submitted at the public hearing, the Council hereby finds:

1. The proposed land use amendment is compatible with the surrounding land uses;
2. The subject site is suitable for High Density (21-29 du/na) residential development;
3. The proposal is consistent with the policies of the South Natomas Community Plan and the General Plan.

NOW, THEREFORE BE IT RESOLVED by the City Council of the City of Sacramento that:

- A. The 1.05± acre area described on the attached Exhibit A is hereby designated on the South Natomas Community Plan land use map as High Density Residential (21-29 du/na).

MAYOR

ATTEST:

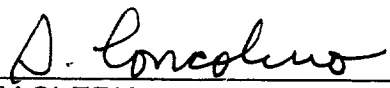
CITY CLERK

P03-051

FOR CITY CLERK USE ONLY

RESOLUTION NO.: 2004-445

DATE ADOPTED: JUN 08 2004

EXHIBIT A- Community Plan Amendment Exhibit

NEIGHBORING COMMUNITY PLAN SUMMARY

PARCEL LABEL	COMMUNITY PLAN LAND USE	DENSITY (ZONING)
1	Residential T-18 du/na	21 (R-28)
2	Residential T-18 du/na	21 (R-28)
3	Residential T-18 du/na	21 (R-28)
4	Residential T-18 du/na	21 (R-28)
5	Residential T-18 du/na	21 (R-28)
6	Residential T-18 du/na	21 (R-28)
7	Residential T-18 du/na	21 (R-28)
8	Residential T-18 du/na	21 (R-28)
9	Residential T-18 du/na	21 (R-28)
10	Residential T-18 du/na	21 (R-28)
11	Residential T-18 du/na	21 (R-28)
12	Residential T-18 du/na	21 (R-28)
13	Residential T-18 du/na	21 (R-28)
14	Residential T-18 du/na	21 (R-28)
15	Residential T-18 du/na	21 (R-28)
16	Residential T-18 du/na	21 (R-28)
17	Residential T-18 du/na	21 (R-28)
18	Residential T-18 du/na	21 (R-28)
19	Residential T-18 du/na	21 (R-28)
20	Residential T-18 du/na	21 (R-28)
21	Residential T-18 du/na	21 (R-28)
22	Residential T-18 du/na	21 (R-28)
23	Residential T-18 du/na	21 (R-28)
24	Residential T-18 du/na	21 (R-28)
25	Residential T-18 du/na	21 (R-28)
26	Residential T-18 du/na	21 (R-28)
27	Residential T-18 du/na	21 (R-28)
28	Residential T-18 du/na	21 (R-28)
29	Residential T-18 du/na	21 (R-28)
30	Residential T-18 du/na	21 (R-28)
31	Residential T-18 du/na	21 (R-28)
32	Residential T-18 du/na	21 (R-28)
33	Residential T-18 du/na	21 (R-28)
34	Residential T-18 du/na	21 (R-28)
35	Residential T-18 du/na	21 (R-28)
36	Residential T-18 du/na	21 (R-28)
37	Residential T-18 du/na	21 (R-28)
38	Residential T-18 du/na	21 (R-28)
39	Residential T-18 du/na	21 (R-28)
40	Residential T-18 du/na	21 (R-28)
41	Residential T-18 du/na	21 (R-28)
42	Residential T-18 du/na	21 (R-28)
43	Residential T-18 du/na	21 (R-28)
44	Residential T-18 du/na	21 (R-28)
45	Residential T-18 du/na	21 (R-28)
46	Residential T-18 du/na	21 (R-28)
47	Residential T-18 du/na	21 (R-28)
48	Residential T-18 du/na	21 (R-28)
49	Residential T-18 du/na	21 (R-28)
50	Residential T-18 du/na	21 (R-28)
51	Residential T-18 du/na	21 (R-28)
52	Residential T-18 du/na	21 (R-28)
53	Residential T-18 du/na	21 (R-28)
54	Residential T-18 du/na	21 (R-28)
55	Residential T-18 du/na	21 (R-28)
56	Residential T-18 du/na	21 (R-28)
57	Residential T-18 du/na	21 (R-28)
58	Residential T-18 du/na	21 (R-28)
59	Residential T-18 du/na	21 (R-28)
60	Residential T-18 du/na	21 (R-28)
61	Residential T-18 du/na	21 (R-28)
62	Residential T-18 du/na	21 (R-28)
63	Residential T-18 du/na	21 (R-28)
64	Residential T-18 du/na	21 (R-28)
65	Residential T-18 du/na	21 (R-28)
66	Residential T-18 du/na	21 (R-28)
67	Residential T-18 du/na	21 (R-28)
68	Residential T-18 du/na	21 (R-28)
69	Residential T-18 du/na	21 (R-28)
70	Residential T-18 du/na	21 (R-28)
71	Residential T-18 du/na	21 (R-28)
72	Residential T-18 du/na	21 (R-28)
73	Residential T-18 du/na	21 (R-28)
74	Residential T-18 du/na	21 (R-28)
75	Residential T-18 du/na	21 (R-28)
76	Residential T-18 du/na	21 (R-28)
77	Residential T-18 du/na	21 (R-28)
78	Residential T-18 du/na	21 (R-28)
79	Residential T-18 du/na	21 (R-28)
80	Residential T-18 du/na	21 (R-28)
81	Residential T-18 du/na	21 (R-28)
82	Residential T-18 du/na	21 (R-28)
83	Residential T-18 du/na	21 (R-28)
84	Residential T-18 du/na	21 (R-28)
85	Residential T-18 du/na	21 (R-28)
86	Residential T-18 du/na	21 (R-28)
87	Residential T-18 du/na	21 (R-28)
88	Residential T-18 du/na	21 (R-28)
89	Residential T-18 du/na	21 (R-28)
90	Residential T-18 du/na	21 (R-28)
91	Residential T-18 du/na	21 (R-28)
92	Residential T-18 du/na	21 (R-28)
93	Residential T-18 du/na	21 (R-28)
94	Residential T-18 du/na	21 (R-28)
95	Residential T-18 du/na	21 (R-28)
96	Residential T-18 du/na	21 (R-28)
97	Residential T-18 du/na	21 (R-28)
98	Residential T-18 du/na	21 (R-28)
99	Residential T-18 du/na	21 (R-28)
100	Residential T-18 du/na	21 (R-28)

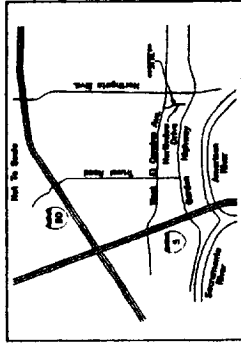

VICINITY MAP



TOM HALASZYSKI ARCHITECT
20 ISABELLA LANE, PLEASANT HILL, CA 94523
(925)978-1142

PROPOSED CHANGE
COMMUNITY PLAN LAND USE: Residential T-18 du/na
ZONING DENSITY (ZONING): 21 (R-28)
CURRENT COMMUNITY PLAN LAND USE: Residential T-18 du/na
PROPOSED COMMUNITY PLAN LAND USE: Residential T-18 du/na
13 du/na (max)

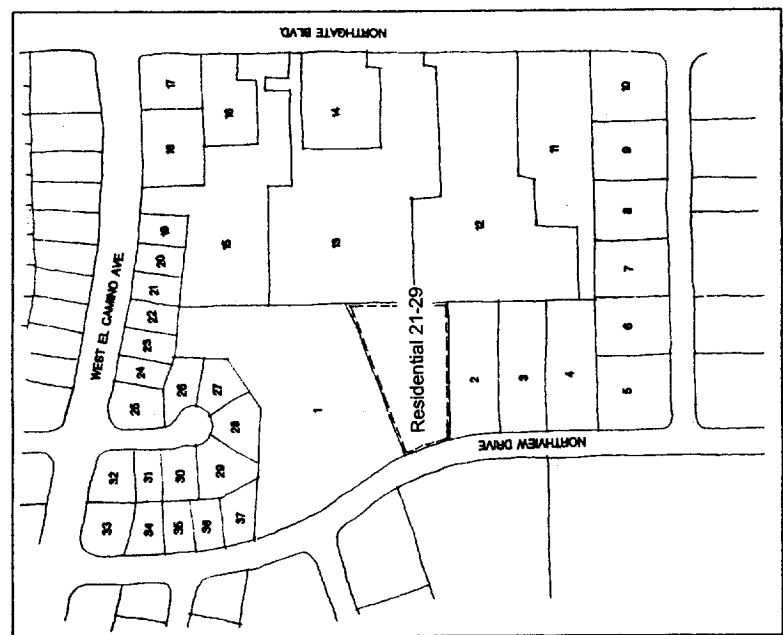

PROPOSED COMMUNITY PLAN

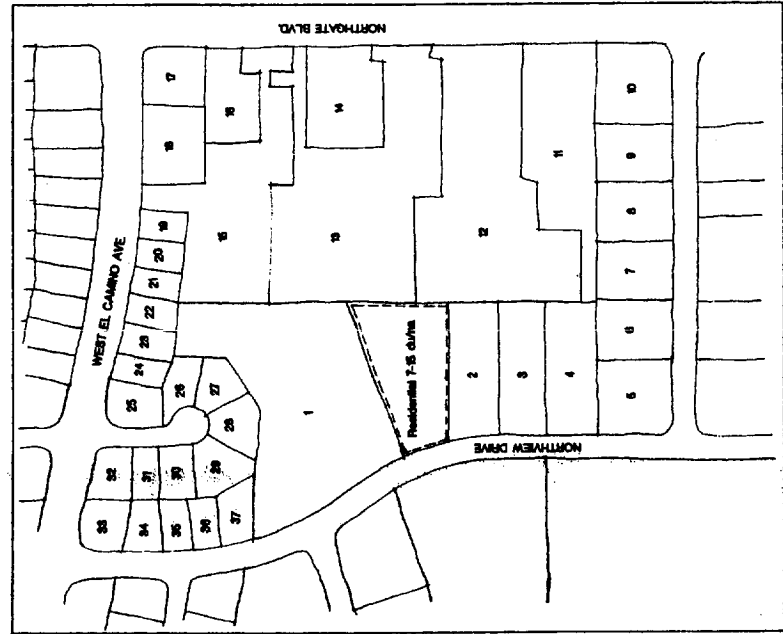

EXISTING COMMUNITY PLAN

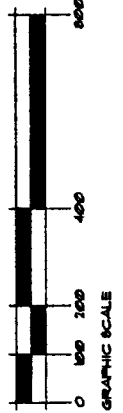

**COMMUNITY PLAN AMENDMENT EXHIBIT
NORTHVIEW VILLAGE APARTMENTS
CITY OF SACRAMENTO, CALIFORNIA
MARCH 25, 2004**

FOR CITY CLERK USE ONLY

RESOLUTION NO.: 2004-445

DATE ADOPTED: JUN 08 2004 6