

**CITY OF SACRAMENTO**  
1231 I Street, Sacramento, CA 95814

**Permit No: 0312268**  
**Insp Area: 4**  
**Thos Bros: 257-C3**

**Site Address: 5612 AMNEST WY SAC**  
**Parcel No: NORTHPOINTE PARK VIL. 24 LOT 59**

**Sub-Type: NSFR**  
**Housing (Y/N): N**

CONTRACTOR  
BFAZER HOMES  
3009 DOUGLAS BL #150  
ROSEVILLE CA 95661

OWNER

ARCHITECT

**Nature of Work: MP 1910 1 STORY 9 ROOM SFR**

**CONSTRUCTION LENDING AGENCY :** I hereby affirm under penalty of perjury that there is a construction lending agency for the performance of the work for which this permit is issued (Sec. 3097, Civ. C).

Lender's Name \_\_\_\_\_ Lender's Address \_\_\_\_\_

**LICENSED CONTRACTORS DECLARATION:** I hereby affirm under penalty of perjury that I am licensed under provisions of Chapter 9 (commencing with section 7000) of Division 3 of the Business and Professions Code and my license is in full force and effect.

License Class B License Number 724191 Date 9/17/03 Contractor Signature Sheryl VanMaen

**OWNER-BUILDER DECLARATION:** I hereby affirm under penalty of perjury that I am exempt from the contractors License Law for the following reason (Sec. 7031.5, Business and Professions Code; any city or county which requires a permit to construct, alter, improve, demolish, or repair any structure, prior to its issuance, also requires the applicant for such permit to file a signed statement that he or she is licensed pursuant to the provisions of the Contractors License Law (Chapter 9 (commencing with Section 7000) of Division 8 of the Business and Professions Code) or that he or she is exempt therefrom and the basis for the alleged exemption. Any violation of Section 7031.5 by any applicant for a permit subjects the applicant to a civil penalty of not more than five hundred dollars (\$500.00);

\_\_\_\_\_, I, as a owner of the property, or my employees with wages as their sole compensation, will do the work, and the structure is not intended or offered for sale (Sec. 7044, Business and Professional Code: The Contractors License Law does not apply to an owner of property who builds or improves thereon, and who does such work himself or herself or through his/her own employees, provided that such improvements are not intended or offered for sale. If, however, the building or improvement is sold within one year of completion, the owner-builder will have the burden of proving that he/she did not build or improve for the purpose of sale.)

\_\_\_\_\_, I, as owner of the property, am exclusively contracting with licensed contractors to construct the project (Sec. 7044, Business and Professions Code: The Contractors License Law does not apply to an owner of property who builds or improves thereon, and who contracts for such projects with a contractor(s) licensed pursuant to the Contractors License Law).

\_\_\_\_\_, I am exempt under Sec. \_\_\_\_\_ B & PC for this reason: \_\_\_\_\_

Date \_\_\_\_\_ Owner Signature \_\_\_\_\_

**PAID**  
**CITY OF SACRAMENTO**

SEP 17 2003

**IN ISSUING THIS BUILDING PERMIT,** the applicant represents, and the city relies on the representation of the applicant, that the applicant verified all measurements and locations shown on the application or accompanying drawings and that the improvement to be constructed does not violate any law or private agreement relating to permissible or prohibited locations for such improvements. This building permit does not authorize any illegal location of any improvement or the violation of any private agreement relating to location of improvements.

I certify that I have read this application and state that all information is correct. I agree to comply with all city and county ordinances and state laws relating to building construction and hereby authorize representative(s) of this city to enter upon the abovementioned property for inspection purposes.

Date 9/17/03 Applicant/Agent Signature Sheryl VanMaen

**WORKER'S COMPENSATION DECLARATION:** I hereby affirm under penalty of perjury one of the following declarations:

\_\_\_\_\_, I have and will maintain a certificate of consent to self-insure for workers' compensation as provided for by Section 3700 of the Labor Code, for the performance of work for which the permit is issued.

\_\_\_\_\_, I have and will maintain workers' compensation insurance, as required by Section 3700 of the Labor Code, for the performance of the work for which this permit is issued. My workers' compensation insurance carrier and policy number are:

Carrier LIBERTY MUTUAL INS CO. Policy Number WA2-65D-004147-082 Exp Date 04/01/2004

\_\_\_\_\_, (This section need not be completed if the permit is for \$100 or less) I certify that in the performance of the work for which this permit is issued, I shall not employ any person in any manner so as to become subject to the workers' compensation laws of California and agree that if I should become subject to the workers' compensation provisions of Section 3700 of the Labor Code, I shall forthwith comply with those provisions.

Date 9/17/03 Applicant Signature Sheryl VanMaen

**WARNING: FAILURE TO SECURE WORKER'S COMPENSATION COVERAGE IS UNLAWFUL AND SHALL SUBJECT AN EMPLOYER TO CRIMINAL PENALTIES AND CIVIL FINES UP TO ONE HUNDRED THOUSAND DOLLARS (\$100,000) IN ADDITION TO THE COST OF COMPENSATION, DAMAGES AS PROVIDED FOR IN SECTION 3706 OF THE LABOR CODE, INTEREST AND ATTORNEY'S FEE.**

**THIS PERMIT SHALL EXPIRE BY LIMITATION IF WORK IS NOT COMMENCED WITHIN 180 DAYS.**

## RESIDENTIAL BUILDING PERMIT APPLICATION

New Construction    
  Addition    
  Remodels    
  Other

Project Address: 5612 Amnest Way, lot 59 Assessor Parcel # 201-0540-023

OWNER INFORMATION: Northpointe Park Village 24

|   |                             |
|---|-----------------------------|
| Legal Property Owner: <u>Beazer Homes Holdings Corp.</u>  | Phone # <u>916-773-3888</u> |
| Owner Address: <u>3009 Douglas Blvd. 150</u> City <u>Roseville</u> State <u>CA</u> Zip <u>95661</u> |                             |

**CONTRACTOR INFORMATION:**

|                                  |                       |                         |                       |
|----------------------------------|-----------------------|-------------------------|-----------------------|
| Contractor: <u>Same as above</u> | Lic. # <u>B724191</u> | Phone # <u>773-3888</u> | Fax # <u>773-0425</u> |
|----------------------------------|-----------------------|-------------------------|-----------------------|

**PROJECT INFORMATION:**

|  |                                  |                         |                     |
|--|----------------------------------|-------------------------|---------------------|
| Land Use Zone _____                    | Occupancy Group _____            | Construction Type _____ | Fed Code _____      |
| No. of stories: <u>1</u>               | No. of rooms: _____              | Street width: _____     |                     |
| 1 <sup>st</sup> Floor Area <u>1910</u> | 2 <sup>nd</sup> Floor Area _____ | Basement _____          | Roof Material _____ |

| AREA IN SQUARE FOOT OF: | EXISTING | NEW         |                |
|-------------------------|----------|-------------|----------------|
| Dwelling/Living         | _____    | <u>1910</u> | <i>0312268</i> |
| Garage/Storage          | _____    | <u>576</u>  |                |
| Decks/Balconies         | _____    | _____       |                |
| Carports                | _____    | _____       |                |

SCOPE OF WORK: Single Family Homes

**FOR OFFICE USE ONLY**

- |   |   |  |
|---|---|--|
| <input type="checkbox"/> Information above complete | <input type="checkbox"/> AR Flood Waiver required             | <input type="checkbox"/> Planning Approval                   |
| <input type="checkbox"/> Violation files checked    | <input type="checkbox"/> Flood Elevation Certificate Required | <input type="checkbox"/> Design Review Approval              |
| <input type="checkbox"/> Standard setbacks          | <input type="checkbox"/> Water Development Infill Area        | <input type="checkbox"/> Special Fee Districts Apply : _____ |
| <input type="checkbox"/> County Sewer               |   |  |

**NEW STRUCTURES & ADDITIONS**

❖ THE FOLLOWING MUST BE PROVIDED IN ORDER TO SUBMIT FOR PLAN REVIEW

- |  |  |
|--|--|
| <input type="checkbox"/> <b>2 COMPLETE PLANS, LEGIBLE &amp; DRAWN TO SCALE</b><br><input type="checkbox"/> <b>3 SETS IF PROJECT IS IN A DESIGN REVIEW AREA</b> | ❖ <i>Plans to include: site plan, floor plan, elevations, roof/ceiling plan, foundation and structural framing details, and structural calculations for non-conforming structures.</i> |
| <input type="checkbox"/> Title 24 Energy Compliance documentation<br><input type="checkbox"/> Grading and Erosion Control Questionnaire                        | <input type="checkbox"/> 11" x 17" copy of floor plan for County Assessor<br><input type="checkbox"/> Plan Review Fees   |

Date: \_\_\_\_\_

Received by: (staff) \_\_\_\_\_

|                          |
|--------------------------|
| <b>ACTIVITY/PERMIT #</b> |
|--------------------------|



INSULATION CONTRACTORS ASSOCIATION OF AMERICA

INSULATION CERTIFICATE  
49019

1321 DUKE STREET, SUITE 303 • ALEXANDRIA, VA 22314 • (703) 739-0356

THIS IS TO CERTIFY THAT INSULATION HAS BEEN INSTALLED IN CONFORMANCE WITH CURRENT ENERGY REGULATIONS, CALIFORNIA ADMINISTRATIVE CODE TITLE 24, STATE OF CALIFORNIA, IN THE BUILDING LOCATED AT:

192201 LOT # 59 TRACT # 51-57-01

STREET Sara Amest CITY SOC

EXTERIOR WALLS:

MANUFACTURER \_\_\_\_\_ THICKNESS/TYPE 2 1/2 R- VALUE 13

CEILINGS:

BATTS: MANUFACTURER \_\_\_\_\_ THICKNESS/TYPE 1 1/2 R- VALUE 30

BLOWN IN: MANUFACTURER \_\_\_\_\_ THICKNESS/TYPE 12 R- VALUE 30

MANUFACTURER \_\_\_\_\_ THICKNESS/TYPE \_\_\_\_\_ R- VALUE \_\_\_\_\_

SQUARE FOOTAGE COVERED 1730 NUMBER OF BAGS USED 33

FLOORS: MANUFACTURER \_\_\_\_\_ THICKNESS/TYPE \_\_\_\_\_ R- VALUE \_\_\_\_\_

SLAB ON GRADE: MANUFACTURER \_\_\_\_\_ THICKNESS/TYPE \_\_\_\_\_ R- VALUE \_\_\_\_\_

MANUFACTURER \_\_\_\_\_ THICKNESS/TYPE \_\_\_\_\_ R- VALUE \_\_\_\_\_

WIDTH OF INSULATION \_\_\_\_\_ INCHES

FOUNDATION WALLS: MANUFACTURER \_\_\_\_\_ THICKNESS/TYPE \_\_\_\_\_ R- VALUE \_\_\_\_\_

MANUFACTURER \_\_\_\_\_ THICKNESS/TYPE \_\_\_\_\_ R- VALUE \_\_\_\_\_

GENERAL CONTRACTOR \_\_\_\_\_ DATE \_\_\_\_\_

CALIFORNIA CONTRACTORS LICENSE # \_\_\_\_\_

INSULATION CONTRACTOR **ARCADE INSULATION** SIGNATURE \_\_\_\_\_ TITLE \_\_\_\_\_

CALIFORNIA CONTRACTORS LICENSE #815286 DATE 1-30-4

NEVADA CONTRACTORS LICENSE #56201 SIGNATURE \_\_\_\_\_ TITLE \_\_\_\_\_

OMEGA PRODUCTS INTERNATIONAL, INC.

DIAMOND WALL INSULATING STUCCO SYSTEM

JOB ADDRESS:

5612 Amnest

Santa

ICBO Report #2006

PLASTERING CONTRACTOR:

Name: STUCCO WORKS, INC.

Address: 5900 WAREHOUSE WAY SACRAMENTO, CA. 95826

Telephone No: (916) 383-6699

Contractor Number of Diamond Wall System 2175

This is to certify that the exterior coating system on the building exterior at the above address has been installed in accordance with the evaluation report specified above and the manufacturer's instructions.

Date

2-2-04

Signature of authorized representative of Plastering Contractor

*[Signature]*

This installation card must be presented to the building inspector after completion of work and before final inspection.

lot # 4059

BEAZER STEFFOLD

Date of job completion 1-13-04

THIS PLOT PLAN IS NOT FOR SALES PURPOSES. THIS PLOT PLAN IS FOR THE PURPOSES OF INDICATING COMPLIANCE WITH ZONING SET BACKS, GENERAL DRAINAGE DIRECTION, AND APPROXIMATE UTILITY CONNECTION. ALL OTHER DATA SHOWN HEREON IS CONCEPTUAL. THIS PLOT PLAN DOES NOT REFLECT AS-BUILT CONDITION, RETAINING WALL ARE OPTIONAL AND MAY OR MAY NOT BE CONSTRUCTED.

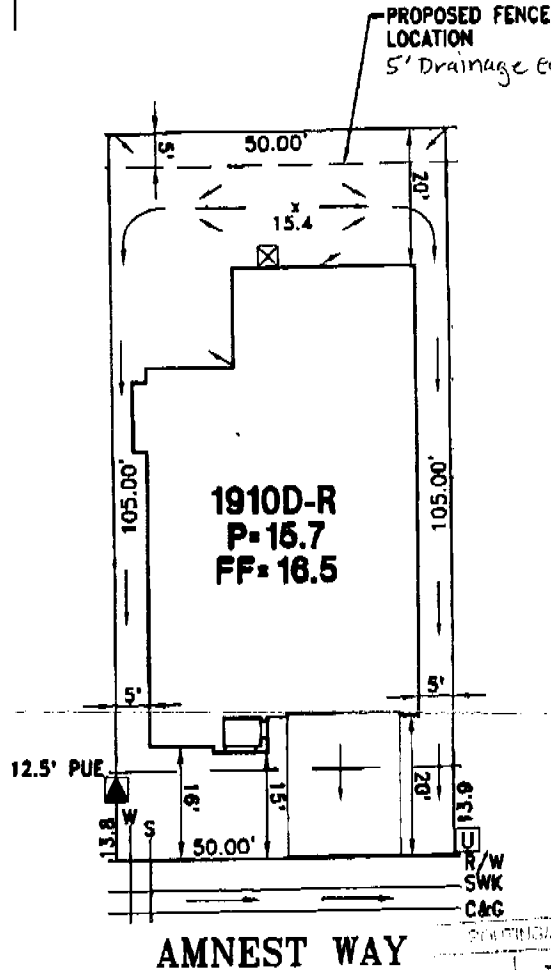
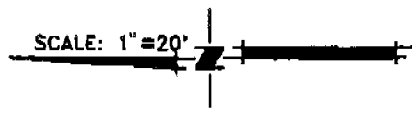

This plan is for informational purposes only. It does not constitute an offer of any service or product. It is not to be used for any purpose other than the one intended. The user assumes all responsibility for the use of this plan and accepts the consequences thereof. No liability shall be assumed for any errors or omissions. This plan is not to be used as evidence in any court of law.

REVISED

| APPROVAL |          |
|----------|----------|
| DATE     | INITIALS |
|          |          |
|          |          |
|          |          |
|          |          |
|          |          |
|          |          |
|          |          |

- LEGEND**
- STREET LIGHT
  - TRANSFORMER
  - UTILITY BOX
  - STREET LIGHT SERVICE POINT
  - FIRE HYDRANT
  - STOP SIGN

**PLOT PLAN**  
**LOT 59**  
 SHEFFIELD GARDENS  
 AT REGENCY PARK VILLAGE 24  
 FOR  
 BEAZER HOMES  
 CITY OF SACRAMENTO CALIFORNIA

**WOOD RODGERS**  
 ENGINEERING - PLANNING - MAPPING - SURVEYING  
 2301 E STREET, #200-8, SACRAMENTO, CA 95816  
 PHONE: 916 341-7760 FAX: 916 341-7767

|         |       |         |             |
|---------|-------|---------|-------------|
| DATE    | DRAWN | CHECKED | PROJECT NO. |
| AUG. 03 | FJ    |         | 1045.069    |