

CITY OF SACRAMENTO

1231 I Street, Sacramento, CA 95814

Permit No: 0110611

Insp Area: 4

Thos Bros: 277B3

Site Address: 71 SPINEL CR SAC

Parcel No: 225-1340-012

NATOMAS CROSSING UNIT 19 LOT 12

Sub-Type: NSFR

Housing (Y/N):

N

CONTRACTOR

KIMBALL HILL HOMES
10535 EAST STOCKTON BL. STE. K
ELK GROVE CA. 95624

OWNER

ARCHITECT

Nature of Work: KIMBALL HILL MP4073 NSFR

CONSTRUCTION LENDING AGENCY : I hereby affirm under penalty of perjury that there is a construction lending agency for the performance of the work for which this permit is issued (Sec. 3097, Civ. C).

Lender's Name Lender's Address

LICENSED CONTRACTORS DECLARATION: I hereby affirm under penalty of perjury that I am licensed under provisions of Chapter 9 (commencing with section 7000) of Division 3 of the Business and Professions Code and my license is in full force and effect.

License Class B License Number 701803 Date 8/28/01 Contractor Signature N. Collins

OWNER-BUILDER DECLARATION: I hereby affirm under penalty of perjury that I am exempt from the contractors License Law for the following reason (Sec. 7031.5, Business and Professions Code; any city or county which requires a permit to construct, alter, improve, demolish, or repair any structure, prior to its issuance, also requires the applicant for such permit to file a signed statement that he or she is licensed pursuant to the provisions of the Contractors License Law (Chapter 9 (commencing with Section 7000) of Division 8 of the Business and Professions Code) or that he or she is exempt therefrom and the basis for the alleged exemption. Any violation of Section 7031.5 by any applicant for a permit subjects the applicant to a civil penalty of not more than five hundred dollars (\$500.00);

I, as a owner of the property, or my employees with wages as their sole compensation, will do the work, and the structure is not intended or offered for sale (Sec. 7044, Business and Professional Code: The Contractors License Law does not apply to an owner of property who builds or improves thereon, and who does such work himself or herself or through his/her own employees, provided that such improvements are not intended or offered for sale. If, however, the building or improvement is sold within one year of completion, the owner-builder will have the burden of proving that he/she did not build or improve for the purpose of sale.)

I, as owner of the property, am exclusively contracting with licensed contractors to construct the project (Sec. 7044, Business and Professions Code: The Contractors License Law does not apply to an owner of property who builds or improves thereon, and who contracts for such projects with a contractor(s) licensed pursuant to the Contractors License Law).

I am exempt under Sec. B & PC for this reason:

Date Owner Signature

IN ISSUING THIS BUILDING PERMIT, the applicant represents, and the city relies on the representation of the applicant, that the applicant verified all measurements and locations shown on the application or accompanying drawings and that the improvement to be constructed does not violate any law or private agreement relating to permissible or prohibited locations for such improvements. This building permit does not authorize any illegal location of any improvement or the violation of any private agreement relating to location of improvements.

I certify that I have read this application and state that all information is correct. I agree to comply with all city and county ordinances and state laws relating to building construction and herby authorize representative(s) of this city to enter upon the abovementioned property for inspection purposes.

Date 8/28/01 Applicant/Agent Signature N. Collins

WORKER'S COMPENSATION DECLARATION: I hereby affirm under penalty of perjury one of the following declarations:

I have and will maintain a certificate of consent to self-insure for workers' compensation as provided for by Section 3700 of the Labor Code, for the performance of work for which the permit is issued.

X I have and will maintain workers' compensation insurance, as required by Section 3700 of the Labor Code, for the performance of the work for which this permit is issued. My workers' compensation insurance carrier and policy number are:

Carrier CLAREDON NAT. INS. CO. Policy Number SCF98-3482-000 Exp Date 10/01/2001

(This section need not be completed if the permit is for \$100 or less) I certify that in the performance of the work for which this permit is issued, I shall not employ any person in any manner so as to become subject to the workers' compensation laws of California and agree that if I should become subject to the workers' compensation provisions of Section 3700 of the Labor Code, I shall forthwith comply with those provisions.

Date 8/28/01 Applicant Signature N. Collins

WARNING: FAILURE TO SECURE WORKER'S COMPENSATION COVERAGE IS UNLAWFUL AND SHALL SUBJECT AN EMPLOYER TO CRIMINAL PENALTIES AND CIVIL FINES UP TO ONE HUNDRED THOUSAND DOLLARS (\$100,000) IN ADDITION TO THE COST OF COMPENSATION, DAMAGES AS PROVIDED FOR IN SECTION 3706 OF THE LABOR CODE, INTEREST AND ATTORNEY'S FEE.

THIS PERMIT SHALL EXPIRE BY LIMITATION IF WORK IS NOT COMMENCED WITHIN 180 DAYS.

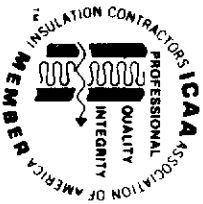

**INSULATION CONTRACTORS
ASSOCIATION
OF AMERICA**

INSULATION
CERTIFICATE

73791

1321 DUKE STREET, SUITE 303 • ALEXANDRIA, VA 22314 • (703) 739-0356

THIS IS TO CERTIFY THAT INSULATION HAS BEEN INSTALLED IN CONFORMANCE WITH CURRENT ENERGY REGULATIONS CALIFORNIA ADMINISTRATIVE CODE TITLE 24, STATE OF CALIFORNIA, IN THE BUILDING LOCATED AT

Kimball Hill Lot # 12 TRACT # N atoms
crossings

STREET 71 Spines circle CITY Sacto

EXTERIOR WALLS:

MANUFACTURER

FIB

THICKNESS/TYPE

B 3/8
1 1/4" R-

VALUE

13
1/19

CEILINGS:

BATTS:

FIB

THICKNESS/TYPE

10 R-

VALUE

30

BLOWN IN:

MANUFACTURER

Insul III

MINIMUM

THICKNESS

12 R-

VALUE

30

SQUARE FOOTAGE COVERED 2430

NUMBER OF BAGS USED

43

FLOORS:

MANUFACTURER

THICKNESS/TYPE

VALUE

SLAB ON GRADE:

MANUFACTURER

THICKNESS/TYPE

VALUE

WIDTH OF INSULATION _____ INCHES

FOUNDATION WALLS:

MANUFACTURER

THICKNESS/TYPE

VALUE

GENERAL CONTRACTOR _____

CALIFORNIA CONTRACTORS LICENSE # _____

DATE _____

SIGNATURE _____

TITLE _____

INSULATION CONTRACTOR **ARCADE INSULATION**

CALIFORNIA CONTRACTORS LICENSE #263794

DATE 2-25-2

A. Berner _____
SIGNATURE TITLE

RESIDENTIAL BUILDING PERMIT APPLICATION

- New Construction
 Addition
 Remodels
 Other

Project Address: 71 Spinel Circle

Assessor Parcel # 225-1340-012

OWNER INFORMATION:

Legal Property Owner: Kimball Hill Homes Phone # (916) 714-1153
 Owner Address: 10535 East Stockton Blvd City Elk Grove State Ca. Zip 95624
 Suite x

CONTRACTOR INFORMATION:

Contractor: Kimball Hill Homes Lic # 701803 Phone # 714-1153 Fax # 714-1425
Natomas Crossing Unit 19

PROJECT INFORMATION:

Land Use Zone R-14 Occupancy Group R-3 Construction Type VN Fed Code 1A
 No. of stories: 2 No. of rooms: 12 Street width: _____
 1st Floor Area 1998 2nd Floor Area _____ Basement _____ Roof Material _____

AREA IN SQUARE FOOT OF:	EXISTING	NEW
Dwelling/Living	_____	<u>4073</u>
Garage/Storage	_____	<u>1022</u>
Decks/Balconies	_____	<u>40</u>
Garports	_____	_____

SCOPE OF WORK: _____

FOR OFFICE USE ONLY

- | | | |
|---|---|---|
| <input type="checkbox"/> Information above complete | <input type="checkbox"/> AR Flood Waiver required | <input type="checkbox"/> Planning Approval |
| <input type="checkbox"/> Violation files checked | <input type="checkbox"/> Flood Elevation Certificate Required | <input type="checkbox"/> Design Review Approval |
| <input type="checkbox"/> Standard setbacks | <input type="checkbox"/> Water Development Infill Area | <input type="checkbox"/> Special Fee Districts Apply: _____ |
| <input type="checkbox"/> County Sewer | | |

NEW STRUCTURES & ADDITIONS

◀ THE FOLLOWING MUST BE PROVIDED IN ORDER TO SUBMIT FOR PLAN REVIEW

- | | |
|---|---|
| <input type="checkbox"/> 2 COMPLETE PLANS, LEGIBLE & DRAWN TO SCALE | ◆ Plans to include: site plan, floor plan, elevations, roof/calling plan, foundation and structural framing details, and structural calculations for non-conforming structures. |
| <input type="checkbox"/> 3 SETS IF PROJECT IS IN A DESIGN REVIEW AREA | |
| <input type="checkbox"/> Title 24 Energy Compliance documentation | <input type="checkbox"/> 11" x 17" copy of floor plan for County Assessor |
| <input type="checkbox"/> Grading and Erosion Control Questionnaire | <input type="checkbox"/> Plan Review Fees |

Date: _____

Received by: (staff) _____

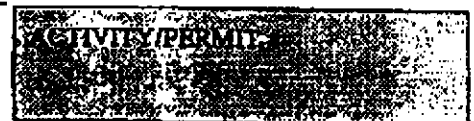

0110cell

259247 24

INSTALLATION CARD

OMEGA DIAMOND WALL INSULATING ONE COAT SYSTEM
OMEGA PRODUCTS INTERNATIONAL, INC.

Job Address:

KIMBALL HILL - SACRAMENTO
LOT 212
71 SPINEL

ICBO Evaluation Service, Inc.
Report 4004

1-30-02
Date of Job Completion

Plastering Contractor:

Name: Mid Valley Plastering, Inc.
Address: 4807 S. Airport Way, Unit # D
Stockton, CA 95206-4924
Telephone: (209) 234-2671

Approved Contractor Number as Issued by the Coating Manufacturer Omega Diamond Wall No. 2315

This is to certify that the exterior system on the building exterior at the above address has been installed in accordance with the evaluation report specified above and the manufacturer's instructions

[Signature]
Signature of Plastering Contractor

2-1-02
Date

This installation card must be presented to the building inspector after completion of work and before final inspection



This set of plans and specifications must be kept on the job at all times, and it is unlawful to make any changes or alterations from the same without written permission from the Building Inspection Division.

The approval of this plan and specification SHALL NOT be held to permit or approve the violation of any City Ordinance or State Law.

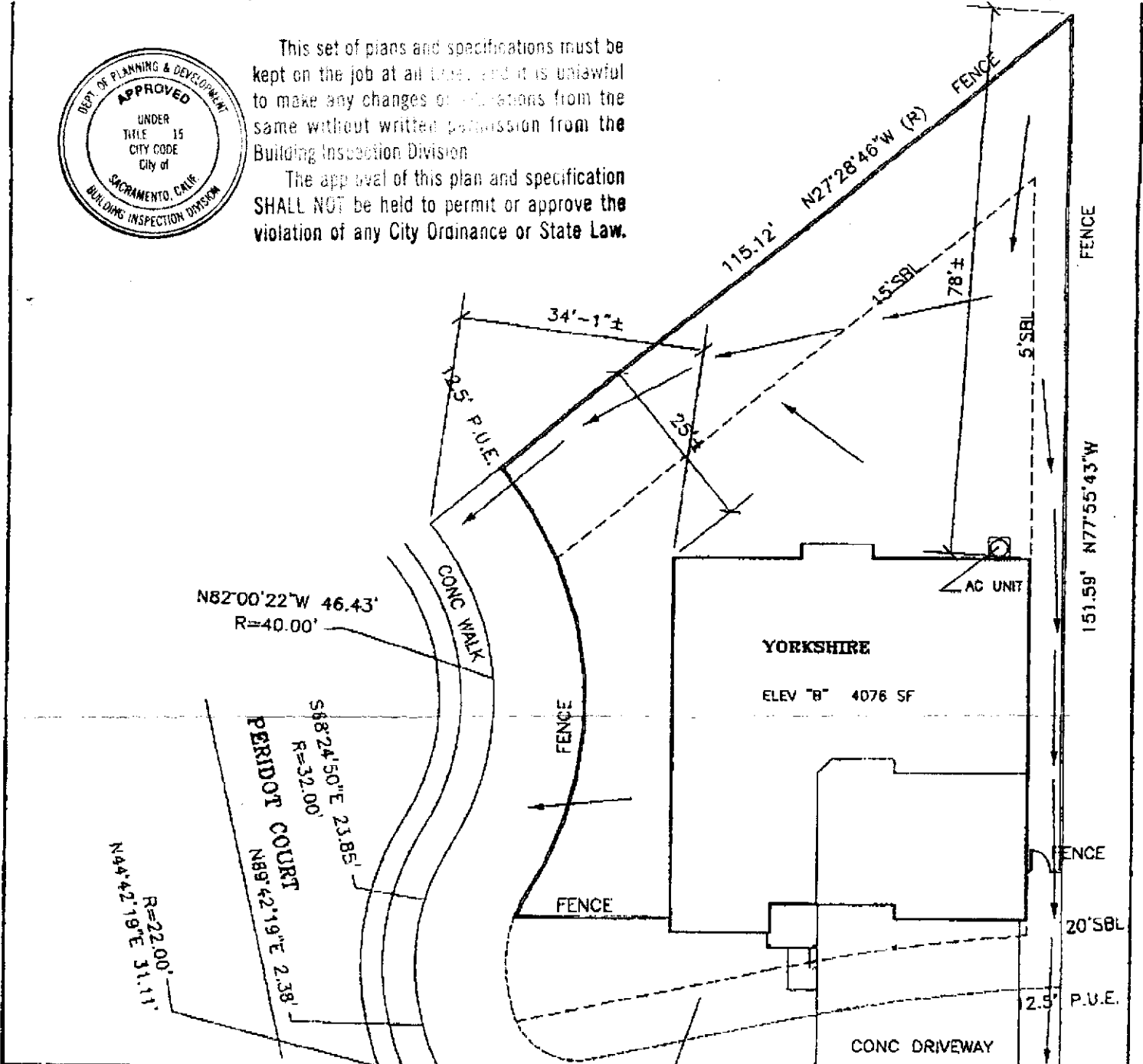

BLOOM Architectural Developments Incorporated
4437 Kenneth Avenue
Fair Oaks, CA 95628
(916)961-1553
(916)967-3011 Fax

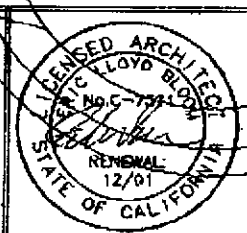

Plot Plan Disclosure This plot plan approximates a general representation of lot dimensions, easements, fence and home placement, etc. This illustration is not a condition of Kimball Hill Homes sales agreement. The actual placement and measurements demonstrated on this diagram are subject to change without notice.

Signature _____

KHH California, Inc. (916)714-1153
10535 E.Stockton Blvd. Ste.K, Elk Grove, CA 95758

Job#	1042 12	Plan#	4073
Date	May 08 01	Draft	1
Plan	YORKSHIRE	Elev	B
Project	Natomas Crossing		
Lot	12	Unit	19
Address	Spinel Circle		
City	Sacramento	State	CA
APN	-0000		

PLOT PLAN
Scale 1"=20'