

CITY OF SACRAMENTO
1231 I Street, Sacramento, CA 95814

Permit No: 0007098
Insp Area: 4

Site Address: 3873 SAINTSBURY DR SAC
Parcel No: 225-1190-031 LOT 219 GATEWAY WEST 1

Sub-Type: NSFR
Housing (Y/N): N

CONTRACTOR
BEAZER HOMES
3009 DOUGLAS BL #150
ROSFVILLE CA 95661

OWNER

ARCHITECT

Nature of Work: NSFR MP1232 5 RMS

CONSTRUCTION LENDING AGENCY : I hereby affirm under penalty of perjury that there is a construction lending agency for the performance of the work for which this permit is issued (Sec. 3097, Civ. C).

Lender's Name _____ Lender's Address _____

LICENSED CONTRACTORS DECLARATION: I hereby affirm under penalty of perjury that I am licensed under provisions of Chapter 9 (commencing with section 7000) of Division 3 of the Business and Professions Code and my license is in full force and effect.

License Class B License Number 724191 Date 7/3/00 Contractor Signature Sheng Van Maran

OWNER-BUILDER DECLARATION: I hereby affirm under penalty of perjury that I am exempt from the contractors License Law for the following reason (Sec. 7031.5, Business and Professions Code; any city or county which requires a permit to construct, alter, improve, demolish, or repair any structure, prior to its issuance, also requires the applicant for such permit to file a signed statement that he or she is licensed pursuant to the provisions of the Contractors License Law (Chapter 9 (commencing with Section 7000) of Division 8 of the Business and Professions Code) or that he or she is exempt therefrom and the basis for the alleged exemption. Any violation of Section 7031.5 by any applicant for a permit subjects the applicant to a civil penalty of not more than five hundred dollars (\$500.00);

____ I, as a owner of the property, or my employees with wages as their sole compensation, will do the work, and the structure is not intended or offered for sale (Sec. 7044, Business and Professional Code: The Contractors License Law does not apply to an owner of property who builds or improves thereon, and who does such work himself or herself or through his/her own employees, provided that such improvements are not intended or offered for sale. If, however, the building or improvement is sold within one year of completion, the owner-builder will have the burden of proving that he/she did not build or improve for the purpose of sale.)

____ I, as owner of the property, am exclusively contracting with licensed contractors to construct the project (Sec. 7044, Business and Professions Code: The Contractors License Law does not apply to an owner of property who builds or improves thereon, and who contracts for such projects with a contractor(s) licensed pursuant to the Contractors License Law).

____ I am exempt under Sec. _____ B & PC for this reason: _____

Date _____ Owner Signature _____

IN ISSUING THIS BUILDING PERMIT, the applicant represents, and the city relies on the representation of the applicant, that the applicant verified all measurements and locations shown on the application or accompanying drawings and that the improvement to be constructed does not violate any law or private agreement relating to permissible or prohibited locations for such improvements. This building permit does not authorize any illegal location of any improvement or the violation of any private agreement relating to location of improvements.

I certify that I have read this application and state that all information is correct. I agree to comply with all city and county ordinances and state laws relating to building construction and hereby authorize representative(s) of this city to enter upon the abovementioned property for inspection purposes.

Date 7/3/00 Applicant/Agent Signature Sheng Van Maran

WORKER'S COMPENSATION DECLARATION: I hereby affirm under penalty of perjury one of the following declarations:

____ I have and will maintain a certificate of consent to self-insure for workers' compensation as provided for by Section 3700 of the Labor Code, for the performance of work for which the permit is issued.

I have and will maintain workers' compensation insurance, as required by Section 3700 of the Labor Code, for the performance of the work for which this permit is issued. My workers' compensation insurance carrier and policy number are:

Carrier LIBERTY MUTUAL INS CO. Policy Number WA2-651-004147-080 Exp Date 4/4/2001 2000

____ (This section need not be completed if the permit is for \$100 or less) I certify that in the performance of the work, I shall not employ any person in any manner so as to become subject to the workers' compensation laws of California and shall, subject to the workers' compensation provisions of Section 3700 of the Labor Code, I shall forthwith comply with those provisions.

Date 7/3/00 Applicant Signature Sheng Van Maran

WARNING: FAILURE TO SECURE WORKER'S COMPENSATION COVERAGE IS UNLAWFUL AND SHALL SUBJECT AN EMPLOYER TO CRIMINAL PENALTIES AND CIVIL FINES UP TO ONE HUNDRED THOUSAND DOLLARS (\$100,000) IN ADDITION TO THE COST OF COMPENSATION, DAMAGES AS PROVIDED FOR IN SECTION 3706 OF THE LABOR CODE, INTEREST AND ATTORNEY'S FEE.

THIS PERMIT SHALL EXPIRE BY LIMITATION IF WORK IS NOT COMMENCED WITHIN 180 DAYS.

RESIDENTIAL BUILDING PERMIT APPLICATION

New Construction Addition Remodels Other

Project Address: 3873 Sainsbury Dr Assessor Parcel # 225-119-031

OWNER INFORMATION: lot 219

Legal Property Owner: Beazer Homes Phone # 773-3888
 Owner Address: 3009 Douglas Blvd #150 City Roseville State CA Zip 95661

CONTRACTOR INFORMATION:

Contractor: Beazer Homes Lic. # 724191 Phone # 773-3888 Fax# 773-0425

PROJECT INFORMATION:

Land Use Zone _____ Occupancy Group _____ Construction Type _____ Fed Code _____
 No. of stories: 1 No. of rooms: _____ Street width: _____
 1st Floor Area _____ 2nd Floor Area 0 Basement 0 Roof Material _____

AREA IN SQUARE FOOT OF:

EXISTING

NEW

Dwelling/Living	_____	<u>1232</u>
Garage/Storage	_____	<u>426</u>
Decks/Balconies	_____	_____
Carports	_____	_____

SCOPE OF WORK: New SFD

FOR OFFICE USE ONLY

- | | | |
|---|---|--|
| <input type="checkbox"/> Information above complete | <input type="checkbox"/> AR Flood Waiver required | <input type="checkbox"/> Planning Approval |
| <input type="checkbox"/> Violation files checked | <input type="checkbox"/> Flood Elevation Certificate Required | <input type="checkbox"/> Design Review Approval |
| <input type="checkbox"/> Standard setbacks | <input type="checkbox"/> Water Development Infill Area | <input type="checkbox"/> Special Fee Districts Apply : _____ |
| <input type="checkbox"/> County Sewer | | |

NEW STRUCTURES & ADDITIONS

◆ THE FOLLOWING MUST BE PROVIDED IN ORDER TO SUBMIT FOR PLAN REVIEW

- | | |
|---|---|
| <input type="checkbox"/> 2 COMPLETE PLANS, LEGIBLE & DRAWN TO SCALE | ◆ Plans to include: site plan, floor plan, elevations, roof/ceiling plan, foundation and structural framing details, and structural calculations for non-conforming structures. |
| <input type="checkbox"/> 3 SETS IF PROJECT IS IN A DESIGN REVIEW AREA | |
| <input type="checkbox"/> Title 24 Energy Compliance documentation | <input type="checkbox"/> 11" x 17" copy of floor plan for County Assessor |
| <input type="checkbox"/> Grading and Erosion Control Questionnaire | <input type="checkbox"/> Plan Review Fees |

Date: _____

Received by: (staff) _____

ACTIVITY/PERMIT # _____

CERTIFICATION OF INSULATION

<p style="font-size: 2em; font-weight: bold;">REITER</p> <p style="font-size: 1.5em; font-weight: bold;">3873 Saintsbury</p> <p style="font-size: 1.2em;">0717</p>	<p>LOT #</p> <p><input checked="" type="checkbox"/> P.O. BOX 854, WEST SACRAMENTO, CA 95691 LIC. #202026</p> <p><input type="checkbox"/> 1309 MELODY ROAD, MARYSVILLE, CA 95901 LIC. #202026</p> <p><input type="checkbox"/> P.O. BOX 9651, FRESNO, CA 93793-9651 LIC. #202026</p> <p><input type="checkbox"/> P.O. BOX 1631, RENO, NV 89505 LIC. #10675</p> <p><input type="checkbox"/> 3326 A PONDEROSA WAY, LAS VEGAS, NV 89118 LIC. #10675</p> <p>DATE INSULATION COMPLETED</p>
--	---

WALLS		CEILING			FLOORS		
(SQUARE FEET)		(SQUARE FEET)			(SQUARE FEET)		
TYPE OF INSULATION		TYPE OF INSULATION			TYPE OF INSULATION		
MATERIAL FIBERGLASS		MATERIAL FIBERGLASS			MATERIAL FIBERGLASS		
FORM BATTS		FORM BATTS & BLOW			FORM BATTS		
MANUFACTURER'S PRODUCT I.D.		MANUFACTURER'S PRODUCT I.D.			MANUFACTURER'S PRODUCT I.D.		
MANUFACTURER		MANUFACTURER			MANUFACTURER		
OCF		OCF			OCF		
R - VALUE INSTALLED		APPLIED THICKNESS		R - VALUE INSTALLED		APPLIED THICKNESS	
13	3 5/8"	30	30	9	17		

KNEE WALLS IF R-VALUE IS OTHER THAN WALLS ABOVE

MATERIAL FIBERGLASS	FORM BATTS	R VALUE	MANUFACTURER OCF
-------------------------------	----------------------	---------	----------------------------

AIR INFILTRATION SEALANT

MATERIAL FOAM	MANUFACTURER W R GRACE
-------------------------	----------------------------------

THIS IS TO CERTIFY THAT INSULATION AND/OR SEALANT HAS BEEN INSTALLED IN CONFORMANCE WITH APPLICABLE CODES, MATERIAL STANDARDS AND REGULATIONS.

SIGNATURE - INSULATION CONTRACTOR <i>Bill Hendry</i>	TITLE MANAGER	DATE 9-11-88
SIGNATURE - GENERAL CONTRACTOR	TITLE	DATE

REMARKS

19840



INSTALLATION CARD

Job Address:

Beazer Homes
Gateway West Lot # 219
3872 Santsbury Dr. Sac

Stucco System Trade Name: KWIK KOTE
Name Stucco Manufacturer: KWIK KOTE CORP.

ICBO Evaluation Service, Inc.
Report No. 3607
Date of Job Completion

Stucco Contractor: *Kenyon Construction*
Name: *John W. Kenyon, III*
Address: *P.O. Box 2077*
North Highlands, CA 95660
Telephone Number: *(916) 349-8191*

Approved Contractor Number as issued by the Stucco Manufacturer: *1*

This is to certify that the stucco system on the building exterior at the above address had been installed in accordance with the evaluation report specified above and the manufacturer's instructions.

Signature of authorized representative of stucco contractor

Date

8/25/00

THIS PLAN IS PREPARED TO SHOW THE DIMENSIONAL RELATIONSHIP FROM BUILDING FOUNDATION TO PROPERTY LINE, DESIGN DRAINAGE CONTROL ELEVATIONS, AND DIRECTION OF DRAINAGE FLOW TO CONFORM WITH LOCAL ORDINANCES FOR THE PURPOSE OF BUILDING PERMIT ISSUANCE. INFORMATION SHOWN IS APPROXIMATE EXCEPT FOR THOSE SETBACKS WHICH ARE MINIMUMS REQUIRED BY ORDINANCE. THIS PLOT DOES NOT REFLECT AS BUILT CONDITIONS WHICH WILL LIKELY VARY FROM THIS PLAN.

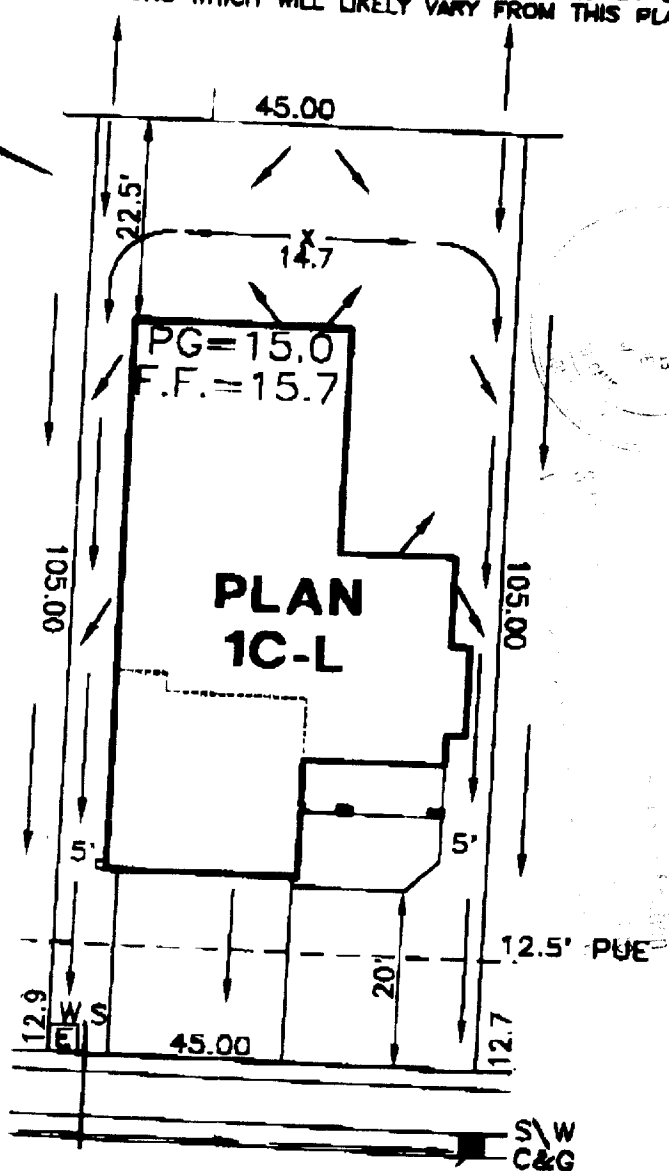
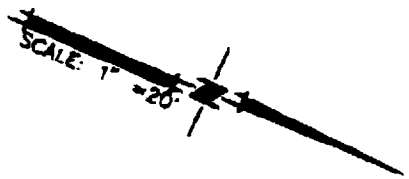

ROUTING/APPROVAL		
	✓	INITIALS
President		
Project Development		
Construction	✓	[Signature]
Marketing	✓	[Signature]

SAINTSBURY DRIVE

[E] UTILITY SERVICE BOX

LOT COVERAGE=35.1%

PLOT PLAN
LOT 219
 GATEWAY WEST-VILLAGE NO. 1
 FOR
 BEAZER HOMES
 SACRAMENTO CALIFORNIA

WOOD-RODGERS INC.

DATE: JUNE2000	DRAWN: HMB	CHECKED: JWH 6-21-00	PROJECT NO: 98BEZ-009
-------------------	---------------	----------------------------	--------------------------