

CITY OF SACRAMENTO  
1231 I Street, Sacramento, CA 95814

Permit No: 0100066  
Insp Area: 4

Site Address: 3 TATUM CT SAC  
Parcel No: 225-1120-031 NORTHPT PK 14 LOT 31

Sub-Type: NSFR  
Housing (Y/N): N

**CONTRACTOR**  
LENNAR RENAISSANCE INC.  
2240 DOUGLAS BL  
ROSEVILLE CA 95601

**OWNER**

**ARCHITECT**

Nature of Work: NSFR MP202 1 STORY 9 RMS

**CONSTRUCTION LENDING AGENCY :** I hereby affirm under penalty of perjury that there is a construction lending agency for the performance of the work for which this permit is issued (Sec. 3097, Civ. C).

Lender's Name \_\_\_\_\_ Lender's Address \_\_\_\_\_

**LICENSED CONTRACTORS DECLARATION:** I hereby affirm under penalty of perjury that I am licensed under provisions of Chapter 9 (commencing with section 7000) of Division 3 of the Business and Professions Code and my license is in full force and effect.  
License Class R License Number 752348 Date 2/28/01 Contractor Signature [Signature]

**OWNER-BUILDER DECLARATION:** I hereby affirm under penalty of perjury that I am exempt from the contractors License Law for the following reason (Sec. 7031.5, Business and Professions Code; any city or county which requires a permit to construct, alter, improve, demolish, or repair any structure, prior to its issuance, also requires the applicant for such permit to file a signed statement that he or she is licensed pursuant to the provisions of the Contractors License Law (Chapter 9 (commencing with Section 7000) of Division 8 of the Business and Professions Code) or that he or she is exempt therefrom and the basis for the alleged exemption. Any violation of Section 7031.5 by any applicant for a permit subjects the applicant to a civil penalty of not more than five hundred dollars (\$500.00).

I, as a owner of the property, or my employees with wages as their sole compensation, will do the work, and the structure is not intended or offered for sale (Sec. 7044, Business and Professional Code). The Contractors License Law does not apply to an owner of property who builds or improves thereon, and who does such work himself or herself or through his/her own employees, provided that such improvements are not intended or offered for sale. If, however, the building or improvement is sold within one year of completion, the owner-builder will have the burden of proving that he/she did not build or improve for the purpose of sale.

I, as owner of the property, am exclusively contracting with licensed contractors to construct the project (Sec. 7044, Business and Professions Code). The Contractors License Law does not apply to an owner of property who builds or improves thereon, and who contracts for such projects with a contractor(s) licensed pursuant to the Contractors License Law.

I am exempt under Sec. \_\_\_\_\_ B & PC for this reason: \_\_\_\_\_  
Date \_\_\_\_\_ Owner Signature \_\_\_\_\_

**IN ISSUING THIS BUILDING PERMIT,** the applicant represents, and the city relies on the representation of the applicant, that the applicant verified all measurements and locations shown on the application or accompanying drawings and that the improvement to be constructed does not violate any law or private agreement relating to permissible or prohibited locations for such improvements. This building permit does not authorize any illegal location of any improvement or the violation of any private agreement relating to location of improvements.

I certify that I have read this application and state that all information is correct. I agree to comply with all city and county ordinances and state laws relating to building construction and hereby authorize representative(s) of this city to enter upon the abovementioned property for inspection purposes.

Date 1-24-01 Applicant/Agent Signature [Signature]

**WORKER'S COMPENSATION DECLARATION:** I hereby affirm under penalty of perjury one of the following declarations:

I have and will maintain a certificate of consent to self-insure for workers' compensation as provided for by Section 3700 of the Labor Code, for the performance of work for which the permit is issued.

I have and will maintain workers' compensation coverage as required by Section 3700 of the Labor Code, for the performance of the work for which this permit is issued. My workers' compensation insurance carrier and policy number are:

Carrier TRANSCONTINENTAL INSURANCE CO Policy Number WC166792277 Exp Date 06/01/2001

(This section need not be completed if the employer for \$100,000 of services shall not employ any person in any manner so as to be subject to the workers' compensation laws of California and agree that if I should become subject to the workers' compensation provisions of Section 3700 of the Labor Code, I shall forthwith comply with those provisions.

Date 1-24-01 Applicant Signature [Signature]

WARNING: FAILURE TO SECURE WORKER'S COMPENSATION COVERAGE IS UNLAWFUL AND SHALL SUBJECT AN EMPLOYER TO CRIMINAL PENALTIES AND CIVIL FINES UP TO ONE HUNDRED THOUSAND DOLLARS (\$100,000) IN ADDITION TO THE COST OF COMPENSATION, DAMAGES AS PROVIDED FOR IN SECTION 3706 OF THE LABOR CODE, INTEREST AND ATTORNEY'S FEE.

**THIS PERMIT SHALL EXPIRE BY LIMITATION IF WORK IS NOT COMMENCED WITHIN 180 DAYS.**



#31

# OMEGA PRODUCTS CORP.

DIAMOND WALL INSULATING STUCCO SYSTEM

JOB ADDRESS:

W. W. C. 287. Leamer

ICBO Report #4004

Date of Job Completion 7/29/01

PLASTERING CONTRACTOR:

Name: STUCCO WORKS INC.

Address: 5900 WAREHOUSE WAY, SACRAMENTO, CALIFORNIA 95826

Telephone No: (916) 383-6699

Contractor Number of Diamond Wall System 2175

This is to certify that the exterior coating system on the building exterior at the above address has been installed in accordance with the evaluation report specified above and the manufacturer's instructions.

Date

7/31/01

[Signature]  
Signature of authorized representative of  
Plastering Contractor

This installation card must be submitted to the building inspector after completion of work and before final inspection.

# CERTIFICATION OF INSULATION

PART I GENERAL	ADDRESS OR TRACT		SACRAMENTO INSULATION CONTRACTORS				
	Winncrest Homes      LOT # 031  GLENMERE		<input checked="" type="checkbox"/> P.O. BOX 854, WEST SACRAMENTO, CA 95691 LIC. #202026 <input type="checkbox"/> 1309 MELODY ROAD, MARYSVILLE, CA 95901 LIC. #202026 <input type="checkbox"/> P.O. BOX 9651, FRESNO, CA 93793-9651 LIC. #202026 <input type="checkbox"/> P.O. BOX 1631, RENO, NV 89505 LIC. #10675 <input type="checkbox"/> 3326 A PONDEROSA WAY, LAS VEGAS, NV 89118 LIC. #10675 DATE INSULATION COMPLETED				
PART II AREAS INSULATED	WALLS		CEILINGS			FLOORS	
	(      SQUARE FEET)		(      SQUARE FEET)			(      SQUARE FEET)	
	TYPE OF INSULATION		TYPE OF INSULATION			TYPE OF INSULATION	
	MATERIAL <b>FIBERGLASS</b>		MATERIAL <b>FIBERGLASS</b>			MATERIAL <b>FIBERGLASS</b>	
	FORM <b>BATTS</b>		FORM <b>BATTS &amp; BLOW</b>			FORM <b>BATTS</b>	
	MANUFACTURER'S PRODUCT I D		MANUFACTURER'S PRODUCT I D			MANUFACTURER'S PRODUCT I D	
	MANUFACTURER		MANUFACTURER			MANUFACTURER	
	OCF		OCF			OCF	
	BAGS						
	R - VALUE INSTALLED	APPLIED THICKNESS	R - VALUE INSTALLED	APPLIED THICKNESS	MIN. INSTALLED WEIGHT PER SQUARE FOOT	R - VALUE INSTALLED	APPLIED THICKNESS
13	3 5/8	38	12 1/4				
38		14 3/4					
KNEE WALLS IF R-VALUE IS OTHER THAN WALLS ABOVE							
MATERIAL <b>FIBERGLASS</b>		FORM <b>BATTS</b>		R VALUE		MANUFACTURER <b>OCF</b>	
AIR INFILTRATION SEALANT							
MATERIAL <b>FOAM</b>				MANUFACTURER <b>W R GRACE</b>			
THIS IS TO CERTIFY THAT INSULATION AND/OR SEALANT HAS BEEN INSTALLED IN CONFORMANCE WITH APPLICABLE CODES, MATERIAL STANDARDS AND REGULATIONS.							
SIGNATURE - INSULATION CONTRACTOR <i>Bell</i>				TITLE <b>MANAGER</b>		DATE <b>6-14-1</b>	
SIGNATURE - GENERAL CONTRACTOR <i>[Signature]</i>				TITLE		DATE	
REMARKS							

# plot plan

THIS PLOT PLAN IS FOR THE PURPOSE OF SHOWING THE HOUSE TO BE CONSTRUCTED ON THE LOT AND MAY NOT REPRESENT THE FINAL AS-BUILT CONFIGURATION OF THE PROPERTY OR IMPROVEMENTS THEREON. THE ACCURACY OF THIS PLOT PLAN IS NOT GUARANTEED, NOR IS IT A PART OF ANY POLICY, REPORT OR GUARANTEE TO WHICH IT MAY BE ATTACHED. ACTUAL DIMENSIONS, OTHER THAN MINIMUM ORDINANCE, MAY VARY OR CHANGE WITHOUT PRIOR NOTICE, DUE TO ACTUAL SITE CONDITIONS.

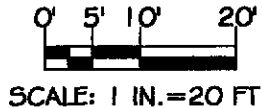

ARROWBROOK AVENUE

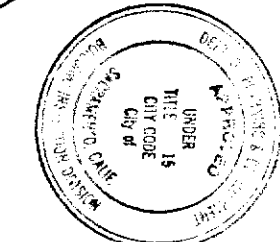
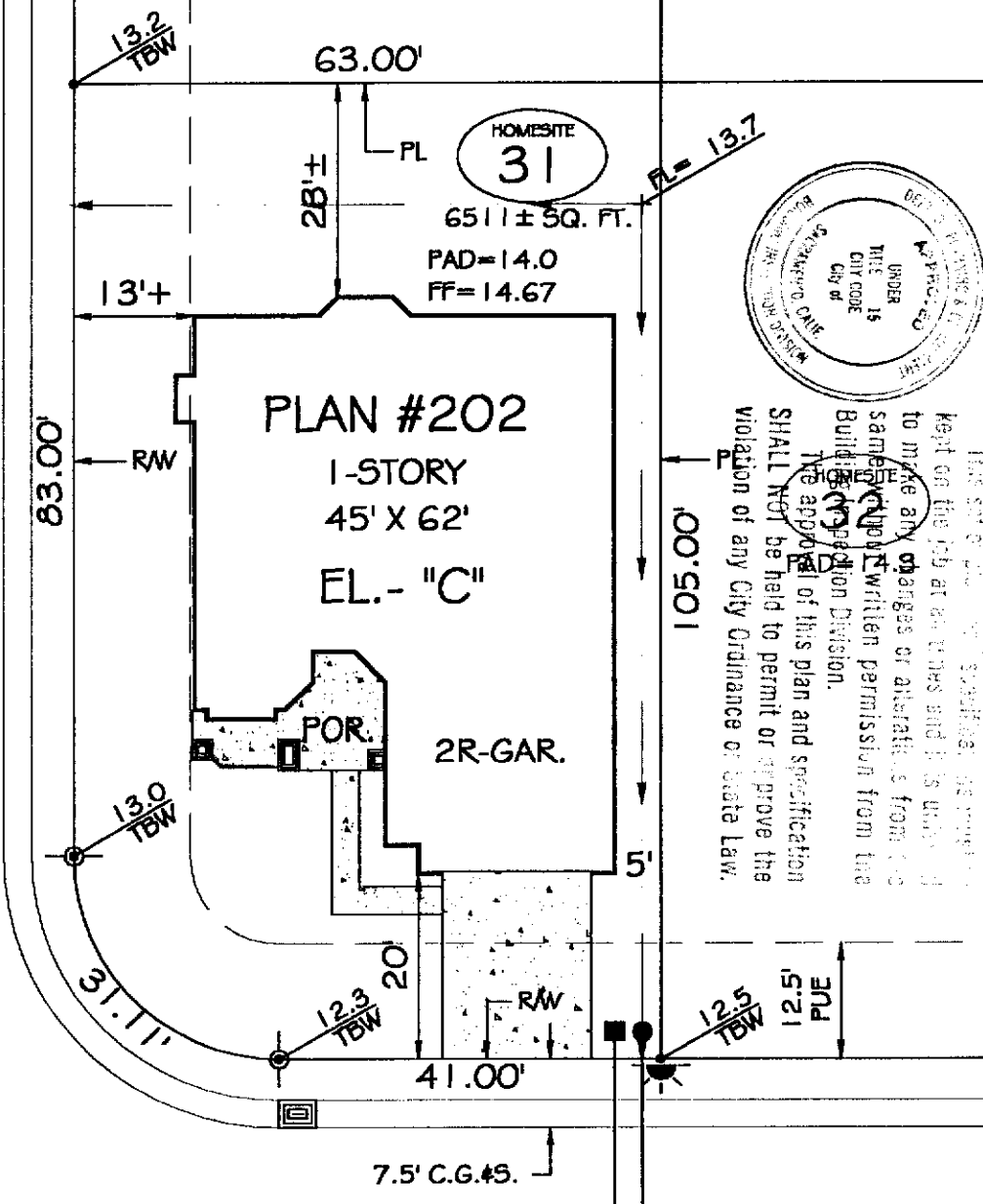

The set of this plan and specifications are to be kept on file at all times and it is understood that any changes or alterations from the same shall require written permission from the Building Department. The approval of this plan and specification SHALL NOT be held to permit or approve the violation of any City Ordinance or State Law.

TATUM COURT

**lot coverage**  
 LOT AREA: 6248 S.F.  
 BUILDING: 2467 S.F.  
 BLDG./ LOT AREA: 40 %

**retaining wall**  
 HEIGHT: \_\_\_\_\_  
 LENGTH: \_\_\_\_\_  
 DISTANCE FROM P.L.: \_\_\_\_\_

- symbols legend**
- DROP INLET:
  - ELECTRIC SERVICE BOX:
  - FIRE HYDRANT:
  - FLOW LINE:
  - HIGH POINT:
  - GAS SERVICE:
  - PAD-MOUNT TRANSFORMER:
  - SEWER SVC.:
  - STREET LIGHT:
  - SPOT ELEVATION:
  - SWALE (FLOW DIRECTION):
  - WATER SVC.:
  - EXTENTS OF UPPER STORY LEVEL:

**general notes**

1. MEASUREMENTS ALONG CURVED LINES ARE CHORD LENGTHS, U.O.N.
2. SETBACK DIMENSIONS ARE ROUNDED DOWN TO NEAREST HALF UNIT, U.O.N.
3. MAXIMUM ALLOWABLE LOT COVERAGE IS 45% FOR 1-STORY AND 40% FOR 2-STORY.

3.2	BARTH	12/13/00	20:1
phase	drawn by	revision	scale



## Winncrest Homes

### Glenmere

a Northpointe Park Village Community

## home site #31

### 3 Tatum Court

NORTHPOINTE PARK VILLAGE 14  
 CITY OF SACRAMENTO, CALIFORNIA  
 A.P.N.: 225-112-031-000