



APPROVED  
BY THE CITY COUNCIL

SEP 29 1987

OFFICE OF THE  
CITY CLERK

12

DEPARTMENT OF  
PUBLIC WORKS

ENGINEERING DIVISION

THOMAS M. FINLEY  
ENGINEERING DIVISION MANAGER

CITY OF SACRAMENTO  
CALIFORNIA

927 TENTH STREET  
ROOM 200  
SACRAMENTO, CA  
95814-2705

916-449-8220

CONSTRUCTION SECTION  
640 BERCUT DRIVE  
SUITE B  
SACRAMENTO, CA  
95814-0131

916-449-5282

September 29, 1987

City Council  
Sacramento, California

Honorable Members In Session:

SUBJECT: Wentworth Place (P-86182) - Approval of Final Subdivision  
Map

SUMMARY

Adoption of a resolution approving a Final Subdivision Map for  
Wentworth Place, located at 1618 Wentworth Avenue, is recommended.

BACKGROUND

On August 19, 1986, the City Council approved a Tentative Subdivision  
Map by adopting Resolution No. 86-656.

All conditions in the staff subdivision report have been met and the  
Final Subdivision Map is presented for approval.

FINANCIAL

All subdivision costs are being paid by the subdividers, John Wong,  
Toy Wong, Stephen C. Chan and Glen Wong.

City Council  
Wentworth Place (P-86182)  
September 29, 1987  
Page 2

RECOMMENDATION

It is recommended that the attached resolution approving the Final Subdivision Map be adopted.

Respectfully submitted,

  
THOMAS M. FINLEY  
Engineering Division Manager

Recommendation Approved:

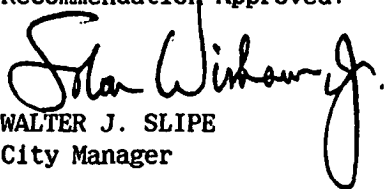
*For*   
WALTER J. SLIPE  
City Manager

Approved:

  
MELVIN H. JOHNSON  
Director of Public Works

JL:dk  
D2-27.G  
09.1587

September 29, 1987  
District No. 4

Attachment

# RESOLUTION NO. 87-799

ADOPTED BY THE SACRAMENTO CITY COUNCIL ON DATE OF

**APPROVED**  
BY THE CITY COUNCIL

SEP 29 1967

APPROVING FINAL SUBDIVISION MAP  
FOR WENTWORTH PLACE (P-86182)

CITY CLERK

WHEREAS, THE COUNCIL OF THE CITY OF SACRAMENTO FINDS AND DETERMINES AS FOLLOWS:

- A. The Final Subdivision Map for Wentworth Place, located at 1618 Wentworth Avenue, with provisions for its design and improvement, is consistent with the City General Plan and the 1965 Sutterville Community Plan.
- B. The Final Subdivision Map is in substantial compliance with the previously approved tentative map.

NOW, THEREFORE, BE IT RESOLVED BY THE COUNCIL OF THE CITY OF SACRAMENTO AS FOLLOWS:

- 1. The Final Subdivision Map for Wentworth Place, located at 1618 Wentworth Avenue, is hereby approved.
- 2. All offers of dedication shown on said map are hereby accepted.

\_\_\_\_\_

MAYOR

ATTEST:

\_\_\_\_\_

CITY CLERK

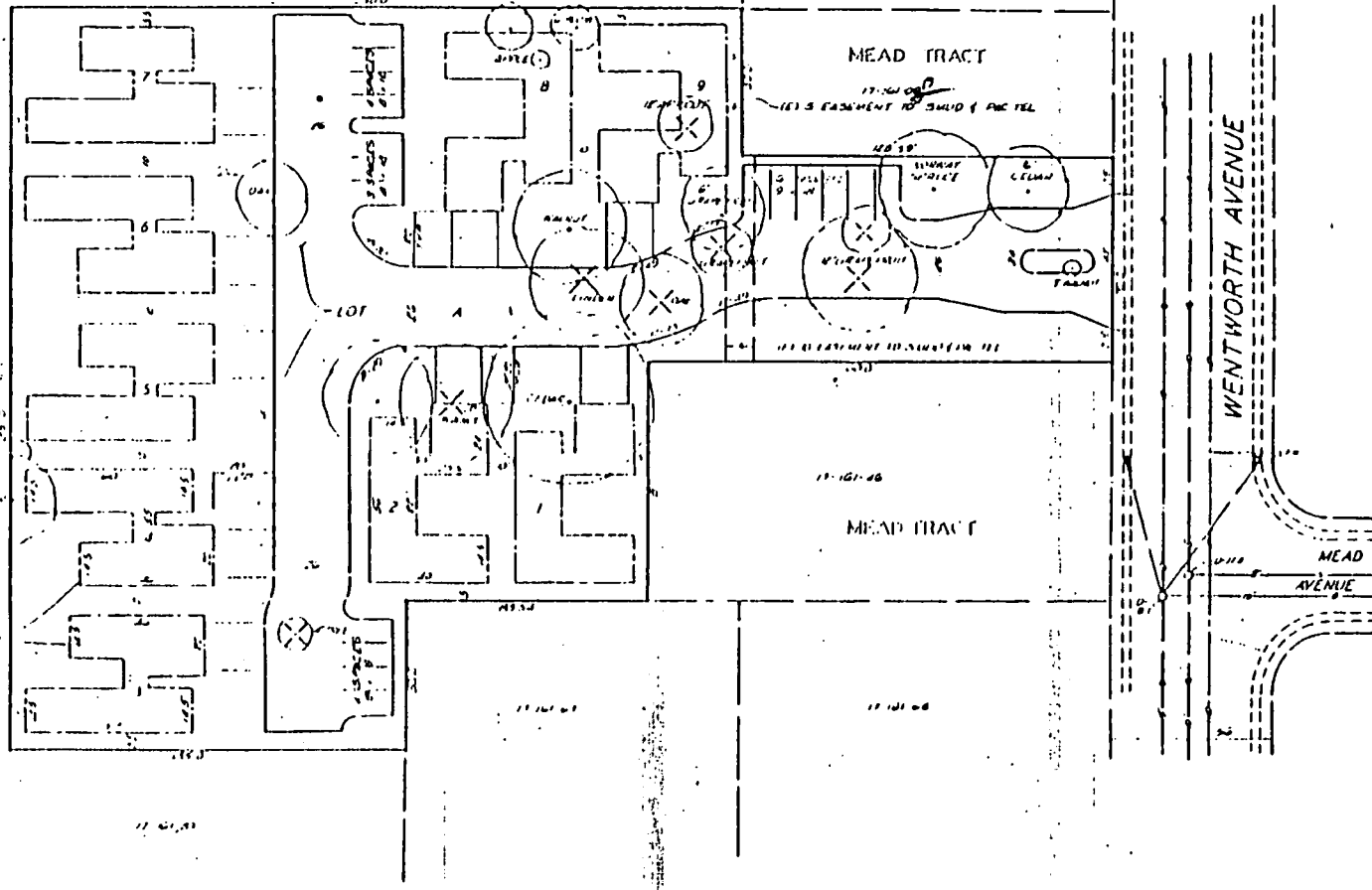

LOCATION MAP

DATE OF PREPARATION: MAY 8 1955

OWNER: SAUND J. ORSI & STENSON STEPHENSON  
 3312 WENTWORTH AVENUE  
 SACRAMENTO CA 95817  
 424 2212

CONSULTING: JOHN ORSI  
 1922 WYOMING AVE  
 SACRAMENTO, CA 95818

ENGINEER: HAROLD THOMAS/STON GROUP  
 1551 SHERIDAN ST  
 SACRAMENTO CA 95818  
 CLARENCE HAROLD S. THOMAS, P.E. 26008  
 826 3202

PRELIM. DESIGN: 0-1

PRELIM. USE: VACANT

PRELIM. DESIGN: 0-1

PRELIM. USE: 3 PAVED LOTS

NUMBER OF LOTS: 1

GRT AREA: 3.46 AC

GNDG AREA: 3.46

DISTRICT: SACRAMENTO CITY UNIFIED

STATE DISTRICT: CITY OF SACRAMENTO

STATE DISTRICT: CITY OF SACRAMENTO

STATE DISTRICT: STATE DISPOSAL

15

RESOLUTION NO. 85-253

AUG 19 1955

APC-82



TENTATIVE MAP  
 WENTWORTH PLACE

NO.	DATE	DESCRIPTION
1		
2		
3		
4		
5		
6		
7		
8		
9		
10		