

CITY OF SACRAMENTO
1231 I Street, Sacramento, CA 95814

Permit No: 0014530
Insp Area: 4

Site Address: 1915 DELAFIELD WY SAC
Parcel No: 225-1320-038
N

NORTHPOINTE PARK UNIT 11 LOT 38

Sub-Type: NSFR
Housing (Y/N):

CONTRACTOR
J&I. PROPERTIES
3434 MARCONI AV. STE. C
SACRAMENTO CA. 95821

OWNER

ARCHITECT

Nature of Work: MP 2724 2 STORY 10 ROOM SFR

CONSTRUCTION LENDING AGENCY : I hereby affirm under penalty of perjury that there is a construction lending agency for the performance of the work for which this permit is issued (Sec. 3097, Civ. C).

Lender's Name _____ Lender's Address _____

LICENSED CONTRACTORS DECLARATION: I hereby affirm under penalty of perjury that I am licensed under provisions of Chapter 9 (commencing with section 7000) of Division 3 of the Business and Professions Code and my license is in full force and effect.

License Class B License Number 767107 Date 12-12-00 Contractor Signature [Signature]

OWNER-BUILDER DECLARATION: I hereby affirm under penalty of perjury that I am exempt from the contractors License Law for the following reason (Sec. 7031.5, Business and Professions Code: any city or county which requires a permit to construct, alter, improve, demolish, or repair any structure, prior to its issuance, also requires the applicant for such permit to file a signed statement that he or she is licensed pursuant to the provisions of the Contractors License Law (Chapter 9 (commencing with Section 7000) of Division 8 of the Business and Professions Code) or that he or she is exempt therefrom and the basis for the alleged exemption. Any violation of Section 7031.5 by any applicant for a permit subjects the applicant to a civil penalty of not more than five hundred dollars (\$500.00):

____ I, as a owner of the property, or my employees with wages as their sole compensation, will do the work, and the structure is not intended or offered for sale (Sec. 7044, Business and Professional Code. The Contractors License Law does not apply to an owner of property who builds or improves thereon, and who does such work himself or herself or through his/her own employees, provided that such improvements are not intended or offered for sale. If, however, the building or improvement is sold within one year of completion, the owner-builder will have the burden of proving that he/she did not build or improve for the purpose of sale.)

____ I, as owner of the property, am exclusively contracting with licensed contractors to construct the project (Sec. 7044, Business and Professions Code. The Contractors License Law does not apply to an owner of property who builds or improves thereon, and who contracts for such projects with a contractor(s) licensed pursuant to the Contractors License Law).

____ I am exempt under Sec. _____ B & PC for this reason: _____

Date _____ Owner Signature _____

IN ISSUING THIS BUILDING PERMIT, the applicant represents, and the city relies on the representation of the applicant, that the applicant verified all measurements and locations shown on the application or accompanying drawings and that the improvements to be constructed does not violate any law or private agreement relating to permissible or prohibited locations for such improvements. This building permit does not authorize any illegal location of any improvement or the violation of any private agreement relating to location of improvements.

I certify that I have read this application and state that all information is correct. I agree to comply with all city and county ordinances and state laws relating to building construction and hereby authorize representative(s) of this city to enter upon the abovementioned property for inspection purposes.

Date 12-12-00 Applicant/Agent Signature [Signature]

WORKER'S COMPENSATION DECLARATION: I hereby affirm under penalty of perjury one of the following declarations:

____ I have and will maintain a certificate of consent to self-insure for workers' compensation as provided for by Section 3700 of the Labor Code, for the performance of work for which the permit is issued.

I have and will maintain workers' compensation insurance, as required by Section 3700 of the Labor Code, for the performance of the work for which this permit is issued. My workers' compensation insurance carrier and policy number are:

Carrier RELIANCE INS CO Policy Number NWA2047932-00 Exp Date 11/18/2001

____ (This section need not be completed if the permit is for \$100 or less) I certify that in the performance of the work for which this permit is issued, I shall not employ any person in any manner so as to become subject to the workers' compensation laws of California and agree that if I should become subject to the workers' compensation provisions of Section 3700 of the Labor Code, I shall forthwith comply with those provisions.

Date 12-12-00 Applicant Signature [Signature]

WARNING: FAILURE TO SECURE WORKER'S COMPENSATION COVERAGE IS UNLAWFUL AND SHALL SUBJECT AN EMPLOYER TO CRIMINAL PENALTIES AND CIVIL FINES UP TO ONE HUNDRED THOUSAND DOLLARS (\$100,000) IN ADDITION TO THE COST OF COMPENSATION, DAMAGES AS PROVIDED FOR IN SECTION 3706 OF THE LABOR CODE, INTEREST AND ATTORNEY'S FEE.

THIS PERMIT SHALL EXPIRE BY LIMITATION IF WORK IS NOT COMMENCED WITHIN 180 DAYS.

Project Address: 1915 Delaheld Wy Assessor Parcel # 225-132-38
Lot Number: 36 Subdivision NORTHPOINTE Park Vil. 11

OWNER INFORMATION:

14530

Legal Property Owner: JTS Communities, Inc. Phone# 487-3434
Owner Address: 3434 Marconi AVE City Sacto State CA Zip 95821

CONTRACTOR INFORMATION:

Contractor JTS Communities Lic. # 767107 Phone # 487-3434 Fax 487-3815

PROJECT INFORMATION:

Land Use Zone R1A Occupancy Group R3 Construction Type VN Fed Code 1A
No. of Stories: 2 No. of Rooms: Street Width:
1st Floor Area 1468 2nd Floor Area 1256 Basement Roof Material
AREA IN SQUARE FOOT OF:
Dwelling/Living 2724
Garage/Storage 710
Decks/Balconies
Carports
SCOPE OF WORK: New SFD Plan: 116-NN

FOR OFFICE USE ONLY

- Information Above Complete AR Flood Waiver Required Planning Approval
Violation Files Checked Flood Elevation Certificate Required Design Review Approval
Standard Setbacks Water Development Infill Area Special Fee Districts Apply:
County Sewer

THE FOLLOWING MUST BE PROVIDED IN ORDER TO SUBMIT FOR PERMIT

- 2 COMPLETE PLOT PLANS LEGIBLE & DRAWN TO SCALE
11 X 17 COPY OF FLOOR PLAN WITH FOLLOWING INFORMATION
a) Assessor's Parcel Number c) Owners Name
b) New Floor Area d) Project Address

Date: Received by: (staff) Permit #

INSTALLATION CARD
Diamond Wall One Coat System
Omega Products International, Inc.

Project Address

1915 DelaField Wy
 NN CA
 10+ 38

ICBO Evaluation Service, Inc.
Report ER-4004

Date Completed

5/1

Plastering Contractor

Name:

J. T. S

Address:

11285 White Rock Rd Rancho Cordova

Telephone No.

(916) 635-2800 95742

Approved contractor number as issued by Omega Products Int'l, Inc.

2227

This is to certify that the exterior coating system on the building exterior at the above address has been installed in accordance with the evaluation report and the manufacturer's instructions.

Don Pickett
Signature of authorized representative of
plastering contractor

12-15-00
Date

This installation card must be presented to the building inspector after completion of work and before final inspection.



WesPac

insulation

a MASCO Company

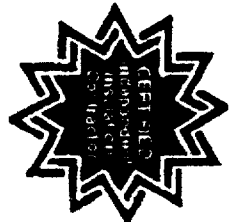

809 North Market Blvd, Ste. 11 • Sacramento, CA 95834
 (916) 927-7148 • Fax (916) 927-4257
 Lic. #487478

Installed Insulation Certificate

We certify that the building insulation listed herein is installed in conformance with current energy conservation regulations, California Administrative Code, Title 24, State of California

R FACTOR	AREA	TYPE	INCHES/BAGS (BLOWN)
R-13	CEILING	FIBERGLASS BLDG	10" / 45 BAGS
R-13	CEILING	FIBERGLASS GATFS	13"
R-13	220 VOLT WALLS	FIBERGLASS BATTFS	6" 50
R-13	240 VOLT WALLS	FIBERGLASS BATTFS	6" 50

1 & PROPERTIES

Certified by 

VERANDA @ NAIONAS PARK 101 S
 1100 VERANDA/99
 Address or Lot Number

Title Secretary

Date Installed 04/22/01 Phase 4

2 STORY HOUSE
 3 - CAR GARAGE
 6085 SQ. FT. OF LOT

DELAFIELD WAY

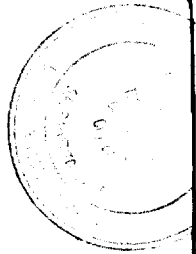
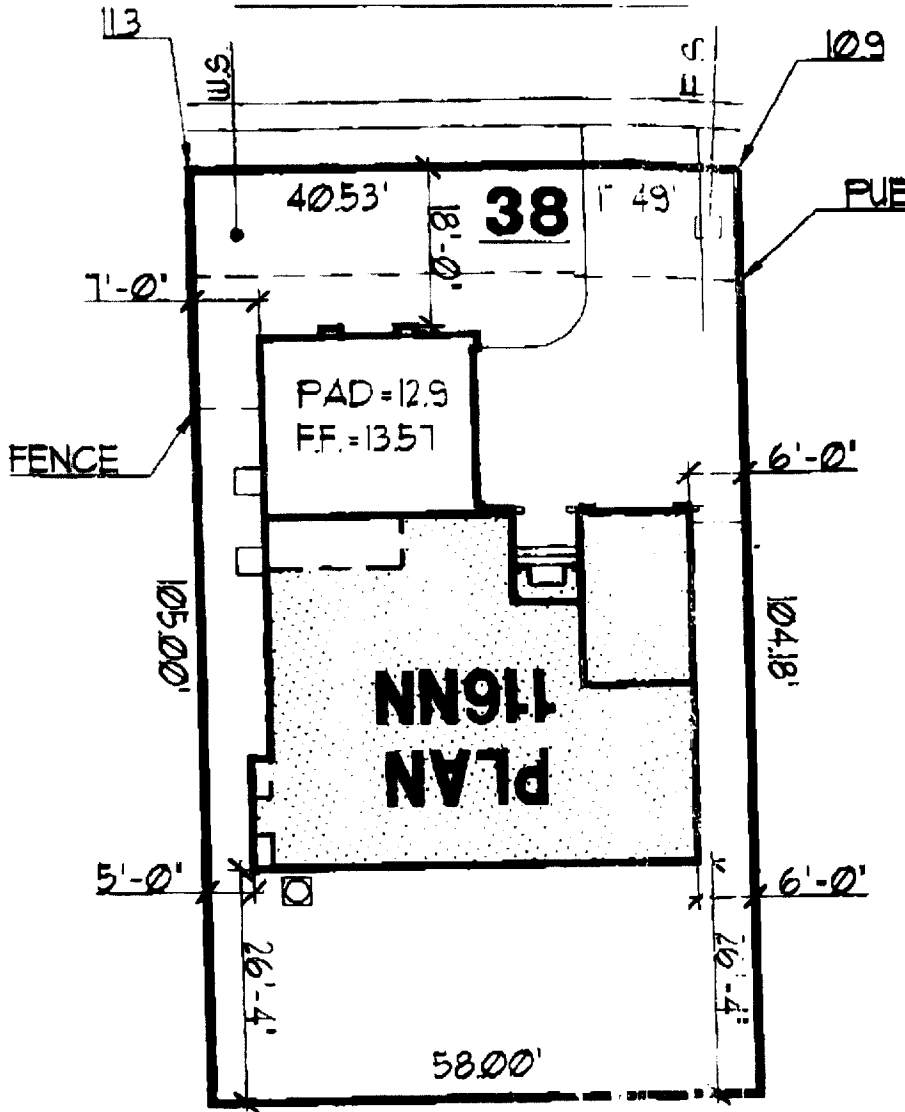

This plan is to be held in full force and effect until the violation of any City Ordinance or State Law.

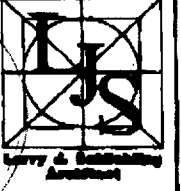

J & L Properties
 Architectural Studio

ORIGINAL
 NOV 30 2000
 Cindy Moreno

JTS Communities
 1434 Marconi Avenue
 Sacramento, CA 95821 (916) 487-3434

PROPOSED SITE PLAN
 NORTHPOINTE PARK
 VILLAGE II - NATOMAS PARK

VERANDA
 Date: Nov 28, 2000
 Drawn By: [Signature]
 Job: [Blank]
 Scale: 1/2" = 1'-0"
 Sheet: [Blank]
 of [Blank] sheets

APPROVED FOR RELEASE: [Signature]
 DATE: 11/30/00
 V-NP-LOT-38-116-A 11-30-00 7:33AM

APPROVED BY: [Signature]
 DATE: 11/30/00

