

CONSTRUCTION LENDING AGENCY

I hereby affirm under penalty of perjury that there is a construction lending agency for the performance of the work for which this permit is issued (Sec. 3097, Civ.C).

Lenders Name _____
Lenders Address _____

LICENSED CONTRACTORS DECLARATION

I hereby affirm under penalty of perjury that I am licensed under provisions of Chapter 9 (commencing with Section 7000) of Division 3 of the Business and Professions Code and my license is in full force and effect.

License Class 5 Lic. Number OB+350
Date 7-10-97 Contractor Howard J. Dumont
(Signature)

OWNER - BUILDER DECLARATION

I hereby affirm under penalty of perjury that I am exempt from the Contractors License Law for the following reason (Sec. 7031.5, Business and Professions Code: Any city or county which requires a permit to construct, alter, improve, demolish, or repair any structure, prior to its issuance, also requires the applicant for such permit to file a signed statement that he or she is licensed pursuant to the provisions of the Contractors License Law (Chapter 9 (commencing with Section 7000) of Division 8 of the Business and Professions Code) or that he or she is exempt therefrom and the basis for the alleged exemption. Any violation of Section 7031.5 by any applicant for a permit subjects the applicant to a civil penalty of not more than five hundred dollars (\$500.00):

- I, as owner of the property, or my employees with wages as their sole compensation, will do the work, and the structure is not intended or offered for sale (Sec. 7044, Business and Professions Code: The Contractors License Law does not apply to an owner of property who builds or improves thereon, and who does such work himself or herself or through his or her own employees, provided that such improvements are not intended or offered for sale. If, however, the building or improvement is sold within one year of completion, the owner-builder will have the burden of proving that he or she did not build or improve for the purpose of sale.)
- I, as owner of the property, am exclusively contracting with licensed contractors to construct the project (Sec. 7044, Business and Professions Code: The Contractors License Law does not apply to an owner of property who builds or improves thereon, and who contracts for such projects with a contractor(s) licensed pursuant to the Contractors License Law).
- I am exempt under Sec. _____ B & P C for this reason _____
Date _____ Owner _____
(Signature)

In issuing this building permit, the applicant represents, and the City relies on the representation of the applicant, that the applicant verified all measurements and locations shown on the application or accompanying drawings and that the improvement to be constructed does not violate any law or private agreement relating to permissible or prohibited locations for such improvements. This building permit does not authorize any illegal location of any improvement or the violation of any private agreement relating to location of improvements.

I certify that I have read this application and state that all information is correct. I agree to comply with all city and county ordinances and state laws relating to building construction and hereby authorize representative of this city to enter upon the abovementioned property for inspection purposes.

Date 7-10-97 Signature Howard J. Dumont
Applicant or Agent

BUILDING SITE ADDRESS

4417 H Street

SUITE

INSP. AREA

ASSESSOR PARCEL NO.

004-0302-018

COMMUNITY PLAN NO.

PLAN CHECK NO.

102
RC

NAME OF APPLICANT		ADDRESS	ZIP CODE	PHONE NO.
LICENSED CONTRACTOR		ADDRESS	ZIP CODE	PHONE NO.
PROPERTY OWNER		ADDRESS	ZIP CODE	PHONE NO.
ARCH. ENGR.				

NO. OF STORIES	NO. OF ROOMS	ROOF COVERING	AREA 1ST FLOOR	TOTAL AREA	GARAGE AREA	PATIO AREA	USE ZONE	STREET WIDTH
							<u>R1</u>	

THIS PERMIT IS FOR: BUILDING MECHANICAL PLUMBING ELECTRICAL SITE FIRE

NATURE OF WORK IN DETAIL: Dry rot Repairs

FLOOD STATUS: (Loss) SPECIAL CONDITIONS ATTACHMENTS:

CITY OF SACRAMENTO PERMIT SERVICES
BUILDING INSPECTION DIVISION 264-7619

WORKER'S COMPENSATION DECLARATION

I hereby affirm under penalty of perjury one of the following declarations:

- I have and will maintain a certificate of consent to self-insure for workers' compensation as provided for by Section 3700 of the Labor Code, for the performance of work for which the permit is issued.
- I have and will maintain workers' compensation insurance, as required by Section 3700 of the Labor Code, for the performance of the work for which this permit is issued. My workers' compensation insurance carrier and policy number are:
Carrier Golden Eagle Ins
Policy Number NWC 33934906

(This section need not be completed if the permit is for one hundred dollars (\$100) or less) I certify that in the performance of the work for which this permit is issued, I shall not employ any person in any manner so as to become subject to the workers' compensation laws of California and agree that if I should become subject to the workers' compensation provisions of Section 3700 of the Labor Code, I shall forthwith comply with those provisions.

Date: 7-10-97 Applicant: Howard J. Dumont
(Signature)

WARNING: FAILURE TO SECURE WORKERS' COMPENSATION COVERAGE IS UNLAWFUL AND SHALL SUBJECT AN EMPLOYER TO CRIMINAL PENALTIES AND CIVIL FINES UP TO ONE HUNDRED THOUSAND DOLLARS (\$100,000) IN ADDITION TO THE COST OF COMPENSATION, DAMAGES AS PROVIDED FOR IN SECTION 3706 OF THE LABOR CODE, INTEREST AND ATTORNEY'S FEES.

VALUATION	\$ <u>3755.00</u>	FIRE SP.	
ISSUED BY:	<u>[Signature]</u>	FED CODE	<u>HA</u>
DATE ISSUED	<u>7-10-97</u>	PERMIT NO.	<u>97</u>
BUILDING PERMIT FEE	\$ <u>160</u>		
PLAN CHECK/PROC. FEE	\$ <u>19</u>		
S.M.I. FEE	\$ <u>50</u>		
CONST. EXCISE TAX	\$		
CITY BUS LICENSE	\$ <u>160</u>		
TECH. FEE	\$ <u>75</u>		<u>1</u>
WATER DEV. FEE	\$		
CITY SEWER DEV. FEE	\$		<u>0</u>
REG. SEWER FEE	\$		
RESIDENTIAL CONST. TAX	\$		<u>2</u>
			<u>7</u>
			<u>0</u>
TOTAL FEES	\$ <u>188.25</u>		<u>R</u>

THIS PERMIT SHALL EXPIRE BY LIMITATION IF WORK AUTHORIZED IS NOT COMMENCED WITHIN 180 DAYS.

WOOD DESTROYING PESTS AND ORGANISMS INSPECTION REPORT

VB.0c

This is an inspection report only - not a Notice of Completion
ADDRESS OF PROPERTY INSPECTED

BUILDING NO. 4417	STREET H-STREET	CITY SACRAMENTO	ZIP 95814	COUNTY CODE 34	DATE OF INSPECTION 06-27-1997	NUMBER of PAGES 4
----------------------	--------------------	--------------------	--------------	-------------------	----------------------------------	----------------------

DUMONT PEST CONTROL
6643 32ND STREET SUITE #104
NORTH HIGHLANDS-CA 95660 (916) 344-3606

STATE OF CALIFORNIA
DEPARTMENT OF
CONSUMER AFFAIRS

STRUCTURAL PEST
CONTROL BOARD

REPORT OF INSPECTION

326631 V

REGISTRATION No. PR1625	REPORT No. 582-97	RECORD No. 497	STAMP No. 326631V	ESCROW No.
-------------------------	-------------------	----------------	-------------------	------------

Ordered By: DAVID KIDD 910 CONNELL COURT ROSEVILLE CA 95747 (771-2171)

Report Sent To.....: DAVID KIDD 910 CONNELL COURT ROSEVILLE CA 95747 (771-2171)

Property Owner.....: DAVID KIDD 910 CONNELL COURT ROSEVILLE CA 95747

Party in Interest :

ORIGINAL REPORT LIMITED REPORT SUPPLEMENTAL REPORT * REINSPECTION REPORT * *Original Stamp No. _____ Date _____

<p>General Description: 1 STORY STUCCO FRAME RESIDENCE FURNISHED AND OCCUPIED WITH A COMPOSITION-ROOF DETACHED GARAGE ON AN UNIMPROVED UNDERAREA AND CONCRETE SLAB</p> <hr/> <p>Inspection tag Posted : SUBAREA</p> <hr/> <p>Other Inspection Tags : None Noted</p>	<table border="1" style="width: 100%; border-collapse: collapse; font-size: x-small;"> <tr> <td style="writing-mode: vertical-rl; transform: rotate(180deg);">IN ACCESSIBLE AREAS</td> <td style="writing-mode: vertical-rl; transform: rotate(180deg);">NOT INSPECTED</td> <td style="writing-mode: vertical-rl; transform: rotate(180deg);">FURTHER INSPECTION</td> <td style="writing-mode: vertical-rl; transform: rotate(180deg);">SUBTERRANEAN TERMITES</td> <td style="writing-mode: vertical-rl; transform: rotate(180deg);">DRYWOOD TERMITES</td> <td style="writing-mode: vertical-rl; transform: rotate(180deg);">FUNGUS or DRYROT</td> <td style="writing-mode: vertical-rl; transform: rotate(180deg);">OTHER WOOD PESTS</td> <td style="writing-mode: vertical-rl; transform: rotate(180deg);">DAMPWOOD TERMITES</td> <td style="writing-mode: vertical-rl; transform: rotate(180deg);">EARTHWOOD CONTACTS</td> <td style="writing-mode: vertical-rl; transform: rotate(180deg);">FAULTY GRADE LEVELS</td> <td style="writing-mode: vertical-rl; transform: rotate(180deg);">CELLULOSE DEBRIS</td> <td style="writing-mode: vertical-rl; transform: rotate(180deg);">EXCESSIVE MOISTURE</td> <td style="writing-mode: vertical-rl; transform: rotate(180deg);">SHOWER LEAKS</td> </tr> </table>	IN ACCESSIBLE AREAS	NOT INSPECTED	FURTHER INSPECTION	SUBTERRANEAN TERMITES	DRYWOOD TERMITES	FUNGUS or DRYROT	OTHER WOOD PESTS	DAMPWOOD TERMITES	EARTHWOOD CONTACTS	FAULTY GRADE LEVELS	CELLULOSE DEBRIS	EXCESSIVE MOISTURE	SHOWER LEAKS																																																																																																																																		
IN ACCESSIBLE AREAS	NOT INSPECTED	FURTHER INSPECTION	SUBTERRANEAN TERMITES	DRYWOOD TERMITES	FUNGUS or DRYROT	OTHER WOOD PESTS	DAMPWOOD TERMITES	EARTHWOOD CONTACTS	FAULTY GRADE LEVELS	CELLULOSE DEBRIS	EXCESSIVE MOISTURE	SHOWER LEAKS																																																																																																																																				
<table border="1" style="width: 100%; border-collapse: collapse;"> <tr> <td style="width: 50%;">1. SUBSTRUCTURE AREA</td> <td style="width: 50%;">DRY ACCESSIBLE PARTIAL BASEMENT</td> <td></td><td></td><td></td><td></td><td></td><td></td><td></td><td></td><td></td><td></td><td></td> </tr> <tr> <td>2. STALL SHOWER</td> <td>NO STALL</td> <td></td><td></td><td></td><td></td><td></td><td></td><td></td><td></td><td></td><td></td><td></td> </tr> <tr> <td>3. FOUNDATIONS</td> <td>CONCRETE ABOVE GRADE</td> <td></td><td></td><td></td><td></td><td></td><td></td><td></td><td></td><td></td><td></td><td></td> </tr> <tr> <td>4. PORCHES ... STEPS</td> <td></td> <td></td><td></td><td></td><td></td><td></td><td></td><td></td><td></td><td></td><td></td><td></td> </tr> <tr> <td>5. VENTILATION</td> <td>APPEARS ADEQUATE ABOVE</td> <td></td><td></td><td></td><td></td><td>X</td><td></td><td></td><td></td><td></td><td></td><td></td> </tr> <tr> <td>6. ABUTMENTS</td> <td>HOLLOW STUCCO COLUMN & ARCHES</td> <td></td><td></td><td></td><td></td><td></td><td></td><td></td><td></td><td></td><td></td><td></td> </tr> <tr> <td>7. ATTIC SPACES</td> <td></td> <td></td><td></td><td></td><td></td><td></td><td></td><td></td><td></td><td></td><td></td><td></td> </tr> <tr> <td>8. GARAGES</td> <td>DETACHED NOT INCLUDED IN THIS REPORT</td> <td></td><td></td><td></td><td></td><td></td><td></td><td></td><td></td><td></td><td></td><td></td> </tr> <tr> <td>9. DECKS ... PATIOS</td> <td>ATTACHED WOOD DECK</td> <td></td><td></td><td></td><td></td><td>X</td><td></td><td></td><td></td><td></td><td></td><td></td> </tr> <tr> <td>10. OTHER ... INTERIOR</td> <td></td> <td></td><td></td><td></td><td></td><td></td><td></td><td></td><td></td><td></td><td></td><td>X</td> </tr> <tr> <td>11. OTHER ... EXTERIOR</td> <td></td> <td></td><td></td><td></td><td></td><td>X</td><td></td><td></td><td></td><td></td><td></td><td></td> </tr> </table>	1. SUBSTRUCTURE AREA	DRY ACCESSIBLE PARTIAL BASEMENT												2. STALL SHOWER	NO STALL												3. FOUNDATIONS	CONCRETE ABOVE GRADE												4. PORCHES ... STEPS													5. VENTILATION	APPEARS ADEQUATE ABOVE					X							6. ABUTMENTS	HOLLOW STUCCO COLUMN & ARCHES												7. ATTIC SPACES													8. GARAGES	DETACHED NOT INCLUDED IN THIS REPORT												9. DECKS ... PATIOS	ATTACHED WOOD DECK					X							10. OTHER ... INTERIOR												X	11. OTHER ... EXTERIOR						X							
1. SUBSTRUCTURE AREA	DRY ACCESSIBLE PARTIAL BASEMENT																																																																																																																																															
2. STALL SHOWER	NO STALL																																																																																																																																															
3. FOUNDATIONS	CONCRETE ABOVE GRADE																																																																																																																																															
4. PORCHES ... STEPS																																																																																																																																																
5. VENTILATION	APPEARS ADEQUATE ABOVE					X																																																																																																																																										
6. ABUTMENTS	HOLLOW STUCCO COLUMN & ARCHES																																																																																																																																															
7. ATTIC SPACES																																																																																																																																																
8. GARAGES	DETACHED NOT INCLUDED IN THIS REPORT																																																																																																																																															
9. DECKS ... PATIOS	ATTACHED WOOD DECK					X																																																																																																																																										
10. OTHER ... INTERIOR												X																																																																																																																																				
11. OTHER ... EXTERIOR						X																																																																																																																																										

DIAGRAM AND EXPLANATION OF FINDINGS (This report is limited to structure or structures shown on diagram)

FOUNDATION DIAGRAM: (Diagram not to scale)

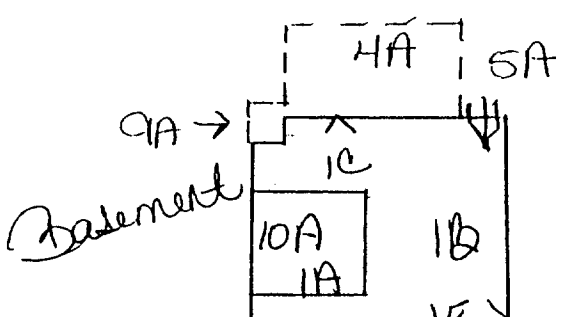

Address of Property Inspected	BLDG. NO.	STREET	CITY	ZIP
	4417	H-STREET	SACRAMENTO	95814
STAMP NO. 326631V		DATE OF INSPECTION: 06-27-1997	REPORT NO. : 582-97	

MOLDING ABOVE THE WINDOWS AS DESIGNATED 11B ON THE DIAGRAM.

RECOMMENDATION 11B. REPLACE THE EXISTING STUCCO MOLDING WITH NEW STUCCO MOLDING TO MATCH THE EXISTING AS CLOSE AS POSSIBLE. NOTE: AN EXACT MATCH IS NOT PROBABLE.

SECTION II

1. SUBSTRUCTURE FINDING.....

1A. THE WATER HEATER WAS OBSERVED TO BE UNSECURED AS REQUIRED BY CALIFORNIA HEALTH AND SAFETY CODE SECTION 19211 (SEISMIC SAFETY STRAPPING).+THIS WAS OBSERVED IN THE BASEMENT AREA.

RECOMMENDATION 1A. SECURE THE WATER HEATER IN A MANNER SO AS TO MITIGATE MOVEMENT DURING PERIODS OF SEISMIC ACTIVITY.

FINDING..... 1B. CELLULOSE DEBRIS WAS FOUND ON THE SURFACE OF THE SOIL BENEATH THE STRUCTURE. THIS CONDITION IS CONDUCTIVE TO SUBTERRANEAN TERMITE INFESTATION.

RECOMMENDATION 1B. REMOVE ALL CELLULOSE DEBRIS OF A RAKEABLE SIZE OR LARGER FROM THE SUBSTRUCTURE AREA.

4. PORCHES , STEPS FINDING.....

4A. THE PLYWOOD IS DELAMINATED AT THE REAR PATIO COVER. IF FURTHER INFORMATION IS DESIRED, IT IS SUGGESTED THAT A LICENSED ROOFING CONTRACTOR BE CONSULTED.+

RECOMMENDATION 4A. IF FURTHER INFORMATION IS DESIRED, IT IS SUGGESTED THAT A LICENSED ROOFING CONTRACTOR BE CONSULTED.+

5. VENTILATION FINDING.....

5B. THE SCREEN COVER FOR THE EXISTING ACCESS OPENING TO THE SUBAREA IS DETERIORATED.

RECOMMENDATION 5B. REPLACE THE EXISTING ACCESS COVER WITH A NEW SCREENED COVER.+

10. OTHER -- INTERIOR FINDING.....

10A. THE GROUT IS DEFICIENT AT THE KITCHEN COUNTER TOP ADJACENT TO THE SINK.

RECOMMENDATION 10A. APPLY GROUT AS NEEDED TO FORM A WATER RESISTANT SEAL.+

FINDING..... 10B. WATER STAINS WERE OBSERVED ON THE CEILING OF THE DINING ROOM AREA

RECOMMENDATION 10B. IF FURTHER INFORMATION IS DESIRED, IT IS SUGGESTED THAT A LICENSED ROOFING CONTRACTOR BE CONSULTED.+

ADDITIONAL NOTES or REMARKS

REINSPECTION OF WORK PERFORMED BY THE OWNER OR OTHERS TO OBTAIN A CERTIFICATION IS REQUIRED BY LAW. THERE IS A CHARGE FOR EACH INSPECTION AND THE AMOUNT WILL NOT EXCEED THE FEE ORIGINALLY CHARGED.

* THE EXTERIOR SURFACE OF THE ROOF WILL NOT BE INSPECTED. IF YOU WANT THE WATER TIGHTNESS OF THE ROOF DETERMINED, YOU SHOULD CONTACT A LICENSED ROOFING CONTRACTOR.+

* THOSE PERFORMING THE REPAIRS ARE ADVISED TO CONTACT DUMONT PEST CONTROL AS MORE THAN 1 REINSPECTION MAY BE NECESSARY. THE REQUEST FOR THE REINSPECTION MUST MEET THE FOLLOWING CRITERIA. #1 - IT MUST BE MADE WITHIN 4 MONTHS FROM THE DATE OF THE ORIGINAL INSPECTION. #2 - THE PARTIES INVOLVED MUST BE AWARE THAT A REINSPECTION IS

SECOND PAGE OF STANDARD INSPECTION REPORT OF THE PROPERTY LOCATED AT:

Address of Property Inspected	BLDG.NO. 4417	STREET H-STREET	CITY SACRAMENTO	ZIP 95814
STAMP NO. 326631V		DATE OF INSPECTION: 06-27-1997	REPORT NO. : 582-97	

ORIGINAL REPORT

A SEPARATED REPORT WHICH IS DEFINED AS SECTION I/SECTION II CONDITIONS EVIDENT ON THE DATE OF INSPECTION. SECTION I CONTAINS ITEMS WHERE THERE IS EVIDENCE OF ACTIVE INFESTATION, INFECTION OR CONDITIONS THAT HAVE RESULTED IN OR FROM INFESTATION OR INFECTION. SECTION II ITEMS ARE CONDITIONS DEEMED LIKELY TO LEAD TO INFESTATION OR INFECTION, BUT WHERE NO VISIBLE EVIDENCE OF SUCH WAS FOUND. FURTHER INSPECTION ITEMS ARE DEFINED AS RECOMMENDATIONS TO INSPECT AREA(S) WHICH DURING THE ORIGINAL INSPECTION DID NOT ALLOW THE INSPECTOR ACCESS TO COMPLETE HIS INSPECTION AND CANNOT BE DEFINED AS SECTION I or SECTION II.

SECTION I

1. SUBSTRUCTURE FINDING.....

1C. AN EARTH TO WOOD CONTACT CONDITION WAS OBSERVED WHERE THE SOIL IS TOUCHING THE MUDSILL AT THE PERIMETER WALL OF THE BASEMENT.

RECOMMENDATION

1C. REGRADE THE SOIL TO CORRECT THE DIRECT EARTH TO WOOD CONTACT CONDITION. NOTE: SHOULD DAMAGE BE EXPOSED DURING THE COURSE OF THIS CORRECTION, A SUPPLEMENTAL REPORT WILL BE ISSUED STATING ANY FINDINGS AND RECOMMENDATIONS AND AN ESTIMATE OF COST FOR ANY REPAIRS+

FINDING.....

1D. WOOD DECAY FUNGI DAMAGE WAS NOTED IN THE FRAMING AND SUBFLOORING BENEATH THE CONCRETE CARRIAGE TYPE PORCH AT THE FRONT OF THE STRUCTURE..

RECOMMENDATION

1D. REPLACE THE DAMAGED WOOD MEMBERS WITH NEW WOOD. APPLY A SODIUM BORATE SOLUTION TO THE AREAS OF REPAIR TO INHIBIT THE FUTURE GROWTH OF WOOD DECAY FUNGI DAMAGE.+NOTE: THIS REPAIR WILL BE PERFORMED FROM BENEATH THE STRUCTURE. ALL CARE WILL BE TAKEN WHEN PERFORMING THE REPAIR, HOWEVER, NO RESPONSIBILITY WILL BE ASSUMED FOR CRACKING OF THE CONCRETE PORCH CAP OR THE STUCCO AT THIS AREA.

FINDING.....

1E. WOOD DECAY FUNGI BLOOMS WERE OBSERVED ON THE WOOD SHEATHING BENEATH THE VENTILATION OPENING AS DESIGNATED 1E ON THE DIAGRAM.

RECOMMENDATION

1E. SCRAPE OFF THE EXISTING WOOD DECAY FUNGI BLOOMS. APPLY A CHEMICAL SOLUTION CONTAINING SODIUM BORATE TO INHIBIT FUTURE GROWTH OF WOOD DECAY FUNGI.

5. VENTILATION FINDING.....

5A. WOOD DECAY FUNGI DAMAGE WAS NOTED IN THE WOOD FRAMING AT THE ACCESS OPENING.+

RECOMMENDATION

5A. REPLACE THE DAMAGED WOOD MEMBERS WITH NEW WOOD. APPLY SODIUM BORATE THE AREA(S) OF REPAIR AND/OR REMOVAL OF WOOD DECAY FUNGI.+

9. DECKS -- PATIOS FINDING.....

9A. EXTENSIVE WOOD DECAY FUNGI DAMAGE WAS NOTED IN REAR WOOD DECK(S).+

RECOMMENDATION

9A. REMOVE THIS DECK IN ITS ENTIRETY AND REPLACE WITH A NEW DECK TO MATCH EXISTING AS CLOSE AS POSSIBLE.+

11. OTHER -- EXTERIOR FINDING.....

11A. WOOD DECAY FUNGI DAMAGE WAS FOUND IN THE WOODEN WINDOW SASHES AS DESIGNATED 11A ON THE DIAGRAM.+

RECOMMENDATION

11A. REMOVE AND REPLACE THE DAMAGED WOODEN WINDOW SASHES WITH NEW WOODEN WINDOW SASHES THAT WILL MATCH EXISTING AS CLOSE AS POSSIBLE.OUR BID DOES NOT INCLUDE REPLACEMENT OF SASH CORDS OR PAINTING OF THE NEW SASH(ES).+

FINDING.....

11B. WOOD DECAY FUNGI DAMAGE WAS NOTED IN THE STUCCO

FOURTH PAGE OF STANDARD INSPECTION REPORT OF THE PROPERTY LOCATED AT:

Address of Property Inspected BLDG. NO. STREET CITY ZIP
 4417 H-STREET SACRAMENTO 95814

STAMP NO. 326631V DATE OF INSPECTION: 06-27-1997 REPORT NO.: 582-97

THANK YOU FOR GRANTING US THE OPPORTUNITY TO INSPECT YOUR HOME. IF YOU HAVE ANY QUESTIONS REGARDING THIS REPORT OR HAVE OTHER PEST PROBLEMS (ANTS, ROACHES, RODENTS, ETC), PLEASE CONTACT US AT 344-3606.

CUSTOMER SATISFACTION HAS BEEN THE KEY TO OUR SUCCESS. +
 *

"NOTICE TO OWNER" UNDER THE CALIFORNIA MECHANICS LIEN LAW, ANY STRUCTURAL PEST CONTROL COMPANY WHICH CONTRACTS TO DO WORK FOR YOU, ANY CONTRACTOR, SUBCONTRACTOR, LABORER, SUPPLIER OR OTHER PERSON WHO HELPS TO IMPROVE YOUR PROPERTY, BUT IS NOT PAID FOR HIS OR HER WORK OR SUPPLIES, HAS THE RIGHT TO ENFORCE A CLAIM AGAINST YOUR PROPERTY. THIS MEANS THAT AFTER A COURT HEARING, YOUR PROPERTY COULD BE SOLD BY A COURT OFFICER AND THE PROCEEDS USED TO SATISFY THE INDEBTEDNESS. THIS CAN HAPPEN EVEN IF YOU HAVE PAID YOUR STRUCTURE PEST CONTROL COMPANY IN FULL IF THE SUBCONTRACTOR, LABORERS OR SUPPLIERS REMAIN UNPAID.

TO PRESERVE THEIR RIGHT TO FILE A CLAIM OR LIEN AGAINST YOUR PROPERTY CERTAIN CLAIMANTS SUCH AS SUBCONTRACTORS OR MATERIAL SUPPLIERS ARE REQUIRED TO PROVIDE YOU WITH A DOCUMENT ENTITLED 'Preliminary Notice' PRIME CONTRACTORS AND LABORERS FOR WAGES DO NOT HAVE TO PROVIDE THIS NOTICE. A PRELIMINARY NOTICE IS NOT A LIEN AGAINST YOUR PROPERTY. ITS PURPOSE IS TO NOTIFY YOU OF PERSONS WHO MAY HAVE A RIGHT TO FILE A LIEN AGAINST YOUR PROPERTY IF THEY ARE NOT PAID.

NOTICE: REPORTS ON THIS STRUCTURE PREPARED BY VARIOUS REGISTERED COMPANYS SHOULD LIST THE SAME FINDINGS (i.e. termite infestations, termite damage, fungus damage, etc.). HOWEVER, RECOMMENDATION TO CORRECT THESE FINDINGS MAY VARY FROM COMPANY TO COMPANY. YOU HAVE A RIGHT TO SEEK A SECOND OPINION FROM ANOTHER COMPANY.

CHEMICAL NAME and ACTIVE INGREDIENT:

- | | | | |
|----------------------------------|--------|--|--------|
| 1[] DEMON T/O CYPERMETHRIN | _____X | 2[] _____ | _____X |
| 3[] SAFROTIN ZOECON | _____X | 4[] PT 3-6-10 | _____X |
| 5[] _____ | _____X | 6[] TIM-SOR Disodium ootaborate tetrahydrate | _____X |
| 7[] DURSBBAN TO | _____X | 8[] PT 270 DURSBBAN chlorpyrifos | _____X |
| 9[] DURSBBAN LO | _____X | 10[] GENTROL hydroprane | _____X |
| 11[] DIAZINON 4E DIAZINON | _____X | 12[] BORID boric acid | _____X |
| 13[] DURSBBAN 50W DURSBBAN | _____X | 14[] DIAZINON 5G DIAZINON 5% " | _____X |
| 15[] VENGEANCE BROMETHALIN | _____X | 16[] TEMPO 20 WP CYCLOPROPANCARBORYLATE | _____X |

State law requires that you be given the following information: CAUTION-PESTICIDES ARE TOXIC CHEMICALS. STRUCTURAL PEST CONTROL Operators are licensed and regulated by the Structural Pest Control Board, and apply PESTICIDES which are REGISTERED and approved for use by the California Department of FOOD AND AGRICULTURE AND THE UNITED STATES ENVIRONMENTAL PROTECTION AGENCY. Registration is granted when the state finds that based on existing scientific evidence there are no appreciable risks if proper use conditions are followed or that the risks are outweighed by the benefits. The degree of risk depends upon the degree of exposure, so exposure should be minimized.

If within 24 hours following application you experience symptoms similar to common seasonal illness comparable to the flu, contact your physician or poison control center (1-800-852-7221) and DUMONT PEST CONTROL.

For further information, contact any of the following: DUMONT PEST CONTROL (916-344-3606). FOR HEALTH QUESTIONS - COUNTY HEALTH Department (916-366-2175); for Application Information THE COUNTY AGRICULTURAL commissioner (916-878-6603) and for regulatory information: The Structural Pest Control Board (916-263-2540) 1422 Howe ave. #3 Sacramento, CA 95825

ISSUED

JUL 10 1997

Sacramento Building Division